

Legend

- Timber Sale Boundary
- Ownership
- County Line
- Stream Buffer
- Slope Buffer
- Green Tree Retention Area
- Reforestation Area
- Surfaced Road
- Unsurfaced Road
- New Road Construction
- Right-of-Way
- Type F Stream
- Type N Stream
- Unknown Stream
- Project Point

EXHIBIT "A"

OF TIMBER SALE CONTRACT NO. WO-341-2025-W01089-01
BARK BEETLE BAILEY
PORTIONS OF SECTION 7, T10S, R7W, W.M.,
BENTON AND POLK COUNTIES, OREGON

This product is for informational use and may not have been prepared for or be suitable for legal, engineering or survey purposes. Variations may exist between and among data sets in use by the Department of Forestry. This map was developed using the Statewide layer in April 2024. Users of this information should review or consult the primary data and information sources to ascertain the usability of this information.

UNIT	GROSS ACRES	NET ACRES
1 (MC)	99	69
2 (RW)	2	2
TOTAL	101	71

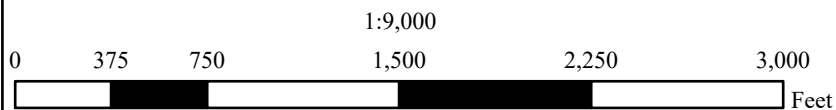

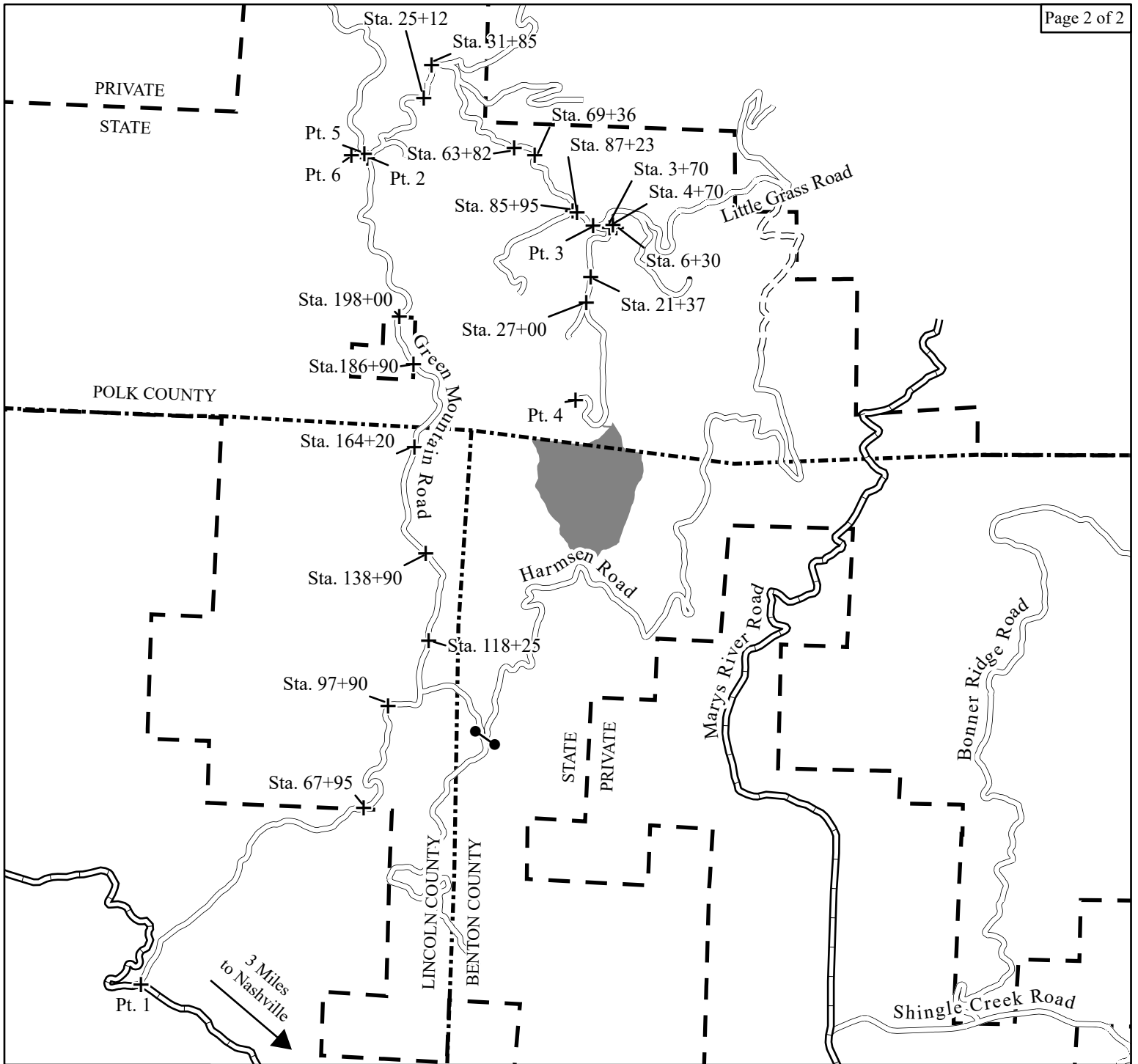

Legend

- Timber Sale Area
- Ownership
- County Line
- County Road
- Surfaced Road
- Unsurfaced Road
- + Project Point
- Gate

EXHIBIT "A"

OF TIMBER SALE CONTRACT NO. WO-341-2025-W01089-01
BARK BEETLE BAILEY
PORTIONS OF SECTION 7, T10S, R7W, W.M.,
BENTON AND POLK COUNTIES, OREGON

UNIT	GROSS ACRES	NET ACRES
1 (MC)	99	69
2 (RW)	2	2
TOTAL	101	71

This product is for informational use and may not have been prepared for or be suitable for legal, engineering or survey purposes. Users of this information should review or consult the primary data and information sources to ascertain the usability of this information.



1:36,000

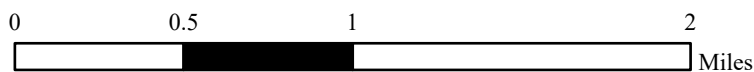

04/26/2024