

**Legend**

- • • Timber Sale Boundary
- - - Ownership
- ▨ Stream Buffer
- ▩ Slope Buffer
- ▨ Reforestation Area
- Surfaced Road
- - - Unsurfaced Road
- Type F Stream
- ... Type N Stream
- ◆ Land Survey Monument
- + Project Point

**EXHIBIT "A"**

OF TIMBER SALE CONTRACT NO. WO-341-2025-W1088-01  
ALL TERRAIN  
PORTIONS OF SECTIONS 15 and 16, T11S, R09W, W.M.,  
LINCOLN COUNTY, OREGON

This product is for informational use and may not have been prepared for or be suitable for legal, engineering or survey purposes. Variations may exist between and among data sets in use by the Department of Forestry. This map was developed using the Statewide layer in June of 2024. Users of this information should review or consult the primary data and information sources to ascertain the usability of this information.

	GROSS AREA	ACRES	NET ACRES
1 (MC)	27		21
2 (MC)	23		19
3 (MC)	7		3
TOTAL	57		43

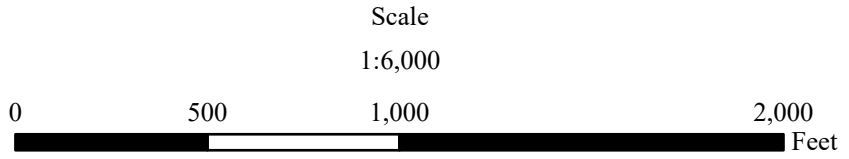

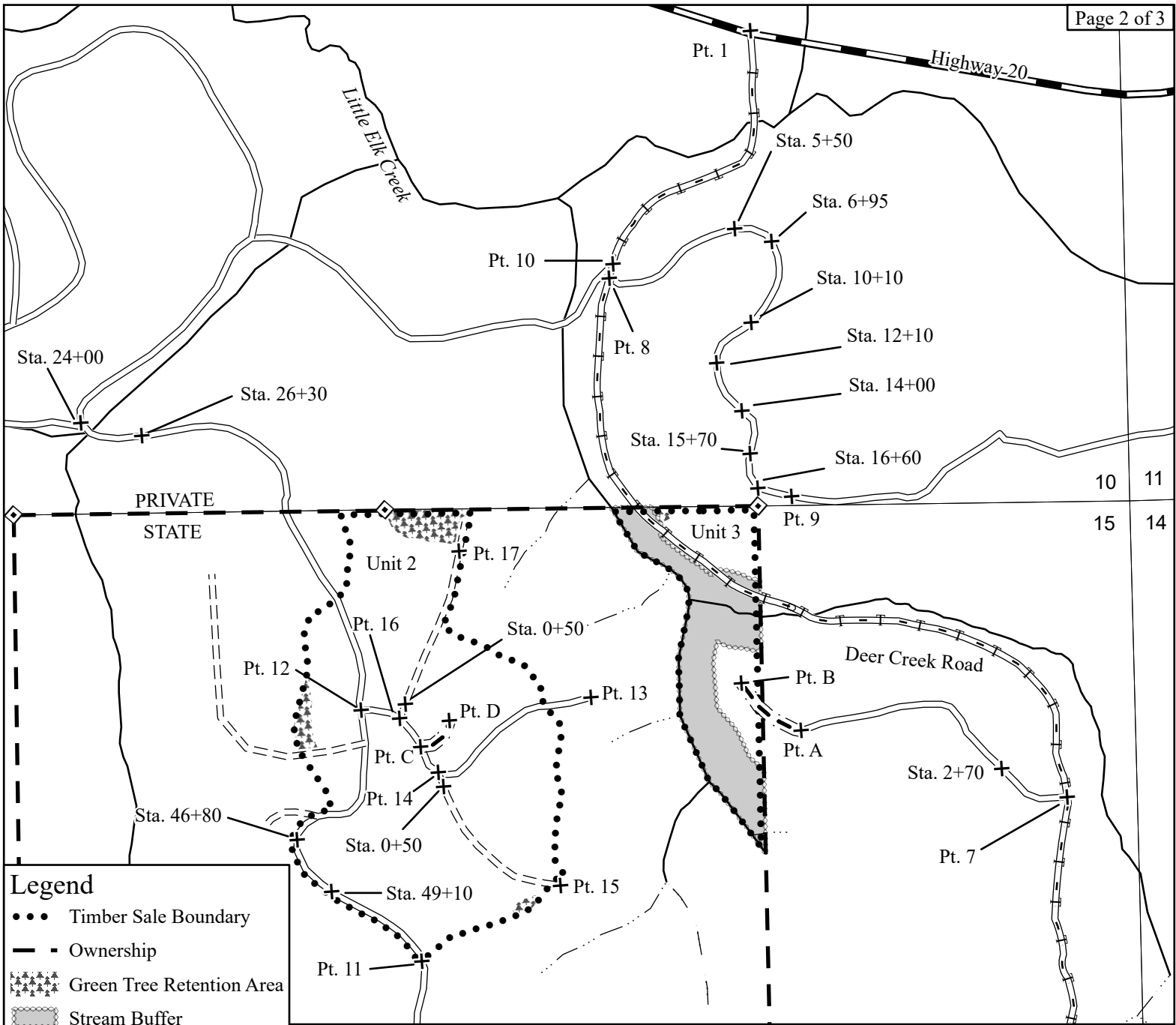

## Legend

- Timber Sale Boundary
- - - Ownership
- Green Tree Retention Area
- Stream Buffer
- Highway
- Surfaced Road
- Unsurfaced Road
- Right-of-Way
- - - New Road Construction
- Type F Stream
- Type N Stream
- T - T Fiber Optic Line
- Land Survey Monument
- + Project Point

## EXHIBIT "A"

OF TIMBER SALE CONTRACT NO. WO-341-2025-W01088-01  
ALL TERRAIN  
PORTIONS OF SECTIONS 15 and 16, T11S, R09W, W.M.,  
LINCOLN COUNTY, OREGON

This product is for informational use and may not have been prepared for or be suitable for legal, engineering or survey purposes. Variations may exist between and among data sets in use by the Department of Forestry. This map was developed using the Statewide layer in June 2024. Users of this information should review or consult the primary data and information sources to ascertain the usability of this information.

	GROSS AREA	NET ACRES	NET ACRES
1 (MC)	27	21	
2 (MC)	23	19	
3 (MC)	7	3	
TOTAL	57	43	

Scale  
1:6,000

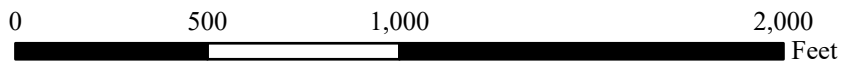

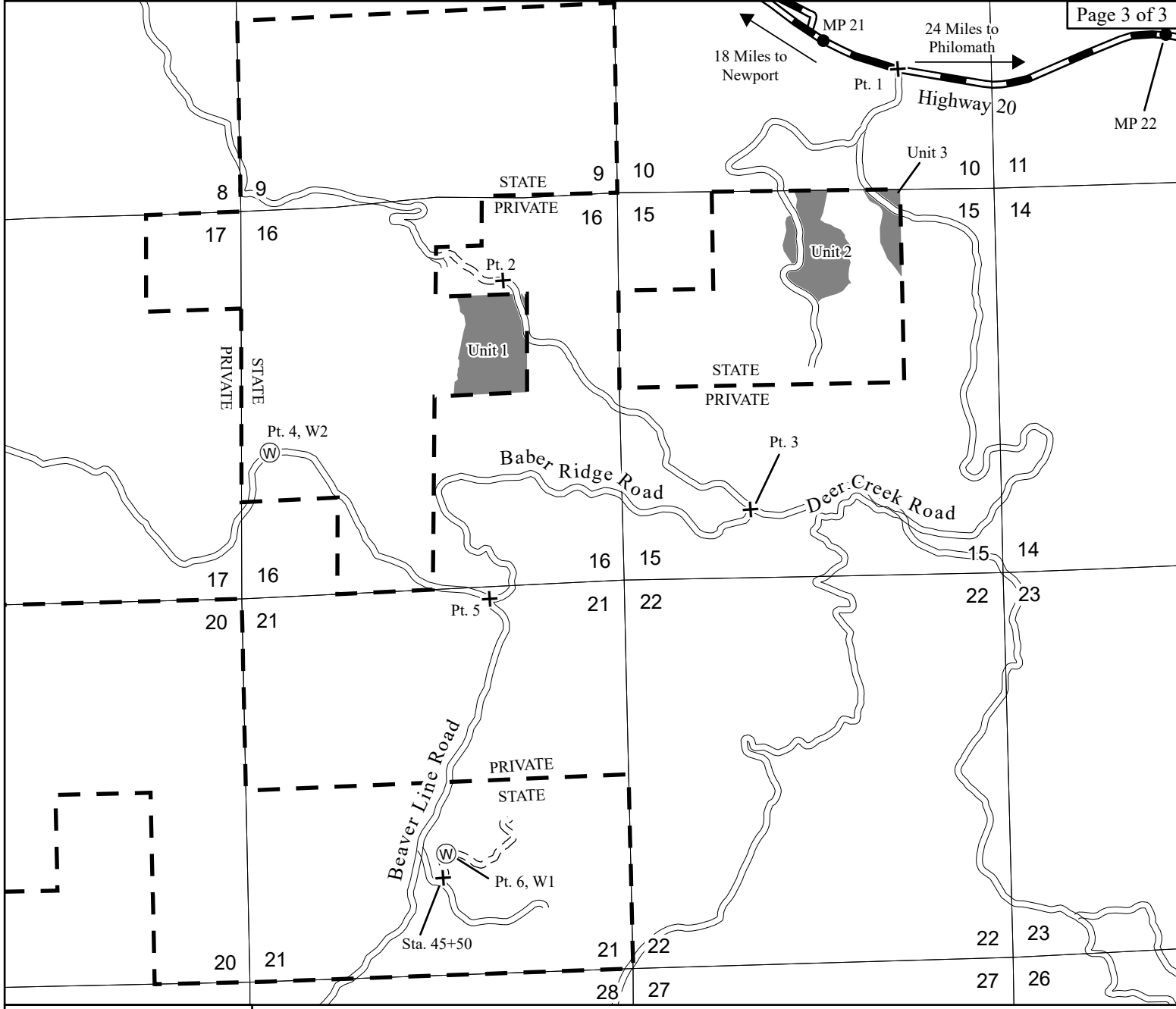

**Legend**

- Timber Sale Area
- Ownership
- Highway
- Surfaced
- Unsurfaced
- Project Point
- Waste Area
- Milepost

**EXHIBIT "A"**

OF TIMBER SALE CONTRACT NO. WO-341-2025-W1088-01  
ALL TERRAIN  
PORTIONS OF SECTIONS 15 and 16, T11S, R09W, W.M.,  
LINCOLN COUNTY, OREGON

This product is for informational use and may not have been prepared for or be suitable for legal, engineering or survey purposes. Users of this information should review or consult the primary data and information sources to ascertain the usability of this information.

Scale  
1:24,000

0 0.38 0.75 1.5 Miles

08/26/2024