

Legend

- Timber Sale Boundary
- ⋯ Stream Buffer Boundary
- : — Right of Way Boundary
- Surfaced Roads
- - - New Road Construction
- Type F-Stream
- Type N-Stream
- █ Stream Buffer
- ▨ Reforestation Area
- | — ODF Ownership Boundary
- Section Lines
- ⚡ Quarry

EXHIBIT A

FOR TIMBER SALE CONTRACT #FG-341-2021-W00260-01
 MISHMASH
 PORTIONS OF SECTIONS 34 & 35, T3N, R6W, W.M.,
 AND PORTIONS OF SECTION 3, T2N, R6W, W.M.,
 WASHINGTON COUNTY, OREGON

Forest Grove District GIS
 August, 2020

This product is for informational use and may not be
 suitable for legal, engineering, or surveying purposes.

1:12,000

1 inch = 1,000 feet

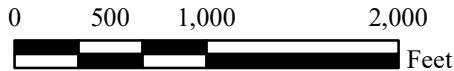

APPROXIMATE NET ACRES

UNIT 1	116 ACRES (MC)
UNIT 2	2 ACRES (R/W)
TOTAL	118 ACRES

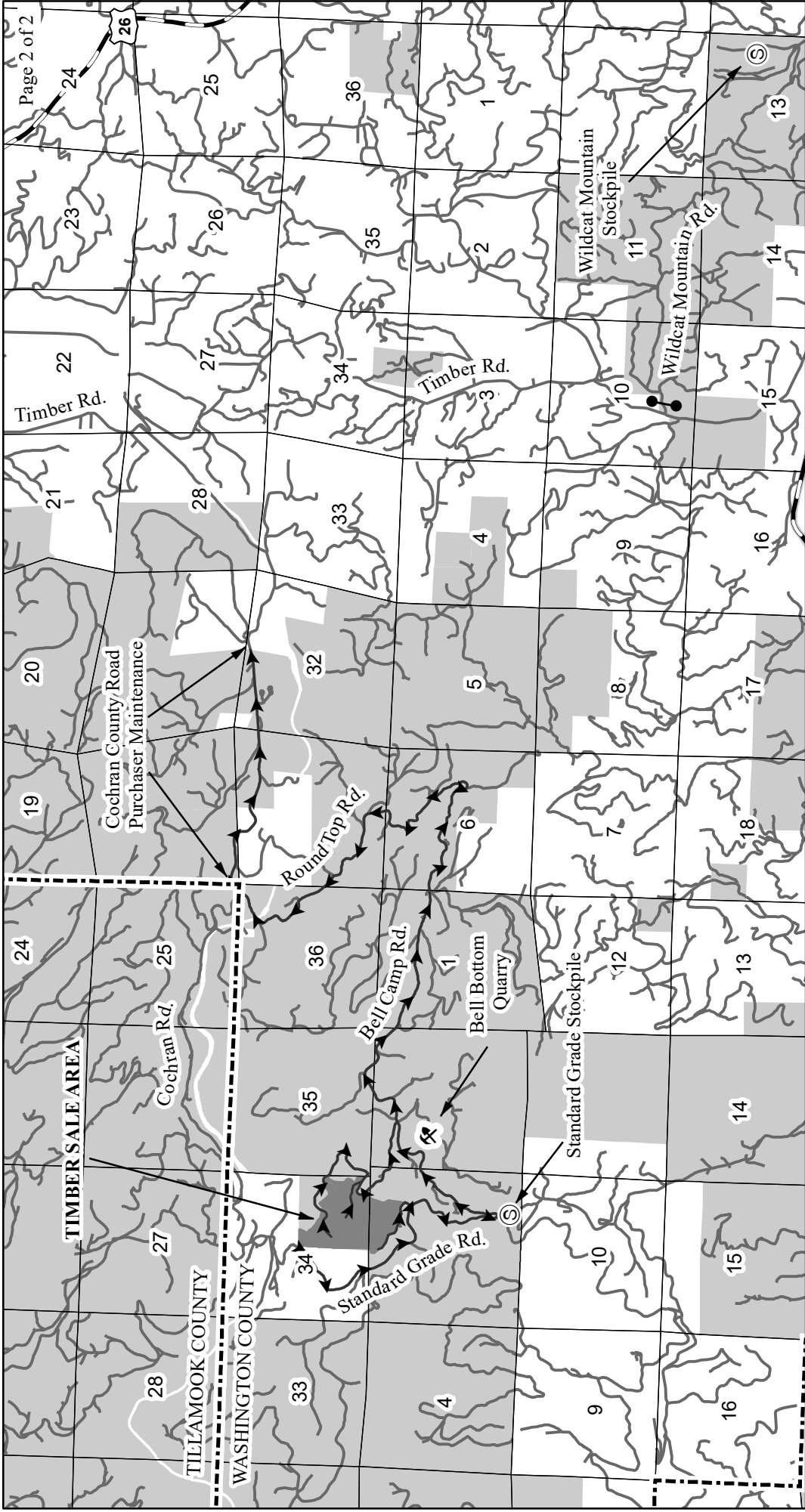

EXHIBIT A

VICINITY MAP
 FOR TIMBER SALE CONTRACT #FG-341-2021-W00260-01
 MISHMASH

PORCTIONS OF SECTIONS 34 & 35, T3N, R6W, W.M.,
 AND PORCTIONS OF SECTION 3, T2N, R6W, W.M.,
 WASHINGTON COUNTY, OREGON

Forest Grove District GIS
 August, 2020

This product is for informational use and may not be suitable for legal, engineering, or surveying purposes.

1:63,360

1 inch = 1 mile

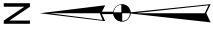

- Legend**
- Timber Sale Area
 - Haul Route Road
 - Surfaced Roads
 - Highways
 - Quarry
 - Stockpile
 - Gate
 - ODF Ownership
 - County Line
 - Section Lines