

Legend

- Timber Sale Boundary
- == Right-of-Way Boundary
- | - - - ODF Ownership Boundary
- Surfaced Roads
- - - New Road Construction
- + + + + + Railroad
- Type-F Stream
- Type-N Stream
- Stream Buffer
- Green Tree Retention Area
- Section Lines

EXHIBIT A

FOR TIMBER SALE CONTRACT #FG-341-2021-W00237-01
 ROOSTER COGBURN
 PORTIONS OF SECTIONS 25 & 26, T3N, R6W, W.M.,
 TILLAMOOK COUNTY, OREGON,
 AND PORTIONS OF SECTION 35, T3N, R6W, W.M.,
 WASHINGTON COUNTY, OREGON.

Forest Grove District GIS
 March, 2021

This product is for informational use and may not be
 suitable for legal, engineering, or surveying purposes.



1:12,000
 1 inch = 1,000 feet

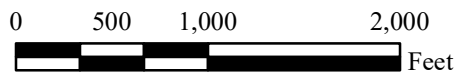

APPROXIMATE NET ACRES

UNIT 1	89 ACRES (MC)
UNIT 2	1 ACRES (R/W)
TOTAL	90 ACRES

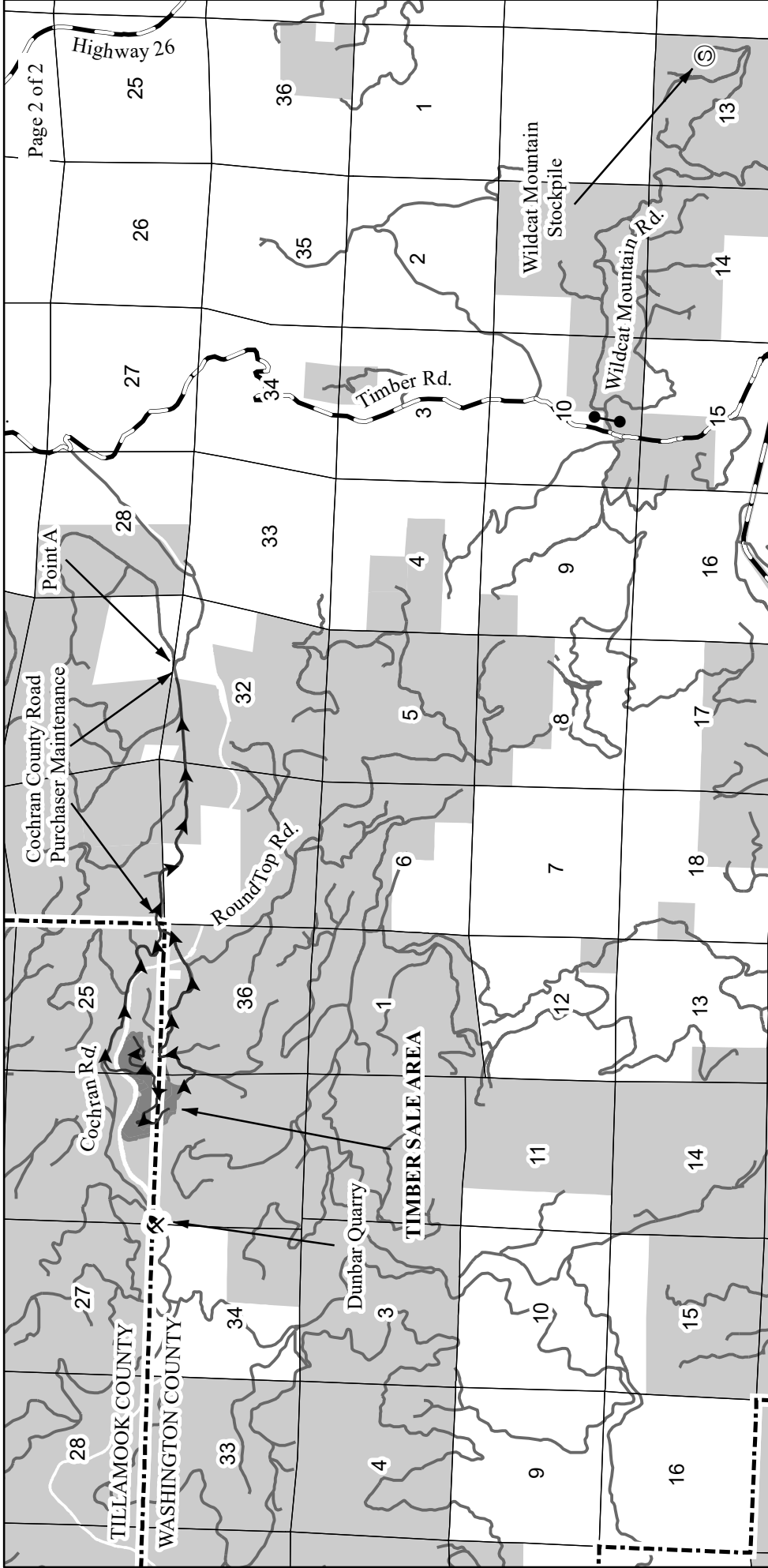

EXHIBIT A

VICINITY MAP
 FOR TIMBER SALE CONTRACT #FG-341-2021-W00237-01
 ROOSTER COGBURN
 PORTIONS OF SECTIONS 25 & 26, T3N, R6W, W.M.,
 TILLAMOOK COUNTY, OREGON,
 AND PORTIONS OF SECTION 35, T3N, R6W, W.M.,
 WASHINGTON COUNTY, OREGON

Forest Grove District GIS
 March, 2021
 This product is for informational use and may not be
 suitable for legal, engineering, or surveying purposes.

1:63,360
 1 inch = 1 mile



- Legend**
- Timber Sale Area
 - Haul Route Road
 - Highways
 - Surfaced Roads
 - Quarry
 - Stockpile
 - Gates
 - ODF Ownership
 - County Line
 - Section Lines

