

EXHIBIT "A"

MAP OF TIMBER SALE CONTRACT

NO. 341-2021-W00818-01

BUCK SHOT

PORTIONS OF SECTIONS 24 AND 25 OF

T5N, R6W, W.M.,

CLATSOP COUNTY, OREGON

1 inch = 1 mile

0 0.5 1 2 Miles

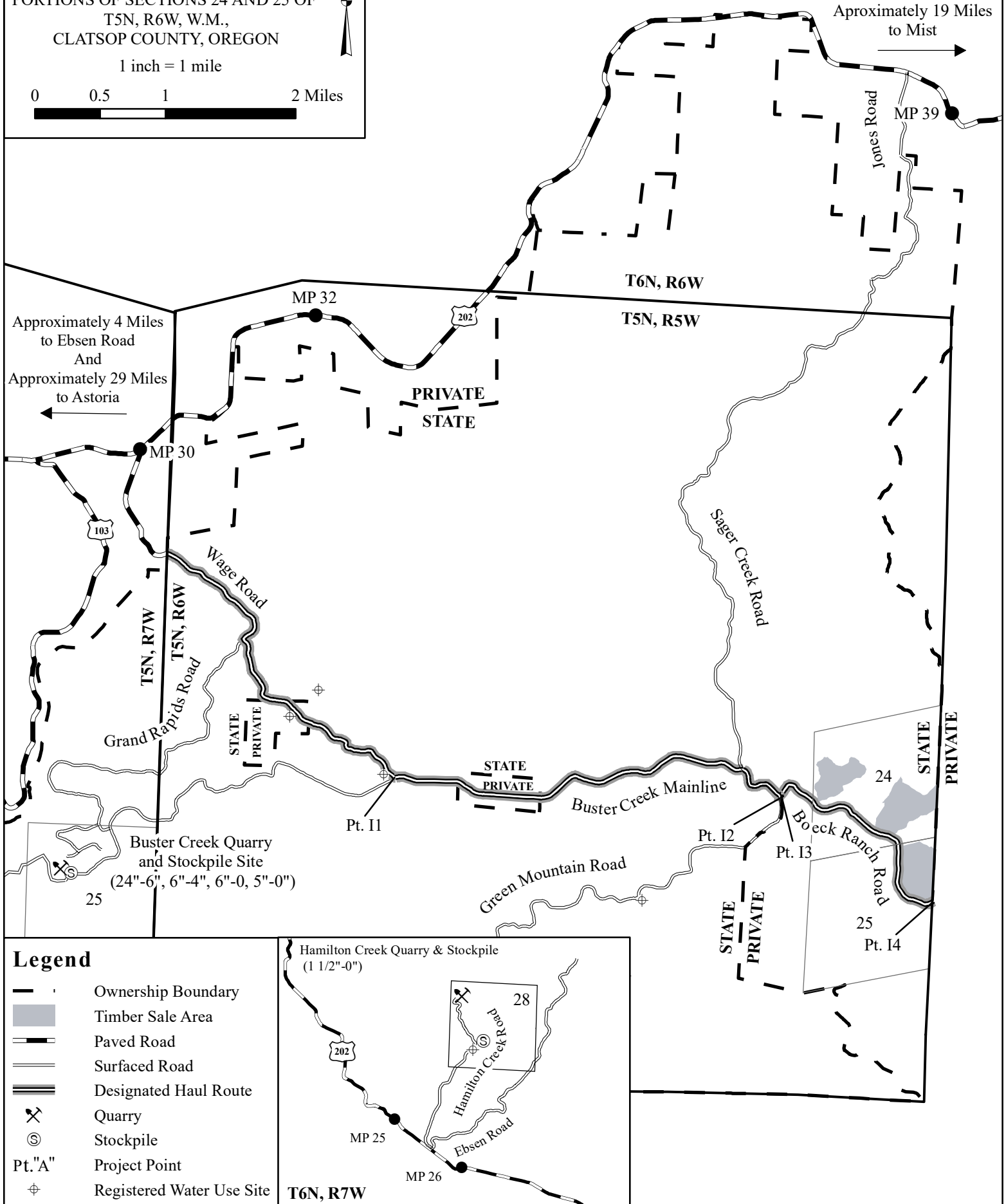

EXHIBIT "A"

MAP OF TIMBER SALE CONTRACT
NO. 341-2020-W00818-01
BUCK SHOT
PORTIONS OF SECTIONS
24 AND 25 OF T5N, R6W, W.M.,
CLATSOP COUNTY, OREGON.

1 inch = 1,000 feet
0 250 500 1,000 Feet

Approximate Net Acres

Unit 1 (MC) =	43
Unit 2 (MC) =	67
Unit 3 (MC) =	66
Unit 4 (R/W) =	1
Total =	177



Legend

- Ownership Boundary
- Timber Sale Boundary
- Existing Road - Surfaced
- New Construction - Surfaced
- New Construction - Unsurfaced
- Right-Of-Way Boundary
- Designated Haul Route
- New Landing Construction
- Type "F" Stream
- Type "N" Stream
- Nonposted Stream Buffer
- Posted Stream Buffer
- Controlled Felling Area
- Seasonally Restricted Area
- Reforestation Area
- Survey Monument
- Pt."A" Project Point

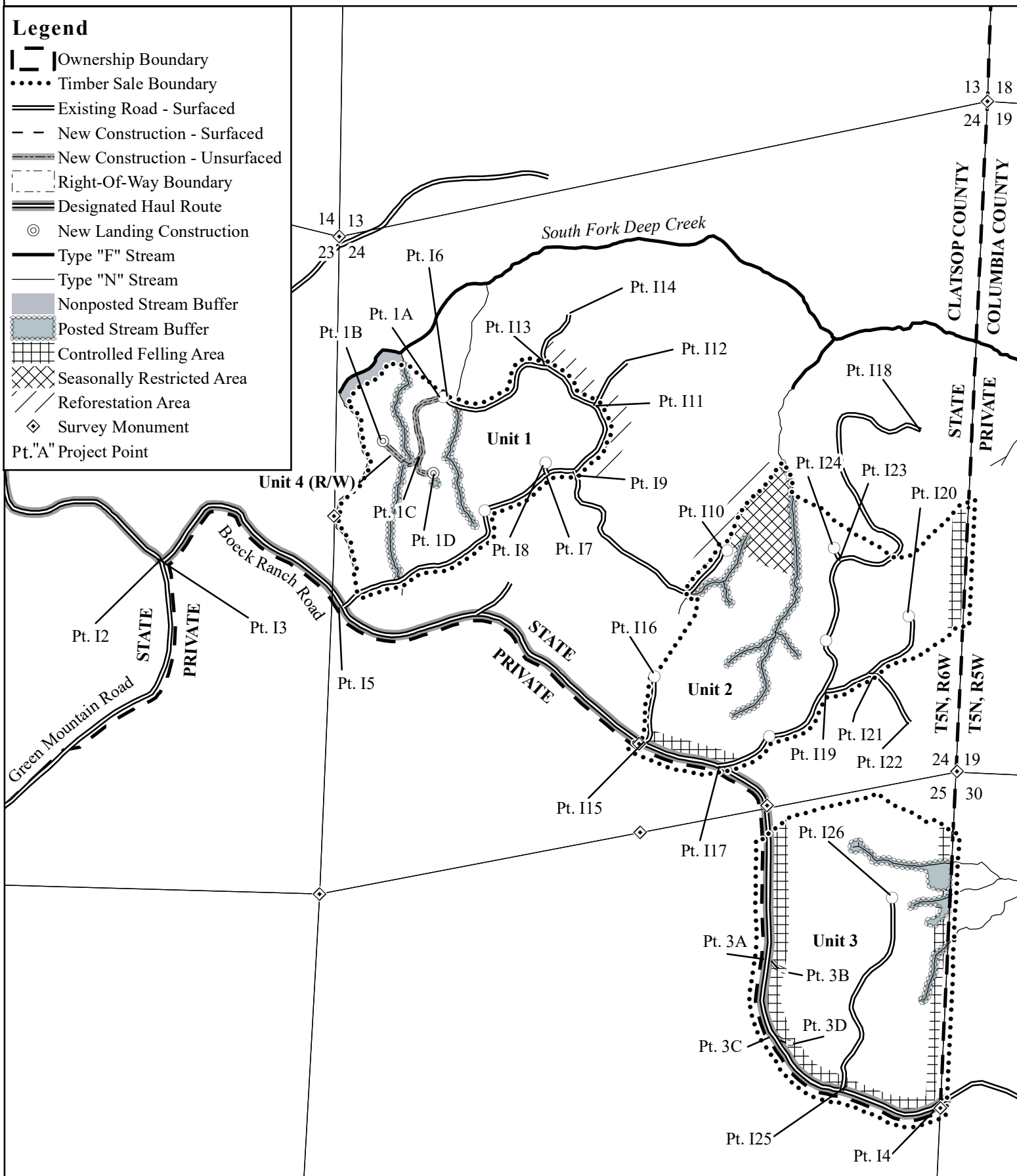

EXHIBIT "A"

ROADSIDE BRUSHING MAP
OF TIMBER SALE CONTRACT
NO. 341-2020-W00818-01
BUCK SHOT
PORTIONS OF SECTIONS
24 AND 25 OF T5N, R6W, W.M.,
CLATSOP COUNTY, OREGON.

Page 3 of 3



1 inch = 2,000 feet



LEGEND

- ODF Ownership
- Timber Sale Boundary
- Roads
- Roads to Brush
- Survey Monument

