

## Exhibit "A"

OF TIMBER SALE CONTRACT NO. 341-2019-W00768-01  
KENNEDY RIDGE  
PORTIONS OF SECTIONS 25 & 26, T33S, R6W, W.M.  
JOSEPHINE COUNTY, OREGON

TOTAL NET ACRES = 85

0 500 1,000 2,000  
Feet

1 inch = 1,000 feet

This product is for informational use  
and may not have been prepared  
for or be suitable for legal, engineering  
or surveying purposes. Users of this information should  
review or consult the primary data and information  
sources to ascertain the usability of this information.



"STEWARDSHIP IN FORESTRY"

### Legend

- Timber Sale Boundary
- ODF Ownership**
- BOF (Board of Forestry)
- Roads**
- All weather
- - - Dirt
- Interstate
- Paved
- - - New Road Construction
- Green Tree Retention
- Streams**
- Fish
- Nonfish
- Stream Buffer
- + Project Points
- ⊙ Landing to Construct
- ⊙ Potential Waste Areas
- Gas Line

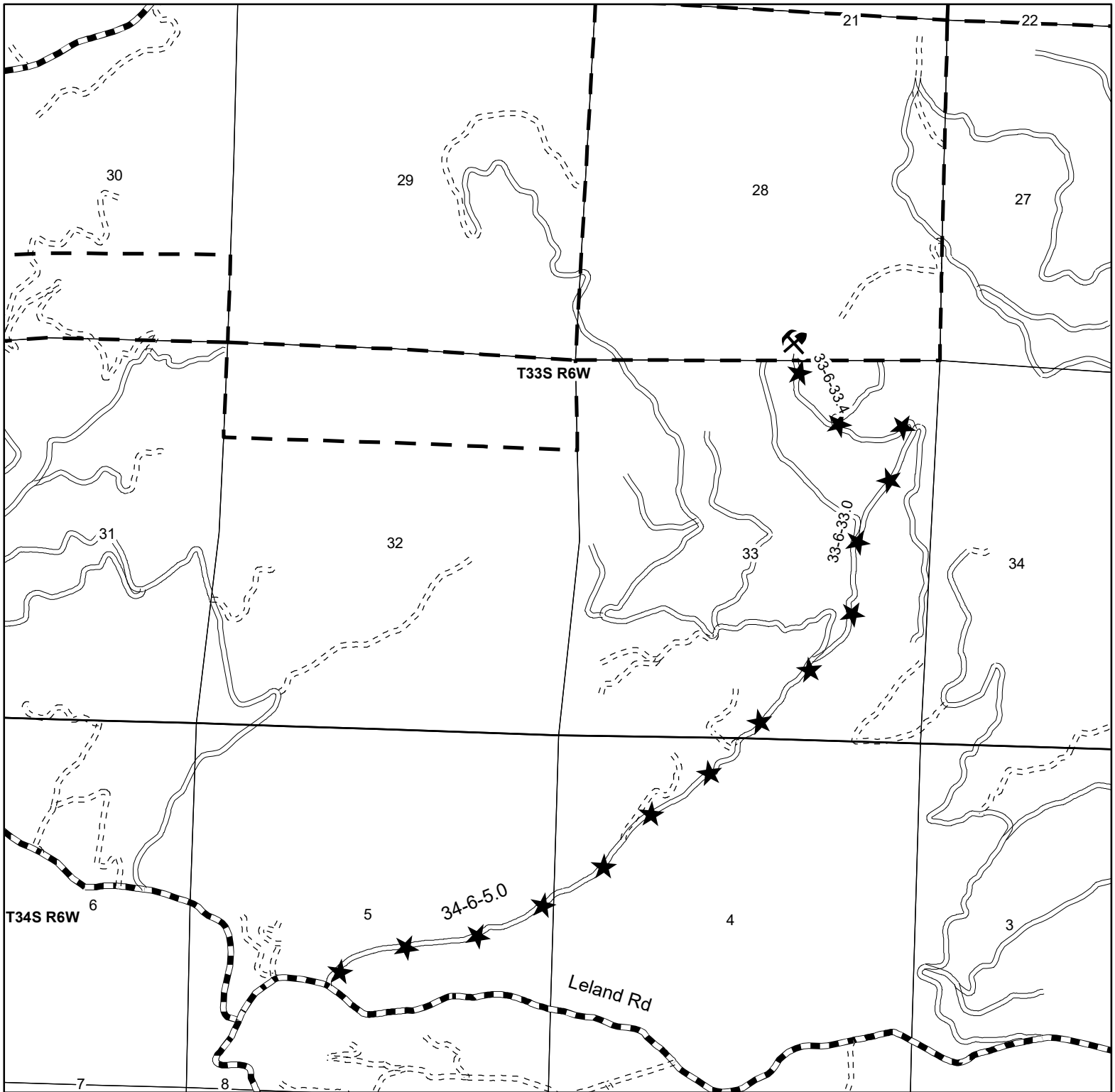

**Legend**

★ Haul Route

⚒ Rock Pits

**ODF Ownership**

▢ BOF (Board of Forestry)

**Roads**

== All weather

=== Dirt

▣ Paved

**Exhibit "A"**  
**London Quarry**  
 OF TIMBER SALE CONTRACT NO. 341-2019-W00768-01  
 KENNEDY RIDGE  
 PORTIONS OF SECTIONS 25 & 26, T33S, R6W, W.M.  
 JOSEPHINE COUNTY, OREGON

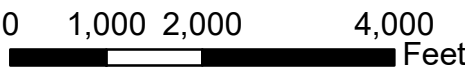

1 inch = 2,000 feet

This product is for informational use  
 and may not have been prepared  
 for or be suitable for legal, engineering  
 or surveying purposes. Users of this information should  
 review or consult the primary data and information  
 sources to ascertain the usability of this information.



"STEWARDSHIP IN FORESTRY"

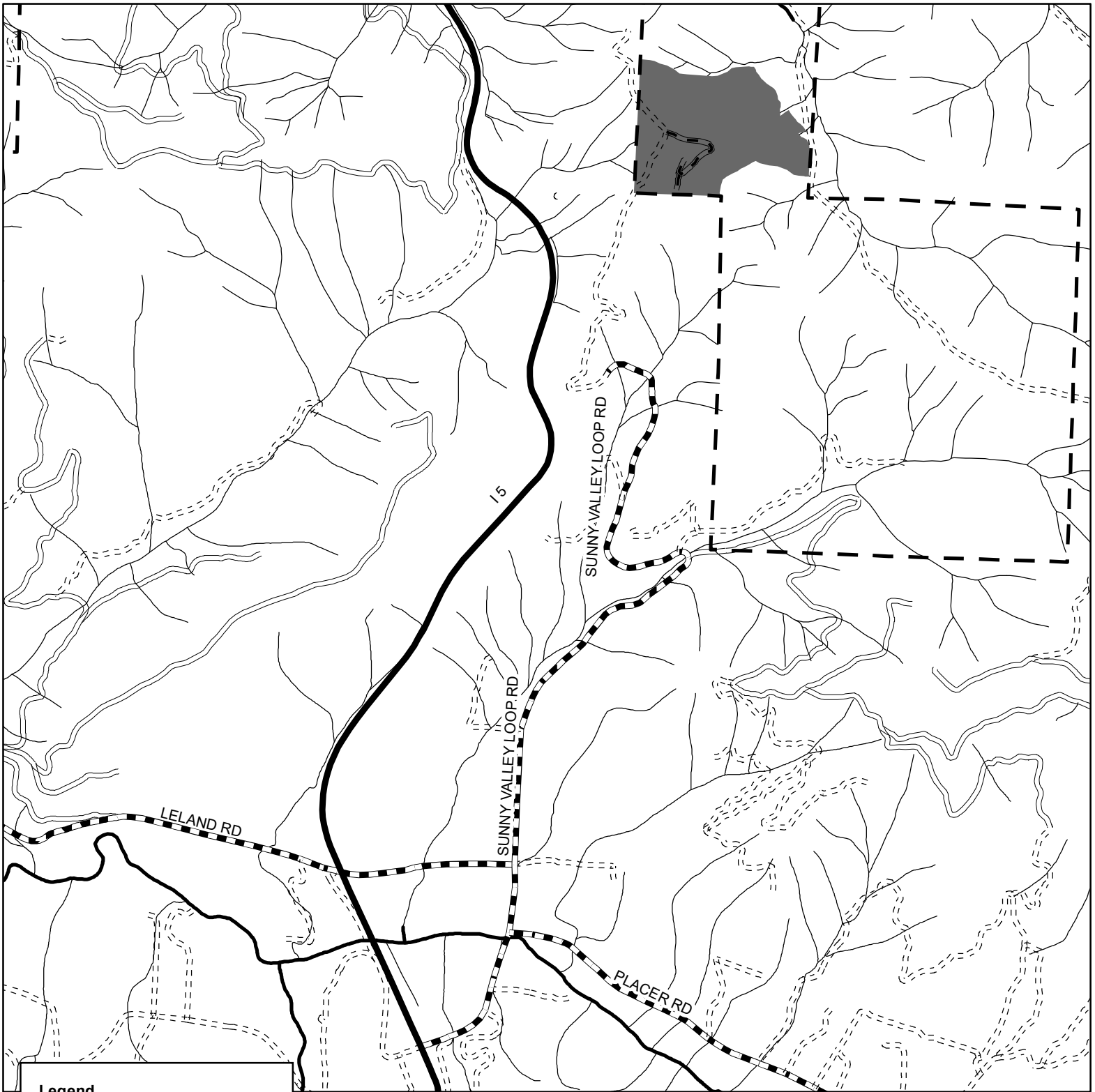

## Vicinity Map

OF TIMBER SALE CONTRACT NO. 341-2019-W00768-01  
KENNEDY RIDGE  
PORTIONS OF SECTIONS 25 & 26, T33S, R6W, W.M.  
JOSEPHINE COUNTY, OREGON

0 1,000 2,000 4,000  
Feet

1 inch = 2,000 feet

This product is for informational use  
and may not have been prepared  
for or be suitable for legal, engineering  
or surveying purposes. Users of this information should  
review or consult the primary data and information  
sources to ascertain the usability of this information.



"STEWARDSHIP IN FORESTRY"

### Legend

BOF (Board of Forestry)

### Roads

All weather

Dirt

Interstate

Paved

New Road Construction

Timber Sale Boundary

### Streams

Fish

Nonfish