

EXHIBIT A

Timber Sale Contract No. 341-18-83

ROCKY ROAD

Portions of Sections 26, 27, 33, 34, & 35, T2S, R7W, and
Portions of Sections 1, 2, & 12, T3S, R7W, W.M.,

Tillamook County, Oregon

1,000 0 1,000 Feet



Tillamook District GIS
10/3/2017

This product is for informational use and may not have been prepared or suitable for legal, engineering, or surveying purposes.

Area	Type of Operation	Acres	
		Gross	Net
1	Modified Clearcut	145	113
2	Modified Clearcut	159	110
3	Modified Clearcut	119	96
4	Right of Way	41	27
Total		464	346

- Rock source
- Stock pile
- Waste area
- Bridge
- Gate
- Survey corner
- Domestic water supply intake
- Cultural site
- Buffer
- Green tree retention area
- Area boundary
- Sale boundary
- Ownership boundary
- Fish stream
- Non-fish stream
- Unsurfaced road
- Surfaced road
- Paved road
- Abandoned road
- Blocked road
- Road construction
- OHV trail
- Non-motorized trail
- Transmission line
- Railroad



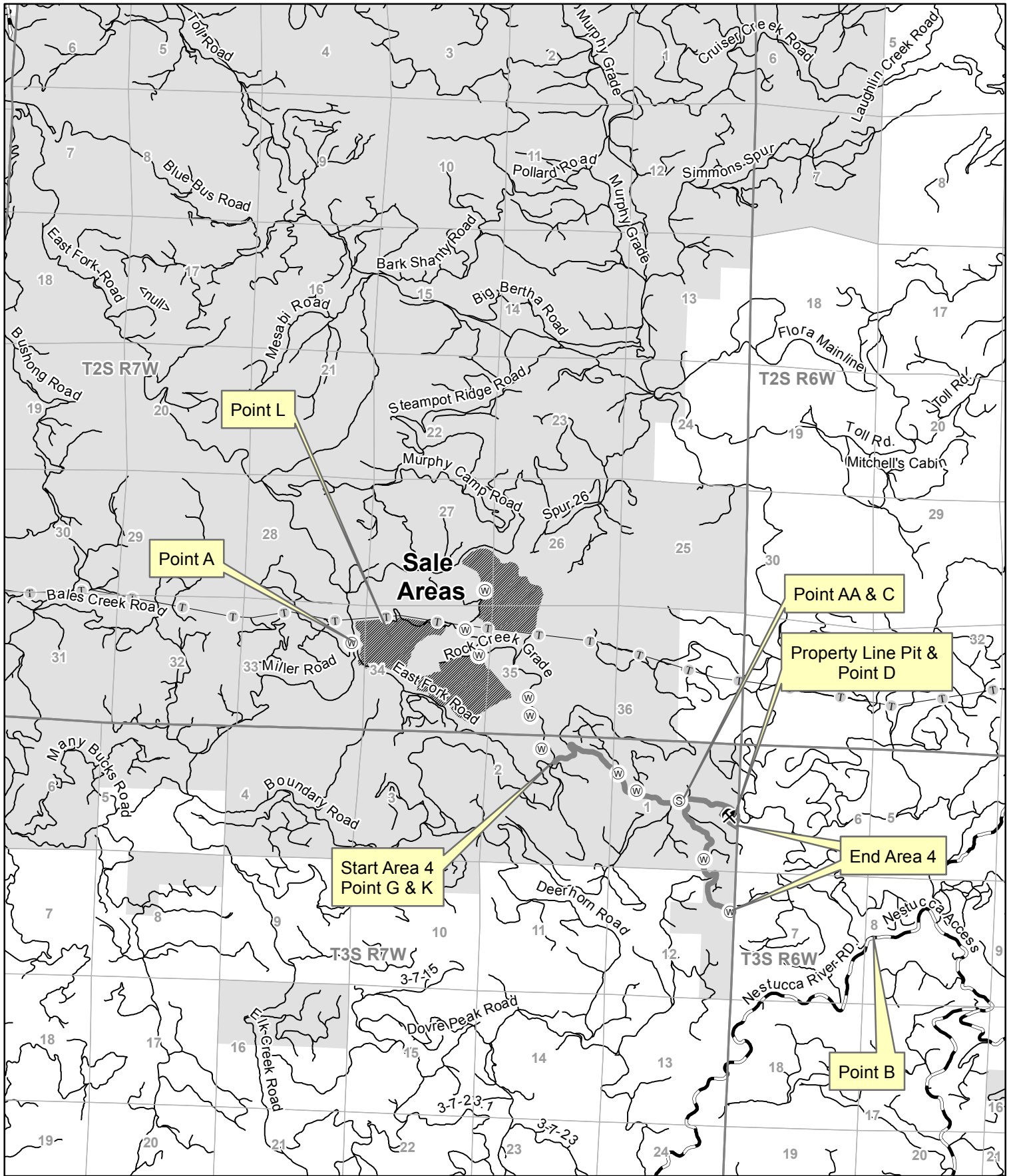

- Rock source
- Stock pile
- Waste area
- Bridge
- Gate
- ODF ownership
- R/W Harvest (Area 4)
- Major road
- Other road
- Transmission line
- Railroad
- Timber sale

EXHIBIT A - VICINITY MAP

Timber Sale Contract No. 341-18-83

ROCKY ROAD

Portions of Sections 26, 27, 33, 34, & 35, T2S, R7W, and
Portions of Sections 1, 2, & 12, T3S, R7W, W.M.,

Tillamook County, Oregon

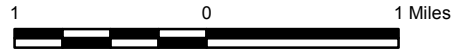

Tillamook District GIS
10/3/2017

This product is for informational use and may not have been prepared or suitable for legal, engineering, or surveying purposes.