

EXHIBIT "A"

Legend

Boundaries

- Timber Sale Boundary
- — State Forest Property Boundary
- == Right of Way (Posted)

Roads

- ==== Surfaced Road
- == Unsurfaced Road
- New Construction

Streams

- — · Type F Stream
- Type N Stream
- Posted Stream Buffer

- + Project Point
- ◆ Land Survey Monument
- ▨ Green Tree Retention Area

OF TIMBER SALE CONTRACT NO. 341-15-52
MILL CAT
PORTIONS OF SECTIONS 17, 18, 19 and 20, T11S, R8W,
& SECTIONS 34 & 35, T11S, R9W, W.M.,
LINCOLN COUNTY, OREGON

This product is for informational use and may not have been prepared for or be suitable for legal, engineering or survey purposes. Users of this information should review or consult the primary data and information sources to ascertain the usability of this information.

Scale

1:12,000



AREA	GROSS ACRES	NET ACRES
1 (MC)	66	47
2 (MC)	38	31
TOTAL	104	78



Created By: Blake McKinley
bmckinley@odf.state.or.us
Date: 10/01/2014

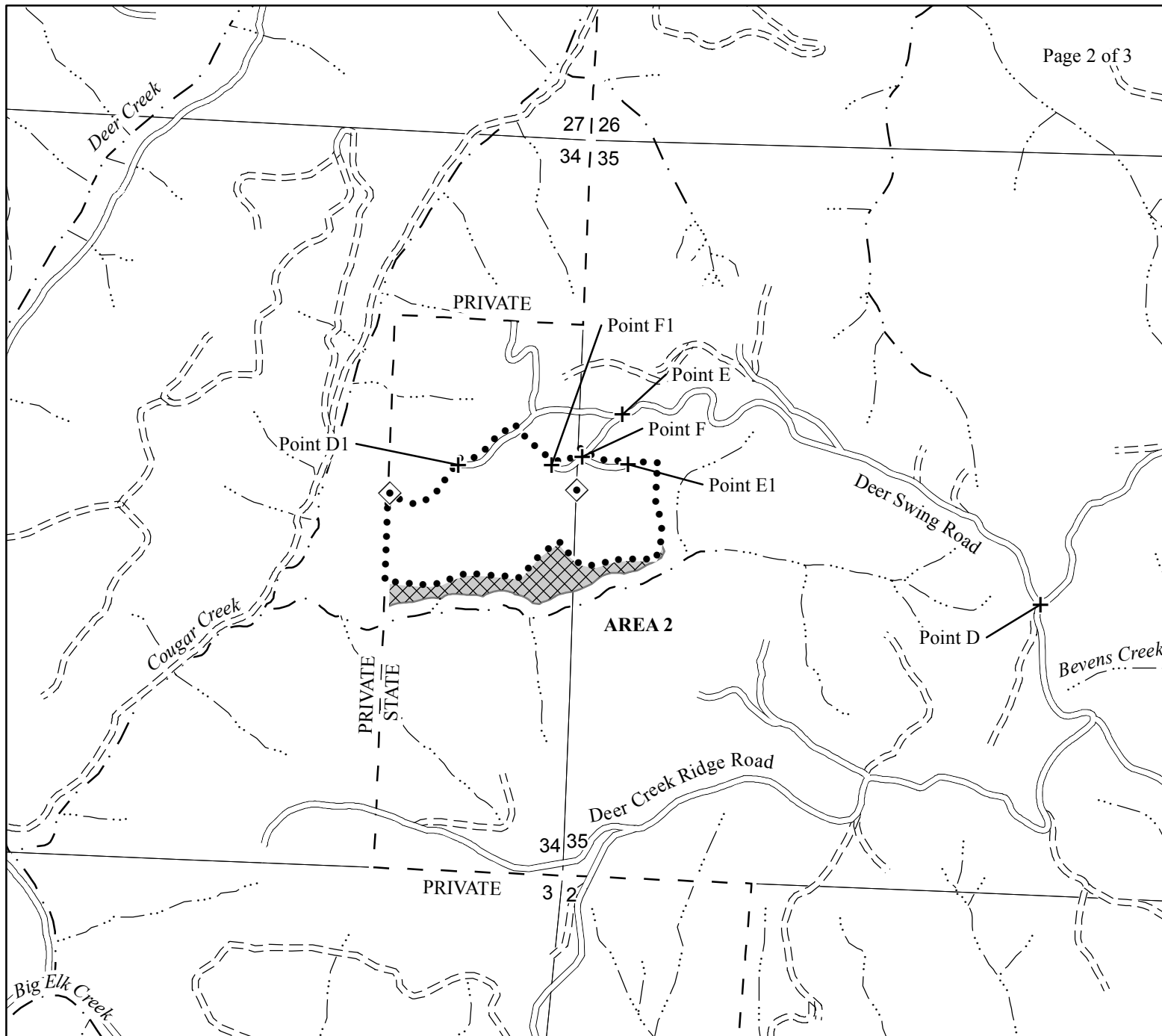

EXHIBIT "A"

Legend

- Boundaries**
- Timber Sale Boundary
 - - - State Forest Property Boundary
- Roads**
- ==== Surfed Road
 - == == Unsurfaced Road
- Streams**
- · - · Type F Stream
 - Type N Stream
- + Project Point
 - ◆ Land Survey Monument
 - ▨ Green Tree Retention Area

OF TIMBER SALE CONTRACT NO. 341-15-52
MILL CAT
PORTIONS OF SECTIONS 17, 18, 19 and 20, T11S, R8W,
& SECTIONS 34 & 35, T11S, R9W, W.M.,
LINCOLN COUNTY, OREGON

This product is for informational use and may not have
been prepared for or be suitable for legal, engineering or
survey purposes. Users of this information should
review or consult the primary data and information
sources to ascertain the usability of this information.

Scale

1:12,000



AREA	GROSS ACRES	NET ACRES
1 (MC)	66	47
2 (MC)	38	31
TOTAL	104	78



Created By: Blake McKinley
bmckinley@odf.state.or.us
Date: 10/01/2014

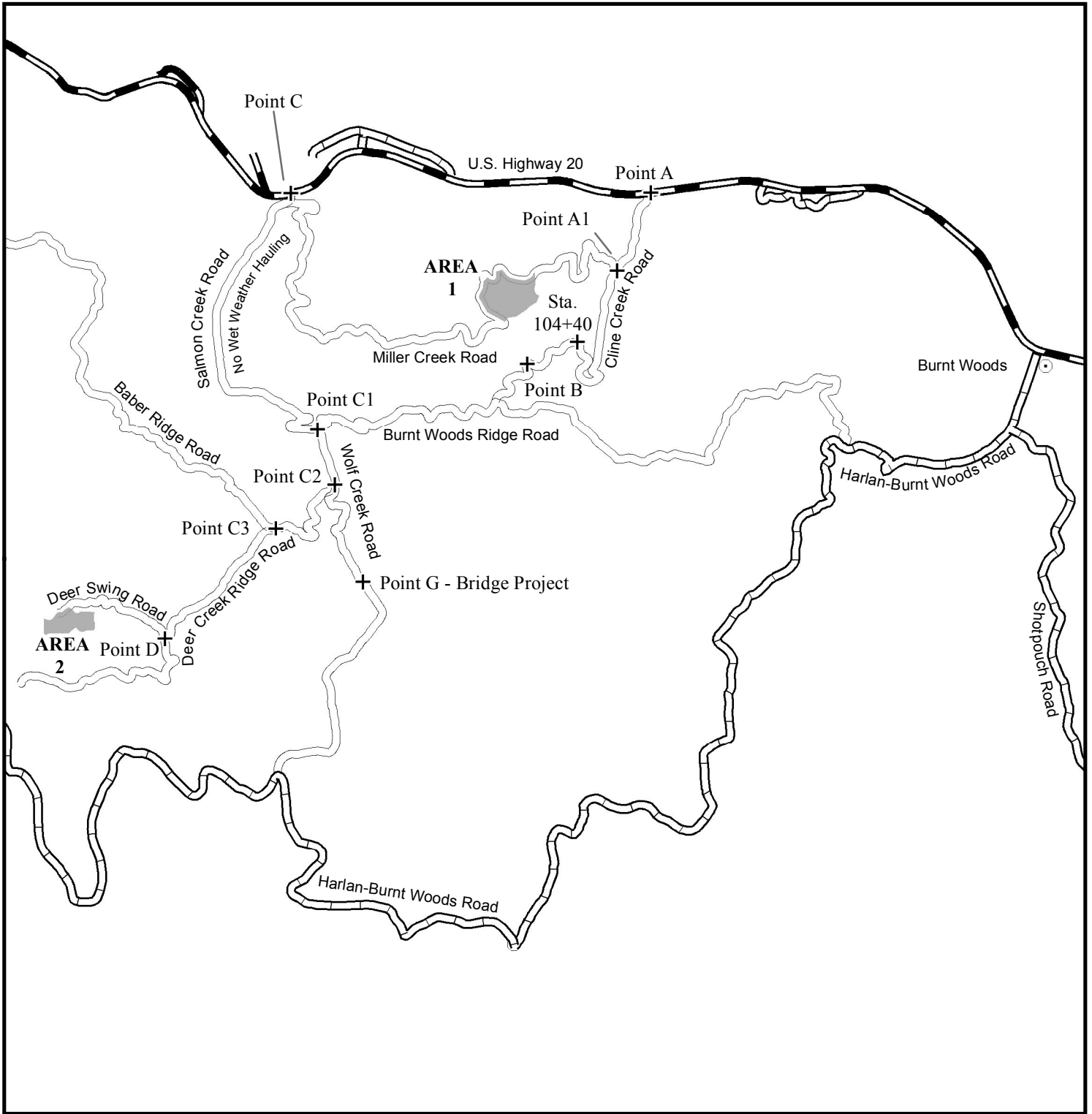

EXHIBIT "A"

VICINITY MAP OF TIMBER SALE CONTRACT NO. 341-15-52 MILL CAT LINCOLN COUNTY, OREGON

LEGEND

- + Project Point
- Towns
- - State Forest Property Boundary
- Roads
 - ▬ Highway
 - ▬▬ County Road
 - ▬▬▬ Surfaced Road
 - ▬ Sale Area

This product is for informational use
and may not have been prepared
for or be suitable for legal, engineering
or surveying purposes. Users of this information should
review or consult the primary data and information
sources to ascertain the usability of this information.

