



"STEWARDSHIP IN FORESTRY"

Timber Sale Appraisal  
Dean's Deerstand  
Sale 341-14-29

District: Coos

Date: June 26, 2013

---

**cost summary**

	Conifer	Hardwood	Total
Gross Timber Sale Value	\$164,999.16	\$4,603.23	\$169,602.39
		Project Work:	\$(4,740.00)
		Advertised Value:	\$164,862.39



"STEWARDSHIP IN FORESTRY"

Timber Sale Appraisal  
Dean's Deerstand  
Sale 341-14-29

**District:** Coos

**Date:** June 26, 2013

---

**timber description**

**Location:** Portions of Section 35, T22S, R11W, W.M., Douglas County, Oregon.

**Stand Stocking:** 60%

SpecieName	AvgDBH	Amortization (%)	Recovery (%)
Douglas - Fir	19	0	90
Western Hemlock / Fir	21	0	87
Alder (Red)	13	0	85

Volume by Grade	10" - 11"	12"+	2S	3S	3S 12"+	4S	6" - 7"	8" - 9"	Total
Douglas - Fir	0	0	364	188	20	0	0	0	572
Western Hemlock / Fir	0	0	1	1	0	0	0	0	2
Alder (Red)	8	2	0	0	0	0	11	6	27
Total	8	2	365	189	20	0	11	6	601



Timber Sale Appraisal  
Dean's Deerstand  
Sale 341-14-29

District: Coos

Date: June 26, 2013

---

comments: Pond Values Used: 2nd Quarter Calendar Year 2013.

Regeneration harvest of two units containing 32 net acres of timber. Timber is predominately 46-year-old Douglas-fir with minor amounts of red alder.

Western redcedar and Other Cedars Stumpage Price = Pond Value  
minus Logging Cost:  
 $\$546.18/\text{MBF} = \$850/\text{MBF} - \$303.82/\text{MBF}$

SCALING COST ALLOWANCE = \$5.00/MBF

FUEL COST ALLOWANCE = \$4.00/Gallon

HAULING COST ALLOWANCE  
Hauling costs equivalent to \$780 daily truck cost.

Other Costs (with Profit & Risk to be added):

FELLING:

Directional Felling = 50 MBF x \$2/MBF = \$100

YARDING & LOADING:

Brand & Paint Logs: 601 MBF x \$1/MBF = \$601

Loader Time for Firewood Stacking & Slash Piling: 4 Hours x  
\$75/hour = \$300

Slash Piling/Cull Sorting: \$200/landing x 2 landing = \$400

Cover Landing & Slash Piles w/Sheeting: 4 piles x \$50/pile = \$200

TOTAL Other Costs (with Profit & Risk to be added) = \$1,601

Other Costs (No Profit & Risk added):

None.



"STEWARDSHIP IN FORESTRY"

Timber Sale Appraisal  
Dean's Deerstand  
Sale 341-14-29

District: Coos

Date: June 26, 2013

---

**logging conditions**

**combination#:** 1      Douglas - Fir      100.00%  
                                 Western Hemlock / Fir      100.00%  
                                 Alder (Red)      100.00%

**yarding distance:** Medium (800 ft)      **downhill yarding:** No  
**logging system:** Cable: Large Tower >=70      **Process:** Stroke Delimber

**tree size:** Mature / Partial Cut (900 Bft/tree), 3-5 logs/MBF

**loads / day:** 7.0      **bd. ft / load:** 3,800

**cost / mbf:** \$143.86

**machines:** Log Loader (A)  
                 Stroke Delimber (A)  
                 Tower Yarder (Large)



"STEWARDSHIP IN FORESTRY"

# Timber Sale Appraisal Dean's Deerstand Sale 341-14-29

**District: Coos**

**Date: June 26, 2013**

## logging costs

<b>Operating Seasons:</b>	1.00	<b>Profit Risk:</b>	20.00%
<b>Project Costs:</b>	\$4,740.00	<b>Other Costs (P/R):</b>	\$1,601.00
<b>Slash Disposal:</b>	\$0.00	<b>Other Costs:</b>	\$0.00

### Miles of Road

**Road Maintenance:** \$0.00

Dirt	Rock (Contractor)	Rock (State)	Paved
0.0	1.0	0.0	0.0

### Hauling Costs

Species	\$ / MBF	Trips/Day	MBF / Load
Douglas - Fir	\$0.00	2.0	3.8
Western Hemlock / Fir	\$0.00	2.0	3.8
Alder (Red)	\$0.00	2.0	3.5



"STEWARDSHIP IN FORESTRY"

Timber Sale Appraisal  
Dean's Deerstand  
Sale 341-14-29

District: Coos

Date: June 26, 2013

### logging costs breakdown

Logging	Road Maint	Fire Protect	Hauling	Other P/R appl	Profit & Risk	Slash Disposal	Scaling	Other	Total
<b>Douglas - Fir</b>									
\$143.86	\$1.12	\$7.30	\$94.08	\$2.66	\$49.80	\$0.00	\$5.00	\$0.00	\$303.82
<b>Western Hemlock / Fir</b>									
\$143.86	\$1.15	\$7.30	\$96.65	\$2.66	\$50.32	\$0.00	\$5.00	\$0.00	\$306.94
<b>Alder (Red)</b>									
\$143.86	\$1.17	\$7.30	\$106.79	\$2.66	\$52.36	\$0.00	\$5.00	\$0.00	\$319.14

Specie	Amortization	Pond Value	Stumpage	Amortized
Douglas - Fir	\$0.00	\$591.64	\$287.82	\$0.00
Western Hemlock / Fir	\$0.00	\$490.00	\$183.06	\$0.00
Alder (Red)	\$0.00	\$489.63	\$170.49	\$0.00



"STEWARDSHIP IN FORESTRY"

Timber Sale Appraisal  
Dean's Deerstand  
Sale 341-14-29

District: Coos

Date: June 26, 2013

---

**summary**

**Amortized**

Specie	MBF	Value	Total
Douglas - Fir	0	\$0.00	\$0.00
Western Hemlock / Fir	0	\$0.00	\$0.00
Alder (Red)	0	\$0.00	\$0.00

**Unamortized**

Specie	MBF	Value	Total
Douglas - Fir	572	\$287.82	\$164,633.04
Western Hemlock / Fir	2	\$183.06	\$366.12
Alder (Red)	27	\$170.49	\$4,603.23

**Gross Timber Sale Value**

Recovery: \$169,602.39

Prepared by: Sara Stack

Phone: 541-267-1752

## Summary of "Other Costs" for Timber Sale Appraisals

Sale Name: Dean's Deerstand

### Additional "Other Cost" with additional profit and risk to be added:

	<u>Units</u>	<u>Quantity</u>	<u>Cost/unit</u>	<u>Total Cost</u>
<b>Felling</b>				
Felling of unmerch material	Acres	0	\$ 80.00	\$ -
Directional Felling	MBF	50	\$ 2.00	\$ 100.00
<b>Yarding and Loading</b>				
Ground Based Equipment Wash (in unit)	Hours	0	\$ 65.00	\$ -
Locate Corridors and Skid Roads	MBF	0	\$ 5.00	\$ -
Artificial guyline support	anchor	0	\$ 500.00	\$ -
Brand and paint logs	MBF	601	\$ 1.00	\$ 601.00
Slash piling and cull sorting on landings	landing	2	\$ 200.00	\$ 400.00
Cover landing slash piles with sheeting	pile	4	\$ 50.00	\$ 200.00
Rig lift trees	per tree	0	\$ 100.00	\$ -
Loader time for firewood stacking	per hour	4	\$ 75.00	\$ 300.00
<b>Snag Creation</b>				
Tree Topping	Trees	0	\$ 100.00	\$ -
Tree Girdling (DBH)	Trees	0	\$ 50.00	\$ -
Tree Girdling (Topping Height)	Trees	0	\$ 125.00	\$ -
<b>Miscellaneous Costs</b>				
Fish Log Stockpile: Yarding & Decking	per MBF	0	\$62.00	\$0.00
Fish Log Stockpile: Special Handling	per MBF	0	\$8.00	\$0.00
Log Placement in Stream	Crossings	0	\$ -	
Additional Fire Equipment	Seasons	0	\$ 1,000.00	\$ -
Maintenance rock per section 5	Cubic Yards	0	\$ 18.00	\$ -
Safety Flagging and/or signing	per day	0	\$ 110.00	\$ -
Rubber-tired back hoe move-in for clean up	hour	0	\$ 100.00	\$ -
Rubber-tired back hoe time for clean up	hour	0	\$ 100.00	\$ -

**Total additional "Other Cost" with additional profit and risk to be added**

**\$ 1,601.00**

### Additional "Other Cost" with no additional profit and Risk

	<u>Units</u>	<u>Quantity</u>	<u>Cost/unit</u>	<u>Total Cost</u>
Log Placement in Stream				
Non-required road construction	Stations			\$ -
Non-required road rocking	Cubic Yards			\$ -
Stream clearance	Feet			\$ -
Scaling (high piece count)	MBF		\$ 1.00	\$ -
<b>Road Easements:</b>				
	MBF			\$ -
	MBF			\$ -
	MBF			0

**Total additional "Other Cost" with no additional profit and Risk**

**\$ -**



# Operating Periods Restrictions Matrix for Dean's Deerstand 341-14-29

Harvesting	January	February	March	April	May	June	July	August	September	October	November	December
			1st	1st	15th	16th	7th	5th	15th	14th	15th	
Ground-based Yarding												
Cable Yarding on unsurfaced roads												
Cable Yarding on rocky roads												
Cable Yarding in seasonally restricted areas												
Cable Yarding in Logging Restricted areas												
Felling												

Hauling	January	February	March	April	May	June	July	August	September	October	November	December
			1st	1st	15th	16th		5th	15th	15th		
Log Hauling on Unsurfaced Roads												

Project Work	January	February	March	April	May	June	July	August	September	October	November	December
			1st	1st	15th	16th		5th	15th	15th		
Non-Project Roads and Landings												
Projects 1 & 2												



Operations Allowed



Activity Restricted 2 hours before  
sunset through 2 hours after sunrise



Operations Prohibited - T & E



Operations Prohibited for weather conditions: unless otherwise  
approved in writing by STATE, or if PURCHASER complies with  
Winter and Wet Weather Option

# TIMBER SALE SUMMARY

Dean's Deerstand

1. **Type of sale:** Final harvest, Recovery, Sealed Bid.
2. **Boundary Lines:** The boundaries of Areas 1 and 2 are marked on the ground with "Timber Sale Boundary" posters, red paint, and red flagging at locations shown on the Exhibit "A."
3. **Revenue Distribution:** 100% CSL; 100% Douglas County.
4. **Sale Acreage:** The total sale area is approximately 32 net acres. Stream buffer areas are posted outside the sale area and are not included in the net acres calculation. Existing interior roads and non-stocked areas were excluded from the cruise acres. The acreage was determined by electronic digitizing using 2009 Lidar, GPS waypoints, and Arc 10 GIS.

	<b>Posted Acres</b>	<b>Interior Road Acres</b>	<b>Non-Stocked Acres</b>	<b>Net Cruise Acres</b>	<b>Net Harvest Acres</b>
<b>Sale Area</b>	33.2	.93	1.69	30.5	32.2

## 5. Volume by Species, Fund, and County:

<b>Species</b>	<b>Total Volume (MBF)</b>	<b>Volume per Acre (MBF)</b>
<b>Douglas fir</b>	572	18
<b>Western hemlock</b>	2	<1
<b>Red alder</b>	27	<1
<b>Total</b>	601	19

## 6. Grade by Percent:

<b>Species</b>	<b>3 Peeler</b>	<b>Special Mill</b>	<b>2 Saw (12+\" Hardwood)</b>	<b>3 Saw (10\"-11\" Hardwood)</b>	<b>4 Saw (8\"-9\" Hardwood)</b>	<b>(6\"-7\" (Hardwood)</b>	<b>Big 3 Saw</b>
Douglas-fir	----	----	64%	33%	0%	----	3%
Hardwoods (Red Alder)	----	----	----	66%	34%	----	----
Western Hemlock	----	----	66%	28%	----	----	----

7. **Grading System:** All trees were graded according to the Southern Oregon Log Scaling and Grading Rules. Trees were cruised to maximize grade (i.e. 20 foot 2 saw), where possible. Timber sale volume was calculated using logs as cruised.

- 8. Cruise:** The sale was variable plot cruised in the spring of 2013 by ODF foresters using the Big BAF cruise design. Each plot consisted of both a full 20 BAF count plot and a full 160 BAF measure plot. The 20 BAF count plot was used to tally the number of trees by species to determine the stand basal area. The 160 BAF cruise plot was used to select Douglas-fir trees for measurement.

A total of 49 nested plots and 53 Douglas-fir measure trees were cruised for diameter, total height, grade, and defect. Cruise plots were spaced 75 feet apart, and cruise lines were spaced 365 feet apart. Cruise data was compiled using the SuperACE cruising program.

**A. Cruise Summary Data:**

Diameter	Top Diameter	Form Point	Form Factor	CV %	SE %
BH	Total Height or Top Count Diameter	All species: 4.5'	Estimated or measured on all trees	50.9	7.27

**B. Stand Summary:**

Species	DBH	Trees per Acre	Basal Area (ft <sup>2</sup> /ac)	MBF per acre
Douglas-fir	19	85	148	18
Hardwoods (Red Alder)	13	21	18	1
Western Hemlock	21	<1	<1	< 1

**C. Green Tree Retention Summary:** Green trees were posted both inside and outside of the timber sale area. There are a few individually marked GTR trees scattered singly and in small groups in Areas 1 and 2, and grouped GTR trees throughout the timber sale's stream buffers.

GTR Area	D-fir Count	D-fir MBF removed from cruise	Hemlock /Cedar Count	Hemlock/ Cedar MBF removed from cruise	Hdwd Count	Hdwd MBF removed from cruise
Intermittent Stream Buffers / Perennial Stream Buffer Extensions	166	---	---	---	177	---
Scattered Upland Individuals and Pods	15	3	---	---	0	0
TOTALS	181	3	---	---	177	0

**D. Defect and Breakage Summary (By Percent):**

Species	Cruised Defect	Hidden Defect	Breakage	Total %
Douglas-fir	4	6	4	14
Hardwoods (Red Alder)	10	7	8	25
Western Hemlock	0	5	6	11

**E. Downed Wood Summary:** The timber sale requires leaving 3-6 logs/acre across the sale. Purchaser will meet the requirement by utilizing defect and breakage of downed wood. Additional volume may come from leaving tops in the unit not to exceed 6 logs/acre.

**8. Timber Description:** The timber sale is comprised of 46 year-old Douglas-fir saw timber with minor amounts of red alder. The Douglas-fir ranges from 60 to 120 feet tall, while hardwoods are 40 to 80 feet in height.

**9. Topography:** The sale area ranges from 10% to 90% slope on primarily north and west facing slopes.

**10. Logging Method:** The sale will be 100% cable logged uphill with single-end suspension over the unit; full suspension will be required over designated streams and RMAs. Lift and tail trees may need to be placed for yarding the sale area as approved in the operations plan. The sale has been designed to be harvested from three landings situated on the 5000 road and the 2640 road. The sale is planned for summer access; however, a wet weather option is available.

**11. Access:** From Coos Bay travel North on Highway 101 for 17 miles to Lakeside. From Lakeside proceed approximately 5 miles on North Lake Road to the 4000 road. Follow the 4000 road 7.5 miles to the 2000 road, then proceed approximately 2 miles north to the 5000 road. Area 1 is directly adjacent to the intersection of the 5000 and 2000 roads. Area 2 is an additional 1/3<sup>rd</sup> of a mile north on the 2000, behind the gate on the 2640 road. (See Exhibit "A")

**12. Projects:**

Project No. 1: Landing Construction

Project No. 2: Landing Improvement

## CRUISE VOLUME COMPUTATION REPORT

SALE NAME:	Dean's Deerstand	DATE:	07/09/2013
LEGAL LOCATION:	Secs. 35, T22S, R11W	BY:	S. Stack
	WM. Douglas County, OR		

### FIELD CULL PERCENTAGE

#### Areas 1 & 2

Species	Doug-fir	Hemlock	Hardwds
Field cull	0.04	0	0.1

### NET FIELD VOLUME MBF (Gross vol. less field cull)

SPECIES>>>>>	Doug-fir	Hemlock	Hardwds	TOTAL
<b>Areas 1 &amp; 2</b>	639	2	32	673
less GTR vol	3	0	0	3
less fish log stockpile	0	0	0	
<b>TOTAL</b>	<b>636</b>	<b>2</b>	<b>32</b>	<b>670</b>

### HIDDEN DEFECT AND BREAKAGE

Species	Doug-fir	Hemlock	Hardwds
Hidden cull	0.06	0.05	0.07
Breakage	0.04	0.06	0.08
<b>TOTAL</b>	<b>0.10</b>	<b>0.11</b>	<b>0.15</b>

### NET VOLUME BY MBF BY AREA

SPECIES>>>>>	Doug-fir	Hemlock	Hardwds	TOTALS
<b>Areas 1 &amp; 2</b>	572	2	27	601
<b>TOTALS</b>	<b>572</b>	<b>2</b>	<b>27</b>	<b>601</b>

### NET VOLUME BY GRADE AND MBF

Grade >>>>>>>>>>	2PEE	3PEE	S.M.	2SAW (12"+)	3SAW (10"-11")	Big 3 SAW	4SAW (8"-9")	(6"-7")	check
<b>Areas 1 &amp; 2</b>									
Doug-Fir	0	0	0	364	188	20	0	0	572
Hemlock	0	0	0	1	1	0	0	0	2
Alder	0	0	0	2	8	0	6	11	27

601

### GRADE DISTRIBUTION BY PERCENT

Grade >>>>>>>>>>	2PEE	3PEE	S.M.	2SAW (12"+)	3SAW (10"-11")	Big 3 SAW	4SAW (8"-9")	(6"-7")	check
<b>Areas 1 &amp; 2</b>									
Doug-fir	0%	0%	0%	64%	33%	3%	0%	0%	100%
Hemlock	0%	0%	0%	50%	50%	0%	0%	0%	100%
Alder	0%	0%	0%	6%	28%	0%	22%	44%	100%

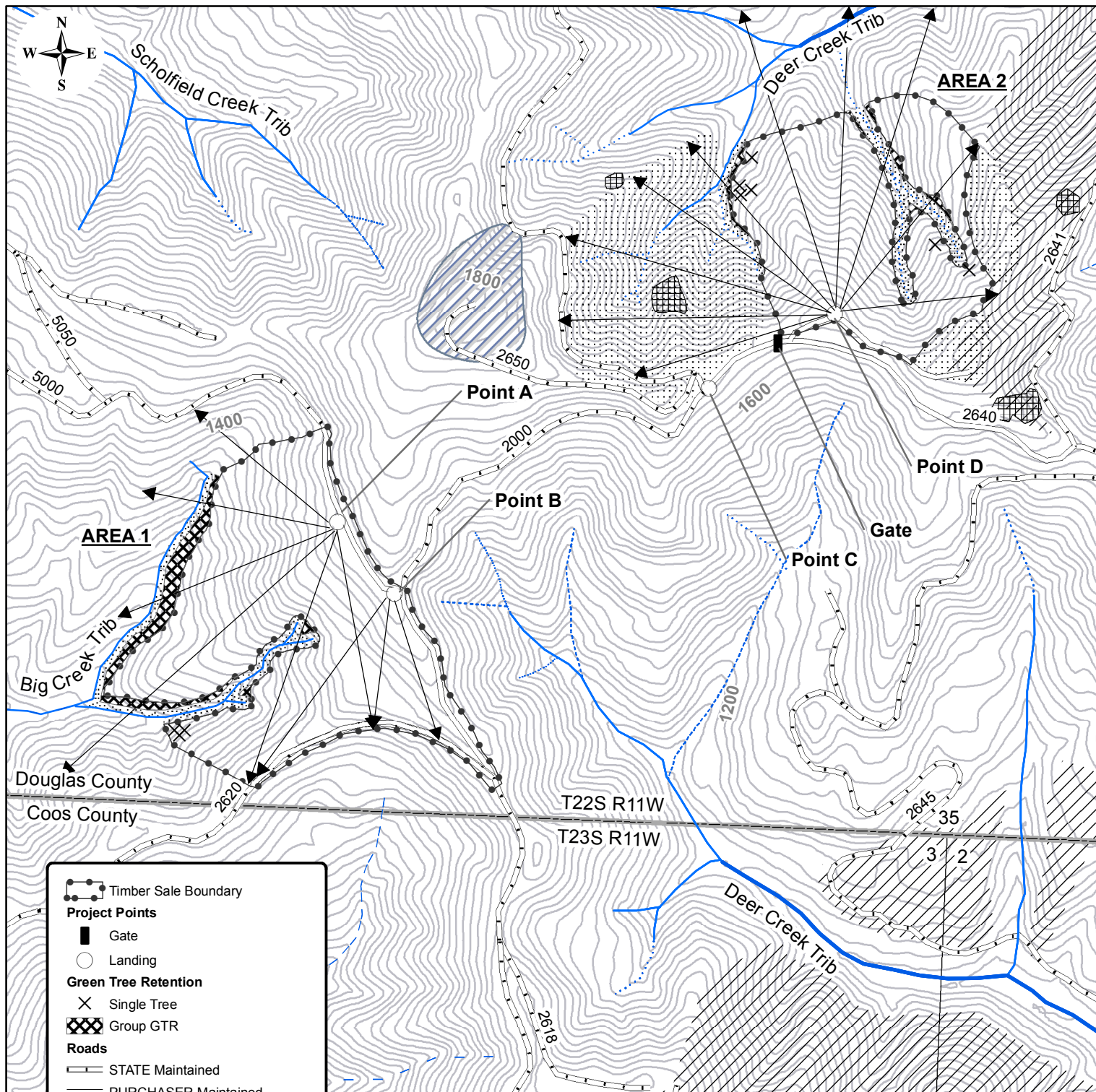

## LOGGING PLAN

OF TIMBER SALE CONTRACT NO. 341-14-29  
 DEAN'S DEERSTAND  
 LOCATED IN PORTIONS OF SECTION 35  
 T22S, R11W WM  
 DOUGLAS COUNTY, OREGON  
 REGULATED USE AREA CS-1

Sale Area	Harvest Type	Net Acres
1	clearcut	19
2	clearcut	13
Total - 32 Harvest Acres		

1 inch = 500 feet

0 250 500 1,000 1,500 2,000 Feet

This product is for informational use and may not have been prepared for, or be suitable for use in, legal or surveying purposes.