

# PART III: EXHIBITS

State Timber Sale Contract  
No. 341-14-05  
Little Beaver Creek

EXHIBIT B

Page 1 of 3  
629-Form 341-203  
Revised 06/97

## OREGON DEPARTMENT OF FORESTRY

### TIMBER SALE OPERATIONS PLAN

(See Page 2 for instructions)

Date Received by STATE: \_\_\_\_\_

(5) State Brand Information (complete):



(1) Contract No.: 341-14-05

(2) Sale Name: Little Beaver Creek

(3) Contract Expiration Date: October 31, 2016

Project Completion Dates: \_\_\_\_\_

(4) Purchaser: \_\_\_\_\_

(6) Purchaser Representatives:

Projects: _____	Phone: _____	Cell/Other Phone: _____	Home: _____
Projects: _____	Phone: _____	Cell/Other Phone: _____	Home: _____
Projects: _____	Phone: _____	Cell/Other Phone: _____	Home: _____
Projects: _____	Phone: _____	Cell/Other Phone: _____	Home: _____
Logging: _____	Phone: _____	Cell/Other Phone: _____	Home: _____
Logging: _____	Phone: _____	Cell/Other Phone: _____	Home: _____
Logging: _____	Phone: _____	Cell/Other Phone: _____	Home: _____
Logging: _____	Phone: _____	Cell/Other Phone: _____	Home: _____

(7) State Representatives:

Projects: _____	Phone: _____	Cell/Other Phone: _____	Home: _____
Logging: _____	Phone: _____	Cell/Other Phone: _____	Home: _____

(8) Name of Subcontractors & Starting Dates:

Projects: No(s) _____ - _____	Date: _____	Phone: _____
No(s) _____ - _____	Date: _____	Phone: _____
No(s) _____ - _____	Date: _____	Phone: _____
No(s) _____ - _____	Date: _____	Phone: _____
Logging: Felling _____	Date: _____	Phone: _____
Yarding: _____	Date: _____	Phone: _____

(9) Comments: \_\_\_\_\_  
\_\_\_\_\_  
\_\_\_\_\_  
\_\_\_\_\_  
\_\_\_\_\_

(10) Operations Map: Attach a copy of timber sale Exhibit A or other suitable map which plainly shows the items listed on the instruction sheet.

EXHIBIT B

INSTRUCTION SHEET FOR OPERATIONS PLAN

**SUBMIT ONE COPY OF PLAN TO STATE**

Operations shall be limited to the work shown in the plan until a revised plan or supplemental plan is submitted covering additional work. Compliance with this plan is not in lieu of compliance with any federal requirements related to the federal Endangered Species Act. If STATE has prepared a required Forest Practices Act (FPA) "Written Plan" for operations, PURCHASER shall comply with all provisions of the Written Plan.

**Explanation of Item No. (from Page 1)**

- (5) All sales require you to use a brand furnished by STATE. If the State brand has not been assigned when the plan is submitted, it will be furnished and assigned later. Complete drawing. If more than one brand is assigned to the sale, complete both drawings.
- (6) The contract requires you to have a designated representative available on the sale area or work location who is authorized to receive in your behalf any notice or instruction given by STATE and to take action in regard to performance under the contract. If logging and project work is widely separated, a representative is required for each.
- (7) The STATE representative will be designated when your plan is approved and is the person who will inspect and issue instructions regarding performance.
- (8) Show names of subcontractors to be used for any or all phases of the operations. If subcontractors are not known, or are changed later, give notification to the STATE representative prior to commencement of work by subcontractor.

Show projected dates for commencement of both projects and logging. If projected dates need to be changed at a later date, notification must be given to the STATE representative by supplemental plan or otherwise, prior to commencement of such operations.

- (10) The STATE representative will furnish extra copies of Exhibit A of the contract for your use in preparing the operations map. The map shall use the following legend and show:
  1. Landing locations, approximate setting boundaries, and probable sequence of logging the settings. Number the settings in sequence.
  2. Locations of spur roads planned for construction, other than those required by the timber sale contract. Provide spur road specifications.
  3. Location of proposed tractor yarding roads. Show if and how marked on the ground.
  4. Location of temporary stream crossings.
  5. List the sequence of performing project work.
  6. Location of rock sources - attach pit development plans.







	Cable Landing, with numbers for sequence.
	Tractor Landing with alphabetical sequence.
	Approximate setting boundary.
	Spur truck roads.
	Tractor yarding roads.
	Temporary stream crossings.

EXHIBIT B  
OPERATIONS PLAN

**Completion Timeline**

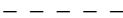
Indicate on the appropriate timeline below, the dates by which you plan to complete the work as required under this contract. The purpose of this section is to develop a plan that will ensure you complete the work as required, and meet the interim completion date(s) and contract expiration date. This plan is incorporated and made a part of the contract. When, in the opinion of STATE, operations are not commencing in a manner that meets the intent of this plan, you may be placed in violation of contract and your operations suspended until an amended plan is submitted and approved by STATE.

**Projects**



**Harvest & Other Requirements**

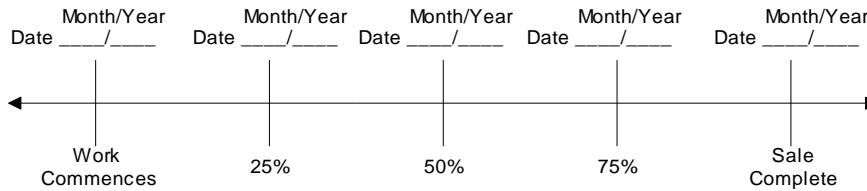

**The Federal Endangered Species Act (ESA) prohibits a person from taking any federally listed threatened or endangered species. Taking under the federal ESA may include alteration of habitat. STATE's approval of this plan does not certify that PURCHASER's operation under the plan is lawful under the federal ESA. As provided in the timber sale contract, PURCHASERS must comply with all applicable state, federal, and local laws.**

**PURCHASER's compliance with this plan is not in lieu of compliance with any federal requirements related to the federal Endangered Species Act.**

APPROVED: Date: \_\_\_\_\_

SUBMITTED BY:  
PURCHASER

STATE OF OREGON - DEPARTMENT OF FORESTRY

\_\_\_\_\_  
Title \_\_\_\_\_

\_\_\_\_\_  
Title \_\_\_\_\_

Original: Salem  
cc: District File  
Purchaser

## SCALING INSTRUCTIONS -- LOCATION APPROVAL -- BRAND INFORMATION

- (9) SALE NAME: Little Beaver Creek  
COUNTY: Washington
- (10) STATE CONTRACT NUMBER: 341-14-05
- (11) STATE BRAND REGISTRATION NUMBER:  
\_\_\_\_\_
- (12) STATE BRAND INFORMATION (COMPLETE):

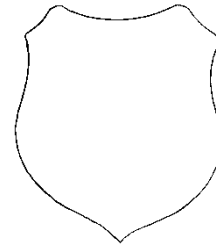

- | (5) MINIMUM SCALING SPECIFICATIONS |                    |
|------------------------------------|--------------------|
| SPECIES                            | MINIMUM NET VOLUME |
| Conifers                           | 10                 |
| Hardwoods                          | 10                 |
|                                    |                    |

		YES	NO
(6)	WESTSIDE SCALE: Use Region 6 actual taper rule. Logs over 40".	<input checked="" type="checkbox"/>	<input type="checkbox"/>
(7)	Weight Scale Sample	<input type="checkbox"/>	<input checked="" type="checkbox"/>

- |  |                          |
|--|--------------------------|
| <b>(14) SPECIAL REQUESTS</b> (Check applicable)          |                          |
| PEELABLE CULL (all species) .....                        | <input type="checkbox"/> |
| <b>NO DEDUCTIONS ALLOWED FOR MECHANICAL DAMAGE</b> ..... | <input type="checkbox"/> |
| ADD-BACK VOLUME - Deductions due to delay .....          | <input type="checkbox"/> |
| OTHER:   |                          |

- (15) **REMARKS**\_\_\_\_\_
- \_\_\_\_\_
- \_\_\_\_\_
- \_\_\_\_\_

(16) SIGNATURES:

State Forester Representative PRINT NAME

[illegible]

**Distribution (See specific instructions on pg. 2): ORIGINAL: Salem / COPIES: TPSO, Approved Scaling Location, Purchaser, District, Mgmt. Unit**

**EXHIBIT C – SAWMILL GRADE**  
**INSTRUCTIONS FOR FORM 343-307a (rev. 11/11)**

- (1) Check appropriate box. REVISION NUMBER requires comments. CANCELLATION requires logging and hauling to be complete, recall branding hammers, date and sign where indicated, write diagonally across page "CANCEL", and send to TPSO.
- (2) Designate Third Party Scaling Organization (TPSO).

Columbia River Log Scaling & Grading Bureau  
P.O. Box 7002, Eugene, OR 97401  
Phone: (541) 342-6007 Fax: (541) 342-2631  
Email: [services@crls.com](mailto:services@crls.com)

Pacific Rim Log Scaling Bureau, Inc.  
8288 28<sup>th</sup> Court North East, Lacey, WA 98516  
Phone: (360) 528-8710 Fax: (360) 528-8718  
Email: [office@prlsb.com](mailto:office@prlsb.com)

Southern Oregon Log Scaling & Grading Bureau  
P.O. Box 580, Roseburg, OR 97470  
Phone: (541) 673-5571 Fax: (541) 672-6381  
Email: [info@southernoregonlogscaling.com](mailto:info@southernoregonlogscaling.com)

Yamhill Log Scaling & Grading Bureau  
P.O. Box 709, Forest Grove, OR 97116  
Phone: (503) 359-4474 Fax: (503) 359-4476  
Email: [yamhill@attglobal.net](mailto:yamhill@attglobal.net)

Northwest Log Scalars, Inc.  
5526 NE 122<sup>nd</sup> Ave, Portland, OR 97230  
Phone: (503) 254-0600 Fax: (503) 408-0919  
Email: [info@nwlogscalars.com](mailto:info@nwlogscalars.com)

Pacific Log Scaling & Grading Bureau, Inc.  
P.O. Box 23939, Portland, OR 97281  
Phone: (503) 684-5599 Fax: (503) 639-4880  
Email: [PacLogScale@aol.com](mailto:PacLogScale@aol.com)

- (3) State District office, address and phone.
- (4) Enter Purchaser's business name, address, and phone number as it appears on the Contract.
- (5) Minimum Scaling Specifications.
- (6) Westside – Region 6 actual taper segment scale. Check Yes or No. Special Service Rules on file with TPSO. See: Segment Scaling and Grading of Long Logs -- All Species -- State Forestry Department Scaling Practices (Westside).
- (7) Weight Scale Sample – Check box if sale is to be a Weight Scale Sample. All specifics for handling, scaling and processing will be attached or explained in the Remarks section Item (15).
- (8) Show scaling locations only applicable to TPSO. Location name should appear as it does on the ODF Approved Scaling Location web site: [http://www.odf.state.or.us/DIVISIONS/management/asset\\_management/ScalingLocation.asp](http://www.odf.state.or.us/DIVISIONS/management/asset_management/ScalingLocation.asp) Locations with scaling and processing directions specific to their location should be on a separate form. Species should be identified if not capable of receiving "all" species. Check appropriate box for either: yard, truck scale, or weight. Refer to the web site listed above for the locations approval status.
- (9) Enter sale name and county.
- (10) Enter sale Contract number.
- (11) Enter Oregon's State Brand Registry Number **(REQUIRED)**.
- (12) Show brand assigned to timber sale. One brand only. If more than one brand is assigned to the sale: (1) make a separate form for each brand and (2) on each form, explain and show other brand(s) in the Remarks section Item (15).
- (13) Check yes for Paint Required and designate "Orange" for color. Non required removal volumes may sometimes require blue paint.
- (14) Special Requests. These are requests that will be applied to ODF timber sales. All boxes applicable to the timber sales designated in the Exhibit C form must be "marked". If "Other" is indicated, it must contain a description and any necessary comments.
- (15) Use this space to designate any weight conversion factors, per load volumes, weight scale sample instructions or any other explanations to clarify scaling, processing and/or mailing requirements. If additional scaling locations are approved, revise original or current form showing all (old and new) locations. Check REVISION box at top of form and explain under remarks. Route as indicated.
- (16) Require purchaser to sign and date completed form in addition to State Forester Representative, sign and print name on the form.

**Salem Distribution Instructions:** Original will be mailed to Salem after it is electronically scanned and placed in the Salem transfer drive <\\WPODFILL01\Transfer\ScalingInstructions> or e-mailed directly to [scaling@odf.state.or.us](mailto:scaling@odf.state.or.us). Scaling instructions for each brand should be scanned separately, for each approved TPSO.

**Distribution (See specific instructions on pg. 2): ORIGINAL: Salem / COPIES: TPSO, Approved Scaling Location, Purchaser, District, Mgmt. Unit**

EXHIBIT D

ROCK QUARRY DEVELOPMENT AND USE

1. PURCHASER shall prepare a written development plan for the quarry area. The plan shall be submitted to STATE for approval prior to conducting any operation in quarry area. The plan shall include, but not be limited to:
  - (a) Location of benches and roads to benches.
  - (b) Disposal site for woody debris, overburden and reject material.
  - (c) Time lines for rock quarry use.
  - (d) Erosion Control measures.
2. PURCHASER shall schedule and coordinate quarry and stockpile usage with other existing or planned activity requiring quarry or stockpile usage. PURCHASER shall notify STATE 5 days prior to the start of quarry development activities.
3. The quarry site shall be left in a condition free from overburden and debris. Access roads to the quarry, and the quarry floor, shall be cleared at the termination of use. Overburden shall be removed for a distance of 20 feet beyond the developed rock source.
4. All overburden and reject material shall be hauled to the designated waste area as directed by STATE.
5. PURCHASER shall conduct the operations relative to the disposal of waste material in such manner that sediment, rock, or debris shall not be washed, conveyed, or otherwise deposited in any stream.
6. Benches shall be maintained/constructed at intervals of 40 feet or less in height and shall be a minimum of 20 feet in width. Any gravel or talus slopes shall be left with a working face at an angle of 60 percent or less. There shall be a minimum of one bench with an access road to it. Said bench shall be easily accessible with tractors.
7. Quarry face shall be developed in a uniform manner. All quarry backslopes shall be left in a stable condition.
8. Oversized material that is produced shall be piled in a designated area adjacent to the pit. It shall not be wasted.
9. The quarry floor shall be developed to provide for drainage away from the quarry. All quarry and stockpile site drainage ditches shall be maintained. Quarry access roads shall be cleared and blocked upon completion of quarry use as directed by STATE.
10. Proper winterization and storm-water control measures such as waterbarring, drainage, utilization of filter bales, mulching and/or blocking access shall be constructed and maintained to protect the watershed and Project Work, as directed by STATE.

## EXHIBIT D

### CRUSHED ROCK SPECIFICATIONS

Materials. The material shall be fragments of rock crushed to the required size. The material shall be free from vegetation and lumps of clay. A 1" screen shall be utilized for production of crushed rock for the purpose of removing excess fine material, unless otherwise approved by STATE. Excess fines are present, when greater than 5 percent of a total rock sample weight, passes a #200 sieve. Rock crushing shall be limited to periods when weather conditions are acceptable to STATE.

Quality and Grading Requirements. The base material shall be rock. River gravel shall not be used. Crushed rock shall meet the grading requirements that follow.

Rock strength: for rock not produced from STATE quarries, the material from which base material is produced or manufactured shall meet the following test requirement for Aggregate Hardness - Test Method AASHTO T 96, 30 percent Maximum.

For the purpose of crushing rock specified under the projects in Section 2610, "Project Work," PURCHASER shall utilize a three-stage rock crusher, or equivalent, unless otherwise approved by STATE.

The rock crusher shall be calibrated to produce rock as specified in this exhibit. Prior to the commencement of production crushing, PURCHASER shall sample, test, and provide rock test results meeting STATE specifications. STATE may then sample and test crushed rock for approval to proceed. PURCHASER shall take one sample of each 2,000 cubic yards of crushed rock material produced thereafter, using approved AASHTO sampling procedures. PURCHASER shall submit samples to a certified laboratory or shall perform testing for gradation requirements using AASHTO T 11 and AASHTO T 27 testing procedures. Prior to testing, each sample shall be split, making one-half of the sample, with proper identification, available for testing by STATE. Each sample and the results of PURCHASER testing shall be made available to STATE within 24 hours of sampling. Any rock crushed prior to STATE approval to proceed shall not be credited to the required rock quantity. Any subsequent rock tests not meeting STATE specifications shall be reason for rejection of that portion of crushed rock produced after that test and shall not be credited to the required rock quantity. STATE may sample the crushed rock at any time during the operation. Results of STATE's tests shall prevail over all other test results.

EXHIBIT D

DURABLE CRUSHED ROCK SPECIFICATIONS

Grading Requirements

<u>For 1½"-0"</u>	Passing	2" sieve	100%
	Passing	1½" sieve	90-100%
	Passing	¾" sieve	60-90%
	Passing	¼" sieve	30-50%
	Passing	No. 10 sieve	15-30%
	Passing	No. 40 sieve	7-15%
<u>For 3"-0"</u>	Passing	4" sieve	100%
	Passing	3" sieve	90-100%
	Passing	1½" sieve	60-90%
	Passing	¾" sieve	40-60%
	Passing	¼" sieve	20-40%
	Passing	No. 10 sieve	5-20%



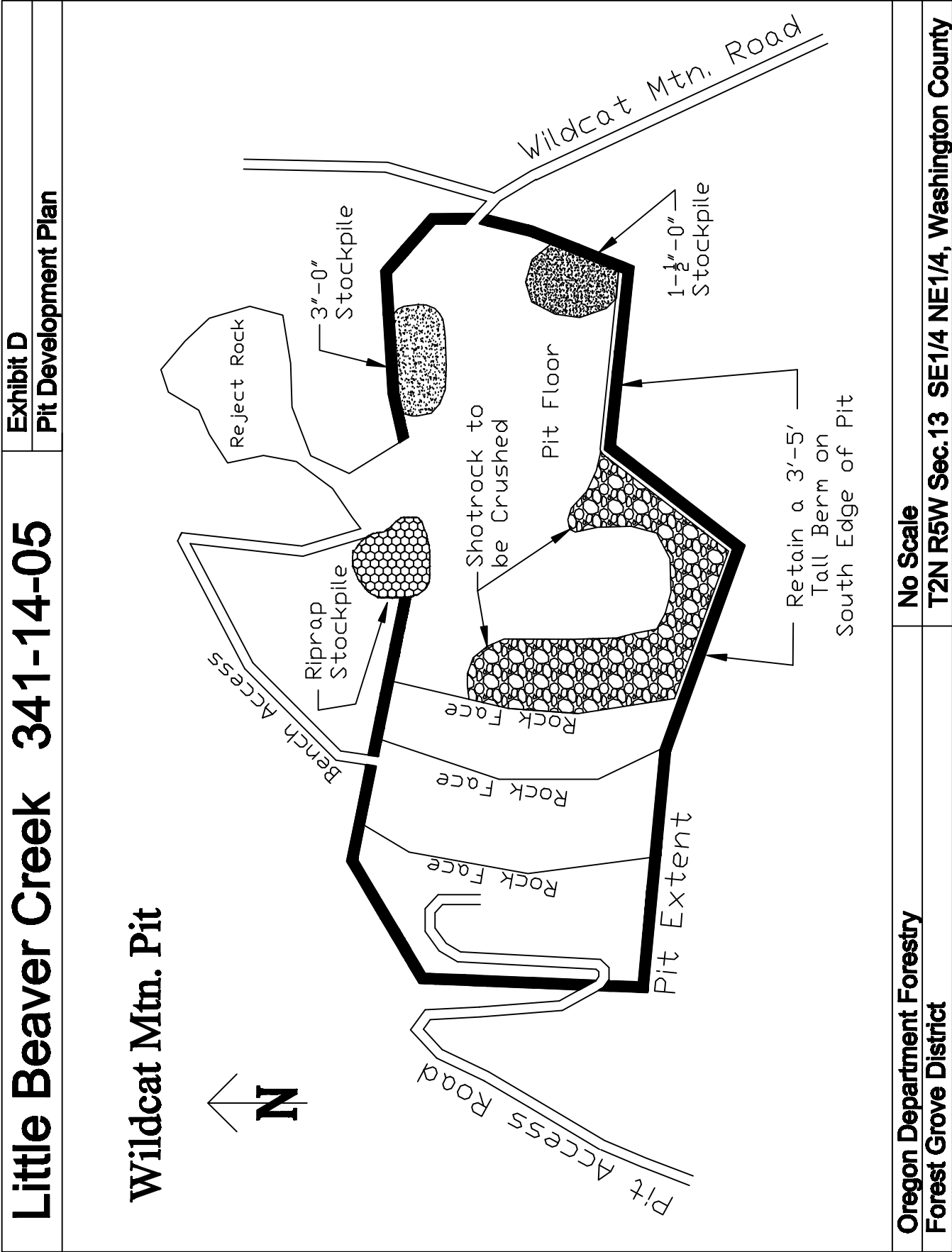

EXHIBIT E

ROAD VACATING SPECIFICATIONS

PURCHASER shall vacate the following road segment: A to B. Specific objectives for this project include:

- (a) Fill removal and stream channel development.
  - (b) Culvert removal.
  - (c) Gate removal.
  - (d) Restoration of natural contours by outsloping of the road prism.
  - (e) Sidecast pullback.
  - (f) Minimize disturbance of existing vegetation.
  - (g) Erosion Control.
- 
- (1) No trees shall be cut within the project area.
  - (2) Fill Removal and Stream Channel Development. Remove fills to match natural topography and stream course levels. Stream channels shall be excavated/developed to widths matching the natural channel upstream and downstream. Developed stream banks shall be sloped at natural contours or no steeper than 1 ½:1, as directed by STATE.
  - (3) Culvert Removal. Remove drainage structures and culverts. Removed culverts shall be hauled to an approved refuse site off of STATE land.
  - (4) Gate Removal. Remove gate. Removed gate shall be hauled to an approved refuse site off of STATE land.
  - (5) Rip Road Surface. Rip road surface to a minimum depth of 10 inches.
  - (6) Outslope Road. Outslope road to restore natural contours or establish a minimum of 10 percent slope for drainage at designated locations. If the road grade exceeds 10 percent, outslope of the road shall be 2 percent greater than the road grade.
  - (7) Sidecast Pullback. Excavate/pullback previously sidecast materials below the road. Developed slopes shall be pulled back to a 1½:1 slope or to natural ground contours. The beginning position for sidecast pullback shall be no greater than 20 feet vertical distance from the existing road surface, in accordance with this exhibit. Sidecast material remaining greater than 20 feet below the road shall be tapered and sloped for drainage.
  - (8) Use of Excavated Materials.
    - (A) Fill Excavation and Sidecast Pullback. Excavated materials shall be placed on the interior (cut) side of the road, and utilized to restore the cutslope to natural contours, or to a minimum 10 percent outsloped surface for drainage. Any excess material will be hauled to a designated waste area, as directed by STATE.
    - (B) Woody Debris shall be placed on the surface of pullback/fill material.
    - (C) Block Roads. Construct a tank trap at points A and B. Use excavated material from fill removals to block roads from vehicle access, as directed by STATE.
  - (9) Waterbars. Construct Waterbars as directed by STATE, and according to the specifications in Exhibit F.
  - (10) Grass Seed and Fertilize. Grass seed and fertilize all areas of disturbed soil and mulch all areas within 100 feet of streams.

EXHIBIT E

ROAD VACATING SPECIFICATIONS

- (11) Erosion Control. Erosion control shall be completed in a progressive manner. Grass seed and straw mulch shall be applied for every 500 feet of road vacated, prior to continuing work.
- (12) Equipment. A minimum 1½ cubic-yard, track mounted excavator shall be used for all excavation, culvert removal, streambed preparation, road blocking and waterbarring, unless otherwise approved in writing by STATE.
- (13) Dry Conditions. All work shall be performed during dry conditions acceptable to STATE.
- (14) Support, including transport, other equipment, replacements, supplies, maintenance, and repairs, shall be furnished as required to complete the project and shall be furnished without cost to STATE, other than as agreed under the contract terms.

SPECIFIC INSTRUCTIONS/SPECIFICATIONS:

<u>Segment</u>	<u>Station</u>	<u>Work Description</u>
A to B	0+00	Point A. Construct tank trap. Begin sidecast pullback.
	0+65	Remove culvert 1. Remove fill.
	4+60	Remove culvert 2. Remove fill.
	13+70	Remove culvert 3.
	20+00	Remove culvert 4. Remove fill.
	21+90	Begin fill removal.
	23+00	End fill removal.
	23+95	Remove culvert 5. Remove fill.
	28+50	Begin fill removal.
	29+15	Remove culvert 6.
	30+00	End fill removal.
	40+55	Remove gate.
	44+75	Point B. Construct tank trap. End sidecast pullback.

EXHIBIT E

TYPICAL CROSS SECTION VIEW OF ROAD VACATING SIDECAST PULLBACK

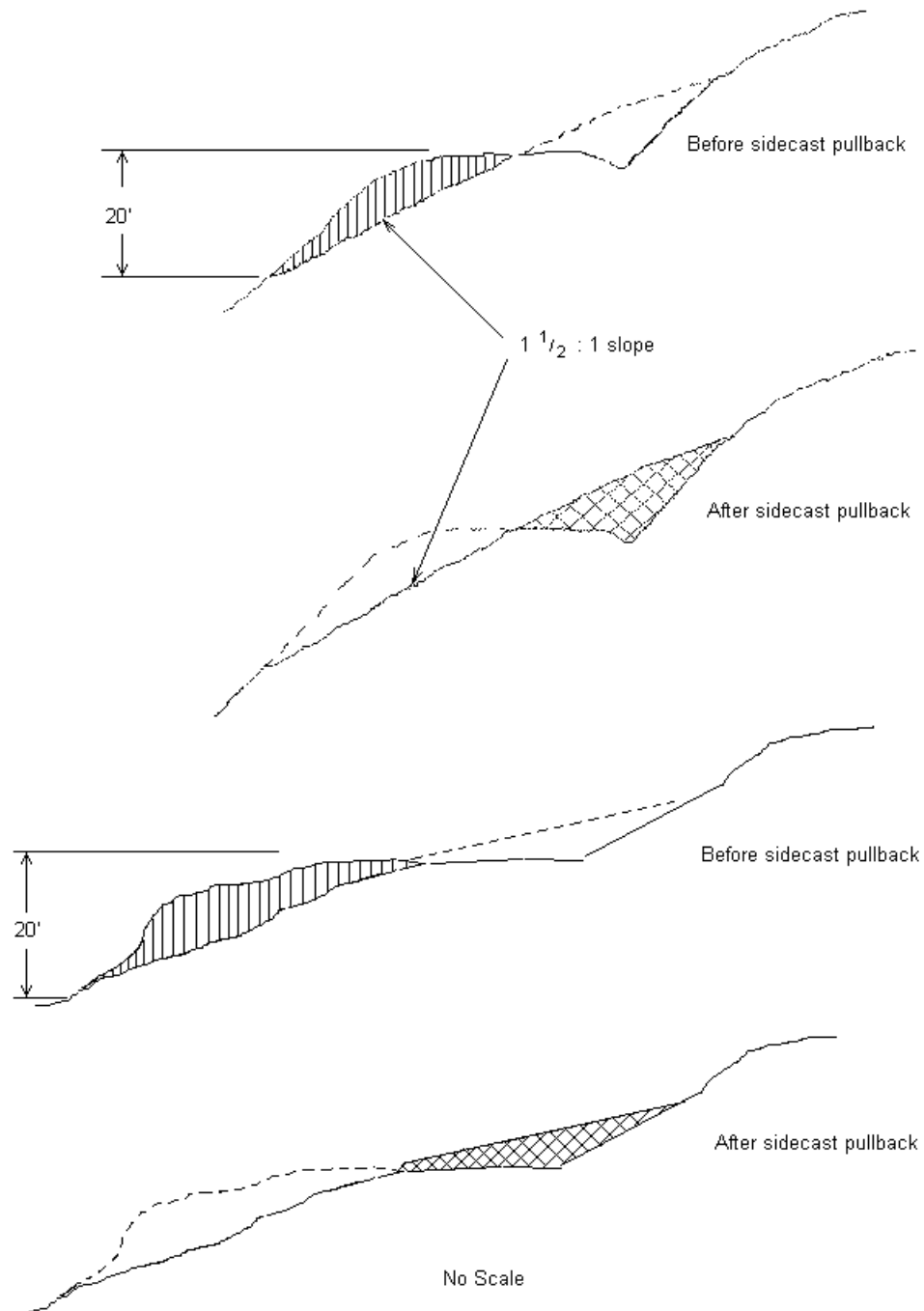
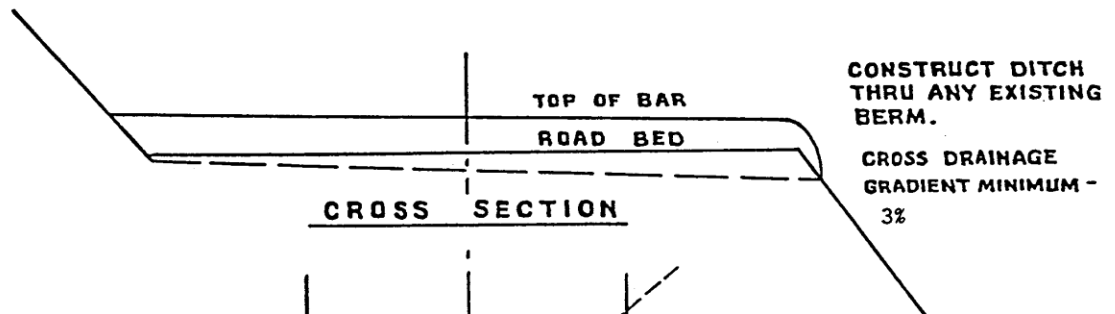
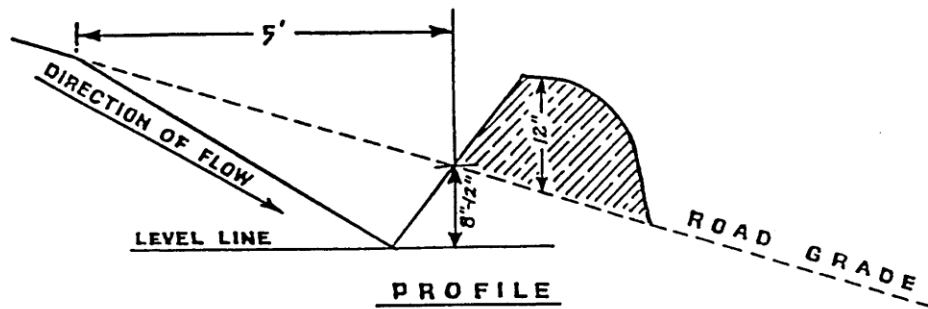
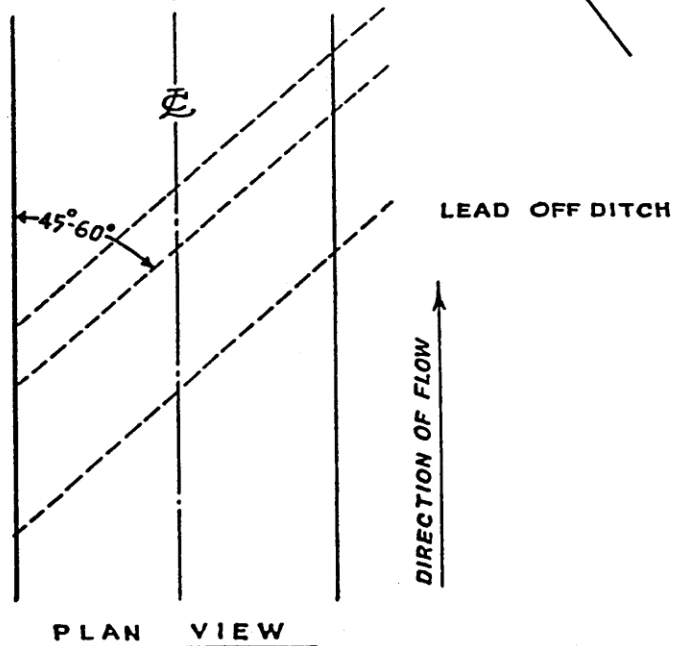

EXHIBIT F  
WATERBAR SPECIFICATIONS



SPACING OF WATERBARS

ROAD GRADE	DISTANCE
≤ 5%	200'
6-10%	100'
11-15%	75'
16-20% or greater	50'



**WATERBAR SPECIFICATIONS  
FOR CROSS DITCHING #298**

EXHIBIT F

TANK TRAP SPECIFICATIONS

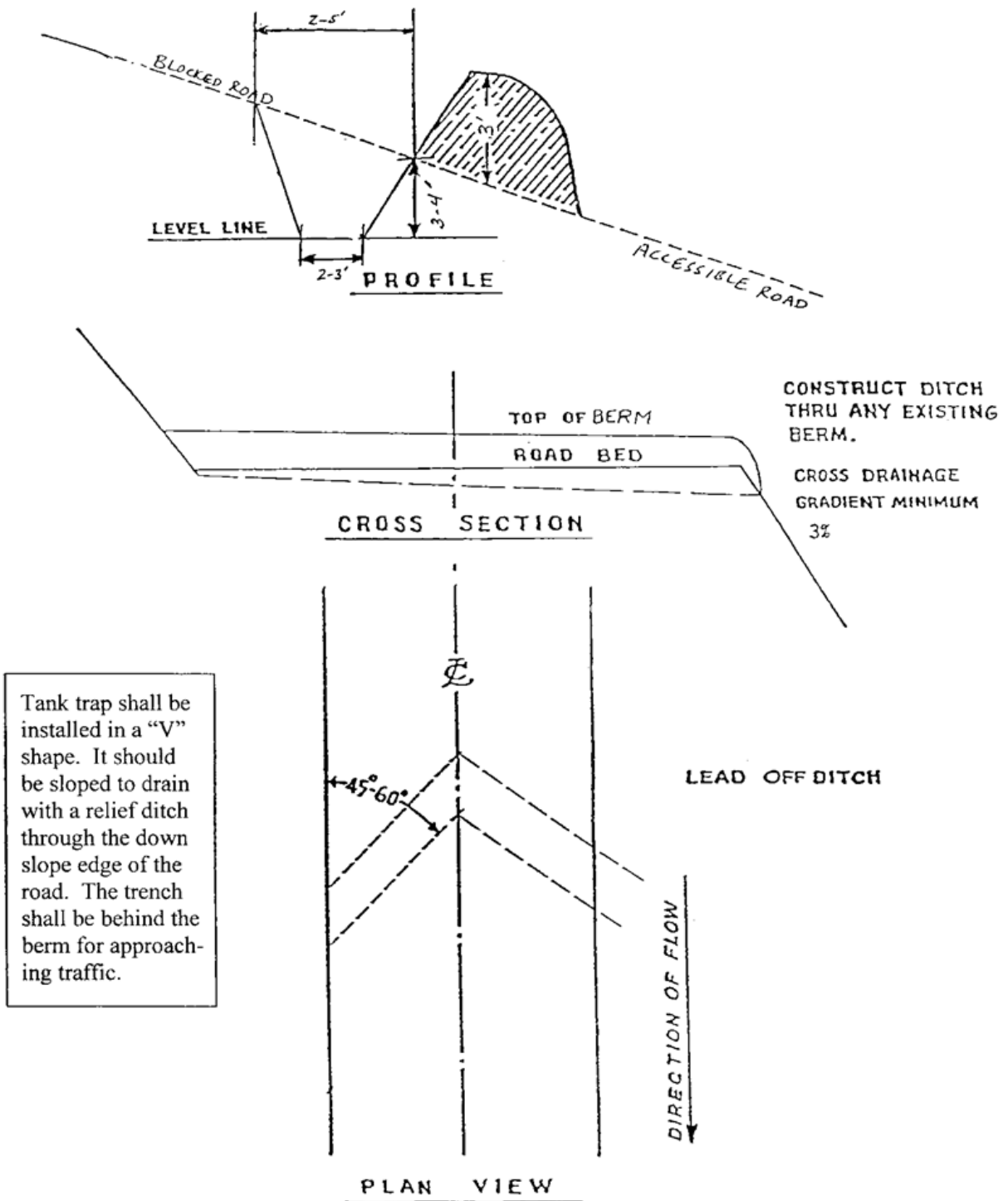

Tank trap shall be installed in a "V" shape. It should be sloped to drain with a relief ditch through the down slope edge of the road. The trench shall be behind the berm for approaching traffic.

TANK TRAP  
SPECIFICATIONS

EXHIBIT G

SEEDING AND MULCHING

This work shall consist of preparing seedbeds and furnishing and placing required seed, fertilizer, and straw mulch. Straw mulch shall consist of straw that is free of noxious weeds.

Seeding Seasons. Seeding shall be performed only from March 1 through June 15 and August 15 through October 31. Seeding materials shall not be applied during windy weather or when the ground is excessively wet or frozen. Areas of disturbed soil shall be seeded by the end of the project period in which work was started.

APPLICATION METHODS FOR SEED AND FERTILIZER

Dry Method. Mechanical seeders, seed drills, landscape seeders, cultipacker seeders, fertilizer spreaders, or other approved mechanical seeding equipment shall be used to apply the seed and fertilizer in the amounts and mixtures specified. Hand-operated seeding devices may be used when seed and fertilizer are applied in dry form.

APPLICATION RATES FOR SEED AND FERTILIZER

The seed mixture listed below shall be applied at 100 lbs. per acre. The seed mixture shall be comprised of the following:

SPECIES	MIXTURE	PURE LIVE SEED	GERMINATION
Annual Rye	33%	95%	>90%
Orchard Grass	33%	95%	>90%
Perennial Rye	34%	95%	>90%

Fertilizer: Chemical analysis shall be 16-20-0 and shall be applied at the rate of 200 pounds per acre. Fertilizer shall not be applied within 100 feet of streams.

Mulching Period. Straw mulch shall be applied within 24 hours of spreading grass seed and fertilizer.

APPLICATION RATES FOR MULCH

Place straw mulch to a reasonably uniform thickness of 1½ to 2½ inches. This rate requires between 2 and 3 tons of dry mulch per acre.

## EXHIBIT H

### SPECIFICATIONS FOR BRUSH AND SLASH TREATMENT

Operation Area: The Timber Sale Area shown on Exhibit A.

Equipment Type, Equipment Operation, and Conduct of Work.

Equipment- shall be a track-mounted machine with a ground-pressure rating of not more than 6.8 PSI and a net horsepower of 85 or more. The machine shall be capable of a minimum horizontal reach of 26 feet and a minimum vertical reach of 16 feet.

The bucket shall be of a hydraulically controlled "clamshell" style equipped with rake teeth and capable of 360-degree continuous rotation. The tooth length on the rake teeth shall be at least 14 inches unless otherwise approved in writing by STATE.

Operator - must be experienced in operating similar equipment on land clearing operations, be able to operate the equipment proficiently, and pile the debris on the area as directed by STATE.

Support - including transport, other equipment, replacements, supplies, maintenance, and repairs shall be furnished as required to complete work; and shall be furnished without cost to STATE, other than as agreed under the contract terms.

Work Scheduling

Work shall not begin until PURCHASER has arranged to have the equipment operators meet with STATE to review the requirements specified in Section 2365, "Progressive Operations", Section 2560, "Slash Disposal", and this Exhibit. Once begun, operations shall be continuous until contract work is completed, unless interrupted by poor weather, fire closures, or other uncontrollable circumstances. Equipment breakdowns shall be repaired without undue delay, and provision shall be made for replacement of equipment to prevent prolonged delays. Brush and slash treatment operation shall be accomplished only during dry weather conditions and shall not be allowed when operations might damage sites or affect stream flows. Any exception to these instructions must be authorized in writing by STATE.

Description of Work to be Done

Move brush and/or woody slash to create openings as planting spots in the slash and brush. Planting spots shall be a minimum of 1 foot by 1 foot in size and shall be on a 10 foot spacing. Care shall be taken to avoid creating a depression in the soil of the planting spot. Spacing may be varied to accommodate stumps, large woody material, rocky areas, etc., but 435 planting spots per acre are still required.

Piling should be avoided but may be done only as needed to create the required planting spots. If piling is necessary, piles should not exceed 10 feet in width or length. Each pile whose length and width dimensions exceed 10 feet shall be covered with 100 square feet of polyethylene plastic sheeting. The plastic sheeting shall be no more than 4 mil gauge. Additional woody debris shall be piled on top of the plastic sheeting to complete the piling, as directed by STATE. PURCHASER shall supply the materials used for covering the piles. Work specifications may be modified or waived only upon written notice from STATE.



## ***PART IV: OTHER INFORMATION***

State Timber Sale Contract  
No. 341-14-05  
Little Beaver Creek

### **NOTICE OF TRANSFER OF STATE TIMBER**

#### **Instructions**

**629:-Form-301-010**

Complete Section 1. Mark the box which applies to you/your company in Section 2. Complete Section 3 and obtain signatures.

#### **SECTION 1**

On \_\_\_\_\_, state timber sale purchaser (Transferor)  
\_\_\_\_\_, sold, exchanged or otherwise transferred to  
\_\_\_\_\_, (Transferee) state timber originating from State  
Timber Sale Contract No. 341-14-05.

Transferee hereby certifies that they:

- (a) Will not export the unprocessed state timber which is the subject of this transaction;
- (b) Will not sell, transfer, exchange or otherwise convey the unprocessed timber which is the subject of this transaction to any other person without first obtaining a like certification from that person; and
- (c) Are not prohibited by OAR's 629-31-005 through 045 from purchasing state timber or logs directly from the State Forester, or this is a sale of Western Red Cedar for domestic processing.

#### **SECTION 2**

- ☐ Have not exported unprocessed timber originating from private lands in Oregon in the last 24 months.
- ☐ This is a sale of hardwood logs for domestic processing.
- ☐ This is a sale of Western Red Cedar for domestic processing.
- ☐ This is a sale of pulp logs or cull logs processed at domestic pulp mills, domestic chip plants or other domestic operations for the purpose of conversion of the logs into chips.

#### **SECTION 3**

The parties understand that falsely entering into this certification, or failure to comply with the terms of this certification is a violation of the Forest Conservation and Shortage Relief Act of 1990 and OAR Chapter 629, Division 31, and is subject to any and all penalties contained therein.

Transferor:

Transferee:

\_\_\_\_\_  
Signed

\_\_\_\_\_  
Signed

\_\_\_\_\_  
Title

\_\_\_\_\_  
Title

\_\_\_\_\_  
Dated

\_\_\_\_\_  
Dated

[Note: For the purpose of this form, the definition of unprocessed timber is the same as in OAR 629-31-005]

Mail To: State Forester  
2600 State Street  
Salem, OR 97310