

EXHIBIT A
Timber Sale Contract No. 341-13-099
HOLLY BUSH
 Portions of Sections 12 & 13 T2S, R8W,
 Portions of Sections 7 & 18 T2S, R7W, W.M.,
 Tillamook County, Oregon

Area	Type of Operation	Acres	
		Gross	Net
1	Modified Clearcut	128	109
2	Modified Clearcut	131	100
Total		259	209



Tillamook District GIS
3/07/2013

This product is for informational use and may not have been prepared or suitable for legal, engineering, or surveying purposes.



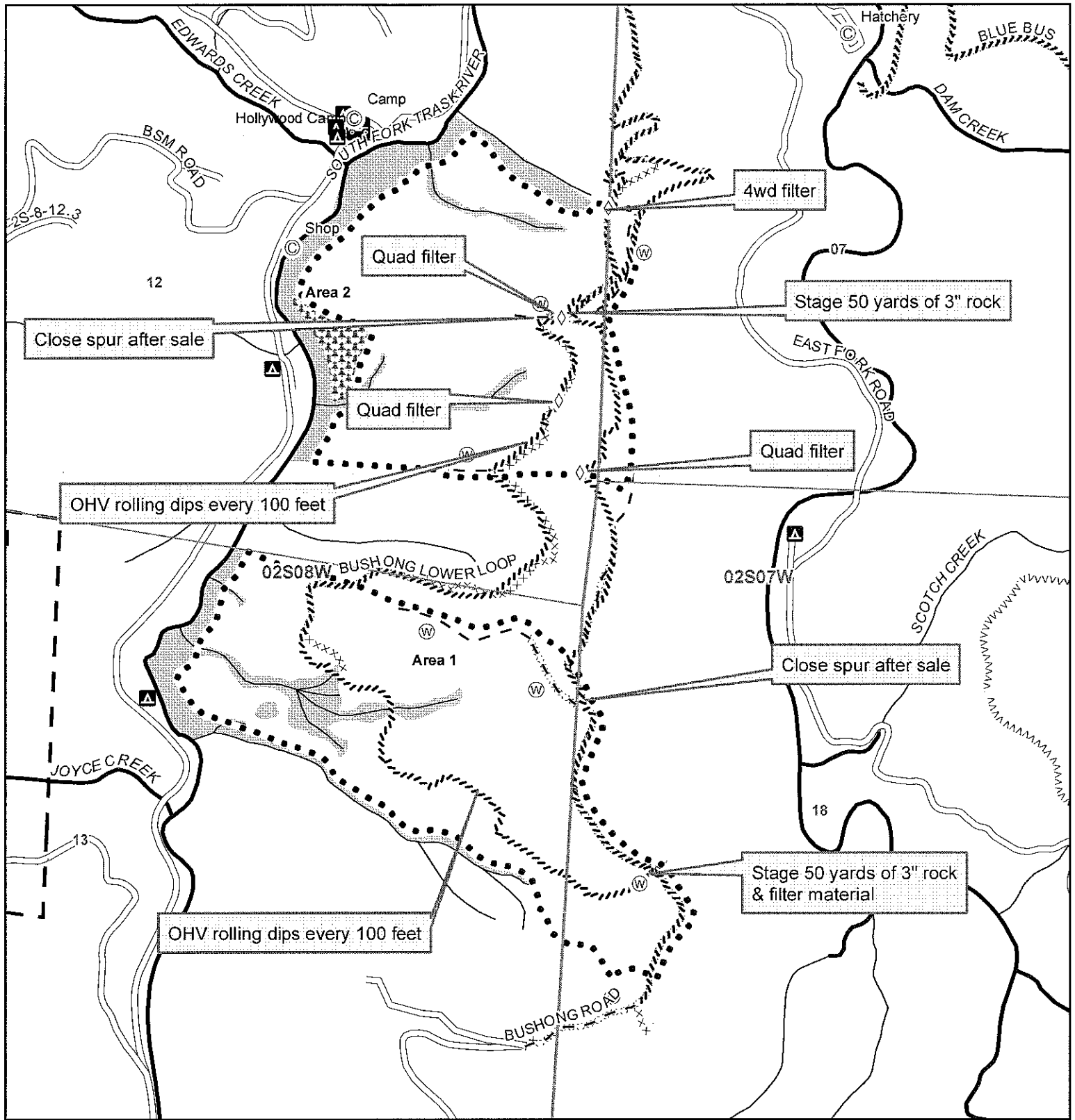

- | | | | |
|--|------------------------------|--|-------------------------|
| | Rock source | | Area boundary |
| | Stock pile | | Sale boundary |
| | Waste area | | Ownership boundary |
| | Bridge | | Perennial Type-F stream |
| | Gate | | Perennial Type-N stream |
| | Survey corner | | Unsurfaced road |
| | Domestic water supply intake | | Surfaced road |
| | Cultural site | | Paved road |
| | Buffer | | Abandoned road |
| | Green tree retention area | | Blocked road |
| | Install trail filter | | Road construction |
| | Dispersed Campsites | | OHV trail |
| | | | Non-motorized trail |
| | | | Transmission line |
| | | | Railroad |

EXHIBIT A - RECREATION PROJECTS
Timber Sale Contract No. 341-13-099
HOLLY BUSH
 Portions of Sections 12 & 13 T2S, R8W,
 Portions of Sections 7 & 18 T2S, R7W, W.M.,
 Tillamook County, Oregon

1,000 0 1,000 Feet



Tillamook District GIS
3/18/2013

This product is for informational use and may not have been prepared or suitable for legal, engineering, or surveying purposes.



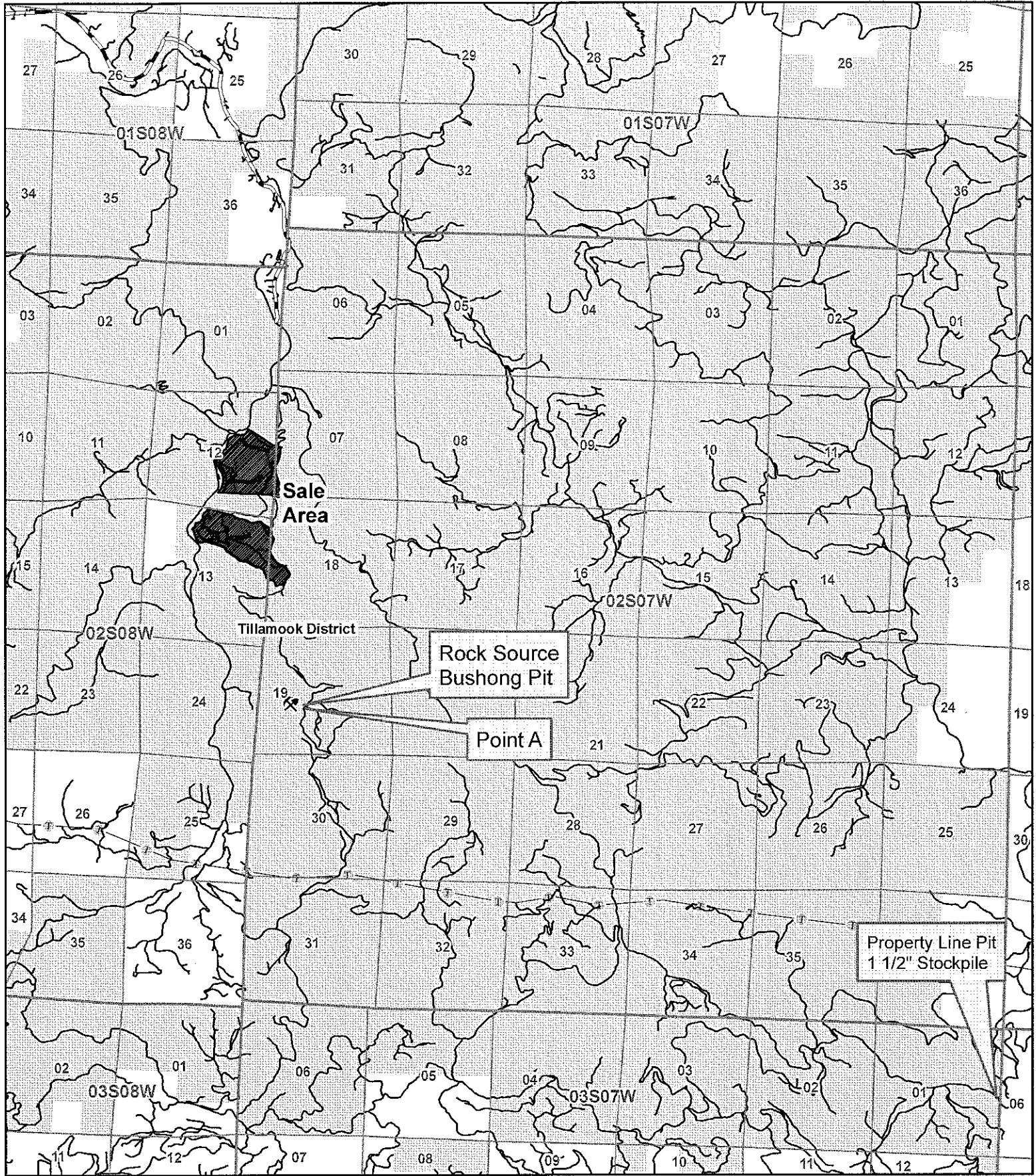

EXHIBIT A - VICINITY MAP

Timber Sale Contract No. 341-13-099
HOLLY BUSH
 Portions of Sections 12 & 13 T2S, R8W,
 Portions of Sections 7 & 18 T2S, R7W, W.M.,
 Tillamook County, Oregon



- | | |
|--------------------------------|---------------------|
| ⚡ Rock source | — Major road |
| ⊙ Stock pile | — Other road |
| ⊗ Waste area | — Transmission line |
| ⚡ Bridge | ++++ Railroad |
| ● Gate | ▨ Timber sale |
| Ⓧ Domestic water supply intake | ▨ ODF ownership |

Tillamook District GIS
 3/18/2013
 This product is for informational use and may not have been prepared or suitable for legal, engineering, or surveying purposes.

