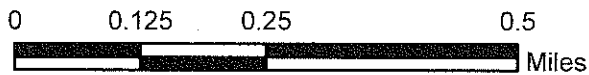
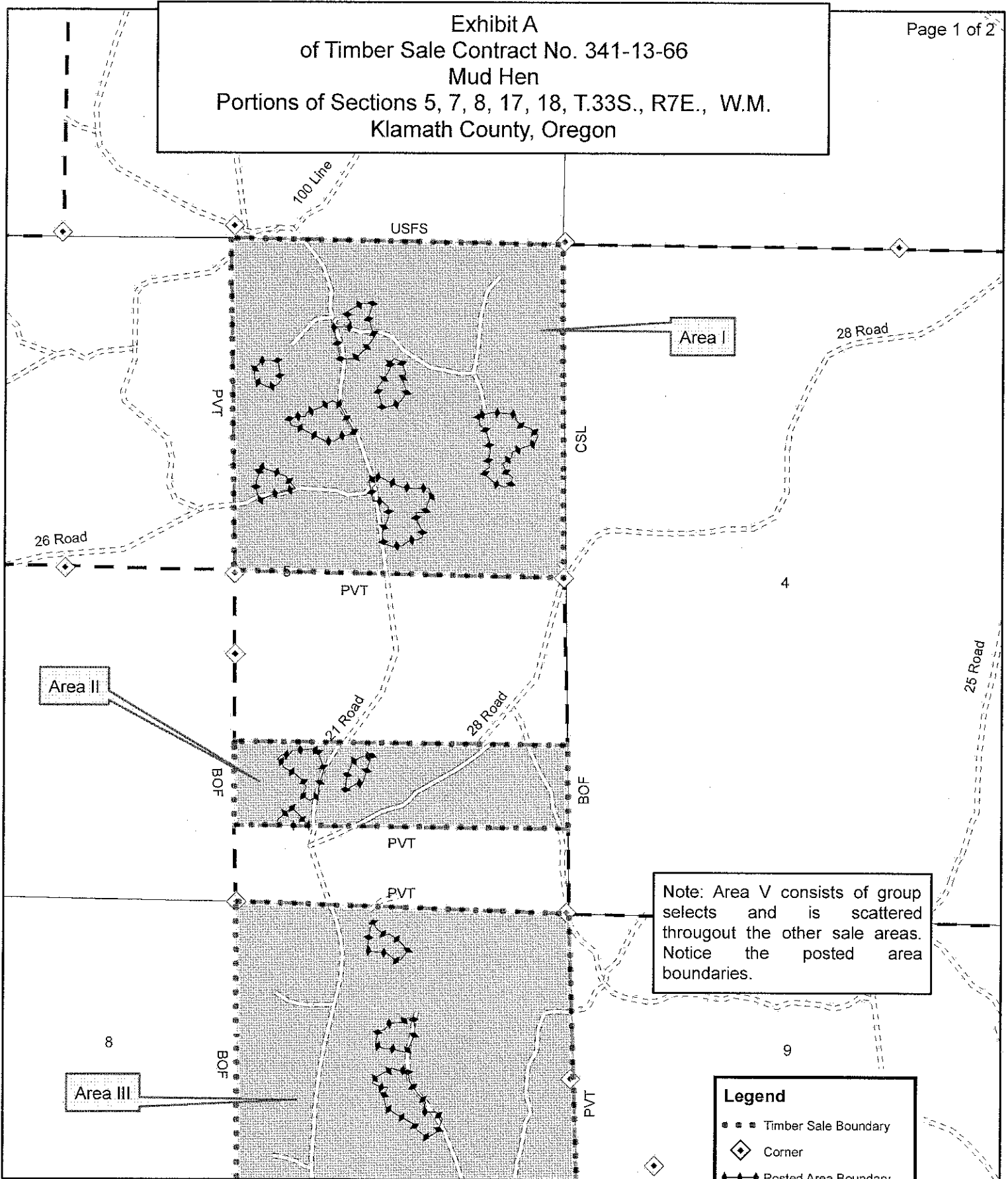
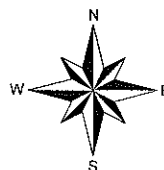

Exhibit A
of Timber Sale Contract No. 341-13-66
Mud Hen
Portions of Sections 5, 7, 8, 17, 18, T.33S., R7E., W.M.
Klamath County, Oregon



1 inch equals 1,000 feet



This product is for informational purposes and may not have been prepared for, or suitable for legal, engineering, or surveying purposes.

Legend

- Timber Sale Boundary
- ◊ Corner
- ◆◆◆◆◆ Posted Area Boundary
- ◇◇◇◇◇ Unposted Area Boundary
- ODF Property Boundary

Roads

- - - - - DIRT
- PAVED
- ==== ROCK

Exhibit A
of Timber Sale Contract No. 341-13-66
Mud Hen
Portions of Sections 5, 7, 8, 17, 18, T.33S., R7E., W.M.
Klamath County, Oregon

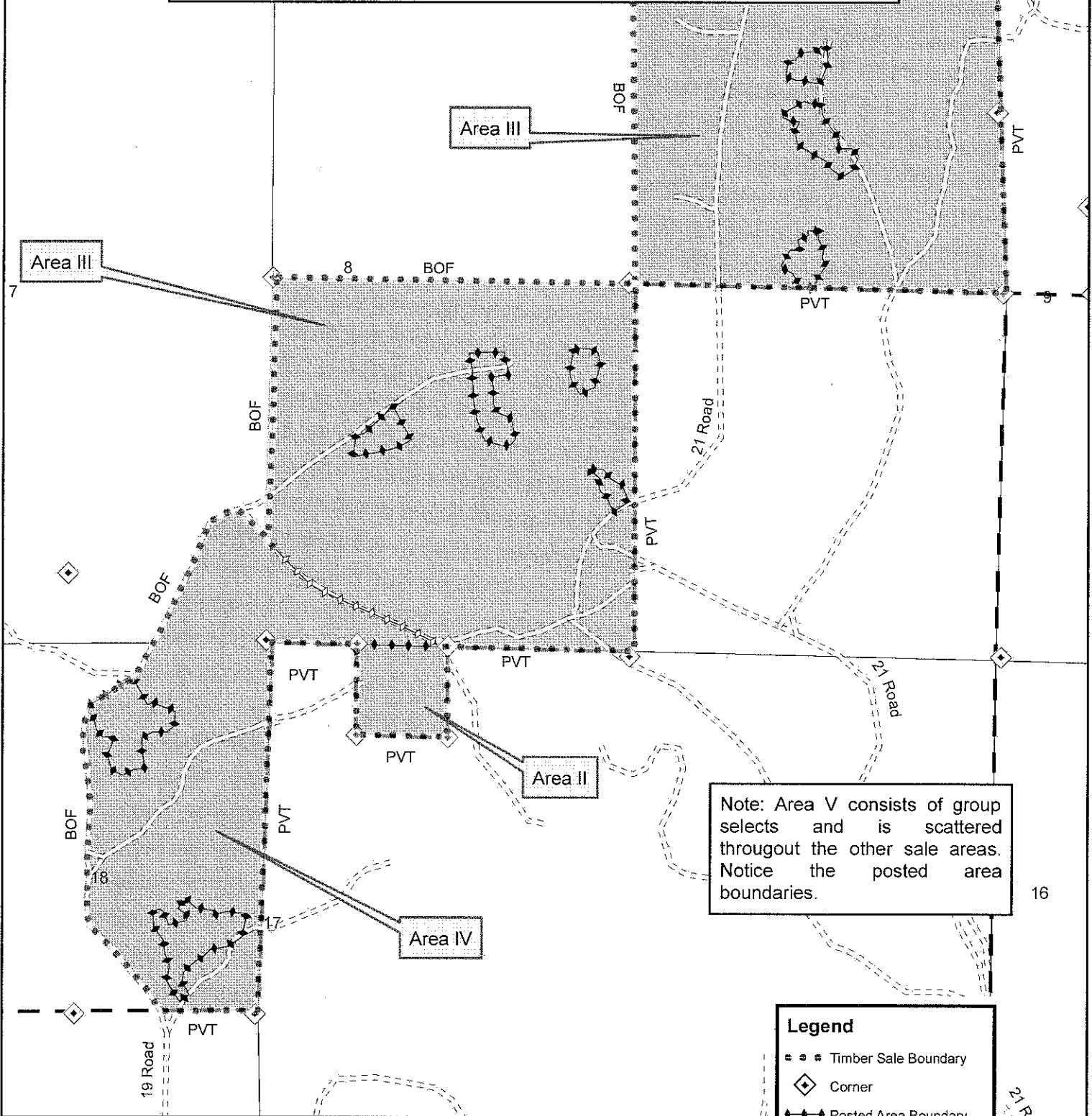

Note: Area V consists of group selects and is scattered throughout the other sale areas. Notice the posted area boundaries.



1 inch equals 1,000 feet

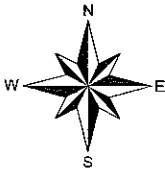

This product is for informational purposes and may not have been prepared for, or suitable for legal, engineering, or surveying purposes.

Legend

- ▣ Timber Sale Boundary
- ◊ Corner
- ◆ Posted Area Boundary
- ◇ Unposted Area Boundary
- ODF Property Boundary

Roads

- DIRT
- PAVED
- ROCK