

Legend

- Landing
- ▣ Posted Sale Boundary
- Project Point
- Ⓜ Waste Area
- Roads
 - Purchaser Maintained Road
 - ▬ State Maintained Road
 - ▬▬ New Road Construction
- Streams
 - Type F
 - Type N Perennial
 - ⋯ Type N Seasonal
 - ▬ Stream Buffer
- ▨ Reforestation Area
- ▩ Green Tree Retention - Group
- ▧ Marbled Murrelet Management Area
- ⋯ Seasonally Restricted



EXHIBIT A

Of Timber Sale Contract No.
STULLS RIDGE STEER
 341-11-45

Portions of Sections 33 and 34, T23S, R11W, and
 Portions of Section 3, T24S, R11W, W.M.
 Coos County, Oregon
 Approximately 27 net harvest acres

Approx. Scale: 1 inch = 1,000 feet



This product is for informational use and may not have been prepared for, or suitable for legal, engineering, or surveying purposes.

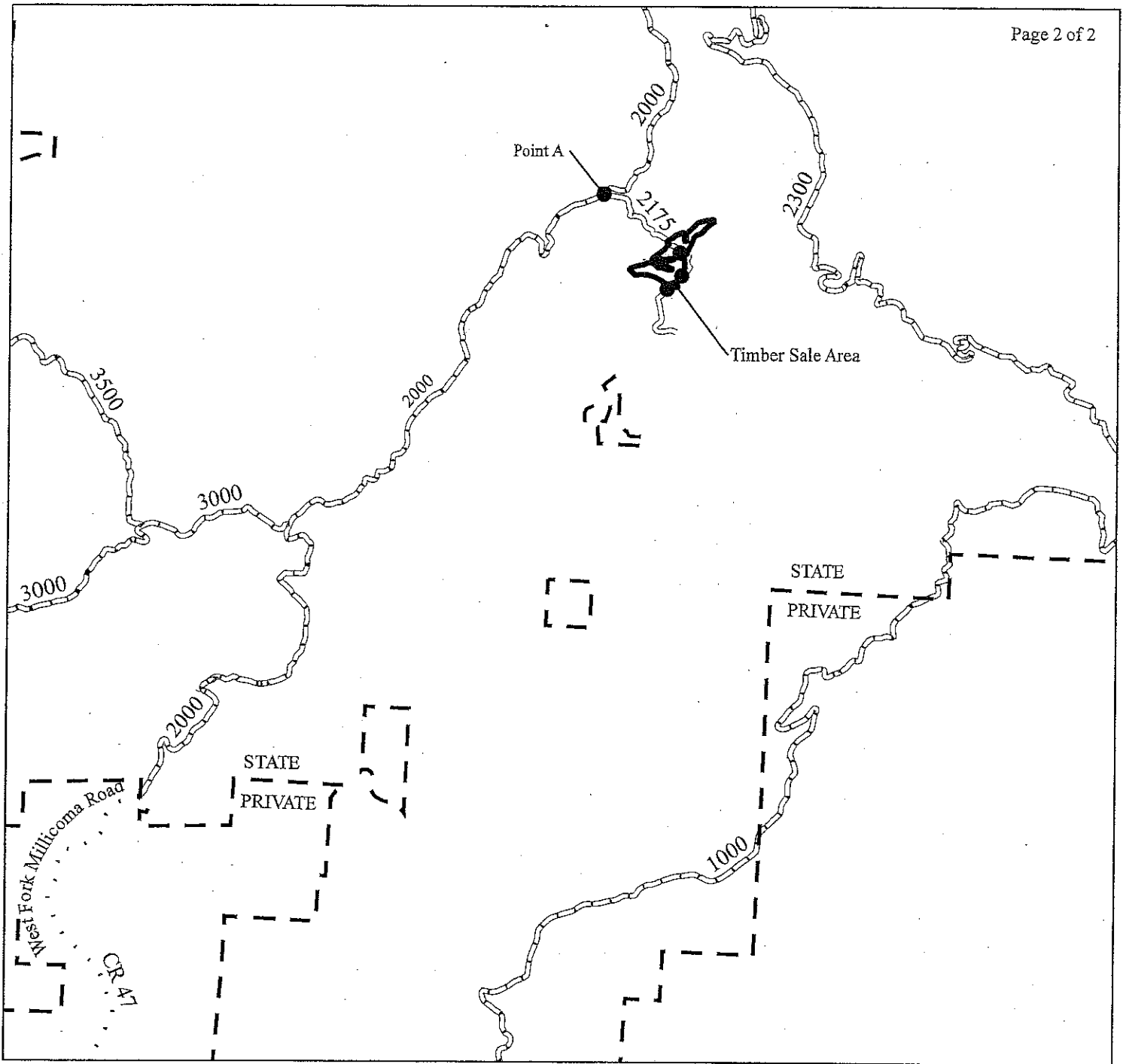

EXHIBIT A

Vicinity Map
 Of Timber Sale Contract No.
 STULLS RIDGE STEER
 341-11-45

Portions of Sections 33 and 34, T23S, R11W, and
 Portions of Section 3, T24S, R11W, W.M.
 Coos County, Oregon
 Approximately 27 net harvest acres

Approx. Scale: 1 inch = 4,000 feet



Legend

- Stulls Ridge Steer Sale Area
- Project Point
- Roads**
- Purchaser Maintained Road
- State Maintained Road
- County Road
- Elliott State Forest Boundary



This product is for informational use and may not have been prepared for, or suitable for legal, engineering, or surveying purposes.