



Exhibit "A" Vicinity Map

OF TIMBER SALE CONTRACT NO. 341-11-05
LION'S LAIR
PORTIONS OF SECTIONS 12, 13, and 14,
T6N, R7W, W.M., CLATSOP COUNTY, OREGON

Approximate Net Acreage:
Area 1 (MC) - 40
Area 2 (MC) - 61
Area 3 (MC) - 37
Area 4 (R/W) - 4
Total Sale Acreage 142

- Legend Page 1 of 2
- Registered Water Use Site
 - Pt. "A" Point for Project Work
 - Waste Area
 - Existing Surfaced Road
 - Paved Road
 - Sections
 - Ownership Boundary
 - New Road Construction
 - Timber Sale Area

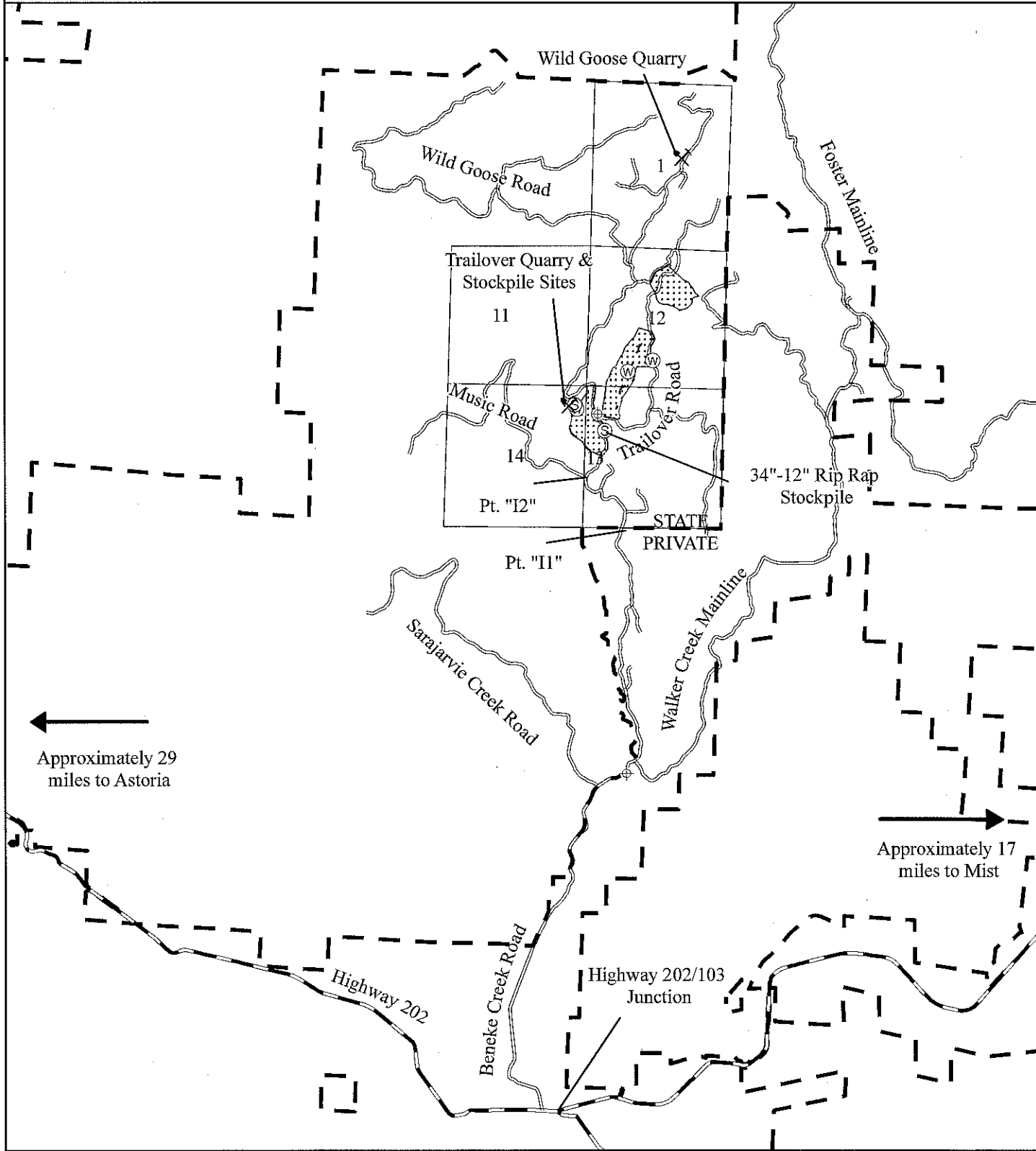

Exhibit "A"

OF TIMBER SALE CONTRACT NO. 341-11-05
LION'S LAIR
PORTIONS OF SECTIONS 12, 13, and 14,
T6N, R7W, W.M., CLATSOP COUNTY, OREGON

Approximate Net Acreage:

Area 1 (MC) - 40

Area 2 (MC) - 61

Area 3 (MC) - 37

Area 4 (R/W) - 4

Total Sale Acreage 142

Legend

- Pt. "A" Point for Project Work
- Type F Stream
- Type N Stream
- ⊙ New Construction Landing
- Right of Way Boundary
- Ⓜ Waste Area
- ⊕ Registered Water Use Site
- Ownership Boundary
- Existing Surfaced Road
- New Road Construction
- Green Tree Retention Area
- Reforestation Area
- Timber Sale Boundary
- Buffer Zone
- Posted Stream Buffer
- Survey Corner

Approximate Scale = 1":1,000'

500 250 0 500 1,000 Feet

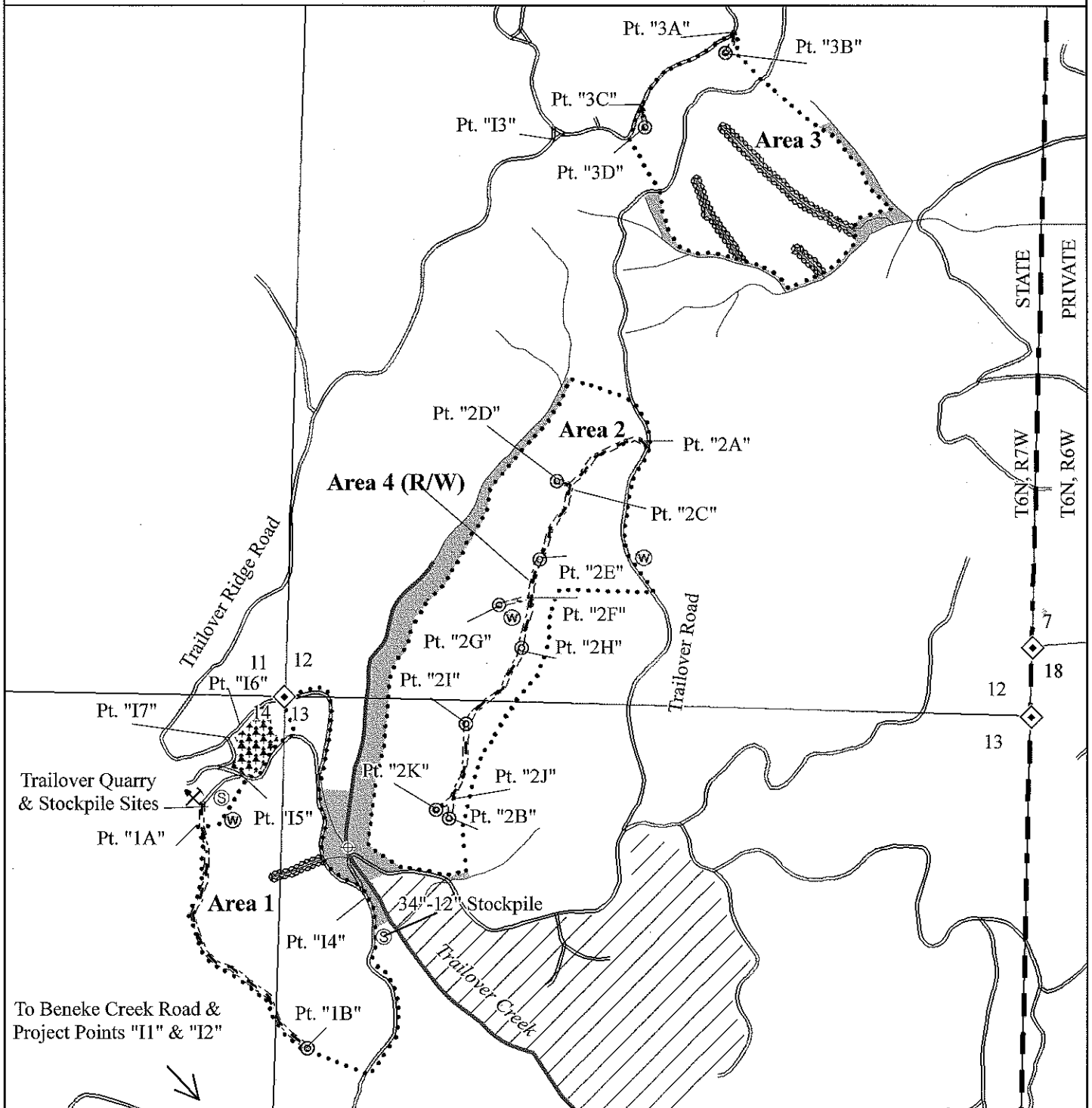

To Beneke Creek Road & Project Points "I1" & "I2"