

- Rock source
- Stock pile
- Waste area
- Bridge
- Gate
- Survey corner
- Domestic water supply intake
- Buffer
- Green tree retention area

- Area boundary
- Sale boundary
- Ownership boundary
- Perennial Type-F stream
- Perennial Type-N stream
- Unsurfaced road
- Surfaced road
- State/Federal highway
- Legacy road
- Cultural resource

- Blocked road
- Road construction
- County road
- OHV trail
- Non-motorized trail
- Transmission line

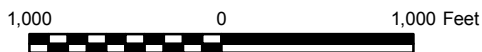

EXHIBIT A

Timber Sale Contract No. 341-10-38
Steam Donkey

Portions of Sections 34 and 35, T1N, R7W,
and Portions of Section 2,
T1S, R7W, W.M.,
Tillamook County, Oregon

| Area | Type of Operation | Acres | |
|-------|-------------------|-------|-----|
| | | Gross | Net |
| 1 | Modified Clearcut | 34 | 34 |
| 2 | Modified Clearcut | 119 | 96 |
| Total | | 153 | 130 |

Tillamook District GIS 06/08/2009

This product is for informational use and may not have been prepared for, or suitable for legal, engineering, or surveying purposes.

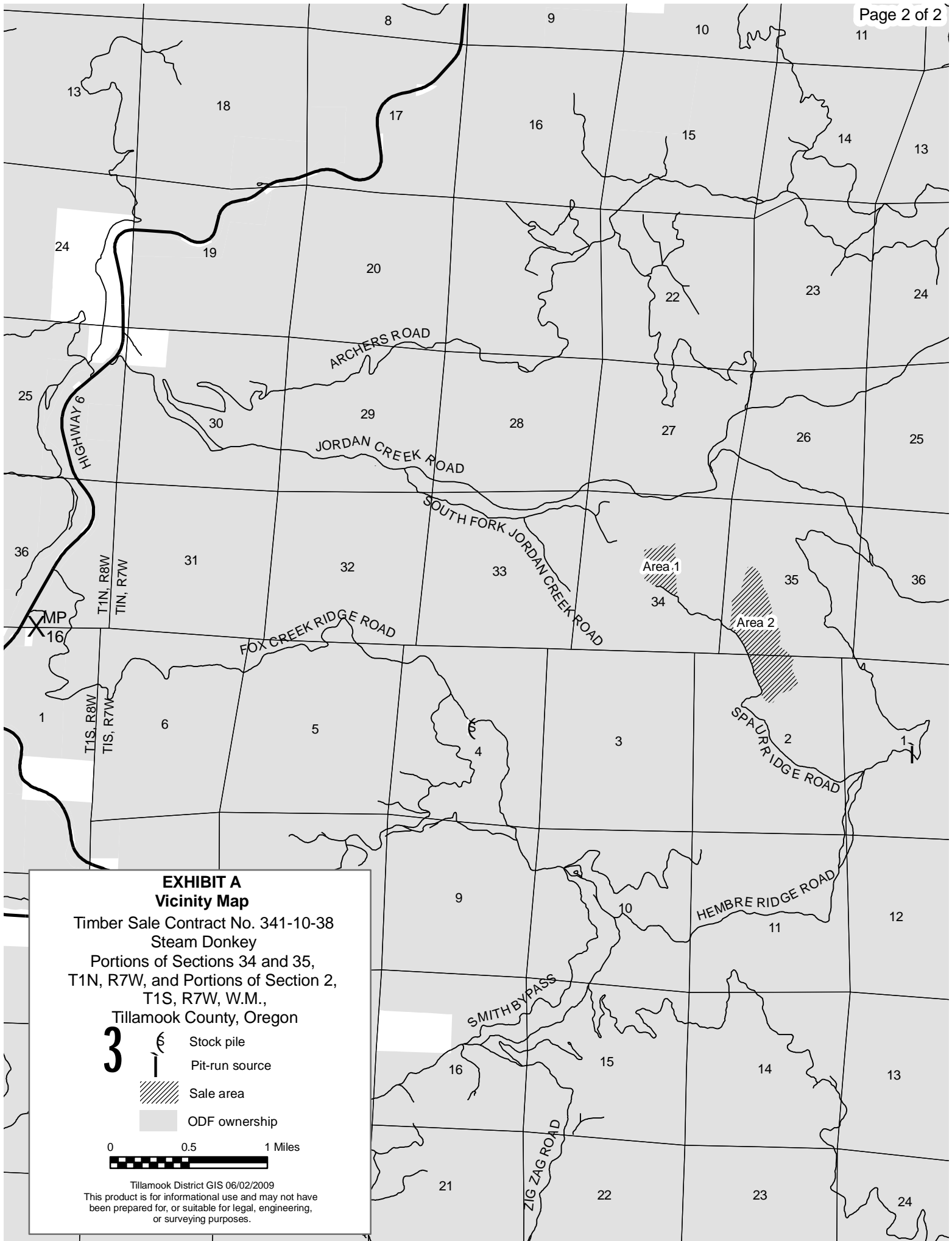

EXHIBIT A Vicinity Map

Timber Sale Contract No. 341-10-38
Steam Donkey
Portions of Sections 34 and 35,
T1N, R7W, and Portions of Section 2,
T1S, R7W, W.M.,
Tillamook County, Oregon

3



Stock pile



Pit-run source



Sale area



ODF ownership

0 0.5 1 Miles



Tillamook District GIS 06/02/2009

This product is for informational use and may not have
been prepared for, or suitable for legal, engineering,
or surveying purposes.