

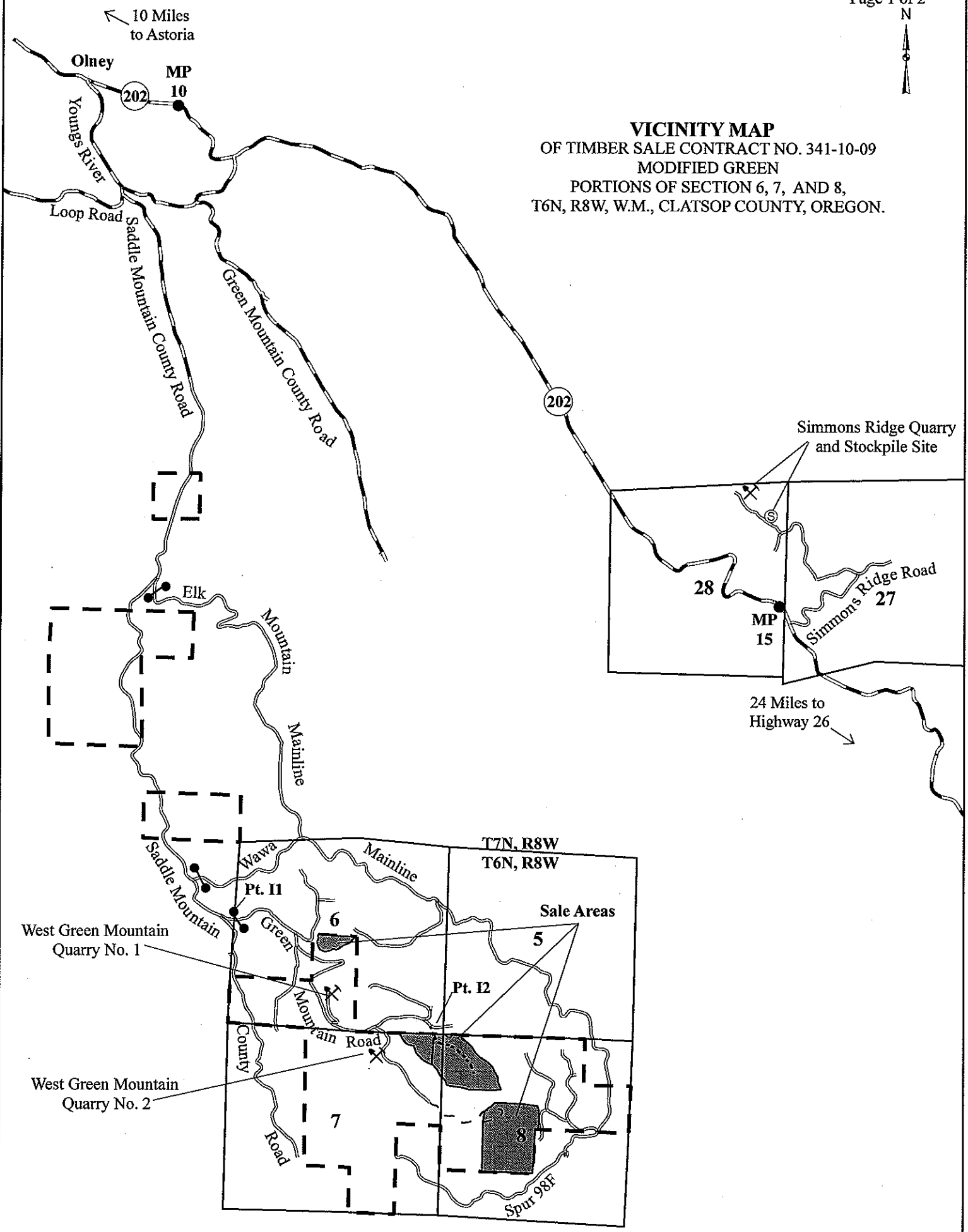

**VICINITY MAP**  
OF TIMBER SALE CONTRACT NO. 341-10-09  
MODIFIED GREEN  
PORTIONS OF SECTION 6, 7, AND 8,  
T6N, R8W, W.M., CLATSOP COUNTY, OREGON.



10 Miles to Astoria

Simmons Ridge Quarry and Stockpile Site

24 Miles to Highway 26

West Green Mountain Quarry No. 1

West Green Mountain Quarry No. 2

Sale Areas

T7N, R8W  
T6N, R8W

Spur 98F

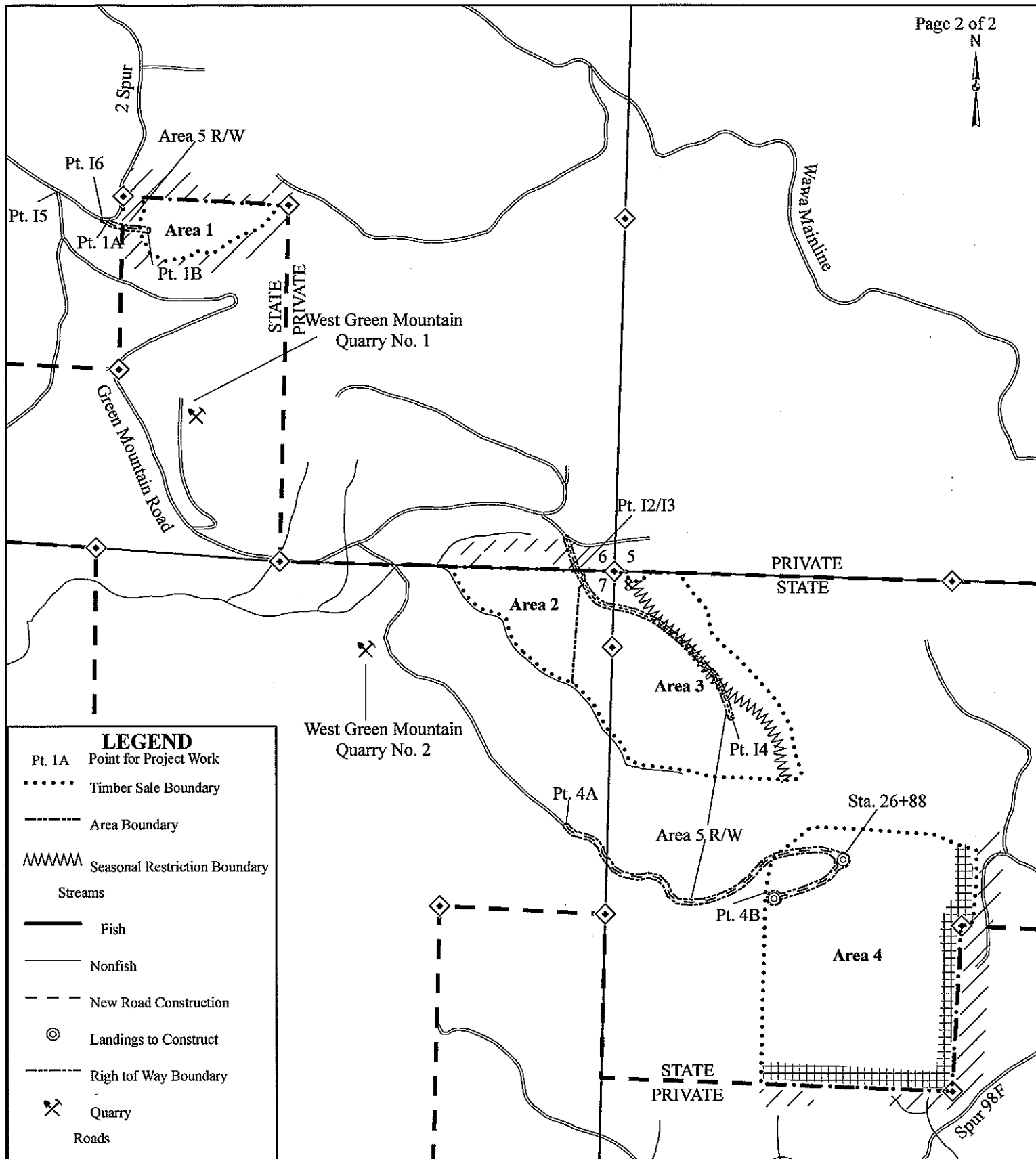

**LEGEND**

- Pt. 1A Point for Project Work
- ..... Timber Sale Boundary
- Area Boundary
- ~~~~~ Seasonal Restriction Boundary
- Streams
- Fish
- Nonfish
- - - New Road Construction
- ⊙ Landings to Construct
- Right of Way Boundary
- ⌘ Quarry
- Roads
- Paved
- Rocked
- Unsurfaced
- ▒ Top Attached Yarding
- ▒ Reforestation Area
- [-] Ownership

**EXHIBIT A**  
 OF TIMBER SALE CONTRACT NO. 341-10-09  
 MODIFIED GREEN  
 PORTIONS OF SECTION 6, 7, AND 8,  
 T6N, R8W, W.M., CLATSOP COUNTY, OREGON.  
 APPROXIMATE SCALE 1"=1,000'

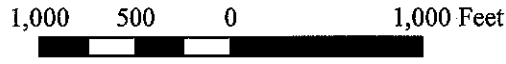

APPROXIMATE ACREAGE		
AREA	MC ACRES	PC ACRES
AREA 1	8.1	
AREA 2	11.8	
AREA 3		48.8
AREA 4	68.6	
AREA 5 R/W	1.7	
<b>TOTAL</b>	<b>90.2</b>	<b>48.8</b>
<b>TOTAL ALL AREAS - 139</b>		