

LEGEND

- Landing
- + Project Point
- ▬ Posted Sale Boundary
- Roads**
- ▬ State Maintained Road
- ▬ Purchaser Maintained Road
- ▬ New Road Construction
- ▬ Right of Way Boundary
- ▬ Elliott State Forest Boundary
- Streams**
- ▬ Type F
- ▬ Type N Perennial
- ▬ Type N Seasonal
- ▨ Stream Buffer
- ▨ Reforestation
- Green Tree Retention Group
- × Green Tree Retention Single
- Marbled Murrelet Management Area
- ▨ Seasonal Restricted

APPROXIMATE ACREAGE

AREA I	47
AREA II	14
AREA III	20
TOTAL	81

EXHIBIT "A"

SOUTH MARLOW SWITCH
 341-09-27
PORTIONS OF SECTIONS 29 & 32
T24S, R11W
COOS COUNTY, OREGON
APPROXIMATELY 81 NET HARVEST ACRES

APPROX. SCALE: 1" = 1000'



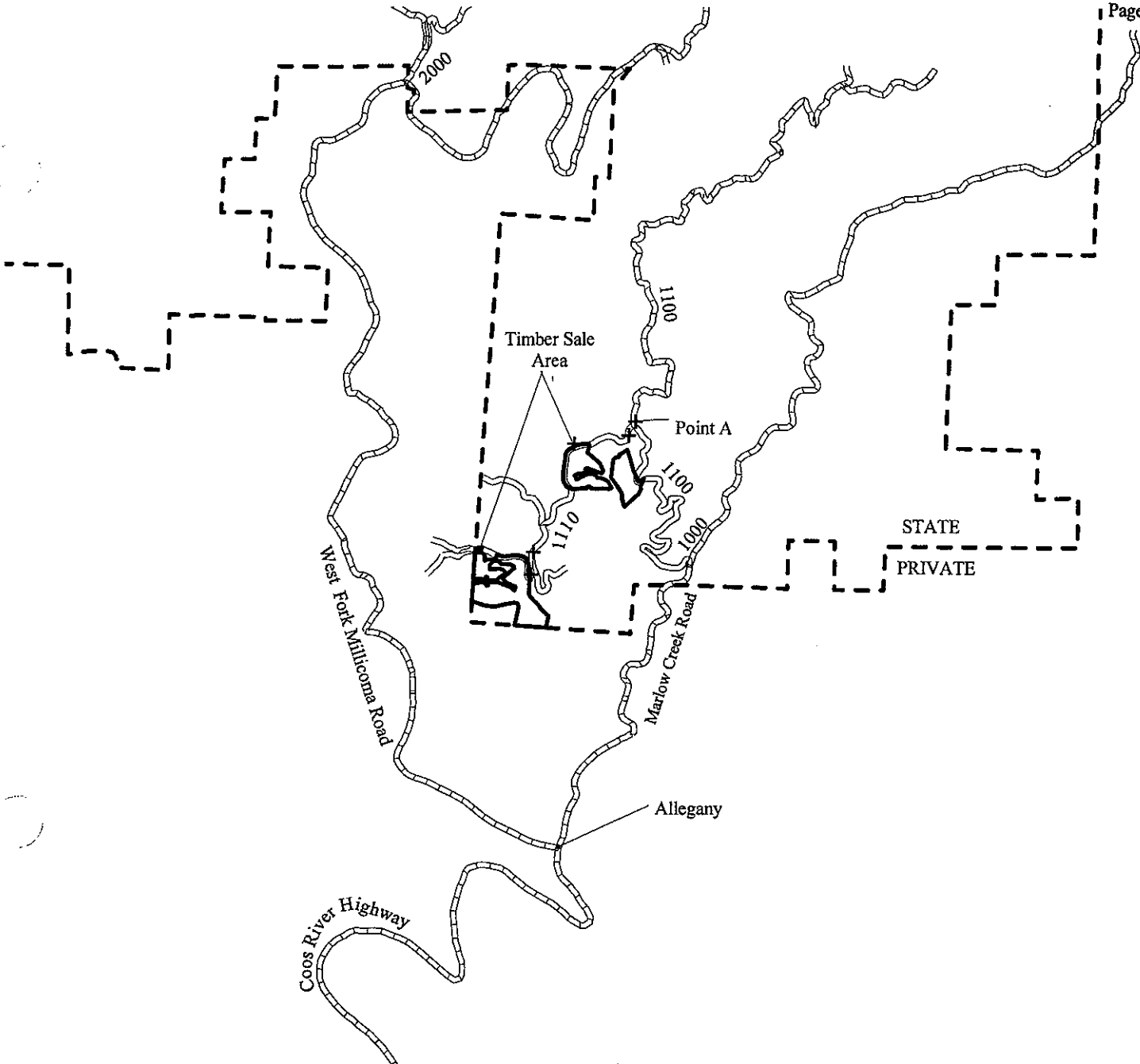

LEGEND

- South Marlow Switch Sale Area
- Project Point
- Roads**
- State Maintained Road
- Purchaser Maintained Road
- Elliott State Forest Boundary

APPROXIMATE ACREAGE

AREA I	47
AREA II	14
AREA III	20
TOTAL	81

EXHIBIT "A"

VICINITY MAP
SOUTH MARLOW SWITCH
 341-09-27
 PORTIONS OF SECTIONS 29 & 32
 T24S, R11W
 COOS COUNTY, OREGON
 APPROXIMATELY 81 NET HARVEST ACRES



APPROX. SCALE: 1:48,000



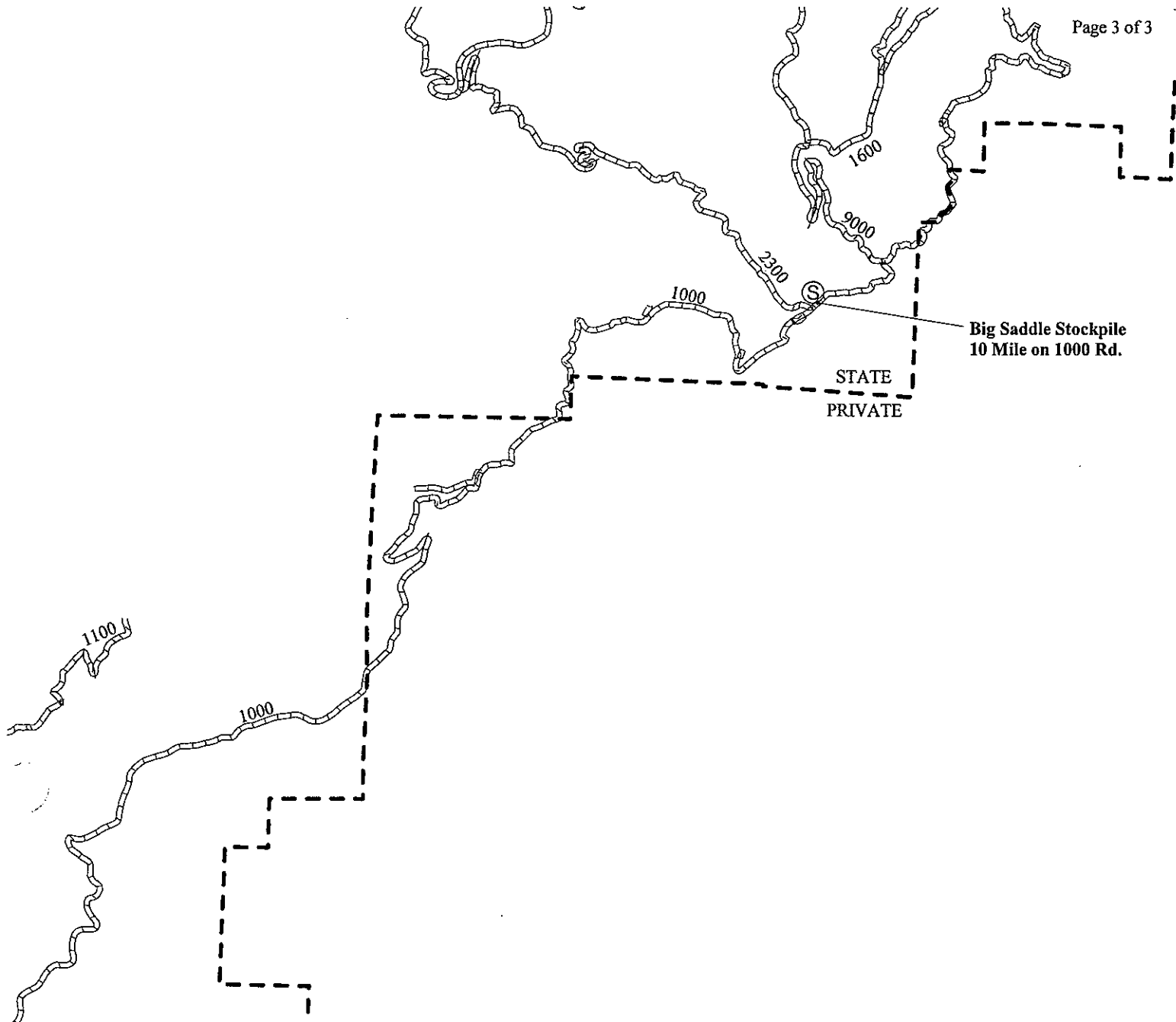

EXHIBIT "A"

- LEGEND
- Ⓢ Stockpile Site
 - Roads
 - State Maintained Road
 - Elliott State Forest Boundary

VICINITY MAP
 SOUTH MARLOW SWITCH
 341-09-27
 PORTIONS OF SECTIONS 29 & 32
 T24S, R11W
 COOS COUNTY, OREGON
 APPROXIMATELY 81 NET HARVEST ACRES



APPROX. SCALE: 1:48,000

