



"STEWARDSHIP IN FORESTRY"

Timber Sale Appraisal
Jackstraw
Sale 341-08-47

District: Klamath/Lake

Date: July 02, 2007

Cost Summary

	Conifer	Hardwood	Total
Gross Timber Sales Value	\$237,637.94	\$0.00	\$237,637.94
		Project Work:	\$(4,569.80)
		Advertised Value:	\$233,068.14



"STEWARDSHIP IN FORESTRY"

Timber Sale Appraisal
 Jackstraw
 Sale 341-08-47

District: Klamath/Lake

Date: July 02, 2007

Timber Description

Location: Portions of Sections 10, 13, 14, & 15, T33S, R71/2E, W.M., Klamath County, Oregon.

Stand Stocking: 20%

SpecieName	AvgDBH	Amortization (%)	Recovery (%)
White Fir	14	0	97
Sugar Pine	19	0	97
Ponderosa Pine	15	0	97
Lodgepole Pine	12	0	95

Volume by Grade	Camprur	CR 14" -	CR 22"+	CR 6" - 8	CR 8" - 1	Total
White Fir	0	65	0	85	147	297
Sugar Pine	0	0	0	1	1	2
Ponderosa Pine	0	245	20	265	491	1,021
Lodgepole Pine	200	0	0	0	0	200
Total	200	310	20	351	639	1,520

Comments: Pond Values Used: 2nd Quarter Calendar Year 2007.

Log Markets: Klamath Falls and Medford

HAULING

Hauling costs equivalent to \$700 daily truck cost.

Other Costs (Profit and Risk to be added):

Brand and Paint: \$1,440

Dust Abatement: \$4,958

TOTAL Other Costs (Profit and Risk to be added) = \$6,398



"STEWARDSHIP IN FORESTRY"

Timber Sale Appraisal
Jackstraw
Sale 341-08-47

District: Klamath/Lake

Date: July 02, 2007

Logging Conditions

Combination#: 1

White Fir	72.00%
Sugar Pine	65.00%
Ponderosa Pine	62.00%
Lodgepole Pine	99.00%

Yarding Distance: Medium (800 ft) **Downhill Yarding:** No
Logging System: Wheel Skidder **Process:** Feller Buncher
Tree Size: Small / Thinning 12in (130 Bft/tree), 12-17 logs/MBF
Loads / Day: 10.0 **Bd. Ft / Load:** 3,700
Cost / MBF: \$90.65

Machines: Log Loader (B)
Stroke Delimber (B)
Feller Buncher w/ Delimber
Tire Skidder

Combination#: 2

White Fir	28.00%
Sugar Pine	35.00%
Ponderosa Pine	38.00%
Lodgepole Pine	1.00%

Yarding Distance: Medium (800 ft) **Downhill Yarding:** No
Logging System: Wheel Skidder **Process:** Manual Falling/Delimiting
Tree Size: Mature / Partial Cut (900 Bft/tree), 3-5 logs/MBF
Loads / Day: 10.0 **Bd. Ft / Load:** 4,400
Cost / MBF: \$72.18

Machines: Log Loader (B)
Tire Skidder



"STEWARDSHIP IN FORESTRY"

Timber Sale Appraisal
 Jackstraw
 Sale 341-08-47

District: Klamath/Lake

Date: July 02, 2007

Logging Costs

Operating Seasons:	1.00	Profit Risk:	12.00%
Project Costs:	\$4,569.80	Other Costs (P/R):	\$6,398.00
Slash Disposal:	\$0.00	Other Costs:	\$0.00

Miles of Road

Road Maintenance: \$0.38

Dirt	Rock (Contractor)	Rock (State)	Paved
0.0	0.0	0.0	0.0

Hauling Costs

Species	\$ / MBF	Trips/Day	MBF / Load
White Fir	\$0.00	3.0	4.0
Sugar Pine	\$0.00	3.0	3.5
Ponderosa Pine	\$0.00	3.0	3.5
Lodgepole Pine	\$0.00	3.0	3.5



"STEWARDSHIP IN FORESTRY"

Timber Sale Appraisal
Jackstraw
Sale 341-08-47

District: Klamath/Lake

Date: July 02, 2007

Local Pond Values

Date	Specie	Grade	Value
7/2/07	White Fir	CR 6" - 8"	\$340.00
7/2/07	White Fir	CR 8" - 14"	\$345.00
7/2/07	White Fir	CR 14" - 22"	\$350.00
7/2/07	White Fir	CR 22"+	\$350.00
7/2/07	Sugar Pine	CR 6" - 8"	\$320.00
7/2/07	Sugar Pine	CR 8" - 14"	\$330.00
7/2/07	Sugar Pine	CR 14" - 22"	\$400.00
7/2/07	Sugar Pine	CR 22"+	\$500.00
7/2/07	Ponderosa Pine	CR 6" - 8"	\$270.00
7/2/07	Ponderosa Pine	CR 8" - 14"	\$310.00
7/2/07	Ponderosa Pine	CR 14" - 22"	\$410.00
7/2/07	Ponderosa Pine	CR 22"+	\$490.00
7/2/07	Lodgepole Pine	Camprun	\$315.00



"STEWARDSHIP IN FORESTRY"

Timber Sale Appraisal
 Jackstraw
 Sale 341-08-47

District: Klamath/Lake

Date: July 02, 2007

Logging Costs Breakdown

Logging	Road Maint	Fire Protect	Hauling	Other P/R appl	Profit & Risk	Slash Disposal	Scaling	Other	Total
White Fir									
\$85.48	\$0.39	\$2.88	\$53.64	\$4.21	\$17.59	\$0.00	\$2.00	\$0.00	\$166.19
Sugar Pine									
\$84.19	\$0.39	\$2.88	\$61.31	\$4.21	\$18.36	\$0.00	\$2.00	\$0.00	\$173.34
Ponderosa Pine									
\$83.63	\$0.39	\$2.88	\$61.31	\$4.21	\$18.29	\$0.00	\$2.00	\$0.00	\$172.71
Lodgepole Pine									
\$90.47	\$0.40	\$2.88	\$62.50	\$4.21	\$19.26	\$0.00	\$2.00	\$0.00	\$181.72

Specie	Amortization	Pond Value	Stumpage	Amortized
White Fir	\$0.00	\$344.66	\$178.47	\$0.00
Sugar Pine	\$0.00	\$325.00	\$151.66	\$0.00
Ponderosa Pine	\$0.00	\$327.14	\$154.43	\$0.00
Lodgepole Pine	\$0.00	\$315.00	\$133.28	\$0.00



"STEWARDSHIP IN FORESTRY"

Timber Sale Appraisal
Jackstraw
Sale 341-08-47

District: Klamath/Lake

Date: July 02, 2007

Summary

Amortized

Specie	MBF	Value	Total
White Fir	0	\$0.00	\$0.00
Sugar Pine	0	\$0.00	\$0.00
Ponderosa Pine	0	\$0.00	\$0.00
Lodgepole Pine	0	\$0.00	\$0.00

Unamortized

Specie	MBF	Value	Total
White Fir	297	\$178.47	\$53,005.59
Sugar Pine	2	\$151.66	\$303.32
Ponderosa Pine	1,021	\$154.43	\$157,673.03
Lodgepole Pine	200	\$133.28	\$26,656.00

Gross Timber Sale Value

Recovery: \$237,637.94

Prepared by: Steven Jones

Phone: 541-883-5681

Summary of Project Work



"STEWARDSHIP IN FORESTRY"

Jackstraw
341-08-47

Project # 1: Felling, yarding, and piling of
submerchantable trees and pulp wood \$ 4,569.80

Total: \$4,569.80

Jackstraw

Additional Work and Project Work

341-08-47



Additional Work

Road Maintenance

Move-in cost (grader):	\$ 300.00	Total Grading Hours:	3
Number of Bladings	1	Grading Cost:	\$ 285.00
Number of Miles to be Bladed	1.5	Total Cost:	\$ 585.00
Miles / Hour for equipment	0.5	Cost / MBF	\$ 0.38
Cost / Hour:	\$ 95.00		

Dust Abatement (Profit & Risk Included)

PP & SP	1,023,004	BF	67%	Average Load	3500	BF	292	# of Loads
WF	296,884	BF	20%	Average Load	4000	BF	74	# of Loads
LP	200,039	BF	13%	Average Load	3500	BF	57	# of Loads
Total:	1,519,927	BF					Total Loads	424

Assume:	4	Trucks/Day	36	Hauling Days
	3	Trips / Day	20	Possible # of Summer Haul
	12	Loads Per Day	3	Hours / Day

Assume June 15 thru October 15 at 22 hauling days / month for a summer haul period.

\$ 80.00	Cost / Hour
60	Total Hours
\$ 158.00	Move-In for Water Truck
\$ 4,800.00	Dust Abatement Cost
\$ 4,958.00	Total Cost
\$ 3.26	Cost / MBF

Brand & Paint (Profit and Risk Included)

36	Hauling Days
2	Hours / Day
\$ 20.00	Cost / Hour
\$ 1,440.00	Total Cost
\$ 0.95	Cost / MBF

Project Work

Project #1 Fell, Skid, & Pile Submerchantable Material

60.80	Total Subswaglog Volume MBF	47,296	Green Pulp (Variable Plot)
\$ 42.50	Fell & Skid / MBF	13,500	Green Pulp (Fixed Plot)
\$ 7.50	Sort / MBF	60,796	Total Board Feet
\$ 50.00	Total / MBF		
\$ 3,039.8	Total Cost		

Landing Cleanup (included with Project # 1)

17	Number of Landings		
	Shovel Time:	0.75	Hour / Landing
		\$ 120.00	Cost / Hour \$ 1,530.00
			Total Cost: \$ 1,530.00

Cost Summary

\$ 3,039.80	Project #1 ~ Fell, Skid, & Pile Submerch. Material	Other Costs
\$ 1,530.00	Landing Cleanup	\$ 585.00 Road Maintenance
		\$ 4,958.00 Dust Abatement
		\$ 1,440.00 Brand & Paint
\$ 4,569.80	Total Cost	\$ 6,983.00 Total Cost

Jackstraw

341-08-47
Cruise Report



"STEWARDSHIP IN FORESTRY"

SALE NAME: Jackstraw

LEGAL DESCRIPTION: Portions of Sections 10, 13, 14, and 15 of Township 33 South, Range 7 ½ East, W. M.

BOUNDARY LINES & SALE POSTINGS:

Unit boundaries are posted with "Timber Sale Boundary" signs, marked with fluorescent orange paint and orange flagging. Required road clearing is marked with blue paint on cut trees.

FUND: 100% B.O.F.

ACREAGE: The timber sale was delineated into four harvest units based upon location.

Timber Sale	Acres
Area I	85
Area II	150
Area III	5
232 Right-of-Way Clearing	N / A
Approximate Sale Acreage	240 acres

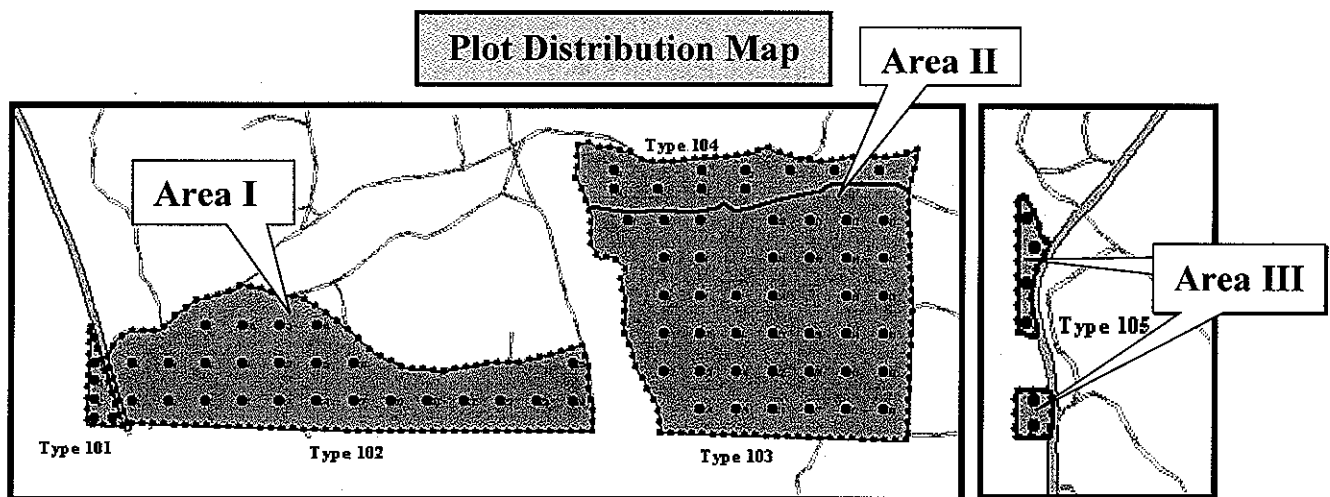

Mapping was accomplished using a handheld Global Positioning System unit with the data run on the district Geographical Information System Program.

TREATMENT:

Area I is a single tree selection cut with leave trees marked with orange paint.
Area II is a single tree selection cut with leave trees marked with orange paint.
Area III is a single tree selection cut with leave trees marked with orange paint.
Highway 232 road right-of-way is a cut tree mark approximately 30 feet perpendicular either direction from the painted centerline of the road.
Both Areas I and II utilize group selection, thinning from below, overstory removal, and shelterwood to accomplish silvicultural objectives. Area III is a single tree selection thinning.
Wildlife trees are designated with an orange "W".

CRUISE METHOD:

Areas I, II, and III utilize a variable plot cruise with all plots being measure plots. Area II, Type 104 also utilized 1/50th acre fixed plot cruise for all submerchantable material (5.0" to 8.0") to measure submerchantable volume for project work crediting. The Highway 232 road right-of-way trees were 20% sample cruised with every fifth blue marked tree measured and recorded.

BASAL AREA FACTOR:

Type	BAF	Type Acreage
Type 101	14	3.4
Type 102	14	81.3
Type 103	10	122.3
Type 104	14	27.3
Type 105	14	4.7

Full point plots taken, 1/50th acre fixed plots for submerchantable material (5.0" to 8.0" DBH) on Area II, Type 104.

PLOT DESIGNATION:

Plot centers were established at every plot using a blue wire flag with the plot number identified on the flag. White flagging with the corresponding plot number was attached to the nearest available tree branch.

SAMPLE SIZE CALCULATIONS:

Timber Sale Area	Coefficient of Variation	Desired Standard Error %	Type Acreage
Types 101 thru 105	109	12	240

$$\text{Number of Plots} = \frac{T^2 C^2}{A^2}$$

C = Coefficient of Variation in Percent (Taken from inventory data)

T = Number of Standard Errors

A = Desired Sampling Error for a sale of this size and value

Timber Sale Area Number of Plots: $\frac{(1)^2(109)^2}{12^2} = 83 \text{ Plots}$

Measurements and Grading:

- DBH and Height were measured on all "in" trees in the plot.
- All plots were measure plots.
- Sawlog volume cruised.
- See attached species and grade tables for minimum requirements.
- All trees were graded using the segment system.
- Separate fixed plot cruise for all submerchantable material (5"to 8") on Area II, Type 104.

TREE HEIGHT:

All trees were measured to a fixed diameter outside bark. This height is usually taken as high up the bole as possible, where the cruiser can clearly see the bole and the taper remains constant (usually 6 or 8 inches). The log segments are broken out and graded accordingly.

MINIMUM D.B.H.:

8.0" D.B.H. for sawlog volume. (Must have a minimum of 20 board feet.)

5.0" D.B.H. for biomass volume.

DIAMETER STANDARDS:

1" diameter class

BTR:

Standard ratios were used. See attached species tables.

FORM FACTOR:

Form factor was measured or estimated at 16' for each tree. Each tree was assigned its own FF.

FORM POINT:

All trees were sighted at D.B.H.

VOLUME COMPUTATION:

All cruise data was input and run at the district office on Atterbury's Super Ace program.

CRUISERS: John Pellissier and Jason Pettigrew

FINAL CRUISE RESULTS:

Timber Sale Areas Combined	Coefficient of Variation	Standard Error %	Sale Acreage
Areas I, II, & III	72.0	7.9	240

TIMBER DESCRIPTION:

Timber Sale Area	Species	Average DBH	Net Volume (MBF)
Areas I, II, III, & Highway 232 Variable Plot	<i>White Fir</i>	13.7	296,884
	<i>Sugar Pine</i>	19.1	2,440
	<i>Ponderosa Pine</i>	14.9	1,020,564
	<i>Lodgepole Pine</i>	11.6	200,039
	Total MBF: 1,519,926		

(Volumes taken from Species, Sort Grade –Board Foot Volumes Report)

GREEN PULP VOLUME

This volume was obtained from the variable plot cruise (>8" DBH) and the fixed plot cruise (5.0"-8.0"). All material graded green pulp. See grade table for minimum standards. The summary for green pulp listed below includes all types for the timber sale.

Area II Type 104 Fixed Plot (1/50th Acre) and Green Pulp Variable Plot	Species	Green Pulp Volume (MBF)
	<i>White Fir</i>	16.15
	<i>Ponderosa Pine</i>	28.90
	<i>Lodgepole Pine</i>	16.15
		Total MBF: 61.20

(Volumes taken from Species, Sort Grade --Board Foot Volumes Report)

TC PSTATS		PROJECT STATISTICS							PAGE	1	
		PROJECT JACK							DATE	6/22/2007	
TWP	RGE	SC	TRACT	TYPE		ACRES	PLOTS	TREES	CuFt	BdFt	
33	7	10	JACK	105	THR	237.70	83	544	S	W	
33	7	14	VARIABLE	104							
		PLOTS	TREES	TREES PER PLOT	ESTIMATED TOTAL TREES		PERCENT SAMPLE TREES				
TOTAL		83	544	6.6							
CRUISE		81	544	6.7	17,256		3.2				
DBH COUNT											
REFOREST COUNT											
BLANKS		2									
100 %											
STAND SUMMARY											
	SAMPLE TREES	TREES /ACRE	AVG DBH	BOLE LEN	REL DEN	BASAL AREA	GROSS BF/AC	NET BF/AC	GROSS CF/AC	NET CF/AC	
PONDEROS	354	41.6	14.9	41		50.1	4,002	3,972	1,101	1,101	
CON FIR	97	14.6	13.7	38	3	15.0	1,299	1,284	346	346	
LP PINE	91	16.3	11.6	36		12.0	899	894	252	252	
SUG.PINE	2	.1	19.1	42		.3	10	10	4	4	
TOTAL	544	72.6	14.0	39		77.3	6,210	6,160	1,704	1,704	
CONFIDENCE LIMITS OF THE SAMPLE											
68.1 TIMES OUT OF 100 THE VOLUME WILL BE WITHIN THE SAMPLE ERROR											
CL	68.1	COEFF			SAMPLE TREES - BF			# OF TREES REQ.		INF. POP.	
SD:	1.0	VAR.%	S.E.%	LOW	AVG	HIGH	5	10	15		
PONDEROS		119.3	6.3	193	206	220					
CON FIR		96.5	9.8	166	184	202					
LP PINE		67.2	7.0	65	70	75					
SUG.PINE		115.7	108.3		110	229					
TOTAL		122.2	5.2	170	179	189	596	149	66		
CL	68.1	COEFF			SAMPLE TREES - CF			# OF TREES REQ.		INF. POP.	
SD:	1.0	VAR.%	S.E.%	LOW	AVG	HIGH	5	10	15		
PONDEROS		94.4	5.0	48	50	53					
CON FIR		87.4	8.9	44	48	53					
LP PINE		60.7	6.4	18	20	21					
SUG.PINE		119.7	112.1		45	95					
TOTAL		98.4	4.2	43	45	47	386	97	43		
CL	68.1	COEFF			TREES/ACRE			# OF PLOTS REQ.		INF. POP.	
SD:	1.0	VAR.%	S.E.%	LOW	AVG	HIGH	5	10	15		
PONDEROS		113.6	12.5	36	42	47					
CON FIR		332.8	36.5	9	15	20					
LP PINE		203.1	22.3	13	16	20					
SUG.PINE		677.8	74.3	0	0	0					
TOTAL		96.6	10.6	65	73	80	372	93	41		
CL	68.1	COEFF			BASAL AREA/ACRE			# OF PLOTS REQ.		INF. POP.	
SD:	1.0	VAR.%	S.E.%	LOW	AVG	HIGH	5	10	15		
PONDEROS		88.0	9.6	45	50	55					
CON FIR		269.6	29.6	11	15	19					
LP PINE		187.3	20.5	10	12	14					
SUG.PINE		640.3	70.2	0	0	0					
TOTAL		71.6	7.9	71	77	83	205	51	23		
CL	68.1	COEFF			NET BF/ACRE			# OF PLOTS REQ.		INF. POP.	
SD:	1.0	VAR.%	S.E.%	LOW	AVG	HIGH	5	10	15		
PONDEROS		86.1	9.4	3,597	3,972	4,347					
CON FIR		254.4	27.9	926	1,284	1,642					
LP PINE		204.8	22.5	693	894	1,095					
SUG.PINE		770.1	84.5	2	10	19					
TOTAL		72.0	7.9	5,674	6,160	6,646	207	52	23		
CL	68.1	COEFF			NET CUFT FT/ACRE			# OF PLOTS REQ.		INF. POP.	
SD:	1.0	VAR.%	S.E.%	LOW	AVG	HIGH	5	10	15		
PONDEROS		84.1	9.2	999	1,101	1,203					
CON FIR		255.5	28.0	249	346	444					
LP PINE		198.8	21.8	197	252	307					
SUG.PINE		788.1	86.4	1	4	8					
TOTAL		69.7	7.6	1,574	1,704	1,834	194	48	22		

Jackstraw Cruise Data

Area I						
Type 101						
Species	Camprun BF / Acre	Green Pulp BF/Acre	Acres	Total Board Feet (Camprun Net)	Total Green Pulp	
<i>Ponderosa Pine</i>	16,363	72	3.4	55,634	245	
Type 102						
Species	Camprun BF / Acre	Green Pulp BF/Acre	Acres	Total Board Feet (Camprun Net)	Total Green Pulp	
<i>Ponderosa Pine</i>	5,344	230	81	432,864	18,630	
<i>Lodgepole Pine</i>	135	42	81	10,935	3,402	
<i>White Fir</i>	198	-	81	16,038	-	
	5,677	272		459,837	22,032	
	5,949	Total Board Feet for Area I		515,471	22,277	
Area II						
Type 103						
Species	Camprun BF / Acre	Green Pulp BF/Acre	Acres	Total Board Feet (Camprun Net)	Total Green Pulp	
<i>Ponderosa Pine</i>	2,880	36	122	351,360	4,392	
<i>Lodgepole Pine</i>	1,355	46	122	165,310	5,612	
<i>White Fir</i>	987	-	122	120,414	-	
<i>Sugar Pine</i>	20	-	122	2,440	-	
	5,242	82		639,524	10,004	
Type 104						
Species	Camprun BF / Acre	Green Pulp BF/Acre	Acres	Total Board Feet (Camprun Net)	Total Green Pulp	
<i>Ponderosa Pine</i>	2,069	41	27.3	56,484	1,119	
<i>Lodgepole Pine</i>	546	137	27.3	14,906	3,740	
<i>White Fir</i>	5,685	372	27.3	155,201	10,156	
	8,300	550		226,590	15,015	
		Total Board Feet for Area II		866,114	25,019	
Area III						
Type 105						
Species	Camprun BF / Acre	Green Pulp BF/Acre	Acres	Total Board Feet (Camprun Net)	Total Green Pulp	
<i>Ponderosa Pine</i>	6,494	-	4.7	30,522	-	
<i>Lodgepole Pine</i>	1,891	-	4.7	8,888	-	
<i>White Fir</i>	1,079	-	4.7	5,071	-	
	9,464			44,481	-	
		Total Board Feet for Area III		44,481	-	
Highway 232 Right-of-Way						
Species	Camprun BF / Acre	Green Pulp BF/Acre	Acres	Total Board Feet (Camprun Net)	Total Green Pulp	
<i>Ponderosa Pine</i>	93,700	-	1	93,700	-	
<i>White Fir</i>	160	-	1	160	-	
	93,860			93,860	-	
		Total Board Feet for Right-of-Way		93,860	-	

	Camprun Sawlog (BF)	Green Pulp (BF)	Area 104 Pulp	Total Pulp
Total Board Feet for Timber Sale	1,519,926	47,296		
<i>Ponderosa Pine</i>	1,020,564	24,386	4509	28,895
<i>Lodgepole Pine</i>	200,039	12,754	2997	15,751
<i>White Fir</i>	296,884	10,156	5994	16,150
<i>Sugar Pine</i>	2,440			
	1,519,926	47,296	13,500	60,796

Log Stock Table - MBF

T33 R7 S10 Ty105
THRU
T33 R7 S14 Ty104

Project: JACK
Acres 238.70

Page 2
Date 6/22/2007
Time 1:00:18PM

Spp	S T	So rt	Gr de	Log Len	Gross MBF	Def %	Net MBF	% Spc	Net Volume by Scaling Diameter in Inches												
									2-3	4-5	6-7	8-9	10-11	12-13	14-15	16-19	20-23	24-29	30-39	40+	
PP		CR	GP	18	1		1	.1		1											
PP		CR	GP	20	0		0	.0				0									
PP		CR	GP	21	1		1	.1		1											
PP		CR	GP	22	5		5	.5		5											
PP		CR	GP	24	1		1	.1		1											
PP		CR	GP	27	0		0	.0			0										
PP		CR	GP	29	2		2	.2		2											
PP		CR	GP	36	2		2	.2		2											
PP		Totals			1,045		1,038	66.6		23	259	131	160	145	105	152	48	16			
LP		CR	CR	12	4		4	2.0			0	1	3								
LP		CR	CR	17	34	2.0	33	15.6		1	26	2	3	2							
LP		CR	CR	27	55		55	26.1			24	26		6							
LP		CR	CR	34	81		80	37.7			41	26	12	1							
LP		CR	CR	37	1		1	.6						1							
LP		CR	CR	40	26		26	12.2			17	6	2								
LP		CR	GP	16	2		2	.8		2											
LP		CR	GP	19	1		1	.3		1											
LP		CR	GP	21	2		2	1.0		2											
LP		CR	GP	23	2		2	.8		2											
LP		CR	GP	29	5		5	2.3		2		3									
LP		CR	GP	37	2		2	.8		2											
LP		Totals			214		213	13.6		11	108	64	20	10							
SP		CR	CR	16	0		0	17.0			0										
SP		CR	CR	17	0		0	8.3			0										
SP		CR	CR	40	2		2	74.7					2								
SP		Totals			2		2	.2			1		2								
Total		All Species			1,570		1,558	100.0		46	452	219	245	202	130	192	57	16			

Species, Sort Grade - Board Foot Volumes (Project)

T33 R7 S10 Ty105 THRU T33 R7 S14 Ty104	Project: JACK Acres 238.70	Page 1 Date 6/22/2007 Time 12:58:56PM
--	---	--

S Spp	So T	Gr rt ad	% Net BdFt	Bd. Ft. per Acre Def% Gross Net			Total Net MBF	Percent of Net Board Foot Volume								Average Log			Logs Per /Acre	
								Log Scale Dia.				Log Length				Ln Ft	Bd Ft	CF/ Lf		
								6-7	8-14	15-22	23+	12-20	21-30	31-35	36-99					
WF	CR	CU																		
WF	CR	CR	96	1.2	1,252	1,237	295	29	49	22		13	18	66	3	26	70	0.74		17.6
WF	CR	GP	4		42	42	10	100				79			21	18	20	0.29		2.1
WF	Totals		20	1.2	1,294	1,279	305	31	47	21		15	18	64	3	24	63	0.71		20.2
PP	CR	CU														3		0.00		.1
PP	CR	CR	97	.7	4,276	4,246	1,013	26	48	24	2	16	18	60	6	26	78	0.82		54.3
PP	CR	GP	3		102	102	24	94	6			53	38		9	19	20	0.34		5.1
PP	Totals		67	.7	4,379	4,348	1,038	27	47	23	2	17	19	59	6	25	73	0.79		59.5
LP	CR	CR	94	.6	842	837	200	55	45			19	28	40	14	26	47	0.51		17.8
LP	CR	GP	6		53	53	13	79	21			19	67		13	24	28	0.40		1.9
LP	Totals		14	.5	895	891	213	56	44			19	30	38	14	26	45	0.50		19.7
SP	CR	CR	100		10	10	2	25	75			25			75	22	60	1.07		.2
SP	Totals		0		10	10	2	25	75			25			75	22	60	1.07		.2
Totals				0.8	6,578	6,528	1,558	32	47	20	2	17	20	57	7	25	66	0.72		99.6

TblSortGrade

Sort/Grade Table

Table Name: SUNPASS

Date: 5/7/2005

Sort	Grd	Abr	Desc	Fbr	Min Dia	Max Dia	Max Butt	Min Len	Max Len	Defect	Min Vol	Vol Type	Min Rings	Knot Size	Knot Freq	Str	Sap	Min Age	Lbs	Lbs Type	Cords	Cords Type
0		CU	CULL	G	1	0	0	1	99	0	0	M	0	0	0			0	0		0	
1		CR	CAMPRU	G	6	0	0	10	99	0	0	M	0	0	0			0	0		0	
7		GP	GRNPULP	G	3	0	0	10	99	0	0	M	0	0	0			0	0		0	
8		DP	DEADPUL	G	3	0	0	10	99	0	0	M	0	0	0			0	0		0	
9		UT	UTILITY	G	8	0	0	12	99	0	0	M	0	0	0			0	0		0	
0		CU	CULL	G	1	0	0	1	99	0	0	M	0	0	0			0	0		0	
1		CR	CAMPRU	G	1	0	0	1	99	0	0	M	0	0	0			0	0		0	

Species Table Report

TblSpecies

Table Name: SUNPASS

Date: 5/7/2005

Page: 1

Code	Abrv	Description	Bark Ratio	ASub Const	Form Factor	Wood Type	Component	Yield Table	Min Log Dia	Min Log Len	Max Log Len	Log Trim	Max Tree Dia	Max Tree Hgt.	BdFt Rule	CuFt Rule	Weight
1	PP	PPINE	.909	PP	.85	C	C	PP-EQUA-100	3	9	20	1.0	99	200	E	1	4800 C
2	WF	WHITE F	.94	NF	.87	C	C	DF-EQUA-050	3	9	20	1.0	99	200	E	1	5000 C
3	LP	LP PINE	.96	DF	.96	C	C	LP-EQUA-100	3	9	20	1.0	99	200	E	1	4800 C
4	DF	DOUG-FIR	.92	DF	.87	C	C	DF-EQUA-050	3	9	20	1.0	99	200	E	1	5700 C
5	SP	SUG PINE	.87	PP	.84	C	C	PP-EQUA-100	3	9	20	1.0	99	200	E	1	4800 C
6	IC	INC CED	.90	SS	.8	C	C	DF-EQUA-050	3	9	20	1.0	99	200	E	1	4500 C
7	RF	SH RFIR	.924	DF	.89	C	C	DF-EQUA-050	3	9	20	1.0	99	200	E	1	5000 C

LOGGING PLAN OF AREAS I, II, AND PORTIONS OF SUN MOUNTAIN ROAD RIGHT-OF-WAY

OF TIMBER SALE CONTRACT NO. 341-08-47
JACKSTRAW
PORTIONS OF SECTIONS 10, 13, 14, 15, T33S, R7.5E, W.M.
KLAMATH COUNTY, OREGON

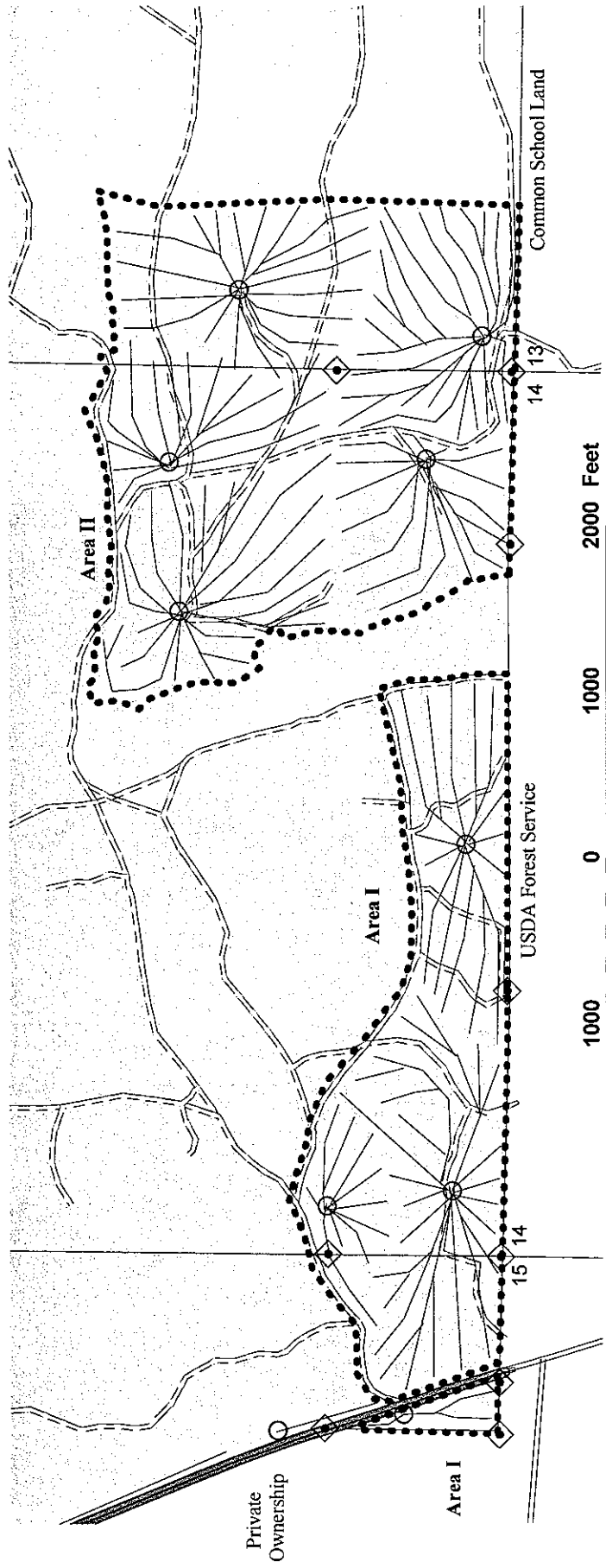

LEGEND

	Section Line		Land Survey Monument
	Board of Forestry Land		Landing
	Surfaced Road		Skid Trail
	Unsurfaced Road		Sun Mountain Road Right-of-Way Clearing
	Timber Sale Boundary		

Scale
1 : 12,000
1 inch = 1000 feet

Area I: 85 acres
Area II: 150 acres
Area III: 5 acres
Total Sale Acreage: 240 acres

AREA III & SUN MOUNTAIN ROAD RIGHT-OF-WAY LOGGING PLAN

OF TIMBER SALE CONTRACT NO. 341-08-47
JACKSTRAW
PORTIONS OF SECTIONS 10, 13, 14, 15, T33S, R7.5E, W.M.
KLAMATH COUNTY, OREGON

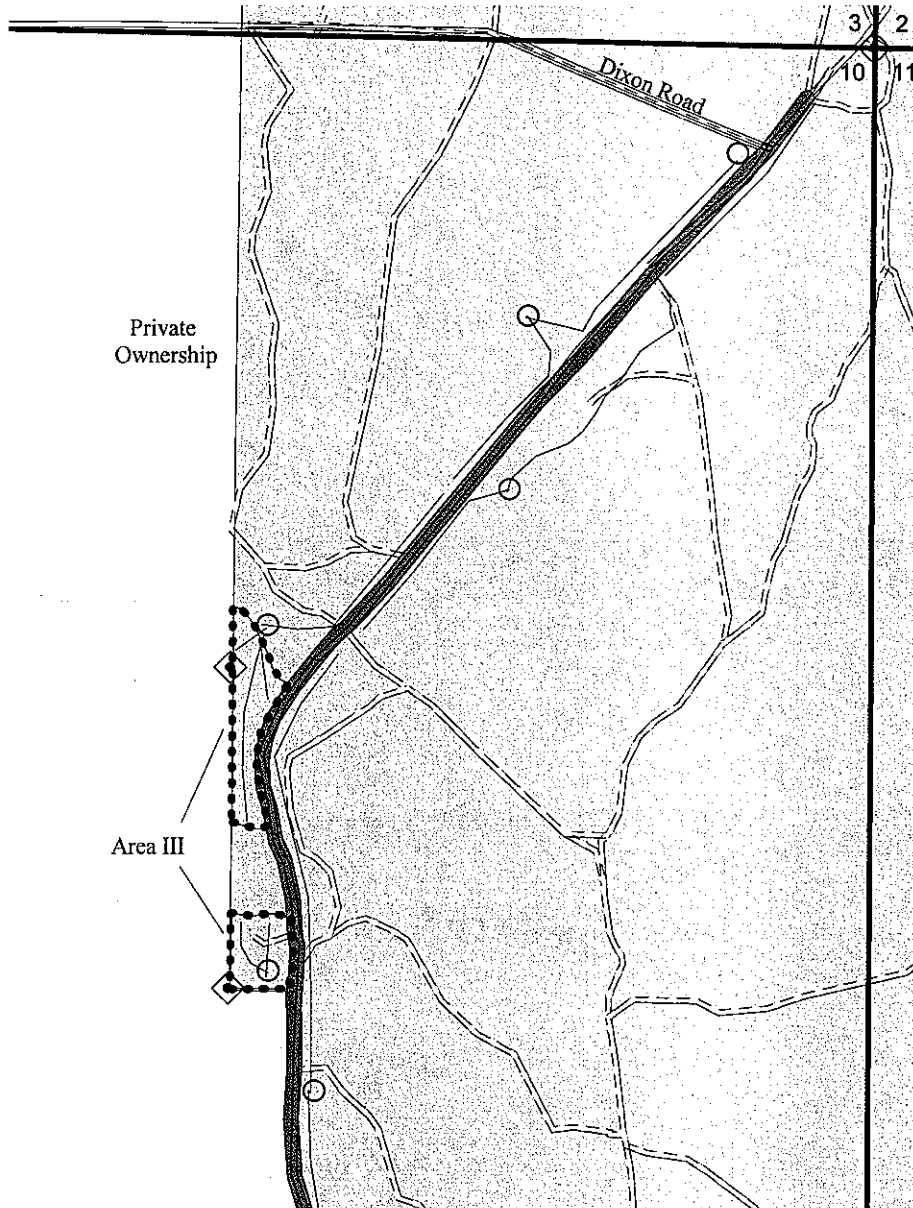

Area I: 85 acres
Area II: 150 acres
Area III: 5 acres
Total Sale Acreage: 240 acres



800 0 800 1600 Feet



Scale
1 : 9,600
1 inch = 800 feet

LEGEND

- | | | |
|-----------------|---|-------------------|
| Section Line | Land Survey Monument | Area III Boundary |
| Unsurfaced Road | Sun Mountain Road Right-of-Way Clearing | Skid Trails |
| Surfaced Road | Board of Forestry Land | Landings |