

- Rock source
- Stock pile
- Waste area
- Bridge
- Gate
- Survey corner
- Domestic water supply intake
- Buffer
- Seasonal Restriction
- Area boundary
- Sale boundary
- Ownership boundary
- Perennial Type-F stream
- Perennial Type-N stream
- Unsurfaced road
- Surfaced road
- State/Federal highway
- Legacy road
- Blocked road
- Road construction
- County road
- OHV trail
- Non-motorized trail
- Transmission line

EXHIBIT A

Timber Sale Contract No. 341-08-43
 Electric Point
 Portions of Sections 23, 26, 27,
 and 34, T1N, R10W, W. M.
 Tillamook County, Oregon

Area	Type of Operation	Acres	
		Gross	Net
1	Partial Cut	144	127
2	Partial Cut	19	18
3	Modified ClearCut	17	17
4	Modified ClearCut	2	2
Total		182	164



Tillamook District GIS
 May 23, 2007





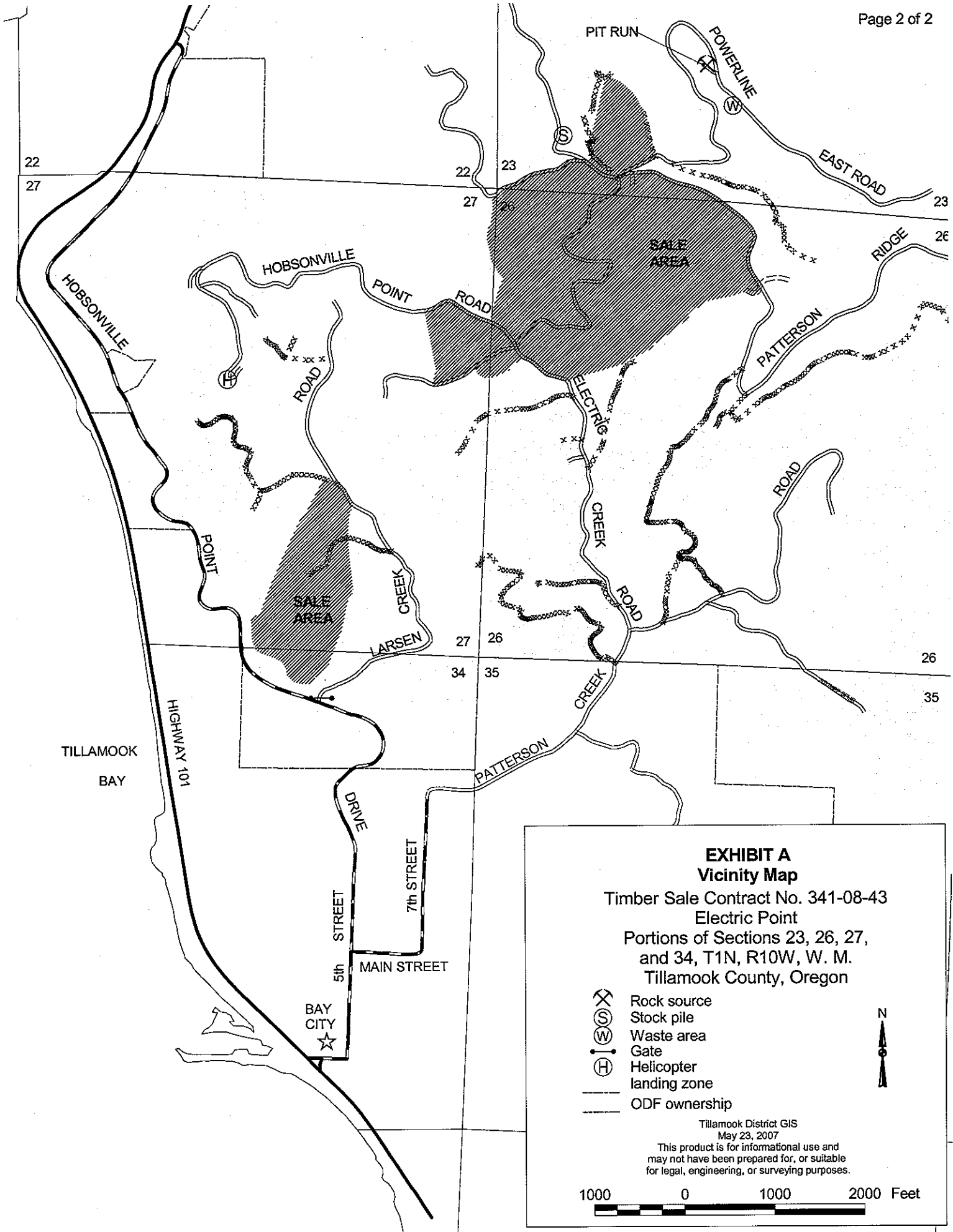

This product is for informational use and may not have been prepared for, or suitable for legal, engineering, or surveying purposes.





**EXHIBIT A
Vicinity Map**

Timber Sale Contract No. 341-08-43
Electric Point
Portions of Sections 23, 26, 27,
and 34, T1N, R10W, W. M.
Tillamook County, Oregon

-  Rock source
-  Stock pile
-  Waste area
-  Gate
-  Helicopter landing zone
-  ODF ownership



Tillamook District GIS
May 23, 2007

This product is for informational use and
may not have been prepared for, or suitable
for legal, engineering, or surveying purposes.

1000 0 1000 2000 Feet

