

- TIMBER SALE BOUNDARY
- Ground-based Operation Area
- Point for Project Work
- Existing Road - Purchaser Maintained
- Existing Road - State Maintained
- Type F Stream
- Perennial Type N Stream
- Seasonal Type N Stream
- Streambuffers
- Green Tree Retention Area
- Individual Green Tree Retention
- Reforestation Area
- Habitat Conservation Area
- Forest Ownership

EXHIBIT "A"

OF TIMBER SALE CONTRACT NO.
 341-08-33
 PILEDUP MARLOW
 PORTIONS OF SECTION 21
 T24S, R11W, WM
 COOS COUNTY, OREGON



APPROXIMATE ACRES

AREA 1: 60 ACRES
 AREA 2: 20 ACRES

TOTAL: 80 NET HARVEST ACRES

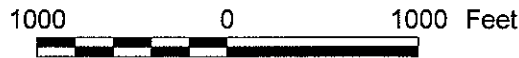

APPROX. SCALE: 1" = 1,000'



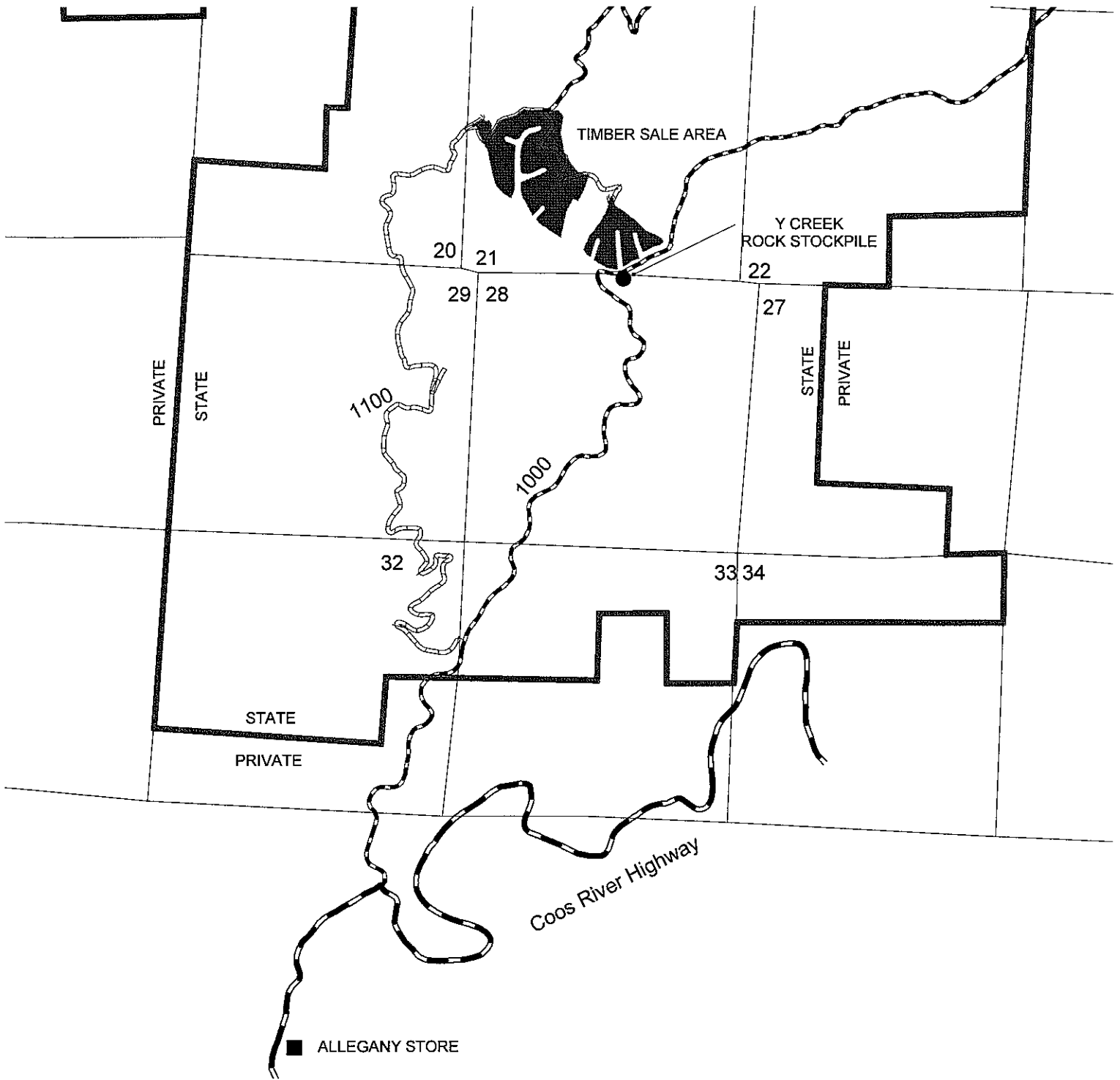





-  TIMBER SALE AREA
-  Forest Boundary
-  Existing Road - Purchaser Maintained
-  Existing Road - State Maintained
-  County Road

EXHIBIT "A" VICINITY MAP

OF TIMBER SALE CONTRACT NO.

341-08-33

PILEDUP MARLOW

PORTIONS OF SECTION 21

T24S, R11W, WM

COOS COUNTY, OREGON



"STEWARDSHIP IN FORESTRY"



APPROX. SCALE: 1" = 1/2 MILE