



"STEWARDSHIP IN FORESTRY"

Timber Sale Appraisal
Nettle / Buster Salvage
Sale 341-08-24

District: Astoria

Date: June 12, 2007

Cost Summary

	Conifer	Hardwood	Total
Gross Timber Sales Value	\$313,475.04	\$0.00	\$313,475.04
		Project Work:	\$0.00
		Advertised Value:	\$313,475.04



Timber Sale Appraisal
 Nettle / Buster Salvage
 Sale 341-08-24

"STEWARDSHIP IN FORESTRY"

District: Astoria

Date: June 12, 2007

Timber Description

Location: Portions of Sections 11, 12, 13, 14, 20, 21, 23, 24, 25, 28, 29, 32, & 33, T5N, R6W,
 & portions of Section 5, T4N, R6W, W.M., Clatsop County, Oregon.

Stand Stocking: 80%

SpecieName	AvgDBH	Amortization (%)	Recovery (%)
Douglas - Fir	23	0	97
Western Hemlock / Fir	18	0	95

Volume by Grade	2S	3S	4S	Total
Douglas - Fir	756	204	26	986
Western Hemlock / Fir	105	22	2	129
Total	861	226	28	1,115



Timber Sale Appraisal
Nettle / Buster Salvage
Sale 341-08-24

"STEWARDSHIP IN FORESTRY"

District: Astoria

Date: June 12, 2007

Comments: Pond Values Used: 1st Quarter Calendar Year 2007.

Anticipated Log Markets: Clatskanie, Mist, and Tillamook, OR and Longview, WA

Western Red Cedar Stumpage Price = Pond Value minus Logging Cost
\$870/MBF = \$1,150/MBF - \$280/MBF

Red Alder Stumpage Price = Pond Value minus Logging Cost
\$540/MBF = \$830/MBF - \$290/MBF

HAULING

Hauling costs equivalent to \$700 daily truck cost.

Other Costs (Profit and Risk to be added):

100% Branding and Painting: \$1/MBF x 1,115 MBF = \$ 1,115

Additional Felling & Bucking Costs: \$10/MBF x 1,115 MBF = \$ 11,150

TOTAL Other Costs (Profit and Risk to be added) = \$12,265

OTHER COSTS (No Profit and Risk added):

Slash Piling with Log Loader:

11 acres X 1 acre/hour X \$87.50/hour = \$962.50

Additional Slash Piling at Cable Landings:

4 Landings X 3 hours/landing X \$65.00/hour = \$780

TOTAL Other Costs (No Profit and Risk added) = \$1,742.50



"STEWARDSHIP IN FORESTRY"

Timber Sale Appraisal
Nettle / Buster Salvage
Sale 341-08-24

District: Astoria

Date: June 12, 2007

Logging Conditions

Combination#: 1 Douglas - Fir 25.00%
Western Hemlock / Fir 25.00%

Yarding Distance: Medium (800 ft) **Downhill Yarding:** No
Logging System: Cable: Small Tower <=40 **Process:** Manual Delimiting
Tree Size: Mature Private Forest / Regen Cut (250 Bft/tree), 6-11 logs/MBF
Loads / Day: 4.0 **Bd. Ft / Load:** 4,000
Cost / MBF: \$168.81

Machines: Log Loader (A)
Tower Yarder (Small)

Combination#: 2 Douglas - Fir 75.00%
Western Hemlock / Fir 75.00%

Yarding Distance: Short (400 ft) **Downhill Yarding:** No
Logging System: Shovel **Process:** Manual Delimiting
Tree Size: Mature / Regen Cut (900 Bft/tree), 3-5 logs/MBF
Loads / Day: 5.0 **Bd. Ft / Load:** 4,000
Cost / MBF: \$125.23

Machines: Shovel Logger



"STEWARDSHIP IN FORESTRY"

Timber Sale Appraisal
 Nettle / Buster Salvage
 Sale 341-08-24

District: Astoria

Date: June 12, 2007

Logging Costs

Operating Seasons:	1.00	Profit Risk:	16.00%
Project Costs:	\$0.00	Other Costs (P/R):	\$12,265.00
Slash Disposal:	\$0.00	Other Costs:	\$1,742.50

Miles of Road

Road Maintenance: \$15.92

Dirt	Rock (Contractor)	Rock (State)	Paved
0.0	0.0	0.0	0.0

Hauling Costs

Species	\$ / MBF	Trips/Day	MBF / Load
Douglas - Fir	\$0.00	2.0	4.5
Western Hemlock / Fir	\$0.00	2.0	4.0

Local Pond Values

Date	Specie	Grade	Value
6/12/07	Douglas - Fir	2S	\$590.00
6/12/07	Douglas - Fir	3S	\$550.00
6/12/07	Douglas - Fir	4S	\$550.00



Timber Sale Appraisal
 Nettle / Buster Salvage
 Sale 341-08-24

"STEWARDSHIP IN FORESTRY"

District: Astoria

Date: June 12, 2007

Logging Costs Breakdown

Logging	Road Maint	Fire Protect	Hauling	Other P/R appl	Profit & Risk	Slash Disposal	Scaling	Other	Total
Douglas - Fir									
\$136.12	\$16.40	\$3.93	\$69.06	\$11.00	\$37.84	\$0.00	\$2.00	\$1.56	\$277.91
Western Hemlock / Fir									
\$136.12	\$16.72	\$3.93	\$79.20	\$11.00	\$39.52	\$0.00	\$2.00	\$1.56	\$290.05

Specie	Amortization	Pond Value	Stumpage	Amortized
Douglas - Fir	\$0.00	\$580.67	\$302.76	\$0.00
Western Hemlock / Fir	\$0.00	\$405.97	\$115.92	\$0.00



"STEWARDSHIP IN FORESTRY"

Timber Sale Appraisal
Nettle / Buster Salvage
Sale 341-08-24

District: Astoria

Date: June 12, 2007

Summary

Amortized

Specie	MBF	Value	Total
Douglas - Fir	0	\$0.00	\$0.00
Western Hemlock / Fir	0	\$0.00	\$0.00

Unamortized

Specie	MBF	Value	Total
Douglas - Fir	986	\$302.76	\$298,521.36
Western Hemlock / Fir	129	\$115.92	\$14,953.68

Gross Timber Sale Value

Recovery: \$313,475.04

Prepared by: Jasen McCoy

Phone: 503-325-5451

Road Maintenance Cost Summary (Interim and Post Harvest)

Sale: Nettle/Buster Salvage
Date: May 7, 2007
By: Ty Williams

MBF: 1,115
\$/MBF: \$15.92

Type	Equipment/Rationale	Move-in Rate	Times	Hours	Rate	Cost
Final Road Maintenance Haul Route Grading	Grader 14G	\$570	1	30	\$84	\$3,090
	Dump Truck 12CY	\$119	1	8	\$59	\$591
	FE Loader C966	\$570	1	4	\$79	\$886
Final Road Maintenance w/compaction	Grader 14G	\$570	1	53	\$84	\$5,022
	Dump Truck 12CY (2 @ \$119)	\$119	2	10	\$59	\$828
	FE Loader C966	\$570	1	5	\$79	\$965
	Vibratory Roller	\$570	1	53	\$79	\$4,757
	Water Truck 2,500 gallon Labor	\$139	1	20	\$70	\$1,539
				4	\$18	\$72
Total						\$17,750

Final Road Maintenance - without compaction

Production/Rates	Miles/day	Distance(miles)	Days	Hours
Grader	4.0	12.0	3.0	30.0

Final Road Maintenance - with compaction

Production/Rates	Miles/day	Distance(miles)	Days	Hours
Grader	1.5	8.0	5.3	53.3
Vibratory Roller	1.5	8.0	5.3	53.3

Final road maintenance with process and compaction required on East Sager Creek Road from the junction with Middle Sager Creek Road to Green Mountain Road and Green Mountain Road to Stanley Creek Road and Boeck Ranch Road. Spot grading w/o compaction on remaining roads and access spurs.

TIMBER CRUISE REPORT

Nettle/Buster SALVAGE FY 2008

1. Sale Area Location:

Area 1 (Deep Creek Thinning) is located in portions of Sections 11, 12, 13 and 14, T5N, R6W, Willamette Meridian, Clatsop County, Oregon.

Area 2 (Boeck Ranch Thinning) is located in portions of Sections 23, 24, and 25, T5N, R6W, Willamette Meridian, Clatsop County, Oregon.

Areas 3-6 (Nettle Meyer Combination) is located in Sections 5, 20, 21, 28, 29, 32, 33, T5N, R6W, and T4N, R6W, Willamette Meridian, Clatsop County, Oregon.

Areas 7-8 (Military Green) is located in portions of Sections 5, 28, 32, and 33, T5N, R6W, and T4N, R6W, Willamette Meridian, Clatsop County, Oregon.

2. Fund Distribution:

BOF = 100%

Tax Code = 01-08 (100%)

3. Sale Acreage and Treatments by Area:

Area	Original Sale Name	Harvest Type	MC Acres	Concentration Acres	Scattered Acres	Survey Method
1	Deep Creek Thinning	Salvage	N/A	31	462	GIS
2	Boeck Ranch Thinning	Salvage	N/A	18	304	GIS
3	Nettle Meyer Combination	Salvage	N/A	10	140	GIS
4	Nettle Meyer Combination	Salvage	N/A	24	507	GIS
4A	Nettle Meyer Combination	MC	11	N/A	N/A	GIS
5	Nettle Meyer Combination	Salvage	N/A	3	21	GIS
6	Nettle Meyer Combination	Salvage	N/A	8	103	GIS
7	Military Green	Salvage	N/A	10	31	GIS
7A	Military Green	MC	15	N/A	N/A	GIS
8	Military Green	Salvage	N/A	10	27	GIS
TOTAL			26	114	1595	

4. Cruise Method and Computations:

All volume results were derived from data collected for the Military Green timber sale cruise.

Based on field evaluations, the following percentage adjustments were applied:

Areas 1 through 8 (salvage logging): Estimated that approximately 25% of the existing volume from the original "leave" stand cruise will be removed from concentration areas. Scattered blowdown was recorded, but not included in volume estimates.

Areas 4A and 7A (modified clearcuts): Estimated that approximately 80% of the existing volume from the original "leave" stand cruise will be removed.

The cruise calculations were processed in the Astoria District office. The field cruise volumes were then evaluated and reviewed to calculate a per acre and sale volume. Percentages were used from the cruise for species and grades to establish the total sale volume.

5. Timber Description:

All areas have been thinned within the last four years. The timber type is predominately Douglas-fir and western hemlock with scattered mixed conifers approximately 50-65 years old. Average tree DBH ranges are from 14"-26". There is a mix of scattered blowdown and concentrated patches of blowdown.

Areas 1 through 8 will be salvage logged, harvesting only those trees blown down and those that are root sprung (leaning).

Areas 4A and 7A are patches located within Areas 4 and 7 where most of the trees have blown down, and will be logged to salvage the downed trees and most of the remaining standing trees. Wildlife trees have been marked for retention.

6. Statistical Analysis and Stand Summary: A statistical analysis was not calculated. Stand Volume Reports attached.

7. Volumes by Species and Sale Areas: Volumes do not include "in-growth". The total net MBF volumes by species and grade are as follows:

Species	DBH	Net. Vol.	2 Saw	3 Saw	4 Saw	Sale%
Douglas-fir	23"	986	756	204	26	88
W. Hemlock / True Fir	18"	129	105	22	2	12
Totals		1,115				

The cruise volume for the modified clearcuts (Areas 4A and 7A) was reduced by an estimated 20 percent for defect, breakage, snags, and marked wildlife trees that will be left.

8. Approvals:

Prepared by: *JW* Jasen McCoy Date: May 3, 2007

9. Attachments:

Species, Sort, Grade Reports (2 pages)

Species, Sort Grade - Board Foot Volumes (Type)										Page 1											
TC TSPCSTGR										Date 4/23/2007											
Project: MILITARY										Time 2:29:02PM											
T5N R6W S32 TSALV										T5N R6W S32 TSALV											
Twp	Rge	Sec	Tract	Type	Acres	Plots	Sample Trees	CuFt	BdFt												
5N	6W	32	CA	SALV	114.00	81	105	1	W												
S T	So rt	Gr ad	% Net BdFt	Bd. Ft. per Acre			Total Net MBF	Percent Net Board Foot Volume								Average Log			Logs Per /Acre		
				Def%	Gross	Net		Log Scale Dia.				Log Length				Ln Ft	Bd Ft	CF/ Lf			
								4-5	6-11	12-16	17+	12-20	21-30	31-35	36-99						
D		0																			.4
D		DO 0															6		0.00		4.1
D		DO 2	77	75.6	15,698	3,836	437		0	53	46		2	20	77		37	84	000.00		45.8
D		DO 3	21	75.2	4,185	1,038	118	1	76	17	7	2	4	35	59		34	25	000.00		42.1
D		DO 4	3	75.0	500	125	14	4	96			80	15	5			17	7	000.00		17.7
D	Totals		88	75.5	20,383	4,998	570	0	18	45	37	2	3	23	71		31	45	000.00		110.1
H		DO 0															6		0.00		.3
H		DO 2	81	75.0	2,133	533	61		2	46	52				100		40	127	000.00		4.2
H		DO 3	17	75.0	448	112	13	68	5	28		5		24	71		36	33	000.00		3.4
H		DO 4	2	75.0	41	10	1	37	63			100					16	14	000.00		.7
H	Totals		12	75.0	2,623	656	75	14	39	47		2		4	93		35	76	000.00		8.6
Type Totals				75.4	23,005	5,654	645	0	18	44	38	2	3	21	74		32	48	000.00		118.7

Logging Plan

OF TIMBER SALE CONTRACT NO. 341-08-24
 NETTLE/BUSTER SALVAGE
 LOCATED IN PORTIONS OF SECTIONS
 11, 12, 13, 14, 20, 21, 23, 24, 25, 28, 29, 32 AND
 33, T5N, R6W, AND SECTION 5, T4N, R6W,
 W.M., CLATSOP COUNTY, OREGON

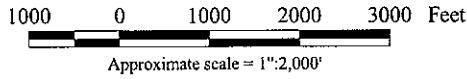

- Legend**
- T Tractor Ground
 - Cable Ground
 - ~ Fish Stream
 - - - Non-fish Stream
 - - - Unknown Stream
 - ▨ Road Prism Salvage
 - ▨ 100' Roadside Salvage
 - ▨ Paved Road
 - ▨ Rocked Road
 - ▨ Ownership Boundary
 - ▨ Concentrations of Blowdown
 - ▨ Modified Clearcut
 - ▨ Scattered Salvage

Logging Breakdown

AREA	CABLE	TRACTOR
1	0%	100%
2	0%	100%

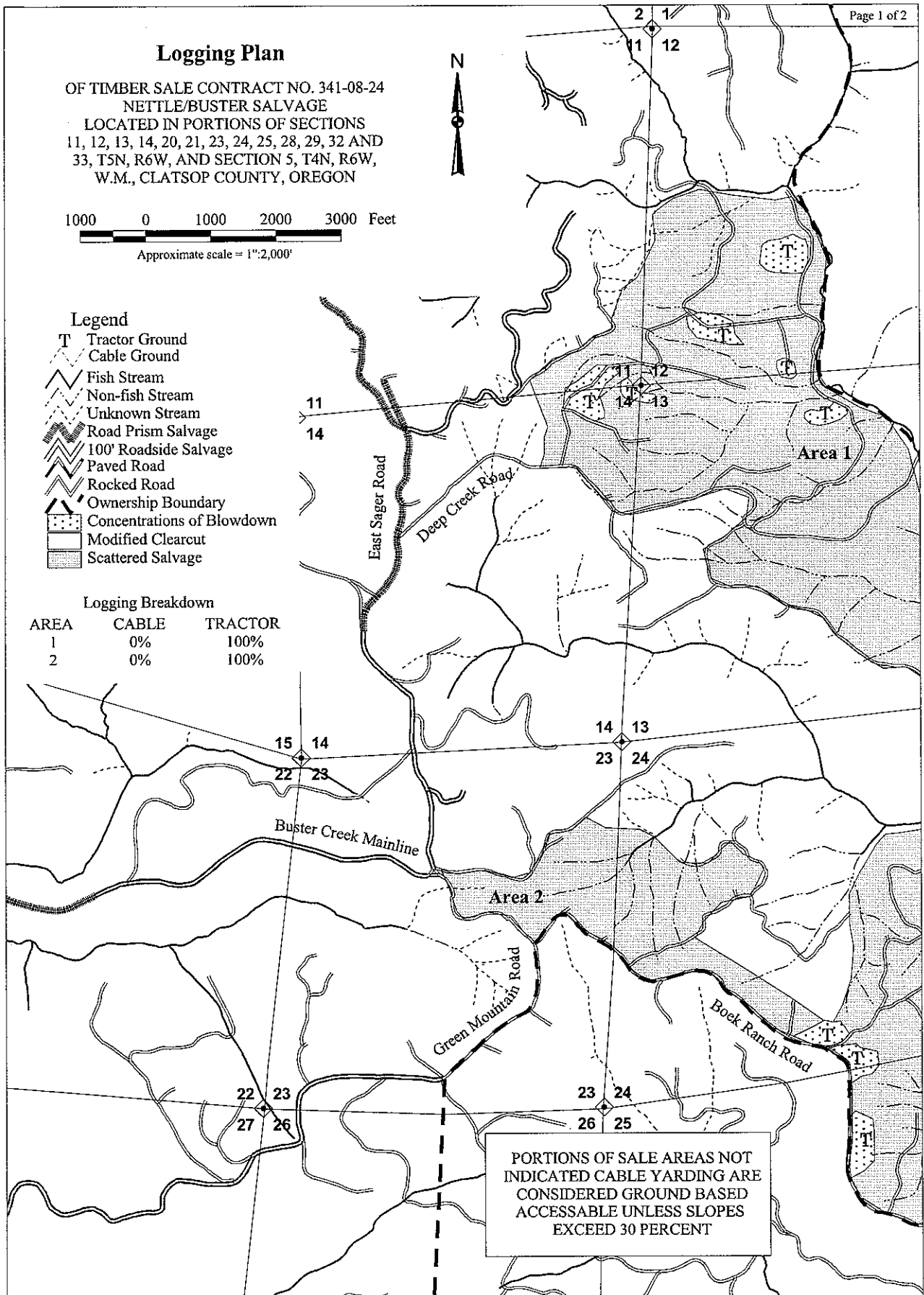

PORTIONS OF SALE AREAS NOT INDICATED CABLE YARDING ARE CONSIDERED GROUND BASED ACCESSABLE UNLESS SLOPES EXCEED 30 PERCENT

Logging Plan

OF TIMBER SALE CONTRACT NO. 341-08-24
 NETTLE/BUSTER SALVAGE
 LOCATED IN PORTIONS OF SECTIONS
 11, 12, 13, 14, 20, 21, 23, 24, 25, 28, 29, 32 AND
 33, T5N, R6W, AND SECTION 5, T4N, R6W,
 W.M., CLATSOP COUNTY, OREGON

AREA	CABLE	TRACTOR
3	20%	80%
4	87%	13%
4A	0%	100%
5	0%	100%
6	75%	25%
7	30%	70%
7A	100%	0%
8	0%	100%

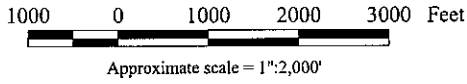

- Legend**
- T Tractor Ground
 - Cable Ground
 - Fish Stream
 - Non-fish Stream
 - Unknown Stream
 - Road Prism Salvage
 - 100' Roadside Salvage
 - Paved
 - Rocked
 - Ownership Boundary
 - Concentrations of Blowdown
 - Modified Clearcut
 - Scattered Salvage
 - Existing Landing

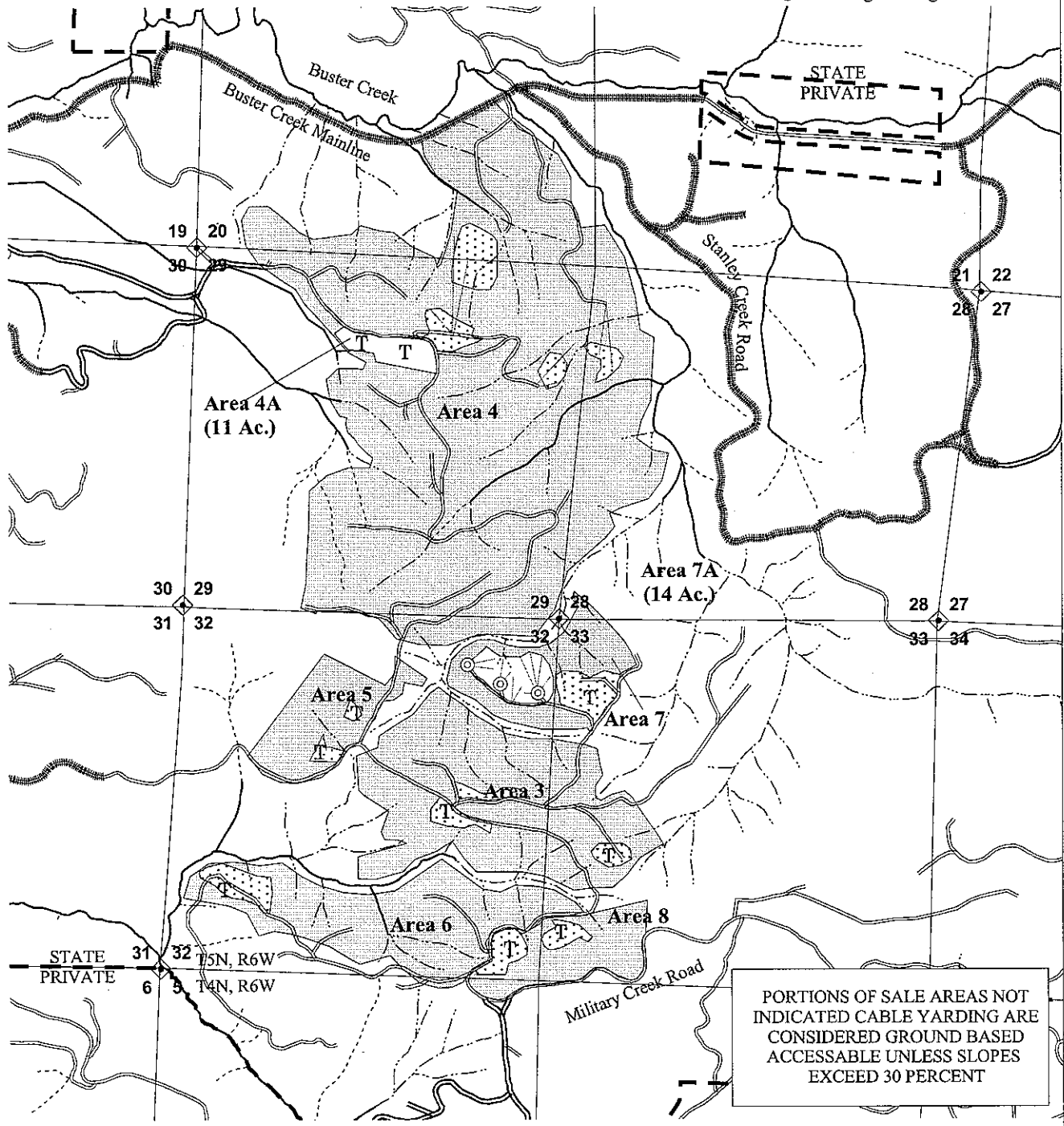

PORTIONS OF SALE AREAS NOT INDICATED CABLE YARDING ARE CONSIDERED GROUND BASED ACCESSIBLE UNLESS SLOPES EXCEED 30 PERCENT