



20 Miles to Astoria

MP 75 Bradley Wayside

Shingle Mill Road

Nicolai Mainline

30

Westport

MP 70

9 Miles to Clatskanie

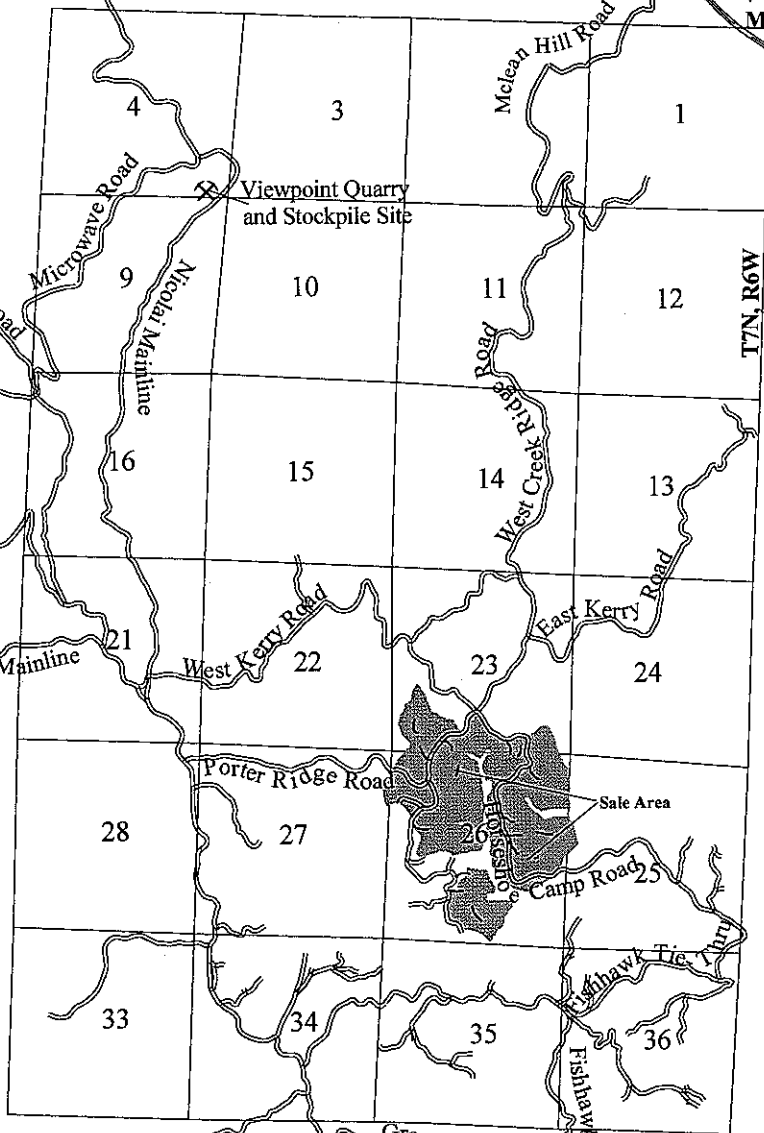

Viewpoint Quarry and Stockpile Site

Sale Area

7 Miles to Mist

EXHIBIT A
 VICINITY MAP
 OF TIMBER SALE CONTRACT NO. 341-07-45
 PORTER HORSE
 CLATSOP COUNTY, OREGON.



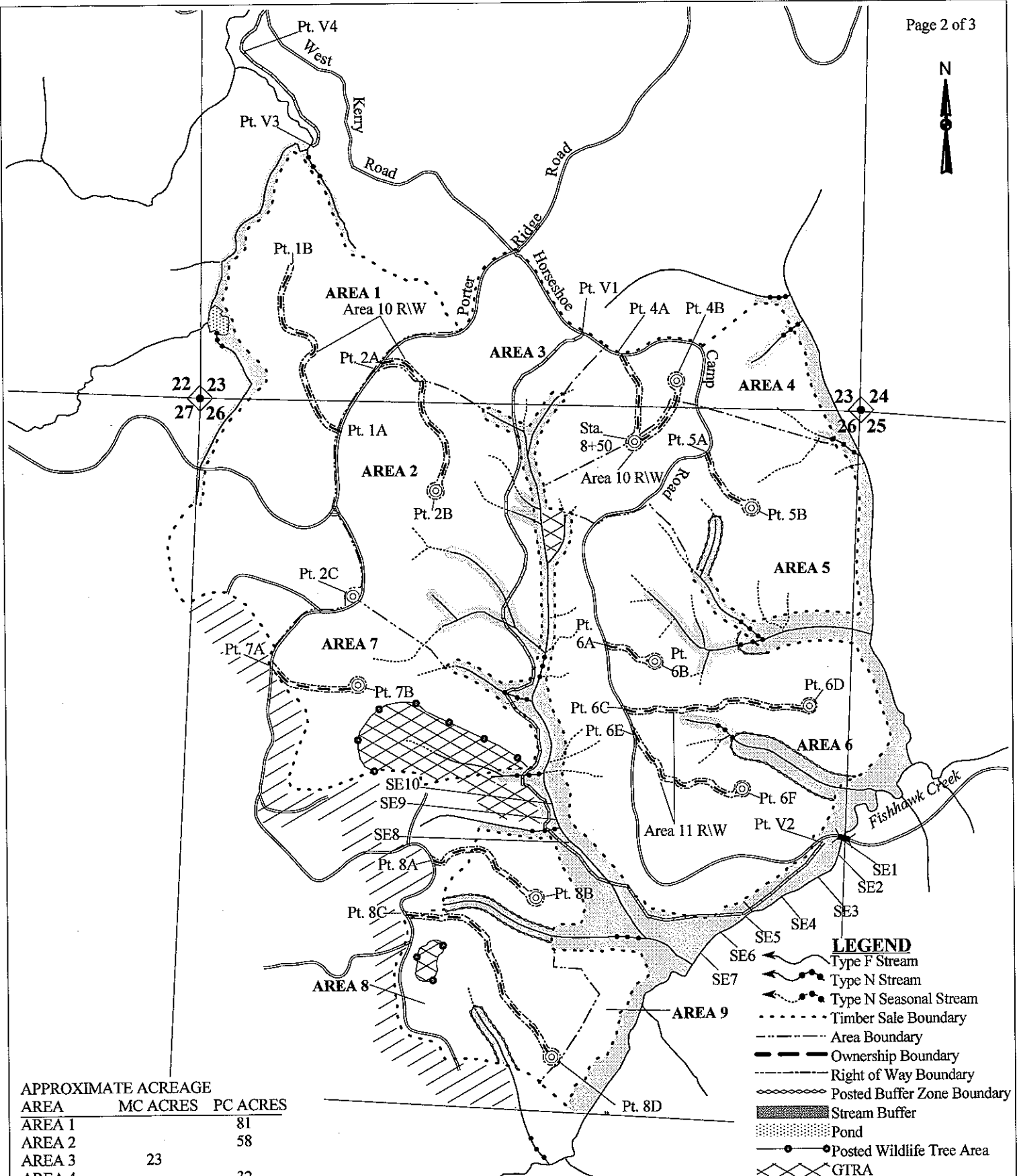

| APPROXIMATE ACREAGE | | |
|-----------------------------|----------|----------|
| AREA | MC ACRES | PC ACRES |
| AREA 1 | | 81 |
| AREA 2 | | 58 |
| AREA 3 | 23 | |
| AREA 4 | | 32 |
| AREA 5 | 54 | |
| AREA 6 | | 107 |
| AREA 7 | 32 | |
| AREA 8 | 40 | |
| AREA 9 | | 9 |
| AREA 10R/W | 4 | |
| AREA 11R/W | 3 | |
| TOTAL | 156 | 287 |
| TOTAL ALL AREAS - 443 ACRES | | |

EXHIBIT A
 OF TIMBER SALE CONTRACT NO.341-07-45
 PORTER HORSE
 PORTIONS OF SECTIONS
 23, 25, 26 & 27, T7N, R6W,
 W.M., CLATSOP COUNTY, OREGON.
 APPROX. SCALE 1"=1,000'

1000 0 1000 Feet

- LEGEND**
- Type F Stream
 - Type N Stream
 - Type N Seasonal Stream
 - Timber Sale Boundary
 - Area Boundary
 - Ownership Boundary
 - Right of Way Boundary
 - Posted Buffer Zone Boundary
 - Stream Buffer
 - Pond
 - Posted Wildlife Tree Area
 - GTRA
 - Reforestation Area
 - Pt. 1A Point For Project Work
 - Surfaced Road
 - New Road Construction
 - Vacating
 - Landing to Construct
 - Known Land Survey Corner
 - Bridge
 - Stream Enhancement

