

**LEGEND**

- Landing
- + Project Point
- Posted Sale Boundary
- Roads**
- ══ State Maintained Road
- ══ Purchaser Maintained Road
- New Road Construction
- Right of Way Boundary
- Streams**
- ══ Type F
- ══ Type N Perennial
- ══ Type N Seasonal
- Stream Buffer
- ▨ Reforestation Area
- Green Tree Retention Group
- × Green Tree Retention Single
- Marbled Murrelet Management Area
- ... Seasonally Restricted

**APPROXIMATE ACREAGE**

AREA I	10
AREA II	19
<b>TOTAL</b>	<b>29</b>

**EXHIBIT "A"**



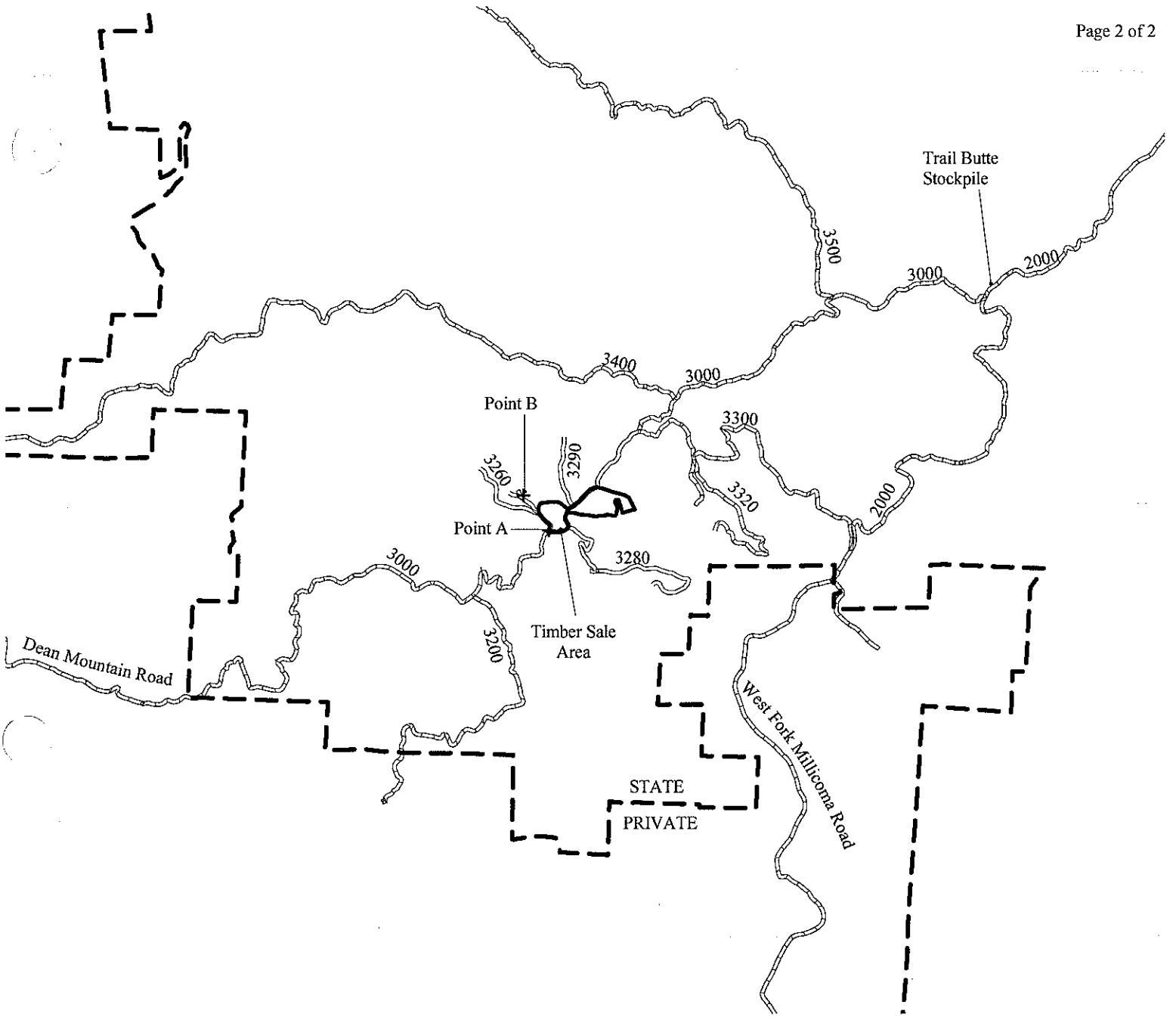

**WEST FORK HEADLANDS**  
 341-07-36  
 PORTIONS OF SECTION 13  
 T24S, R12W  
 COOS COUNTY, OREGON  
 APPROXIMATELY 29 NET HARVEST ACRES

APPROX. SCALE: 1" = 1000'





**LEGEND**

-  West Fork Headlands Sale Area
-  Project Point
- Roads
-  State Maintained Road
-  Purchaser Maintained Road
-  Elliott State Forest Boundary

**APPROXIMATE ACREAGE**

AREA I	10
AREA II	19
<b>TOTAL</b>	<b>29</b>

**EXHIBIT "A"**

**VICINITY MAP  
WEST FORK HEADLANDS  
341-07-36  
PORTIONS OF SECTION 13  
T24S, R12W  
COOS COUNTY, OREGON  
APPROXIMATELY 29 NET HARVEST ACRES**



**APPROX. SCALE: 1:48,000**

