

- Rock source
- Stock pile
- Waste area
- Bridge
- Gate
- Survey corner
- Domestic water supply intake
- Cultural site
- Buffer
- Area boundary
- Sale boundary
- Ownership boundary
- Perennial Type-F stream
- Perennial Type-N stream
- Unsurfaced road
- Surfaced road
- State/Federal highway
- Legacy road
- Blocked road
- Road construction
- County road
- OHV trail
- Non-motorized trail
- Transmission line

**EXHIBIT A**

Timber Sale Contract No. 341-07-23  
 Fire Break Ridge  
 Portions of Sections 11, 12, 13  
 and 14, T2N, R9W, W. M.  
 Tillamook County, Oregon

Area	Type of Operation	Gross	Net
1	Partial cut	76	69
2	Modified clearcut	41	41
3	Partial cut	55	53
Total		172	163



Tillamook District GIS  
 4-12-2006

This product is for informational use and may not have been prepared for, or suitable for legal, engineering, or surveying purposes.



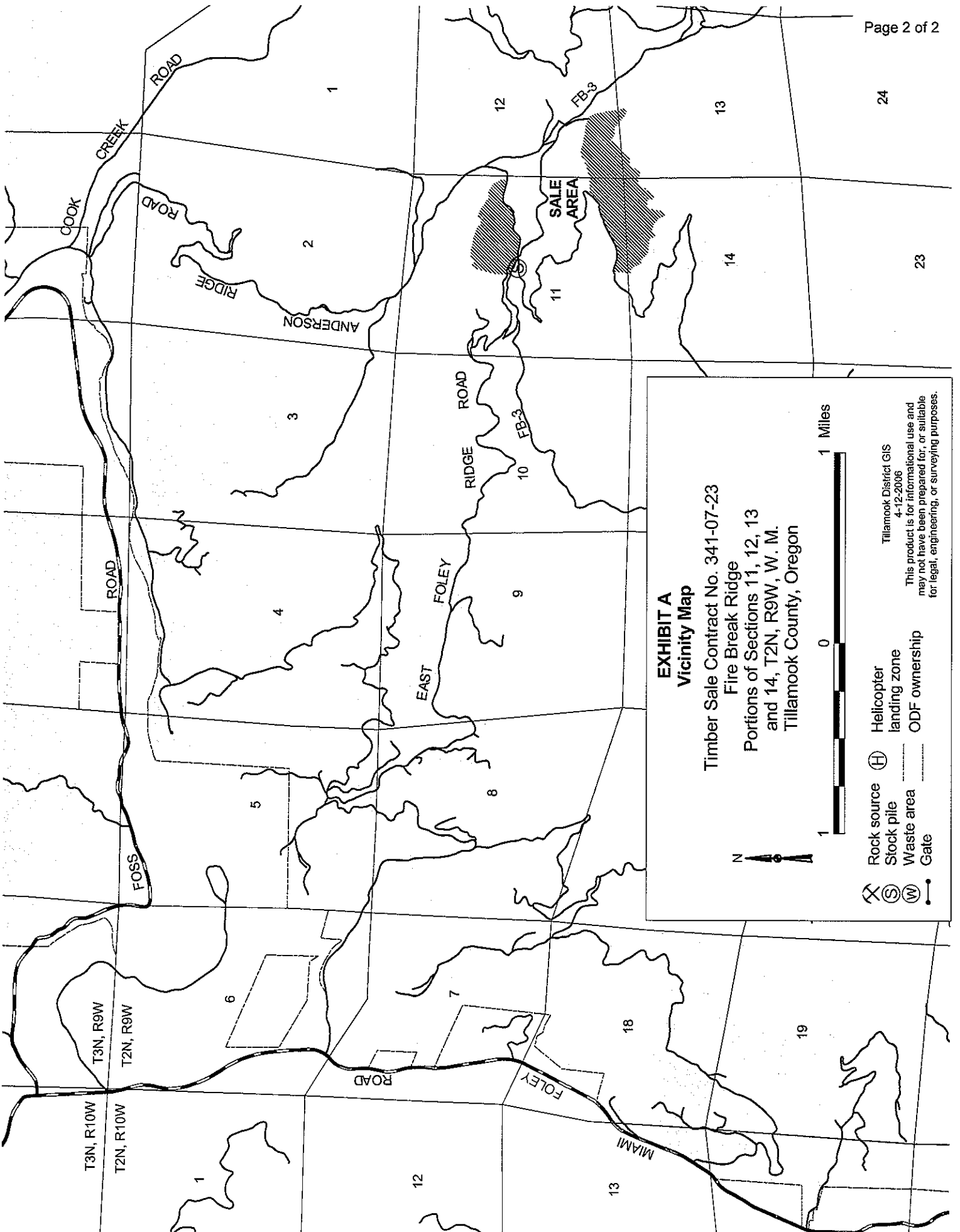

**EXHIBIT A**  
**Vicinity Map**

Timber Sale Contract No. 341-07-23

Fire Break Ridge

Portions of Sections 11, 12, 13

and 14, T2N, R9W, W. M.

Tillamook County, Oregon



- Rock source
- Stock pile
- Waste area
- Gate
- Helicopter landing zone
- ODF ownership

Tillamook District GIS  
4-12-2006

This product is for informational use and may not have been prepared for, or suitable for, legal, engineering, or surveying purposes.