

- ⊗ Rock source
- Ⓢ Stock pile
- Ⓜ Waste area
- ⌒ Bridge
- ⊙ Gate
- ⊠ Survey corner
- Ⓧ Domestic water supply intake
- Buffer
- - - Area boundary
- Sale boundary
- - - Ownership boundary
- Perennial Type-F stream
- - - Perennial Type-N stream
- === Unsurfaced road
- == Surfaced road
- State/Federal highway
- Legacy road
- xxx Blocked road
- - - Road construction
- County road
- ⋯ OHV trail
- ⋯ Non-motorized trail
- T T Transmission line

**EXHIBIT A**  
 Timber Sale Contract No. 341-07-02  
 Rimrock Road  
 Portions of Section 34,  
 T1S, R7W, W. M.  
 Tillamook County, Oregon

	Type of	Acres
Area	Operation	Gross Net
1	Modified clearcut	44 44
2	Modified clearcut	114 103
<b>Total</b>		<b>158 147</b>

1000 0 1000 Feet



Tillamook District GIS  
06/13/2006







This product is for informational use and may not have been prepared for, or suitable for legal, engineering, or surveying purposes.



### EXHIBIT A Vicinity Map

Timber Sale Contract No. 341-07-02

Rimrock Road  
Portions of Section 34,  
T1S, R7W, W. M.  
Tillamook County, Oregon

-  Rock source
-  Stock pile
-  Waste area
-  Gate
-  Helicopter landing zone
-  ODF ownership



Tillamook District GIS  
06/13/2006

This product is for informational use and may not have been prepared for, or suitable for legal, engineering, or surveying purposes.

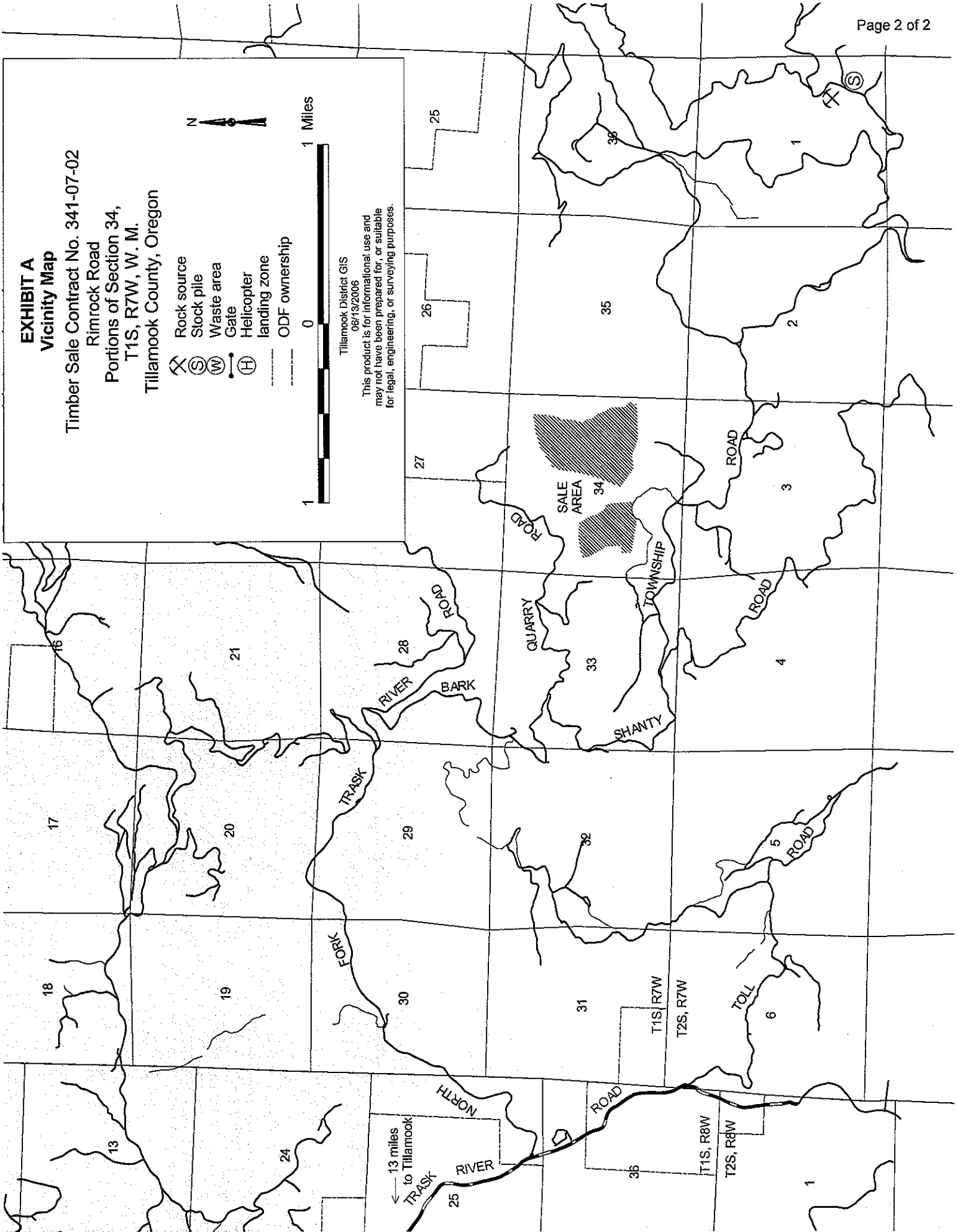

← 13 miles to Tillamook

TRASK RIVER  
NORTH ROAD

T1S, R7W  
T2S, R7W

T1S, R8W  
T2S, R8W

SALE AREA 34

QUARRY

SHANTY

TOWNSHIP

ROAD

ROAD

ROAD

TOLL

TRASK RIVER

RIVER

BARK

ROAD

ROAD

ROAD

ROAD

TOLL

TRASK RIVER

RIVER

BARK

ROAD

ROAD

ROAD

ROAD

TOLL

25

26

27

35

36

1

2

3

4

5

6

17

13

19

20

21

29

30

32

31

1

6

5

4

3

2

1

5