

LEGEND

- Project Points
- × Green Tree Retention
- ▨ Stream Buffer
- ▩ Lakes
- Streams**
- ▤ Type F Perennial
- ▥ Type N Perennial
- ▦ Type N Seasonal
- ▧ Timber Sale Boundary
- ▨ Purchaser Maintained Road
- ▩ County Road
- Section Lines
- State Forest Boundary
- ▬ Domestic Water Source

EXHIBIT "A"

OF TIMBER SALE NO.
 341-06-25
 ASH VALLEY SCHOOL
 PORTIONS OF SECTION 24; T23S, R10W, W.M.
 DOUGLAS COUNTY, OREGON

APPROX. SCALE 1" = 1000'

APPROX. NET ACREAGE = 76



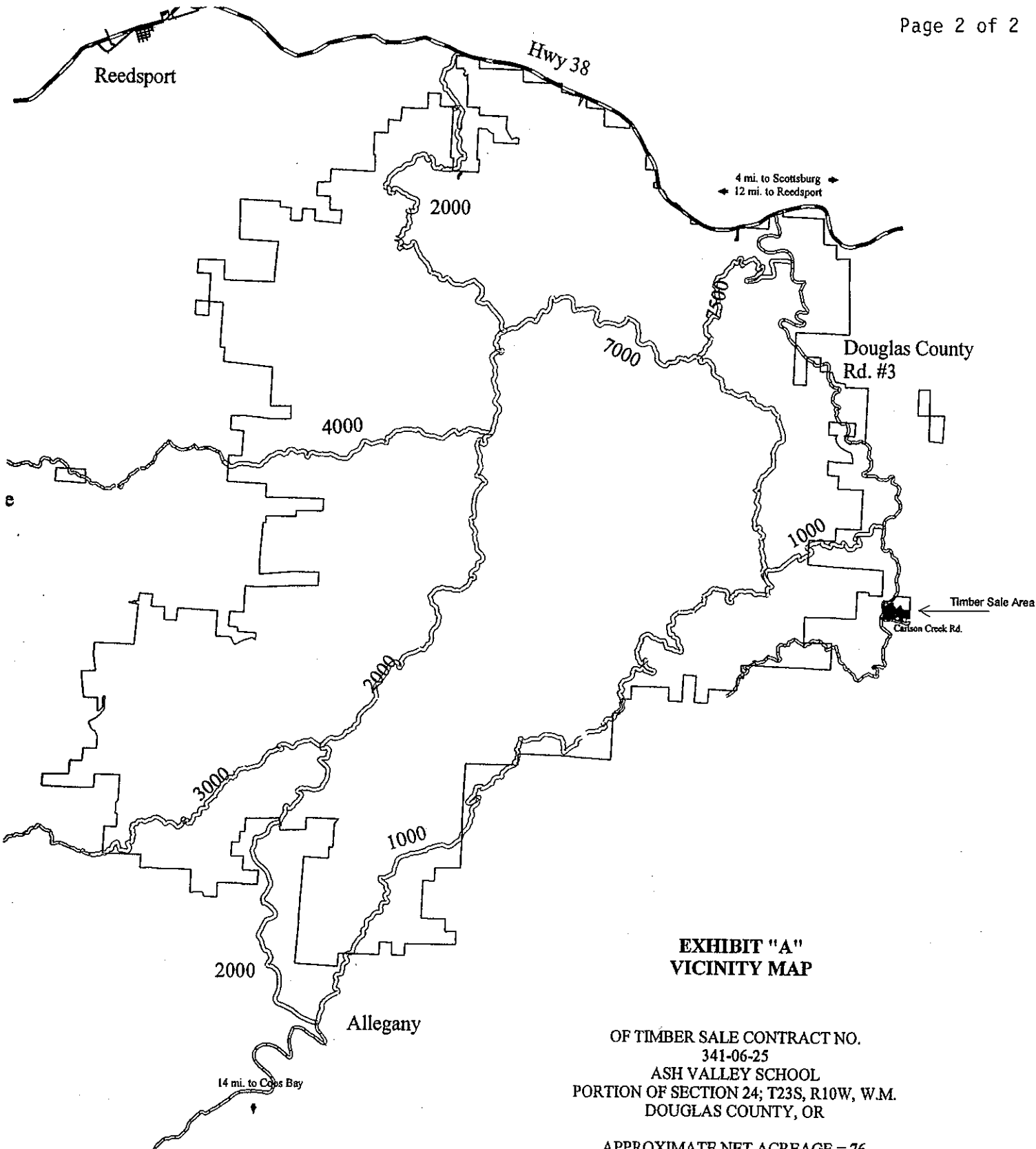

EXHIBIT "A"
VICINITY MAP

OF TIMBER SALE CONTRACT NO.
341-06-25
ASH VALLEY SCHOOL
PORTION OF SECTION 24; T23S, R10W, W.M.
DOUGLAS COUNTY, OR

APPROXIMATE NET ACREAGE = 76

Approx. Scale 1"=2.5 Miles

LEGEND

Roads	
	Forest Road
	Highway
	County
	Town
	Sale Area
	State Forest Boundary

