

- ⊗ Rock source
- ⊙ Stock pile
- ⊙ Waste area
- ⊗ Blocked
- \* Culvert removal
- ⊢ Bridge
- ⊢ Gate
- ⊠ Survey corner
- ▲ Domestic water supply
- Modified Clearcut or Partial Cut
- ▨ Retention Cut
- Buffer
- Area boundary
- ⊙-⊙-⊙ Sale boundary
- Ownership boundary
- Perennial Type-F stream
- Perennial Type-N stream
- == Unsurfaced road
- == Surfed road
- State highway
- ⋯ Abandoned road
- - - Road construction
- County road
- ⊖ OHV trail
- ⋯ Non-motorized trail
- T T Transmission line

**EXHIBIT A**  
**Timber Sale Contract No. 341-05-65**  
**Arch Cape**  
**Portions of Sections 1 and 12,**  
**T1N, R8W, W. M.**  
**and Portions of Sections 6 and 7,**  
**T1N, R7W, W.M.**  
**Tillamook County, Oregon**



Tillamook District GIS  
11-18-04



This product is for informational use and may not have been prepared for, or suitable for legal, engineering, or surveying purposes.

Area	Type of Operation	Acres	
		Sale	Net
1	Retention Cut	123	120
2	Modified Clearcut	127	107
3	Retention Cut	46	42
4	Modified Clearcut	33	32
5	Retention Cut	170	154
6	Modified Clearcut	187	146
<b>Total</b>		<b>686</b>	<b>601</b>

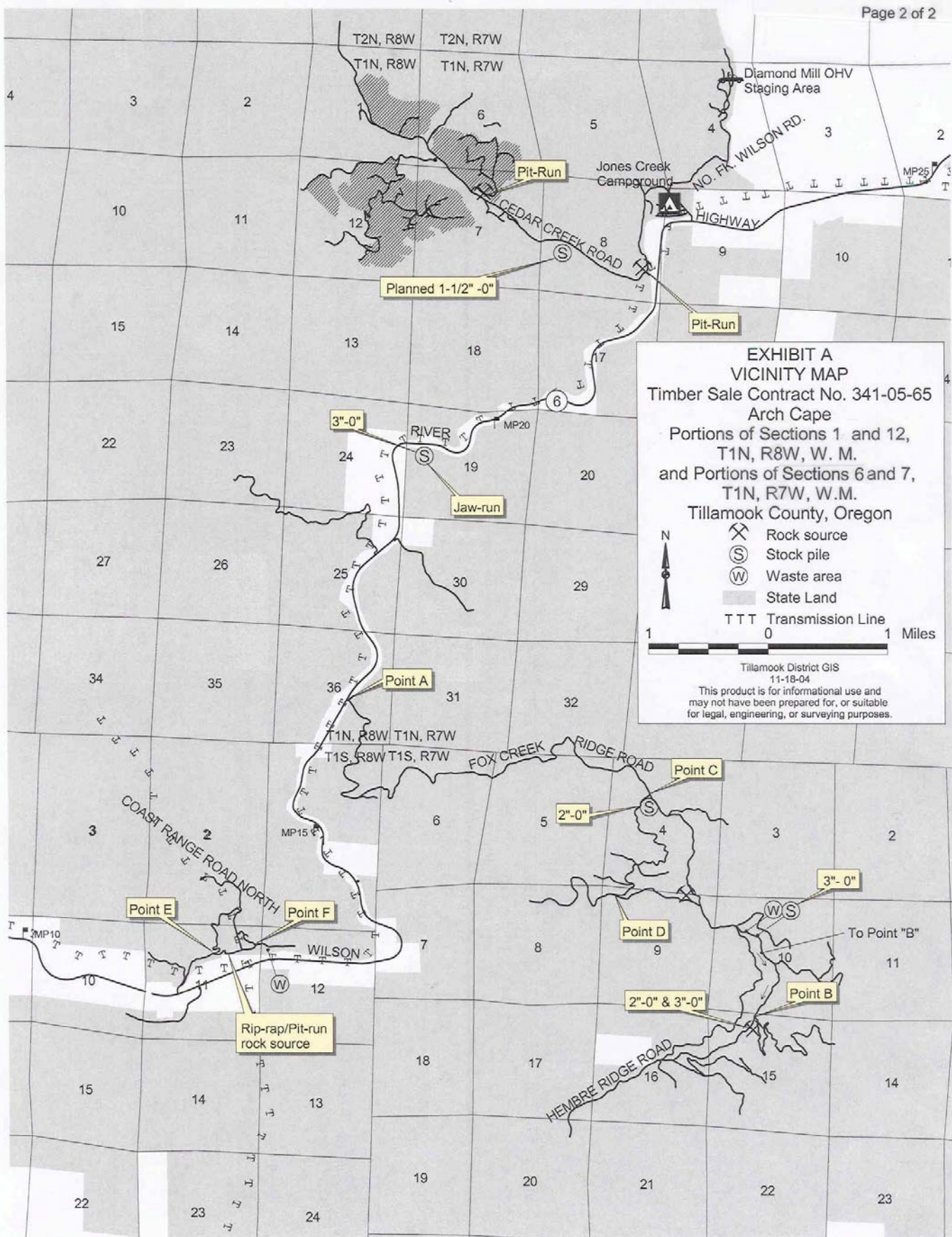



**EXHIBIT A  
VICINITY MAP**  
 Timber Sale Contract No. 341-05-65  
 Arch Cape  
 Portions of Sections 1 and 12,  
 T1N, R8W, W. M.  
 and Portions of Sections 6 and 7,  
 T1N, R7W, W.M.  
 Tillamook County, Oregon

 Rock source  
 Stock pile  
 Waste area  
 State Land  
 Transmission Line

  
  
 1 0 1 Miles

Tillamook District GIS  
 11-18-04  
 This product is for informational use and  
 may not have been prepared for, or suitable  
 for legal, engineering, or surveying purposes.