

- Rock source
- Stock pile
- Waste area
- Blocked
- Culvert removal
- Bridge
- Gate
- Survey corner
- Domestic water supply
- Modified Clearcut or Partial Cut
- Retention Cut
- Buffer
- Area boundary
- Sale boundary
- Ownership boundary
- Perennial Type-F stream
- Perennial Type-N stream
- Unsurfaced road
- Surfaced road
- State highway
- Abandoned road
- Road construction
- County road
- OHV trail
- Non-motorized trail
- Transmission line

EXHIBIT A
Timber Sale Contract No. 341-05-55
Clear Creek Ridge
Portions of Sections 11, 13, 14, 15,
23 and 24, T1S, R7W, W. M.
Tillamook County, Oregon



Tillamook District GIS
 1-4-2005
 This product is for informational use and
 may not have been prepared for, or suitable
 for legal, engineering, or surveying purposes.



| Area | Type of Operation | Acres | |
|--------------|-------------------|------------|------------|
| | | Sale | Net |
| 1 | Retention Cut | 4 | 4 |
| 2 | Modified Clearcut | 116 | 97 |
| 3 | Retention Cut | 7 | 5 |
| 4 | Retention Cut | 22 | 15 |
| 5 | Modified Clearcut | 11 | 11 |
| 6 | Modified Clearcut | 74 | 73 |
| 7 | Retention Cut | 9 | 8 |
| 8 | Retention Cut | 71 | 63 |
| 9 | Modified Clearcut | 79 | 69 |
| 10 | Retention Cut | 14 | 13 |
| 11 | Modified Clearcut | 53 | 53 |
| 12 | Modified Clearcut | 109 | 104 |
| 13 | Retention Cut | 36 | 36 |
| 14 | Modified Clearcut | 25 | 25 |
| 15 | Modified Clearcut | 50 | 46 |
| Total | | 680 | 622 |

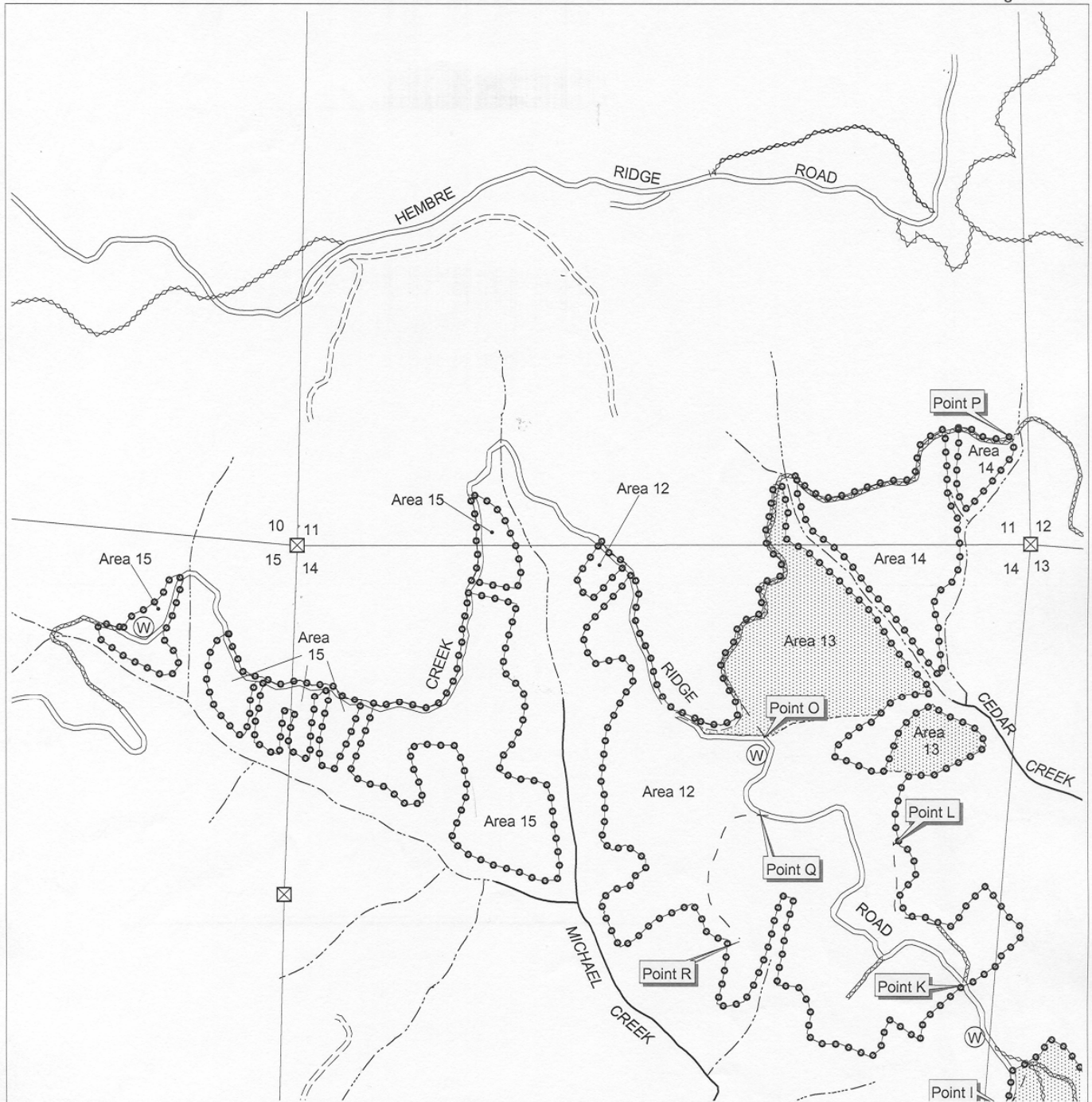

- ⊗ Rock source
- ⊙ Stock pile
- ⊙ Waste area
- ⊗ Blocked
- * Culvert removal
- ⌒ Bridge
- ⊠ Gate
- ⊠ Survey corner
- ▲ Domestic water supply
- Modified Clearcut or Partial Cut
- ▨ Retention Cut
- Buffer
- Area boundary
- ⊙-⊙ Sale boundary
- Ownership boundary
- Perennial Type-F stream
- ⋯ Perennial Type-N stream
- Unsurfaced road
- Surfaced road
- State highway
- ⌒ Abandoned road
- Road construction
- County road
- ⋯ OHV trail
- ⋯ Non-motorized trail
- T T Transmission line

EXHIBIT A
Timber Sale Contract No. 341-05-55
Clear Creek Ridge
Portions of Sections 11, 13, 14, 15,
23 and 24, T1S, R7W, W. M.
Tillamook County, Oregon



Tillamook District GIS
 1-4-2005
 This product is for informational use and may not have been prepared for, or suitable for legal, engineering, or surveying purposes.



| Area | Type of Operation | Acres | |
|--------------|-------------------|------------|------------|
| | | Sale | Net |
| 1 | Retention Cut | 4 | 4 |
| 2 | Modified Clearcut | 116 | 97 |
| 3 | Retention Cut | 7 | 5 |
| 4 | Retention Cut | 22 | 15 |
| 5 | Modified Clearcut | 11 | 11 |
| 6 | Modified Clearcut | 74 | 73 |
| 7 | Retention Cut | 9 | 8 |
| 8 | Retention Cut | 71 | 63 |
| 9 | Modified Clearcut | 79 | 69 |
| 10 | Retention Cut | 14 | 13 |
| 11 | Modified Clearcut | 53 | 53 |
| 12 | Modified Clearcut | 109 | 104 |
| 13 | Retention Cut | 36 | 36 |
| 14 | Modified Clearcut | 25 | 25 |
| 15 | Modified Clearcut | 50 | 46 |
| Total | | 680 | 622 |

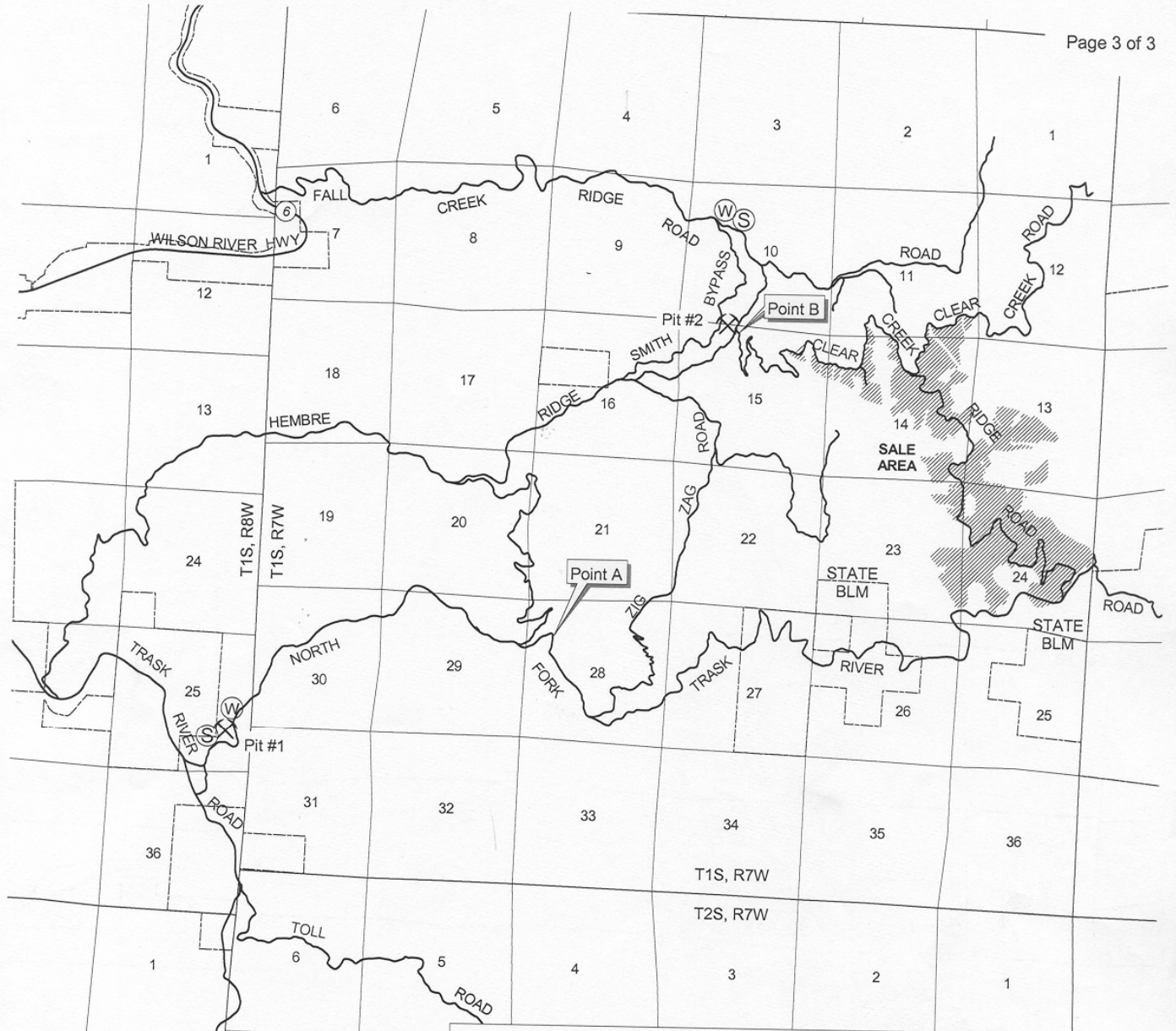





EXHIBIT A
Vicinity Map
Timber Sale Contract No. 341-05-55
Clear Creek Ridge
Portions of Sections 11, 13, 14, 15,
23 and 24, T1S, R7W, W. M.
Tillamook County, Oregon

-  Rock source
-  Stock pile
-  Waste area
-  Gate



Tillamook District GIS
1-4-2005
This product is for informational use and
may not have been prepared for, or suitable
for legal, engineering, or surveying purposes.