

- Rock source
- Stock pile
- Waste area
- Blocked
- Culvert removal
- Bridge
- Gate
- Survey corner
- Domestic water supply
- Buffer
- Area boundary
- Sale boundary
- Ownership boundary
- Perennial Type-F stream
- Perennial Type-N stream
- Unsurfaced road
- Surfaced road
- State highway
- Abandoned road
- Road construction
- County road
- OHV trail
- Non-motorized trail

EXHIBIT A
 Timber Sale Contract No. 341-05-54
 Boundary Camp
 Portions of Sections 1 and 2,
 T3S, R7W, W. M.
 Tillamook County, Oregon

Area	Type of Operation	Acres	
		Sale	Net
1	Partial Cut	118	101
2	Partial Cut	62	58
3	Partial Cut	7	6
Total		187	165



Tillamook District GIS
11-05-04

This product is for informational use and may not have been prepared for, or suitable for legal, engineering, or surveying purposes.



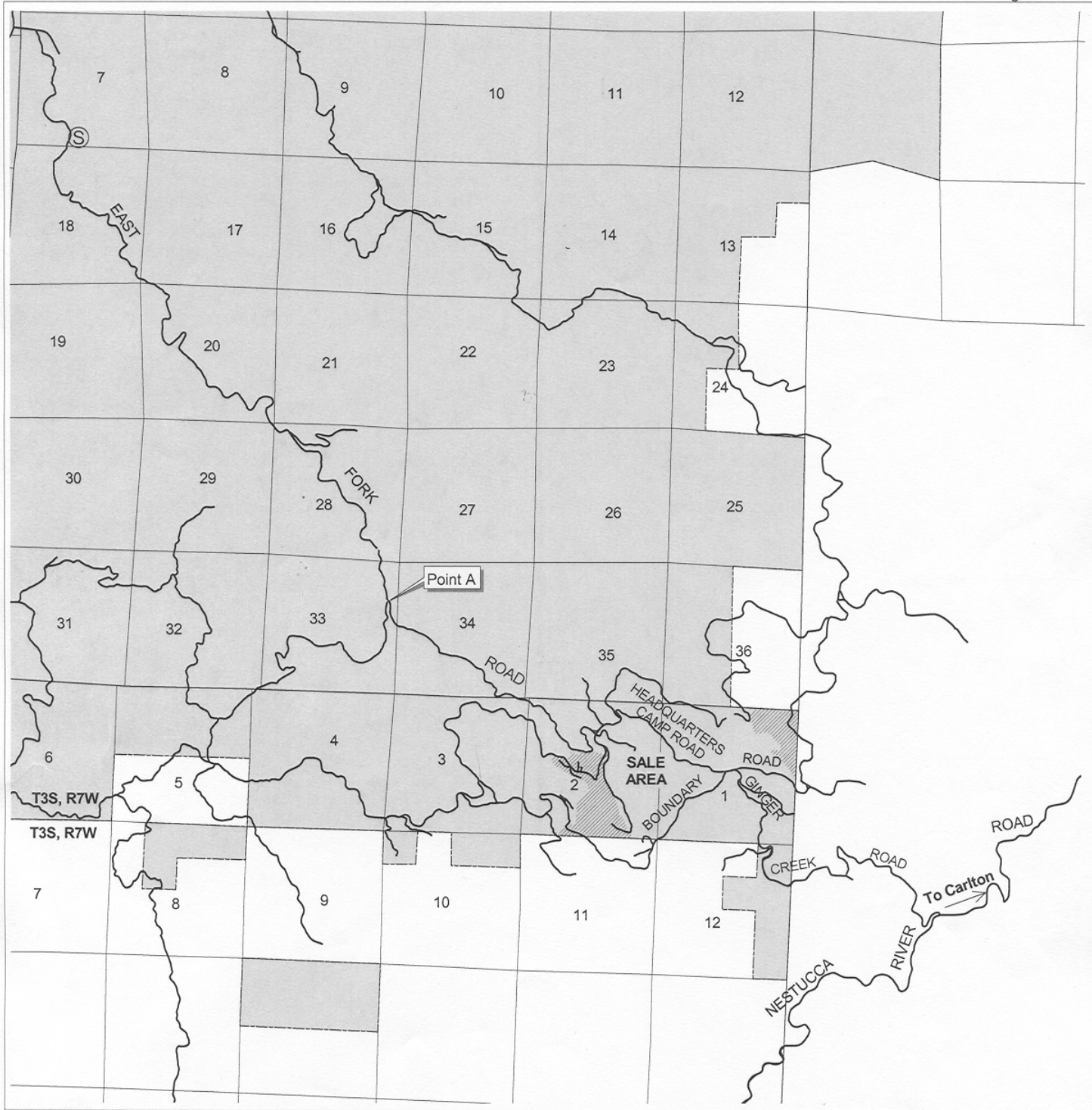

EXHIBIT A
 Vicinity Map
 Timber Sale Contract No. 341-05-54
 Boundary Camp
 Portions of Sections 1 and 2,
 T3S, R7W, W. M.
 Tillamook County, Oregon

Ⓢ Stock pile

▨ ODF owned or managed land

Tillamook District GIS
 11-05-04

This product is for informational use and may not have been prepared for, or suitable for legal, engineering, or surveying purposes.



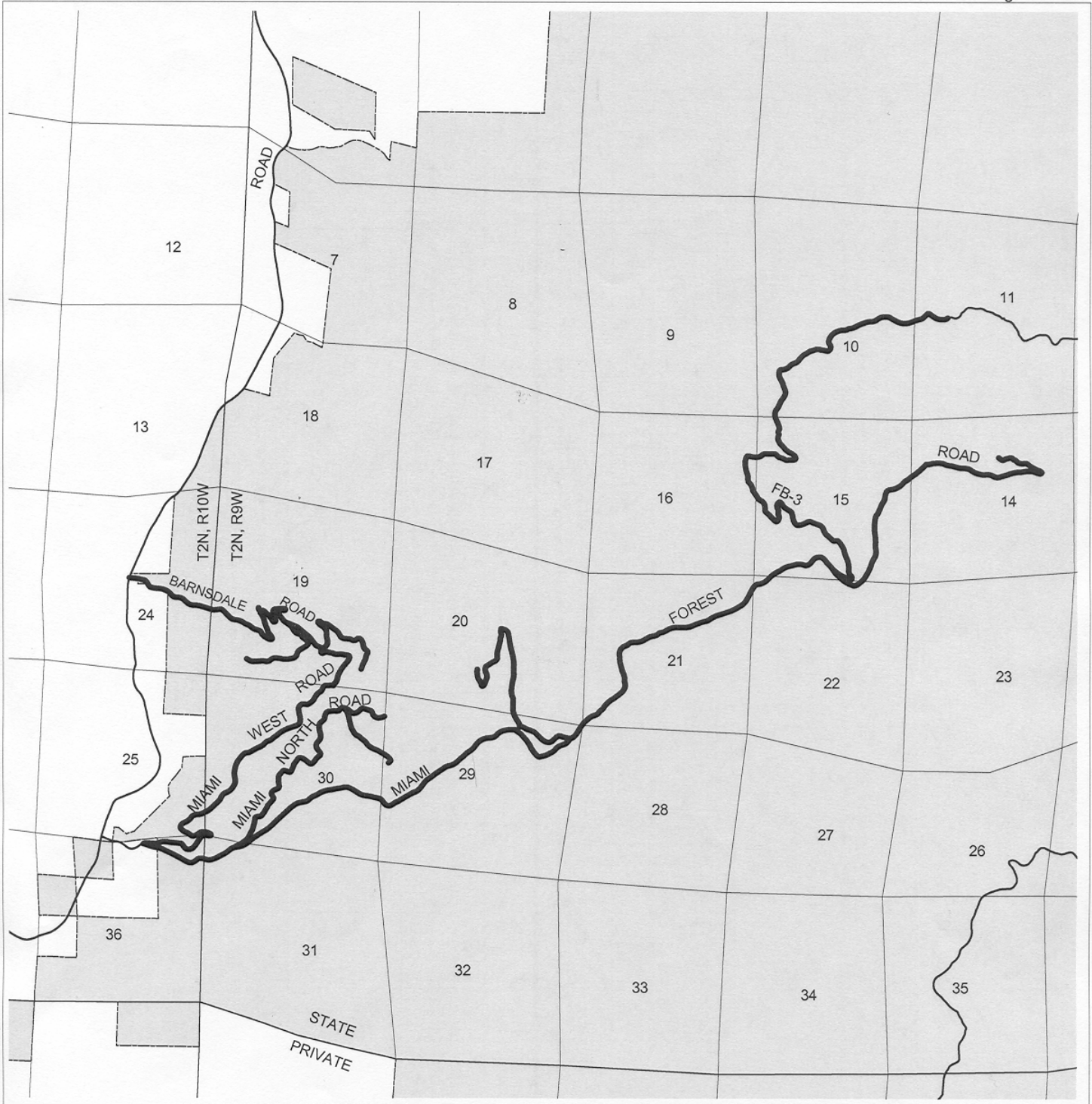



EXHIBIT A
 Road Brushing
 Timber Sale Contract No. 341-05-54
 Boundary Camp

Portions of Sections 10, 11, 14, 15, 16, 19,
 20, 21, 22, 29, 30 and 31, T2N, R9W and
 Portions of Sections 24, 25, and 36, T2N, R10W, W. M.
 Tillamook County, Oregon

-  Roads to brush
-  ODF owned or managed land

Tillamook District GIS
 11-05-04

This product is for informational use and
 may not have been prepared for, or suitable
 for legal, engineering, or surveying purposes.

