

- Rock source
- Stock pile
- Waste area
- Blocked
- Culvert removal
- Bridge
- Gate
- Survey corner
- Domestic water supply
- Modified Clearcut or Partial Cut
- Retention Cut
- Buffer
- Area boundary
- Sale boundary
- Ownership boundary
- Perennial Type-F stream
- Perennial Type-N stream
- Unsurfaced road
- Surfaced road
- State highway
- Abandoned road
- Road construction
- County road
- OHV trail
- Non-motorized trail

EXHIBIT A
 Timber Sale Contract No. 341-05-46
 Spider Jones
 Portions of Sections 28, 29, 30,
 31, 32 and 33, T2N, R7W, W. M.
 Tillamook County, Oregon



Tillamook District GIS
 11-08-2004
 This product is for informational use and
 may not have been prepared for, or suitable
 for legal, engineering, or surveying purposes.

| Area | Type of Operation | Acres | |
|--------------|-------------------|------------|------------|
| | | Sale | Net |
| 1 | Modified Clearcut | 56 | 52 |
| 2 | Retention Cut | 37 | 34 |
| 3 | Modified Clearcut | 58 | 57 |
| 4 | Retention Cut | 73 | 66 |
| 5 | Modified Clearcut | 70 | 64 |
| 6 | Modified Clearcut | 71 | 68 |
| 7 | Modified Clearcut | 110 | 98 |
| 8 | Retention Cut | 29 | 28 |
| 9 | Modified Clearcut | 11 | 11 |
| Total | | 515 | 478 |

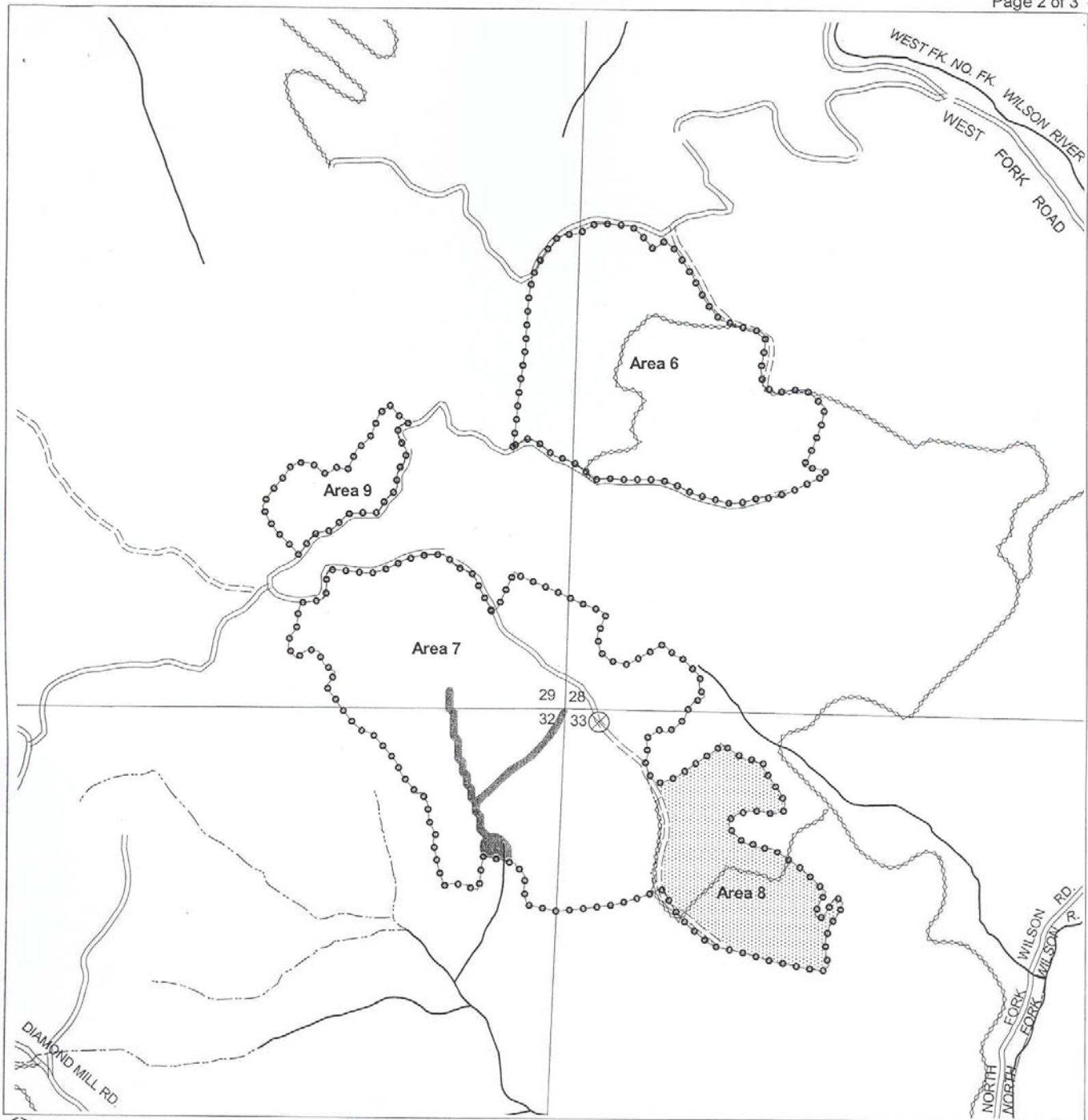

- | | | | |
|--|----------------------------------|--|-------------------------|
| | Rock source | | Area boundary |
| | Stock pile | | Sale boundary |
| | Waste area | | Ownership boundary |
| | Blocked | | Perennial Type-F stream |
| | Culvert removal | | Perennial Type-N stream |
| | Bridge | | Unsurfaced road |
| | Gate | | Surfaced road |
| | Survey corner | | State highway |
| | Domestic water supply | | Abandoned road |
| | Modified Clearcut or Partial Cut | | Road construction |
| | Retention Cut | | County road |
| | Buffer | | OHV trail |
| | | | Non-motorized trail |

EXHIBIT A
 Timber Sale Contract No. 341-05-46
 Spider Jones
 Portions of Sections 28, 29, 30,
 31, 32 and 33, T2N, R7W, W. M.
 Tillamook County, Oregon

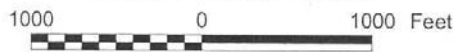

Tillamook District GIS
 11-08-2004

This product is for informational use and may not have been prepared for, or suitable for legal, engineering, or surveying purposes.



| Area | Type of Operation | Acres | |
|--------------|-------------------|------------|------------|
| | | Sale | Net |
| 1 | Modified Clearcut | 56 | 52 |
| 2 | Retention Cut | 37 | 34 |
| 3 | Modified Clearcut | 58 | 57 |
| 4 | Retention Cut | 73 | 66 |
| 5 | Modified Clearcut | 70 | 64 |
| 6 | Modified Clearcut | 71 | 68 |
| 7 | Modified Clearcut | 110 | 98 |
| 8 | Retention Cut | 29 | 28 |
| 9 | Modified Clearcut | 11 | 11 |
| Total | | 515 | 478 |

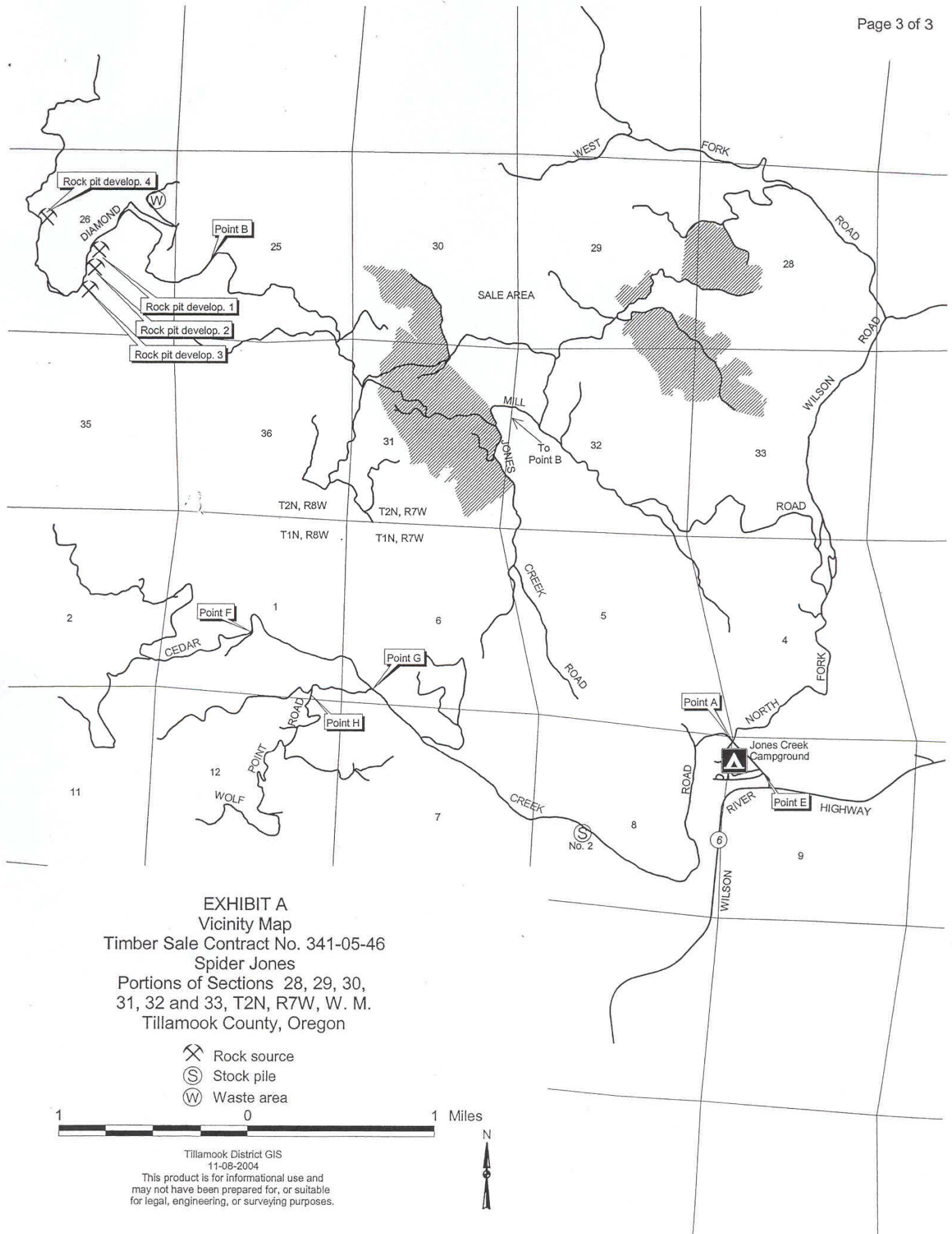





EXHIBIT A
Vicinity Map
Timber Sale Contract No. 341-05-46
Spider Jones
Portions of Sections 28, 29, 30,
31, 32 and 33, T2N, R7W, W. M.
Tillamook County, Oregon

-  Rock source
-  Stock pile
-  Waste area



Tillamook District GIS
11-08-2004
This product is for informational use and
may not have been prepared for, or suitable
for legal, engineering, or surveying purposes.