

- Rock source
- Stock pile
- Waste area
- Blocked
- Culvert removal
- Bridge
- Gate
- Survey corner
- Domestic water supply
- Buffer
- Area boundary
- Sale boundary
- Ownership boundary
- Type-F stream
- Type-N stream
- Unsurfaced road
- Surfaced road
- State highway
- Abandoned road
- Road construction
- County road
- OHV trail
- Non-motorized trail

EXHIBIT A
Timber Sale Contract No. 341-05-23
Miami Combo
Portions of Sections 14, 15, 16, 22, and 23,
T2N, R9W, W. M.
Tillamook County, Oregon

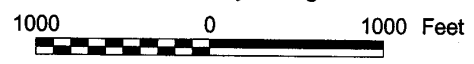

Area	Type of Operation	Acres	Net
1a	Clearcut	46	30
1b	Retention Cut	55	54
2a	Clearcut	96	81
2b	Retention Cut	12	11
Total		209	176

Tillamook District GIS
 03-23-2004
 This product is for informational use and
 may not have been prepared for, or suitable
 for legal, engineering, or surveying purposes.



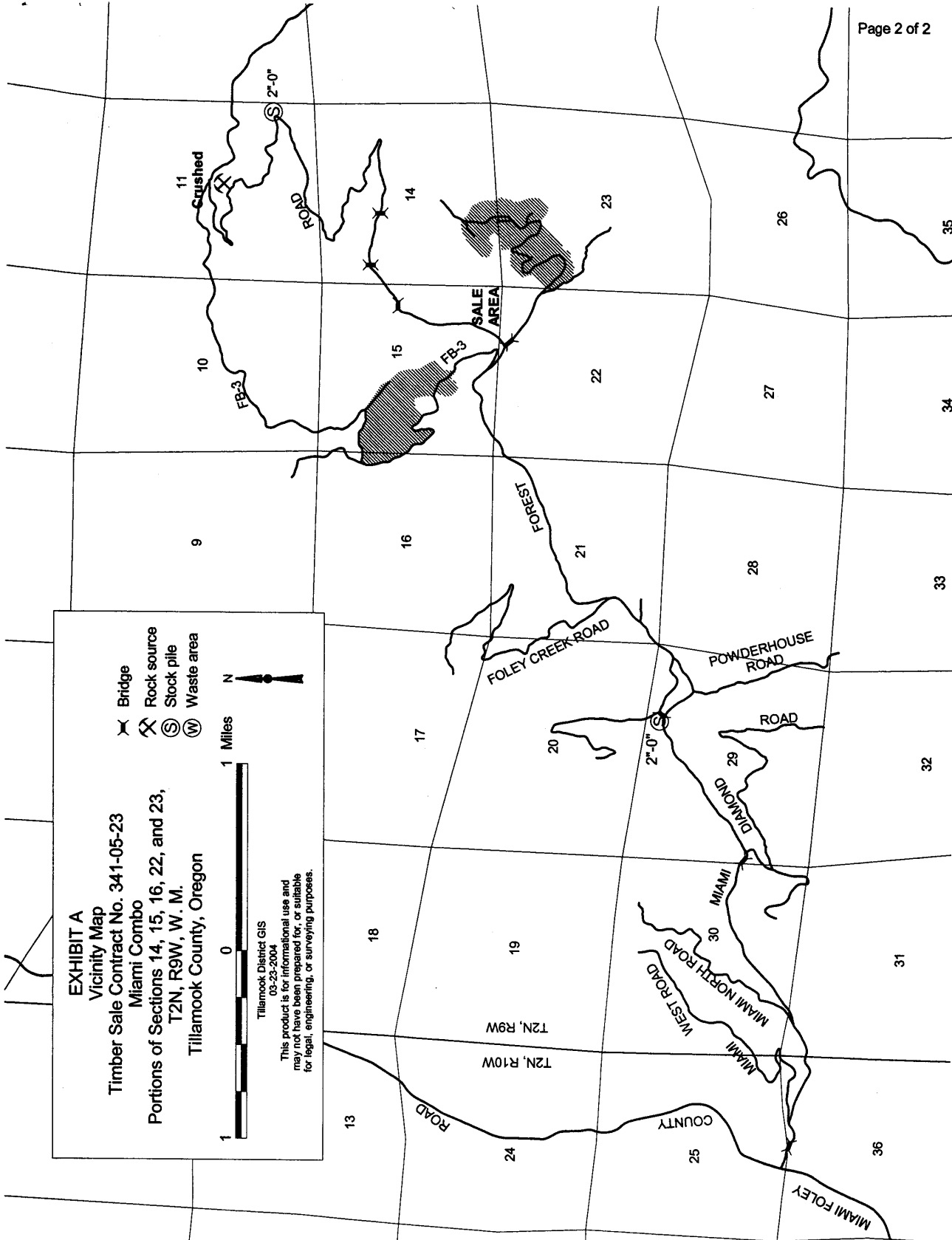

EXHIBIT A
 Vicinity Map
 Timber Sale Contract No. 341-05-23
 Miami Combo
 Portions of Sections 14, 15, 16, 22, and 23,
 T2N, R9W, W. M.
 Tillamook County, Oregon

Bridge
 Rock source
 Stock pile
 Waste area

1 Miles

N

Tillamook District GIS
 03-23-2004
 This product is for informational use and
 may not have been prepared for, or suitable
 for legal, engineering, or surveying purposes.