

- Rock source
- Stock pile
- Waste area
- Block
- Culvert removal
- Bridge
- Gate
- Survey corner
- Domestic water supply
- Green tree retention area
- Buffer zone
- Area boundary
- Sale boundary
- Ownership boundary
- Type-F stream
- Type-N stream
- Unsurfaced road
- Surfaced road
- State highway
- Abandoned road
- Road construction
- County road
- OHV trail
- Non-motorized trail

EXHIBIT A
Vicinity Map
 Timber Sale Contract No. 341-04-29
 Lower Roller Road
 Portions of section 3, T1S, R9W, and
 sections 15, 16, 21 and 22 T1N, R9W, W. M.
 Tillamook County, Oregon

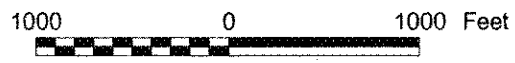

Area	Type of Operation	Acres	
		Net	Gross
1	Clear Cut	21	34
2	Clear Cut	26	30
Total		47	64



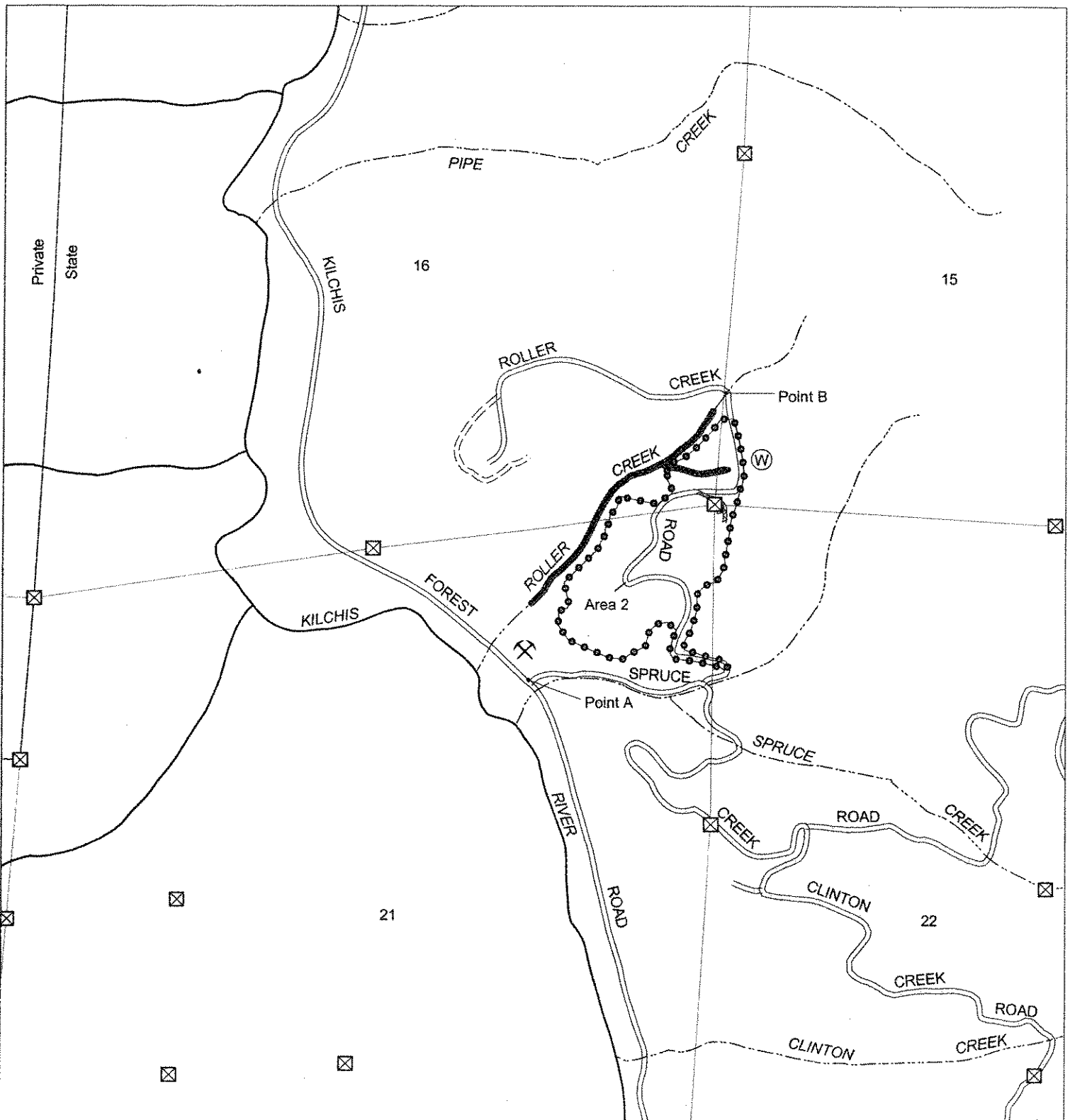

- Rock source
- Stock pile
- Waste area
- Block
- Culvert removal
- Bridge
- Gate
- Survey corner
- Domestic water supply
- Green tree retention area
- Buffer zone
- Area boundary
- Sale boundary
- Ownership boundary
- Type-F stream
- Type-N stream
- Unsurfaced road
- Surfaced road
- State highway
- Abandoned road
- Road construction
- County road
- OHV trail
- Non-motorized trail

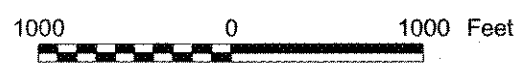

EXHIBIT A
Vicinity Map
Timber Sale Contract No. 341-04-29
Lower Roller Road
Portions of section 3, T1S, R9W, and
sections 15, 16, 21 and 22 T1N, R9W, W. M.
Tillamook County, Oregon



Area	Type of Operation	Acres	
		Net	Gross
1	Clear Cut	21	34
2	Clear Cut	26	30
Total		47	64



EXHIBIT A
Vicinity Map
Timber Sale Contract No. 341-04-29
Lower Roller Road
Portions of section 3, T1S, R9W, and
sections 15, 16, 21 and 22 T1N, R9W, W. M.
Tillamook County, Oregon

-  Rock source
-  Stock pile
-  Waste area

