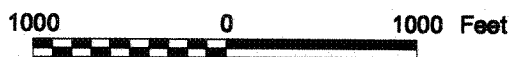

EXHIBIT A
Timber Sale Contract
No. 341-04-20
West Point
Portions of sections
25, 26, 34, and 35, T2N, R8W,
section 30 T2N, R7W, and
sections 2 and 3, T1N, R8W, W. M.
Tillamook County, Oregon

Area	Type of Operation	Acres	
		Net	Sale
1	Partial Cut	9	9
2	Partial Cut	12	13
3	Clear Cut	8	9
4	Partial Cut	11	13
5	Clear Cut	25	30
6	Partial Cut	78	99
7	Partial Cut	21	22
8	Partial Cut	29	37
Total		193	232



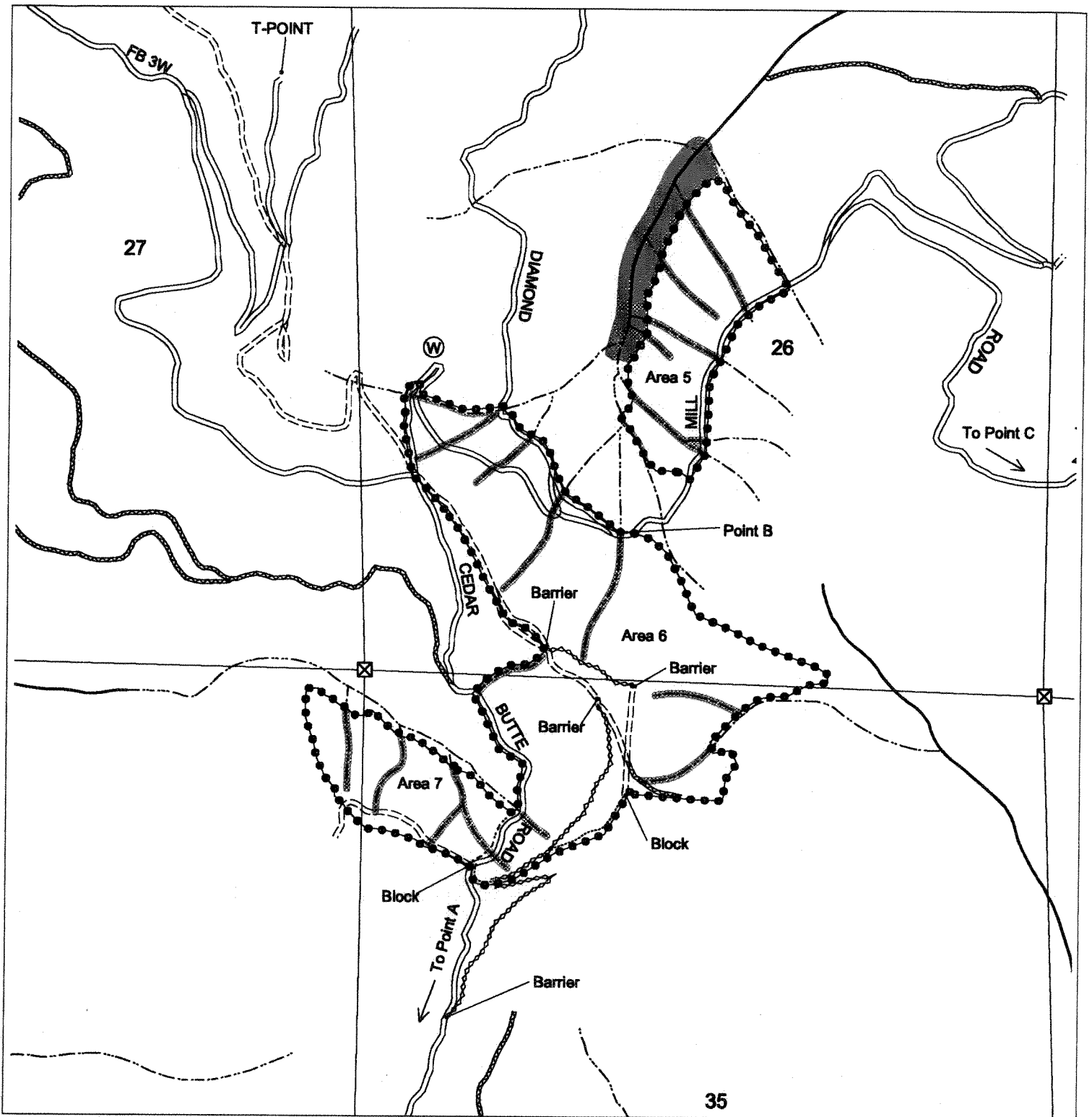
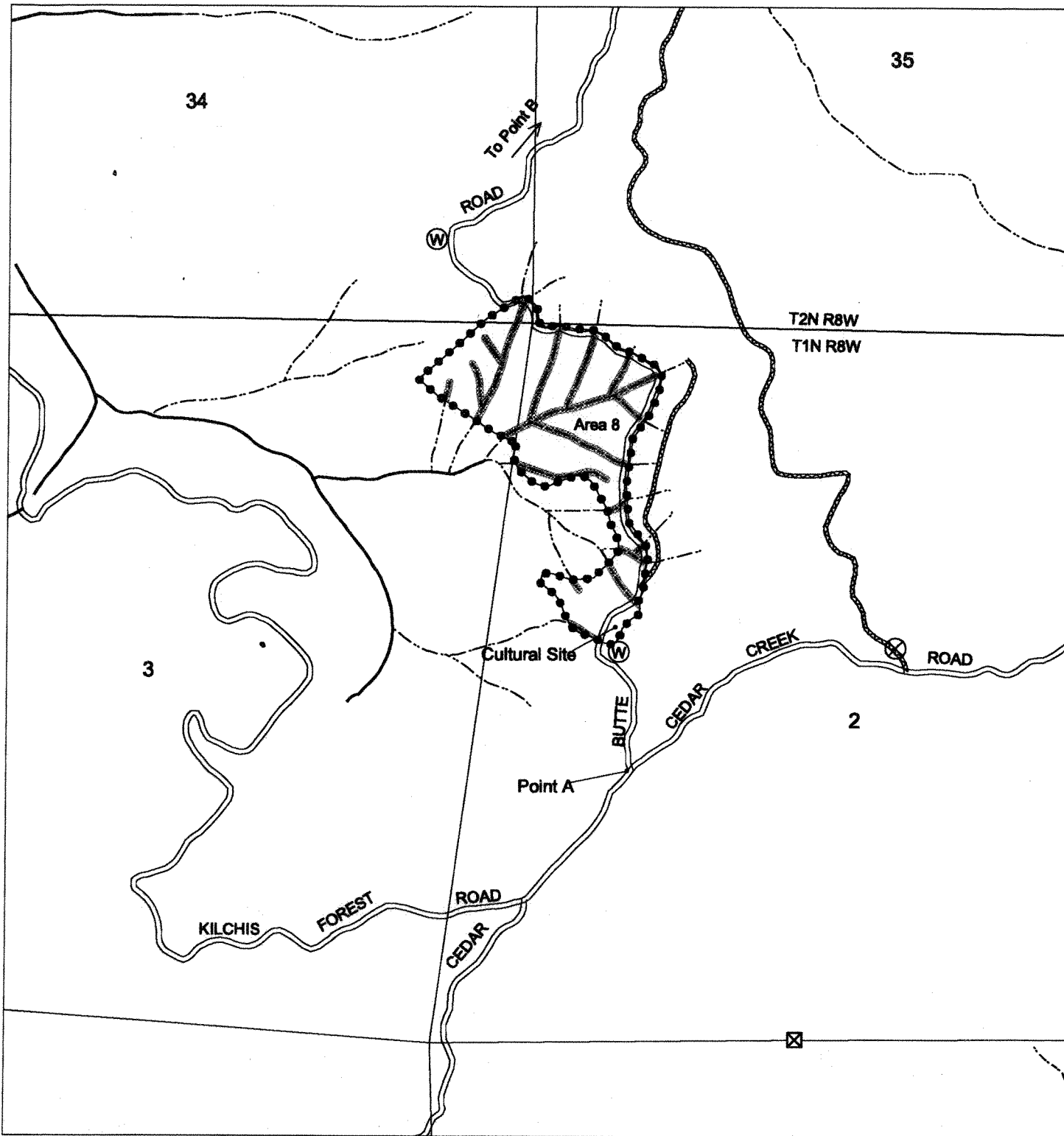

EXHIBIT A
Timber Sale Contract
No. 341-04-20
West Point
Portions of sections
25, 26, 34, and 35, T2N, R8W,
section 30 T2N, R7W, and
sections 2 and 3, T1N, R8W, W. M.
Tillamook County, Oregon

Area	Type of Operation	Acres	
		Net	Sale
1	Partial Cut	9	9
2	Partial Cut	12	13
3	Clear Cut	8	9
4	Partial Cut	11	13
5	Clear Cut	25	30
6	Partial Cut	78	99
7	Partial Cut	21	22
8	Partial Cut	29	37
Total		193	232

- | | | | |
|--|---------------------------|--|---------------------|
| | Rock source | | Area boundary |
| | Stock pile | | Sale boundary |
| | Waste area | | Ownership boundary |
| | Blocked | | Type-F stream |
| | Culvert removal | | Type-N stream |
| | Bridge | | Unsurfaced road |
| | Gate | | Surfaced road |
| | Survey corner | | State highway |
| | Domestic water supply | | Abandoned road |
| | Green tree retention area | | Road construction |
| | Buffer | | County road |
| | | | OHV trail |
| | | | Non-motorized trail |



- | | | | |
|--|---------------------------|--|---------------------|
| | Rock source | | Area boundary |
| | Stock pile | | Sale boundary |
| | Waste area | | Ownership boundary |
| | Blocked | | Type-F stream |
| | Culvert removal | | Type-N stream |
| | Bridge | | Unsurfaced road |
| | Gate | | Surfaced road |
| | Survey corner | | State highway |
| | Domestic water supply | | Abandoned road |
| | Green tree retention area | | Road construction |
| | Buffer | | County road |
| | | | OHV trail |
| | | | Non-motorized trail |

EXHIBIT A
Timber Sale Contract
No. 341-04-20
West Point
Portions of sections
25, 26, 34, and 35, T2N, R8W,
section 30 T2N, R7W, and
sections 2 and 3, T1N, R8W, W. M.
Tillamook County, Oregon

Area	Type of Operation	Acres	
		Net	Sale
1	Partial Cut	9	9
2	Partial Cut	12	13
3	Clear Cut	8	9
4	Partial Cut	11	13
5	Clear Cut	25	30
6	Partial Cut	78	99
7	Partial Cut	21	22
8	Partial Cut	29	37
Total		193	232

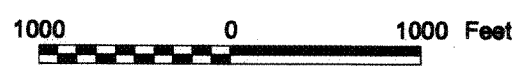

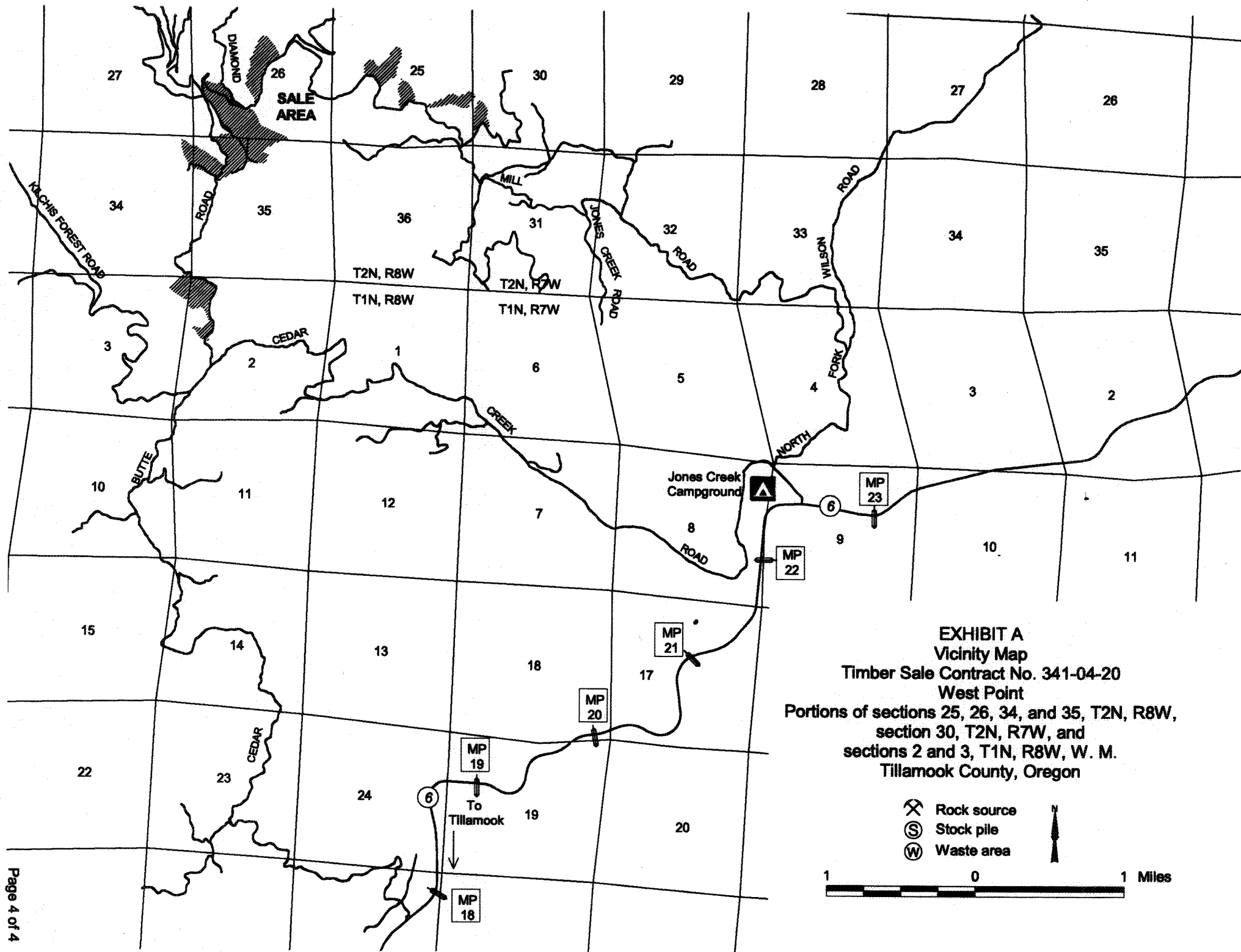

EXHIBIT A
Vicinity Map
Timber Sale Contract No. 341-04-20
West Point
 Portions of sections 25, 26, 34, and 35, T2N, R8W,
 section 30, T2N, R7W, and
 sections 2 and 3, T1N, R8W, W. M.
 Tillamook County, Oregon

- Rock source
- Stock pile
- Waste area

