



"STEWARDSHIP IN FORESTRY"

# Timber Sale Appraisal Cost Summary New Moon Sale 341-03-67

District: Tillamook

Date: 4/3/03

	Conifer	Hardwood	Total
<b>Gross Timber Sale Value</b>	\$78,461.24	\$2,438.80	\$80,900.04
		<b>Project Work</b>	\$0.00
		<b>Advertised Value</b>	\$80,900.04



"STEWARDSHIP IN FORESTRY"

# Timber Sale Appraisal Timber Description New Moon Sale 341-03-67

**District:** Tillamook

**Location:** Moon Creek Road  
T3S, R8W, Section 16

**Date:** 4/3/03

**Stand Stocking:** 20%

Species	Avg. DBH	Amortized %	Recovery %
Douglas - Fir	14	0	95
Alder (Red)	14	0	95

Volume by Grade	Douglas - Fir	Alder (Red)	Total
3S	266	0	266
4S	20	0	20
Camprun	0	10	10
<b>Total</b>	286	10	296

**Comments:** Pond Values Used: 1st Quarter 2003

Alder pond value of \$515/mbf was obtained locally.

Other(add profit and risk): \$592 total

Brand and Paint: \$2/mbf x 296 mbf = \$592

Maintenance Moon Creek Road: \$5.44/mbf

Grading: \$500/mile x 2.7 miles x 1 time / 296 mbf= \$4.56/mbf

Surfacing: 20cy x \$13/cy / 296 mbf= \$.88/mbf



"STEWARDSHIP IN FORESTRY"

# Timber Sale Appraisal

## Logging Conditions

### New Moon

### Sale 341-03-67

---

<b>Combination#:</b> 1	Douglas - Fir	100.00%	
	Alder (Red)	100.00%	
<b>Yarding Distance:</b>	Short (400 ft)		<b>Downhill Yarding:</b> Yes
<b>Logging System:</b>	Track Skidder		<b>Process:</b> Manual Falling/Delimiting
<b>Tree Size:</b>	Small / Thinning 9in (70 Bft/tree), 20+ logs/MBF		
<b>Loads/Day:</b>	6		<b>Bd. Ft./Load:</b> 3,500
<b>Cost/MBF:</b>	\$155.50		
<b>Machines:</b>			
	Log Loader (B)		
	Track Skidder		



# Timber Sale Appraisal

## Logging Costs

### New Moon

### Sale 341-03-67

"STEWARDSHIP IN FORESTRY"

Date: 4/3/03

Operating Seasons: 1.0

Profit & Risk: 12%

Project Costs: \$0

Other Costs (P/R): \$592

Slash Disposal: \$0

Other Costs: \$0

Road Maintenance: \$5.44

Miles of Road			
Dirt	Rock (Contractor)	Rock (State)	Paved
0.0	0.0	0.0	0.0

#### Hauling Costs

Species	\$/MBF	Trips/Day	MBF/Load
Douglas - Fir	\$0.00	3.0	3.4
Alder (Red)	\$0.00	2.0	3.0

#### Local Pond Values

Date	Species	Grade	Value
4/3/03	Alder (Red)	Camprun	\$515.00



"STEWARDSHIP IN FORESTRY"

# Timber Sale Appraisal Logging Costs Breakdown New Moon Sale 341-03-67

Costs	Douglas - Fir	Alder (Red)
<b>Logging</b>	155.50	155.50
<b>Road Maintenance</b>	5.73	5.73
<b>Fire Protection</b>	9.48	0.00
<b>Hauling</b>	46.11	80.84
<b>Other (P/R appl.)</b>	2.07	0.00
<b>Profit &amp; Risk</b>	26.27	29.05
<b>Slash Disposal</b>	0.00	0.00
<b>Scaling</b>	2.00	0.00
<b>Other</b>	0.00	0.00
<b>Total</b>	247.16	271.12

<b>Amortization</b>	0.00	0.00
<b>Pond Value</b>	521.50	515.00
<b>Stumpage</b>	274.34	243.88
<b>Amortized</b>	0.00	0.00



"STEWARDSHIP IN FORESTRY"

# Timber Sale Appraisal Summary New Moon Sale 341-03-67

## Amortized

	Douglas - Fir	Alder (Red)
MBF	0.00	0.00
Value	0.00	0.00
Total	0.00	0.00

## Unamortized

	Douglas - Fir	Alder (Red)
MBF	286.00	10.00
Value	274.34	243.88
Total	78,461.24	2,438.80

## Gross Timber Sale Value

**Recovery \$80,900.04**

Prepared by: John Pine

Date: 4/3/03

District: Tillamook

Phone: (503) 842-2545



"STEWARDSHIP IN FORESTRY"

# OREGON DEPARTMENT OF FORESTRY CRUISE REPORT

New Moon

1. **Type of Sale:** Regeneration harvest– Recovery
2. **Legal Description:** Portion of Section 16 of T3S, R8W, W.M., Tillamook County, Oregon.
3. **Sale Acreage:** The sale boundary was plotted on a digital orthophotograph and the acreage was calculated with GIS.

Sale Area	ACRES		
	<u>Sale</u>	<u>Total</u>	<u>Net</u>
	40	43	36

**Sale Acres**

Area within the Timber Sale Boundary signs

**Total acres**

*For accomplishment reporting*

**Clearcut harvest** - Sale acres; plus green tree retention acres outside the sale boundary; less roads and riparian areas classified as Special Stewardship in LMCS inside the sale boundary.

**Net acres**

*Used for calculating the advertised volume.*

**Clearcut** - Sale acres, less green tree retention, roads, and riparian areas classified as Special Stewardship in LMCS inside the sale boundary.

4. **Cruising Procedures:**

- A. **Cruise Method:** Four parallel cruise lines spaced 300 feet apart were established on the sale area. Along those lines variable radius full point plots were taken every 200 feet. A total of 18 count tree plots were established and 9 of the plots were also measured and graded to determine a V-BAR for the stand. Diameters were measured at a height of 4.5 feet above the ground on the uphill side. Diameters were to the nearest 1", heights to the nearest foot. Diameters under 9" were not recorded. The cruise had a coefficient of variation of 52.9 and a SE% of 12.5 for net board feet / acre.
- B. **Plot size:** A BAF of 20 was used, the point of tree observation was 4.5 feet.
- C. **Grading System:** Tree heights were to a 6" merchantable height for conifers, 8" for hardwoods. Douglas-fir was graded using Columbia River rules favoring a 40' log, all other species graded camprun.

- D. **Defect and Breakage:** A 5% defect and breakage reduction was applied to both conifer and hardwood volume.
- E. **Cruiser Names / Dates:** John Pine and Don Everingham. August and September 2002.
5. **Computation Procedures:** V-BAR (Volume-Basal Area Ratio) and Basal Area for the take trees was computed using SuperAce. The data from SuperACE was entered into a Volume Computation Spreadsheet (see attached) to obtain volumes for use in the appraisal.
6. **Timber Description:** The sale contains Swiss Needle Cast infected Douglas-fir stands 37 years of age with scattered clumps of hemlock. Hardwoods are present in draws and near abandoned roads.
7. **Revenue Distribution:**  
100% FDF  
Tax Code: 8-1  
Deed No. 186, 338, 368  
Rehabilitation Obligated: None
8. **Appendices:**  
- Volume Summary  
- Logging Plan





"STEWARDSHIP IN FORESTRY"

## New Moon

### Volume Summary

36 acres						
SPECIES	Basal Area Per Acre	V-BAR	Vol/Acre MBF	Volume MBF	D & B	Net Vol MBF
Douglas-fir	92	91	8.4	301	5%	286
Alder	3	87	0.3	10	5%	10
<b>TOTAL</b>				311		296

TOTAL SALE VOLUME			
SPECIES	MBF	D&B	Net Vol. (MBF)
Douglas-fir	301	5%	286
Alder	10	5%	10
<b>TOTAL</b>	311		296

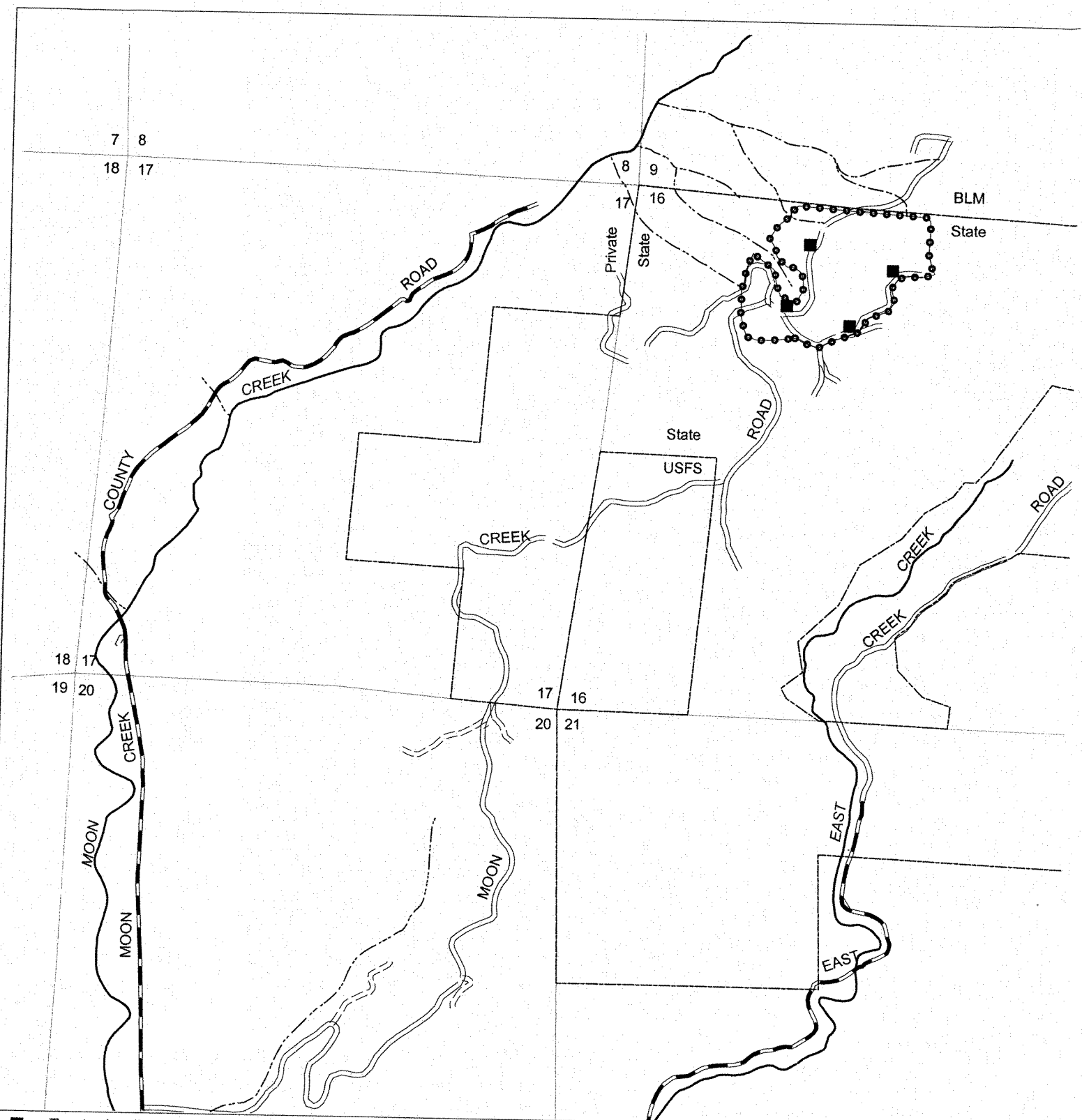

- Tractor landing
- Cable landing
- ▲ Domestic water supply
- ⊗ Block
- Cable yarding
- Ground yarding
- ▨ Helicopter yarding
- Buffer zone
- Non-required thinning
- ⊂ Green tree retention area
- Setting boundary
- - - Area boundary
- ⋯ Sale boundary
- Ownership boundary
- Type-F stream
- - - Type-N stream
- Surfaced road
- - - Unsurfaced road
- State highway
- County road
- (2) - Non-project road
- - - Swing road
- - - Abandoned road
- ⋯ OHV trail
- ⋯ Non-motorized trail

**LOGGING PLAN**  
 Timber Sale Contract No. 341-03-67  
 New Moon  
 Portions of section 16, T3S, R8W, W. M.  
 Tillamook County, Oregon

	Type of		Acres	
	Operation	Sale	Net	
Clear Cut	40	36		

