



"STEWARDSHIP IN FORESTRY"

Timber Sale Appraisal Cost Summary Buntu Sale 341-03-66

District: Tillamook

Date: 4/3/03

	Conifer	Hardwood	Total
Gross Timber Sale Value	\$51,588.60	\$4,074.90	\$55,663.50
		Project Work	(\$7,971.68)
		Advertised Value	\$47,691.82



"STEWARDSHIP IN FORESTRY"

Timber Sale Appraisal Timber Description Buntu Sale 341-03-66

District: Tillamook

Location: Portions of Section 19, T3S, R9W, W.M., Tillamook County, OR
Bun Creek Road
Beaver, OR

Date: 4/3/03

Stand Stocking: 20%

Species	Avg. DBH	Amortized%	Recovery%
Douglas - Fir	12	0	95
Alder (Red)	12	0	95

Volume by Grade	Douglas - Fir	Alder (Red)	Total
3S	166	0	166
4S	47	0	47
Camprun	0	15	15
Total	213	15	228

Comments: Pond Values Used: 1st Quarter 2003

Alder pond values of \$515 obtained locally.

Other (add profit and risk): \$456

Brand and Paint: $\$2.00/\text{mbf} \times 228\text{mbf} = \456

Other costs (profit and risk included): \$583.46

USFS Forest Developed Road #1004 road use fees:

Application fee :\$143

Timber access fee: $\$.675 \text{ mbf}/\text{mile} \times .65 \text{ miles} \times 228 \text{ mbf} = \100.04

Timber hauling fee : $\$1.44 \text{ mbf}/\text{mile} \times .65 \text{ m} \times 228 \text{ mbf} = \213.41

Access fee for maintenance rock : $\$.1168/\text{ton}/\text{mile} \times .65 \text{ m} \times 20\text{cy} @ 3200 \text{ lbs}/\text{cy} / 2000\text{lbs}/\text{ton}$
= \$2.43

Access fee for project work rock: $\$.1168/\text{ton}/\text{mile} \times .65\text{m} \times 128\text{cy} @ 3000 \text{ lbs}/\text{cy} / 2000\text{lbs}/\text{ton}$
= \$14.58

Slash piling and sorting: $\$110.00/\text{hr} \times 1 \text{ hour} = \110.00

Maintenance Bun Creek unit road: Total \$2.59/mbf

Grading: $\$500/\text{mile} \times 1 \text{ mile} \times 1 \text{ time}/228\text{mbf} = \$2.19/\text{mbf}$

Surfacing: $20\text{cy}/\text{mile} \times .23\text{MMBF} \times \$20/\text{cy} \times 1 \text{ mile} / 228\text{mbf} = \$.40/\text{mbf}$



Timber Sale Appraisal

Logging Conditions

Buntu

Sale 341-03-66

"STEWARDSHIP IN FORESTRY"

Combination#: 1	Douglas - Fir	100.00%	
	Alder (Red)	100.00%	
Yarding Distance:	Medium (800 ft)		Downhill Yarding: No
Logging System:	Cable: Small Tower <=40		Process: Manual Delimiting
Tree Size:	Small / Thinning 9in (70 Bft/tree), 20+ logs/MBF		
Loads/Day:	5		Bd. Ft./Load: 3,400
Cost/MBF:	\$168.50		
Machines:			
	Log Loader (A)		
	Tower Yarder (Small)		



"STEWARDSHIP IN FORESTRY"

Timber Sale Appraisal

Logging Costs

Buntu

Sale 341-03-66

Date: 4/3/03

Operating Seasons: 1.0

Profit & Risk: 15%

Project Costs: \$7,972

Other Costs (P/R): \$456

Slash Disposal: \$0

Other Costs: \$583

Road Maintenance: \$2.59

Miles of Road			
Dirt	Rock (Contractor)	Rock (State)	Paved
0.0	0.0	0.0	0.0

Hauling Costs

Species	\$/MBF	Trips/Day	MBF/Load
Douglas - Fir	\$0.00	3.0	3.4
Alder (Red)	\$0.00	4.0	3.0

Local Pond Values

Date	Species	Grade	Value
4/3/03	Alder (Red)	Camprun	\$515.00



Timber Sale Appraisal Logging Costs Breakdown Buntu Sale 341-03-66

"STEWARDSHIP IN FORESTRY"

Costs	Douglas - Fir	Alder (Red)
Logging	168.50	168.50
Road Maintenance	2.73	2.73
Fire Protection	12.72	0.00
Hauling	46.11	40.37
Other (P/R appl.)	2.14	0.00
Profit & Risk	34.83	31.74
Slash Disposal	0.00	0.00
Scaling	2.00	0.00
Other	2.74	0.00
Total	271.77	243.34

Amortization	0.00	0.00
Pond Value	513.97	515.00
Stumpage	242.20	271.66
Amortized	0.00	0.00



"STEWARDSHIP IN FORESTRY"

Timber Sale Appraisal Summary Buntu Sale 341-03-66

Amortized

	Douglas - Fir	Alder (Red)
MBF	0.00	0.00
Value	0.00	0.00
Total	0.00	0.00

Unamortized

	Douglas - Fir	Alder (Red)
MBF	213.00	15.00
Value	242.20	271.66
Total	51,588.60	4,074.90

Gross Timber Sale Value

Recovery \$55,663.50

Prepared by: John Pine

Date: 4/3/03

District: Tillamook

Phone: (503) 842-2545

PROJECT SUMMARY SHEET

Sale: BUNTU

Date: Nov. 25 2002

Construction -

Point		stations =	\$0.00
Point		stations =	\$0.00
		SUB TOTAL	<u>\$0.00</u>

Improvement -

Point	A to B	52+70	stations =	\$7,159.68
Point			stations =	\$0.00
Point			stations =	\$0.00
Point			stations =	\$0.00
Point			stations =	\$0.00
			SUB TOTAL	<u>\$7,159.68</u>

Move - In -

Move-In		\$812.00
		\$0.00
		\$0.00
	SUB TOTAL	<u>\$812.00</u>

GRAND TOTAL \$7,971.68

SUMMARY OF CONSTRUCTION COST

Sale: BUNTU Road: Bun Creek Road

Construction - 0.00 stations miles Improvement - 52+70 stations miles
0.00 miles 1.00 miles

CLEARING AND GRUBBING -

Side cast	0.00 acres @	\$540.00 per acre =	\$0.00	
Scattering	2.00 acres @	\$815.00 per acre =	\$1,630.00	
Piling	0.00 acres @	\$905.00 per acre =	\$0.00	
Endhaul	0.00 acres @	\$1,500.00 per acre =	\$0.00	
TOTAL CLEARING AND GRUBBING				\$1,630.00

EXCAVATION -

	0 hr.s @	\$0.00 per hr. =	\$0.00	
	52.70 sta. @	\$30.00 per sta. =	\$1,581.00	
End Haul				
Sta. 19+10	200 cys. @	\$2.70 per c.y. =	\$540.00	
	0 cys. @	\$0.00 per c.y. =	\$0.00	
	0 cys. @	\$0.00 per c.y. =	\$0.00	
TOTAL EXCAVATION				\$2,121.00

CULVERT MATERIALS -

Culverts					
0	LF of 18"	\$0.00	0	LF of 24"	\$0.00
0	LF of 30"	\$0.00	0	LF of 36"	\$0.00
0	LF of 42"	\$0.00	0	LF of 48"	\$0.00
0	LF of 54"	\$0.00	0	LF of 60"	\$0.00
		\$0.00			\$0.00
Half Rounds					
0	LF of 21"	\$0.00	0	LF of 30"	\$0.00
0	LF of 36"	\$0.00	0	LF of 42"	\$0.00
0	LF of 48"	\$0.00	0	LF of 54"	\$0.00
0	LF of 60"	\$0.00	0	LF of 66"	\$0.00
		\$0.00			\$0.00
Culvert Stakes					
0	1/2 round stakes @	\$8.00 per stake =	\$0.00		
0	marker stakes @	\$6.00 per stake =	\$0.00		
TOTAL CULVERT MATERIALS				\$0.00	

SURFACING-

12" Depth	128	cy. of	Pit Run	@	\$12.88 per c.y. =	\$1,648.64
TOTAL SURFACING						\$1,648.64

SPECIAL PROJECTS

Grass Seed & Fertilize Areas of Disturbed Soil: 2.4 Acres @ \$180/ac.	\$432.00	
Grade Road 52+70 Stations @ \$14.20/sta.	\$748.34	
Roll Subgrade: 52+70 Stations @ \$11/sta.	\$579.70	
TOTAL SPECIAL PROJECTS		\$1,760.04

GRAND TOTAL **\$7,159.68**

MOVE-IN CALCULATIONS

SALE NAME: BUNTU

MILEAGE FACTORS		MILEAGE FACTORS	
Distance	Factor	Distance	Factor
0-25	0.58	55	1.07
30	0.66	60	1.15
35	0.74	65	1.23
40	0.82	70	1.31
45	0.91	75	1.4
50	1	80	1.48

MILEAGE FACTOR = 0.58

EQUIPMENT DESCRIPTION	Base Cost	Move W/in Area/Mile	Begin Mileage	End Mileage	Total Miles	Cost
0 Drill & Compressor	\$241	\$8.15	0	0	0	\$0.00
1 Graders	\$241	\$7.05	0	0	0	\$139.78
0 Loader--1 1/2-2 1/2 cy	\$241	\$10.00	0	0	0	\$0.00
0 --3 cy.s>	\$387	\$10.00	0	9	9	\$0.00
1 Rollers & Compactors	\$241	\$22.00	0	0	0	\$139.78
Excavators, Big						
1 Backhoes	\$533	\$40.00	0	0	0	\$309.14
0 Backhoes 24/30" Bucket (Rub Tir	\$241	\$10.00	0	0	0	\$0.00
1 Tractors -- D5 - D7	\$385	\$20.00	0	0	0	\$223.30
0 -- D8	\$533	\$25.53	0	0	0	\$0.00
0 Dump Trucks< 10 cy	\$121	\$2.30	0	9.4	9.4	\$0.00
0 >10cy	\$144	\$2.76	0	0	0	\$0.00
Rock Crusher (Excluding Setup)						
0 Don't add stage 1 Stage	\$1,066					\$0.00
0 costs together 2 Stage	\$1,597					\$0.00
0 3 Stage	\$2,489					\$0.00
0 Screening Plant	\$387					\$0.00
0 Crusher Setup 1 Stage	\$733					\$0.00
0 Don't add stage 2 Stage	\$1,598					\$0.00
0 costs together 3 Stage	\$2,520					\$0.00
0 Change Gradation	\$207					\$0.00
0 Screening Plant	\$395					\$0.00

TOTAL MOVE-IN COSTS: \$812.00



**OREGON DEPARTMENT OF FORESTRY
CRUISE REPORT**

Buntu

1. **Type of Sale:** Regeneration – Recovery
2. **Legal Description:** Portion of Section 19 of T3S, R9W, W.M., Tillamook County, Oregon.
3. **Sale Acreage:** The sale boundary was plotted on a digital orthophotograph and the acreage was calculated with GIS.

	ACRES		
Sale Area	<u>Sale</u>	<u>Total</u>	<u>Net</u>
	36	41	33

Sale Acres

Area within the Timber Sale Boundary signs

Total acres

For accomplishment reporting

Clearcut harvest - Sale acres; plus green tree retention acres outside the sale boundary; less roads and riparian areas classified as Special Stewardship in LMCS inside the sale boundary.

Net acres

Used for calculating the advertised volume.

Clearcut - Sale acres, less green tree retention, roads, and riparian areas classified as Special Stewardship in LMCS inside the sale boundary.

4. **Cruising Procedures:**

- A. **Cruise Method:** : Five cruise lines spaced 300 feet apart were established on the sale area. Along those lines variable radius full point plots were taken every 200 feet. A total of 18 count tree plots were established and 9 of the plots were also measured and graded to determine a V-BAR for the stand. Diameters were taken at 4.5 feet above ground on the uphill side. Diameters were measured to the nearest 1", heights to the nearest 1'. Diameters under 9" were not recorded. The cruise had a coefficient of variation of 62.1 and a SE% of 14.6 for the net board feet / acre.
- B. **Plot size:** A BAF of 20 was used, the point of tree observation was 4.5 feet.
- C. **Grading System:** Tree heights were measured to a 6" merchantable top for conifers and 8" for hardwoods. Douglas-fir was graded using Columbia River rules favoring a 40' log, all other species graded camprun.

D. **Defect and Breakage:** A 5% defect and breakage reduction was applied to both conifer and hardwood volume.

E. **Cruiser Names / Dates:** John Pine and Elliott Stone. July and August 2002.

5. **Computation Procedures:** V-BAR (Volume-Basal Area Ratio) and Basal Area for the take trees was computed using SuperACE. The data from SuperACE was entered into a Volume Computation spreadsheet (see attached) to obtain volumes for use in the appraisal.

6. **Timber Description:** The sale contains Swiss Needle Cast infected Douglas-fir stands 38 years of age with scattered clumps of hemlock. Hardwoods are present in draws and near abandoned roads.

7. **Revenue Distribution:**
100% FDF
Tax Code: 8, 8-2
Deed No. 186
Rehabilitation Obligated: None

8. **Appendices:**
- Volume Summary
- Logging Plan



"STEWARDSHIP IN FORESTRY"

Buntu

Volume Summary

Area I						
33 acres						
SPECIES	Basal Area Per Acre	V-BAR	Vol/Acre MBF	Volume MBF	D & B	Net Vol MBF
Douglas-fir	81	84	6.8	225	5%	213
Alder	7	68	0.5	16	5%	15
TOTAL				240		228

TOTAL SALE VOLUME			
SPECIES	MBF	D & B	Net Vol. (MBF)
Douglas-fir	225	5%	213
Alder	16	5%	15
TOTAL	241		228

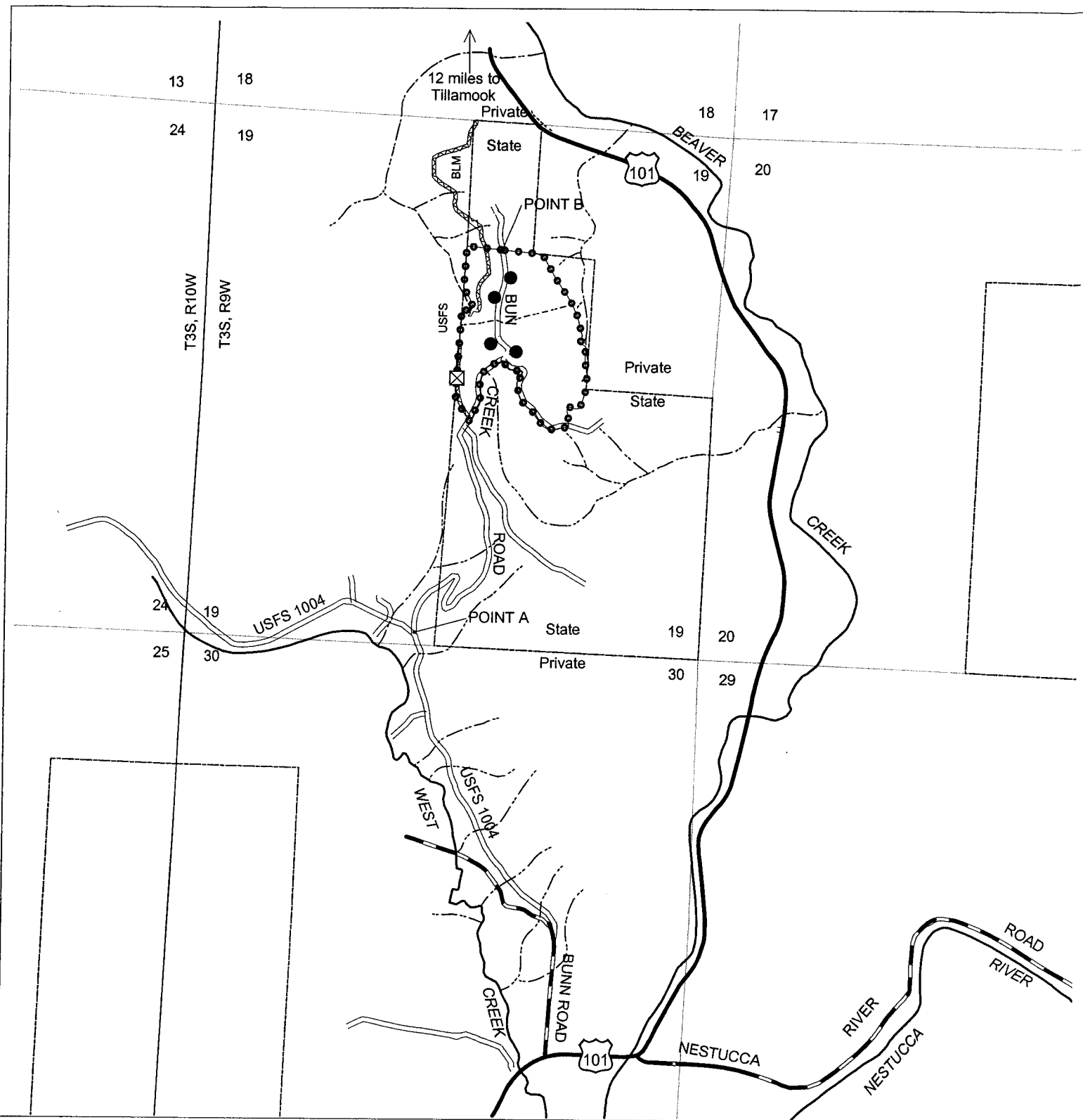

- Tractor landing
- Cable landing
- ▲ Domestic water supply
- ⊗ Block
- Cable yarding
- Ground yarding
- ▨ Helicopter yarding
- Buffer zone
- Non-required thinning
- ⊂ Green tree retention area
- Setting boundary
- Area boundary
- Sale boundary
- Ownership boundary
- Type-F stream
- Type-N stream
- Surfaced road
- Unsurfaced road
- State highway
- County road
- ② Non-project road
- Swing road
- Abandoned road
- ⊂ OHV trail
- Non-motorized trail

LOGGING PLAN
 Timber Sale Contract No. 341-03-66
 Buntu
 Portions of section 19, T3S, R9W, W. M.
 Tillamook County, Oregon

Type of Operation	Acres Sale	Acres Net
Clear Cut	36	33
Total	36	33

