

- Green Tree Retention
- Area boundary
- Sale boundary
- Unsurfaced road
- Surfaced road
- State highway
- Abandoned road
- Road construction
- County road
- OHV trail
- Non-project road
- Type-F stream
- Type-N stream
- Stream Buffer
- Survey corner
- Rock source
- Stock pile
- Waste area
- Transmission Lines

Exhibit A
of Timber Sale Contract No. 341-03-29
Swiss MISC
Portions of sections 13, 14, 23, 24, 25,
and 26, T1N, 10W, portions of
section 36, T2N, R10W, and
portions of section 31, T2N, T9W,
W. M., Tillamook County, Oregon

Area	Sale	Clear Cut	
		Net	Partial Cut
1	42	26	0
2	25	5	13
3	50	0	31
4	120	30	57
5	43	19	17
5 (CSL)	34	0	26
6	17	0	13
6 (CSL)	5	0	5
Total	336	80	162

*CSL - Common School Land

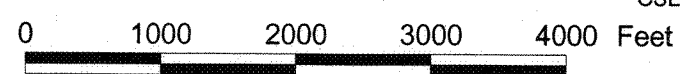

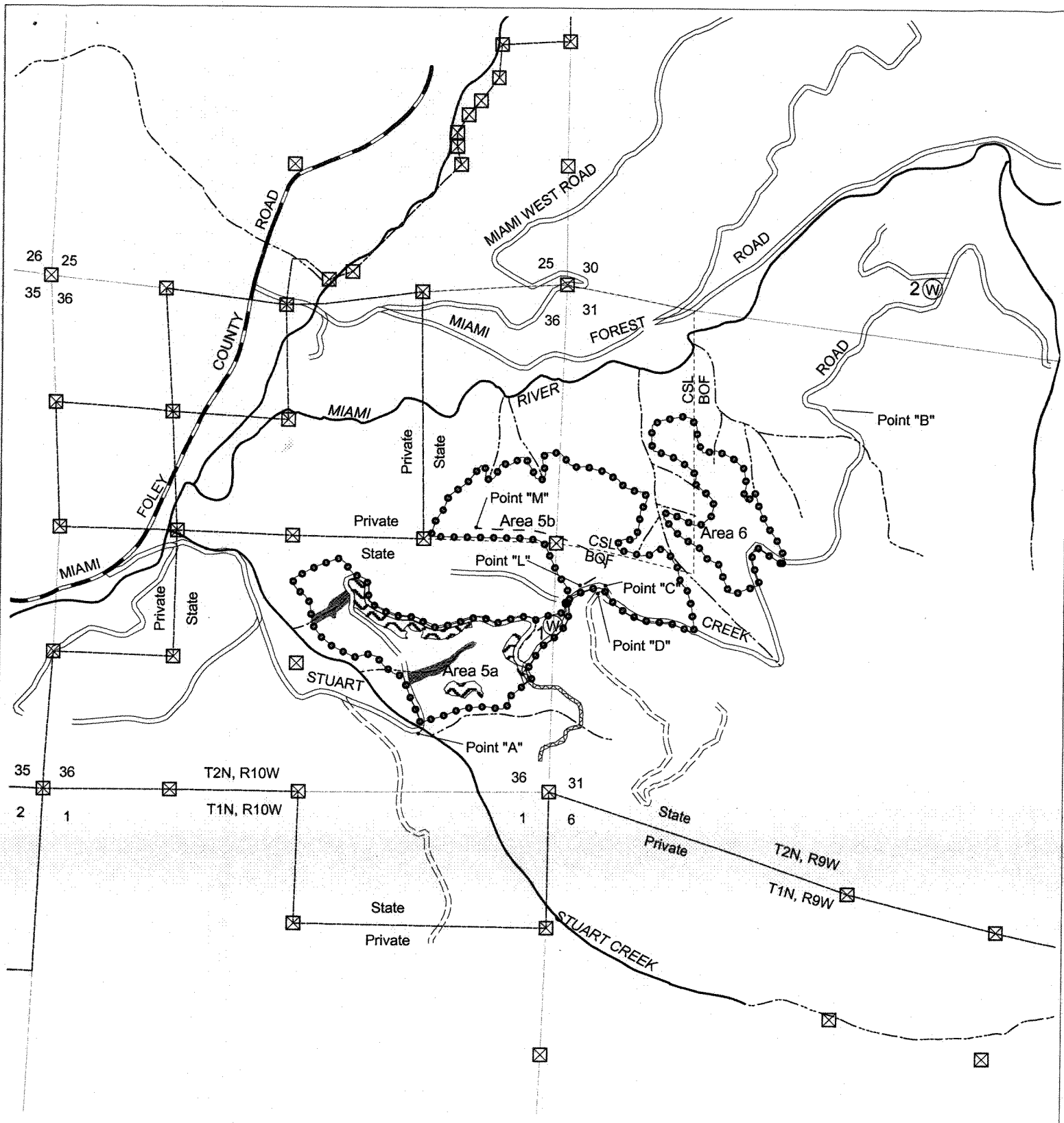

- Green Tree Retention
- Area boundary
- Sale boundary
- Unsurfaced road
- Surfaced road
- State highway
- Abandoned road
- Road construction
- County road
- OHV trail
- Non-project road
- Type-F stream
- Type-N stream
- Stream Buffer
- Survey corner
- Rock source
- Stock pile
- Waste area

Exhibit A
of Timber Sale Contract No. 341-03-29
Swiss MISC
Portions of sections 13, 14, 23, 24, 25,
and 26, T1N, 10W, portions of
section 36, T2N, R10W, and
portions of section 31, T1N, T9W,
W. M., Tillamook County, Oregon

Area	Sale	Clear Cut	
		Net	Partial Cut Net
1	42	26	0
2	25	5	13
3	50	0	31
4	120	30	57
5	43	19	17
5 (CSL)	34	0	26
6	17	0	13
6 (CSL)	5	0	5
Total	336	80	162

*CSL - Common School Land

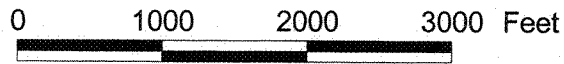

Exhibit A
 Vicinity Map
 of Timber Sale Contract No. 341-03-29
 Swiss MISC
 Portions of sections 13, 14, 23, 24, 25,
 and 26, T1N, 10W, portions of
 section 36, T2N, R10W, and
 portions of section 31, T1N, T9W,
 W. M., Tillamook County, Oregon

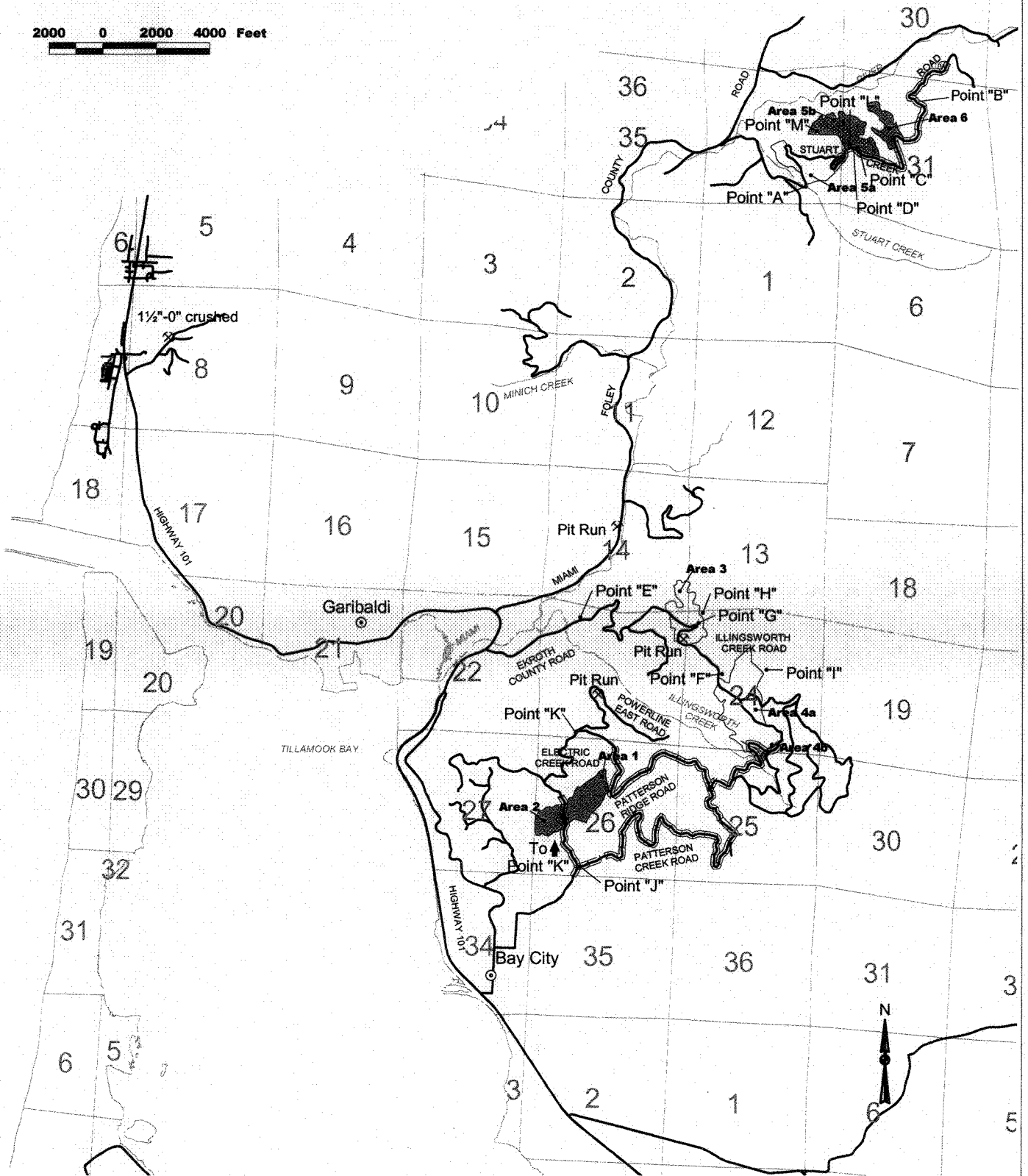

Exhibit A
 Seasonal Restriction Map
 of Timber Sale Contract No. 341-03-29
 Swiss MISC
 Portions of sections 13, 14, 23, 24, 25,
 and 26, T1N, 10W, portions of
 section 36, T2N, R10W, and
 portions of section 31, T1N, T9W,
 W. M., Tillamook County, Oregon

■ Area Seasonal Restrictions
 ▨ Seasonal Road Restrictions

2000 0 2000 4000 Feet

