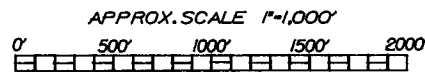

EXHIBIT "A"

OF TIMBER SALE CONTRACT NO. 341-03-12
TOTTEN CREEK
PORTIONS OF SECTION 7, T24S, R11W, W. M.
COOS COUNTY, OREGON

APPROXIMATELY 36 ACRES



LEGEND

- | | | | | | |
|-------|---------------------------|-----------|--|-------|-----------------------------------|
| | TIMBER SALE BOUNDARY | STA. 0+00 | Survey Station | ===== | Primary Existing Road |
| ----- | Area Boundary | ◆ | Known Land Survey Corner | ----- | Secondary Existing Road |
| ----- | Right Of Way Boundary | ① | Culvert Location | ----- | Primary Road (Const. Required) |
| | Stream Buffer | | Snag Corridor | ----- | Secondary Road (Const. Required) |
| | Reforestation Area | ▲ | Rock Pit | ===== | County Road |
| | Tractor Yarding Permitted | ▲ | Type F Stream | ----- | Private Road (Access Not Assured) |
| | Point For Project Work | ▲ | Type N Stream | ----- | Existing Road - State Maintained |
| | Green Tree Retention Area | ▲ | Debris Removal Required (Below Asterisk) | | |
| | High Risk Area | ▲ | | | |
| | | X X | Scattered GTR. | | |

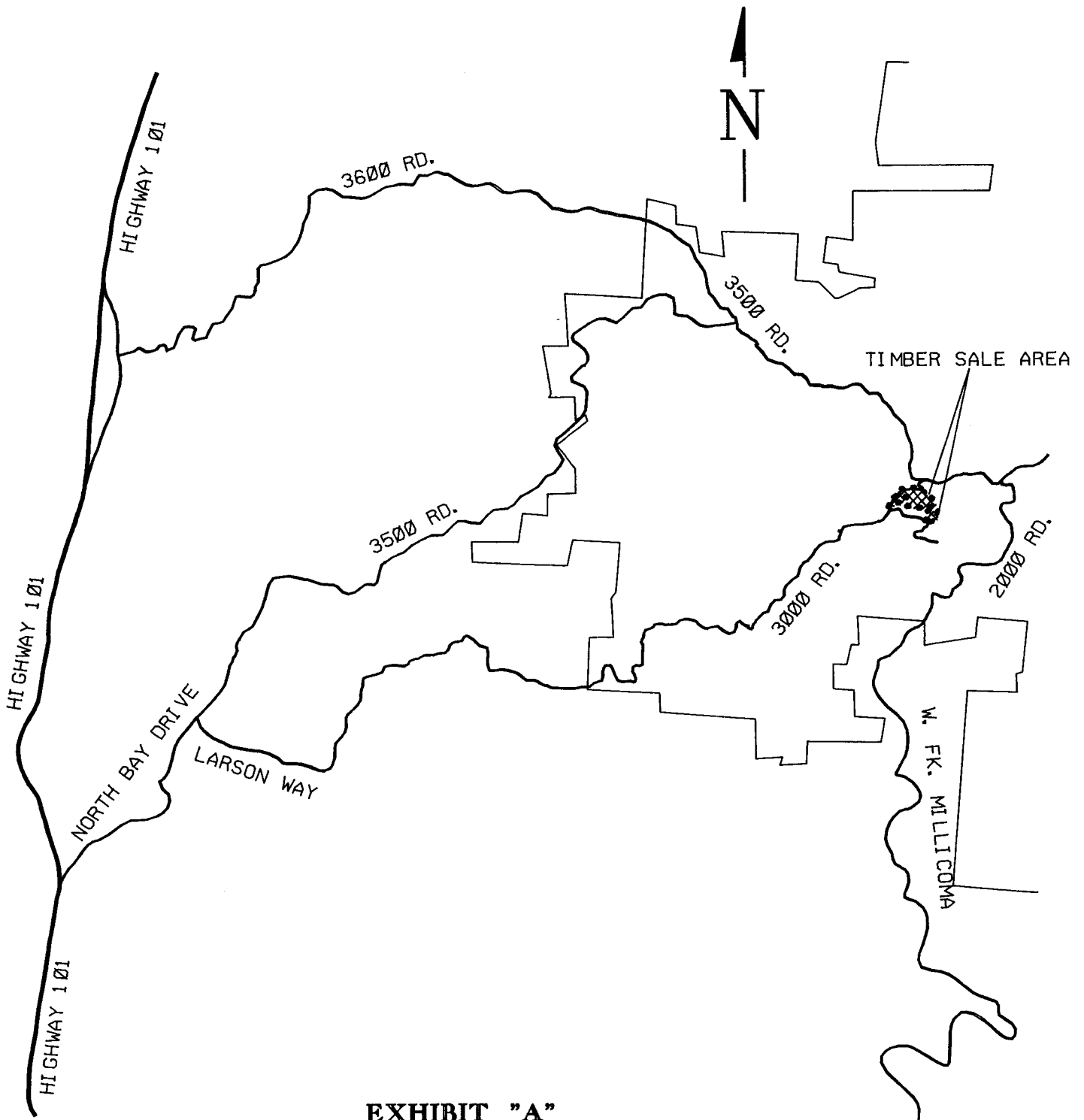

EXHIBIT "A"
VICINITY MAP

OF TIMBER SALE CONTRACT NO. 341-03-12
TOTTEN CREEK
COOS COUNTY, OREGON

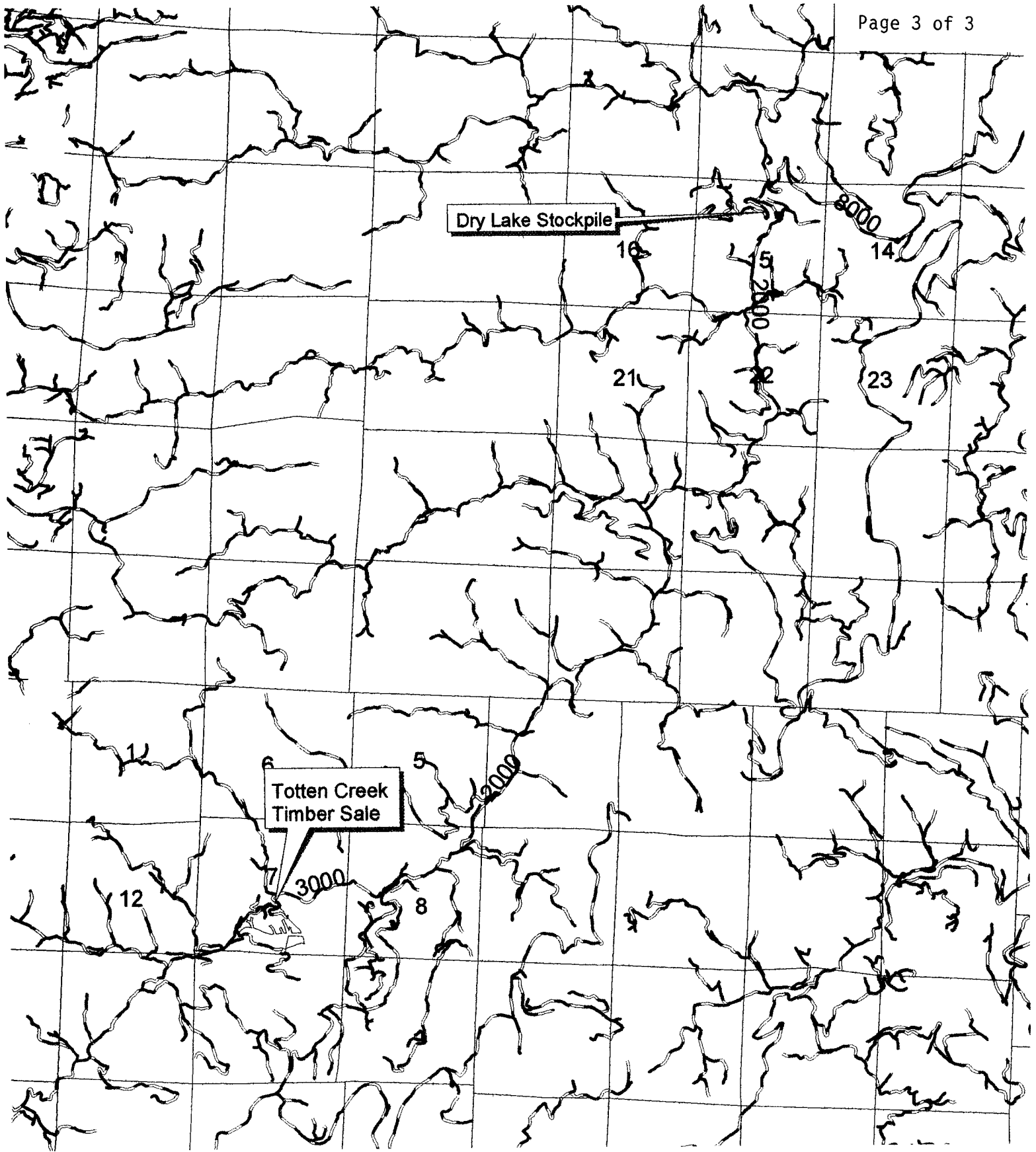

Exhibit "A"
Vicinity Map for Dry Lake Stockpile
Sec. 15, T 23S., R 11W.

