

Legend

- Type F Stream
- Type N Stream
- Landing to be Constructed
- Timber Sale Boundary
- Area Boundary
- Right Of Way Boundary
- Stream Buffer
- Reforestation Area
- POINT "A" Point For Project Work
- Surfaced Road
- New Construction
- Wetland
- Microwave Tower
- Underground Powerline

Exhibit "A"

OF TIMBER SALE CONTRACT NO.
 341-03-01
 SAINT NICK THINNING
 PORTIONS OF SECTIONS 8, 9, 16, 17,
 20 & 21 T7N, R6W, WM, CLATSOP COUNTY, OREGON

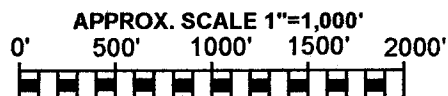

Approximate Net Acreage

| | | |
|--------------|-----|------------------|
| AREA 1 | PC | 68 ACRES |
| AREA 2 | PC | 168 ACRES |
| AREA 3 | PC | 257 ACRES |
| AREA 4 | CC | 3 ACRES |
| AREA 5 | CC | 20 ACRES |
| AREA 6 | R/W | 8 ACRES |
| TOTAL | | 524 ACRES |

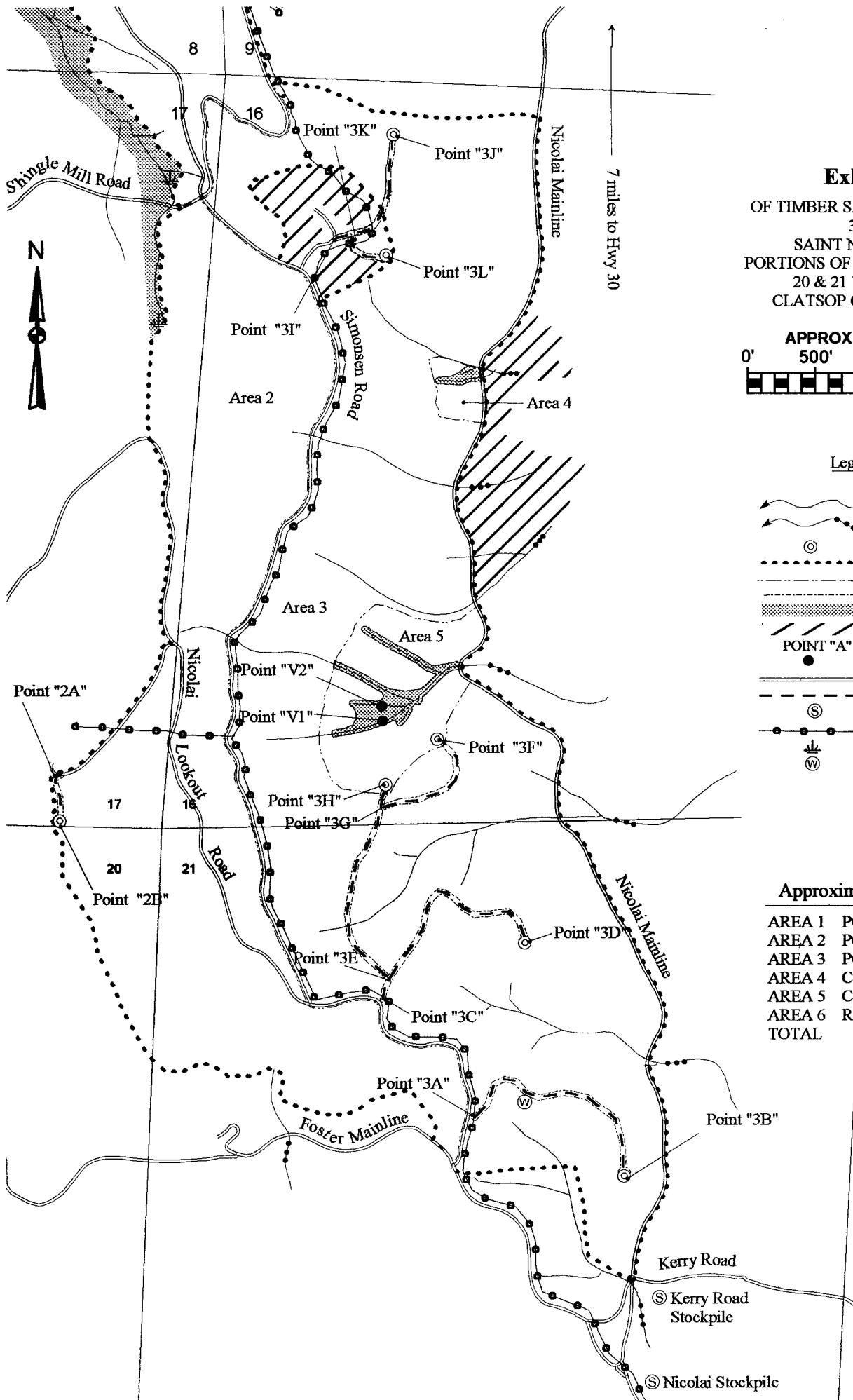
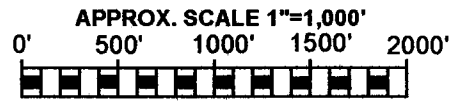

Exhibit "A"

OF TIMBER SALE CONTRACT NO.
 341-03-01
 SAINT NICK THINNING
 PORTIONS OF SECTIONS 8, 9, 16, 17,
 20 & 21 T7N, R6W, WM,
 CLATSOP COUNTY, OREGON



Legend

- Type F Stream
- Type N Stream
- Landing to be Constructed
- Timber Sale Boundary
- Area Boundary
- Right Of Way Boundary
- Stream Buffer
- Reforestation Area
- POINT "A"
Point For Project Work
- Vacating Project
- Surfaced Road
- New Construction
- Stockpile Site
- Underground Powerline
- Wetland
- Waste Area

Approximate Net Acreage

| | | |
|--------------|-----|------------------|
| AREA 1 | PC | 68 ACRES |
| AREA 2 | PC | 168 ACRES |
| AREA 3 | PC | 257 ACRES |
| AREA 4 | CC | 3 ACRES |
| AREA 5 | CC | 20 ACRES |
| AREA 6 | R/W | 8 ACRES |
| TOTAL | | 524 ACRES |

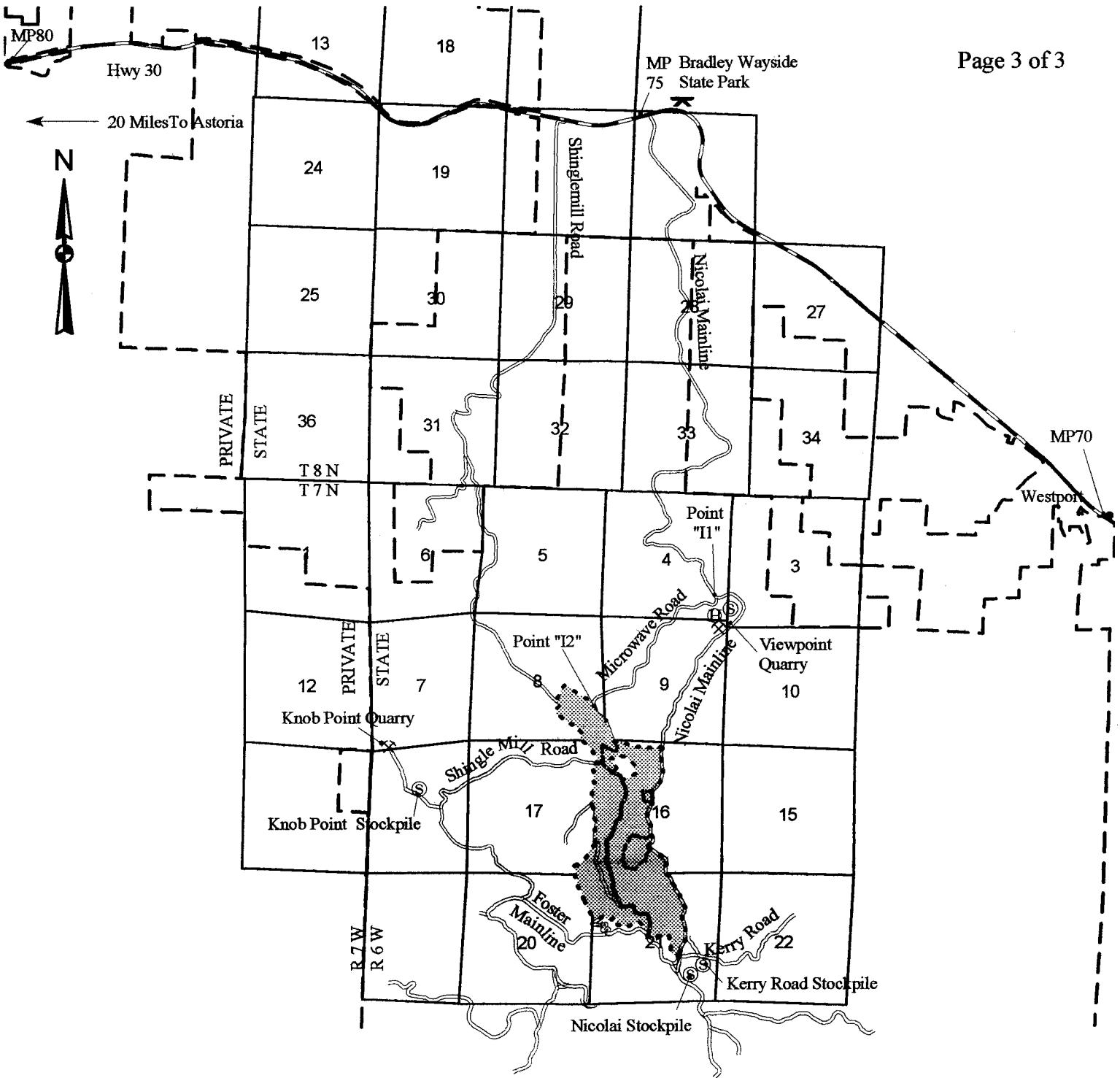

- Legend**
- Ownership Boundary
 - Timber Sale Boundary
 - Area Boundary
 - ▨ Timber Sale Area
 - POINT "A" Point For Project Work
 - ⊙ Stockpile Site
 - ⊗ Quarry
 - ⊕ Helicopter Evacuation Point
 - In Viewpoint Quarry
Latitude 46 6.77
Longitude -123 25.57
 - MP75 • Mile Post
 - ==== Surfaced Road
 - ==== Highway 30
 - Point "I1" Point for Project Work

Vicinity Map
 OF TIMBER SALE CONTRACT NO.
 341-03-01
 SAINT NICK THINNING
 PORTIONS OF SECTIONS 8, 9, 16, 17,
 20 & 21 T7N, R6W, WM, CLATSOP COUNTY, OREGON



| Approximate Net Acreage | |
|-------------------------|------------------|
| AREA 1 PC | 68 ACRES |
| AREA 2 PC | 168 ACRES |
| AREA 3 PC | 257 ACRES |
| AREA 4 CC | 3 ACRES |
| AREA 5 CC | 20 ACRES |
| AREA 6 R/W | 8 ACRES |
| TOTAL | 524 ACRES |