



"STEWARDSHIP IN FORESTRY"

Timber Sale Appraisal Cost Summary New Potato Sale 341-02-69

District: Tillamook

Date: 4/8/02

	Conifer	Hardwood	Total
Gross Timber Sale Value	\$1,210,346.80	\$0.00	\$1,210,346.80
		Project Work	(\$166,322.00)
		Advertised Value	\$1,044,024.80



Timber Sale Appraisal Timber Description New Potato Sale 341-02-69

"STEWARDSHIP IN FORESTRY"

District: Tillamook

Location: Sections 18 and 19, T1SR7W and
Sections 13, 14, and 24, T1SR8W

Date: 4/8/02

Stand Stocking: 40%

Species	Avg. DBH	Amortized%	Recovery%
Douglas - Fir	16	0	95

Volume by Grade	Douglas - Fir	Total
2S	895	895
3S	3,130	3,130
4S	447	447
Total	4,472	4,472

Comments: Pond Values Used: 1st Quarter 2002

Road Maintenance: Total = \$2.34

Grading: 6 miles X 2 gradings X 500/mile/4472 MBF = 1.34

Surfacing: \$3.30/yard X 4.5 MMBF X 6miles X 50 CuYds/mile / 4472 MBF = \$1.00

Other Cost (plus profit and risk):

Brand and paint: \$2.00MBF X 4472 = \$8,994

Other Cost (profit and risk included): Total = \$2810.00

Open Blocked Roads:

Backhoe = 8hrs. @ \$115/hr. = \$920.00

Move-In = 360.00

100cy crushed rock @ \$3.30cy = \$330.00

Pit-run rock for landings and spot rocking on existing spur roads:

200 cyds @ \$6/cy = \$1,200

Hardwood Pond Value of \$420 obtained from Northwest Hardwoods for Jan. 2002.

\$420-\$230.60 = \$189.40



Timber Sale Appraisal

Logging Conditions

New Potato

Sale 341-02-69

"STEWARDSHIP IN FORESTRY"

Combination#: 1 Douglas - Fir 70.00%

Yarding Distance: Medium (800 ft) **Downhill Yarding** No

Logging System: Cable: Medium Tower >40 - <70 **Process:** Stroke Delimber

Tree Size: Small / Thinning 12in (130 Bft/tree), 12-17 logs/MBF

Loads/Day: 6 **Bd. Ft./Load:** 3,500

Cost/MBF: \$156.32

Machines:

- Log Loader (A)
- Stroke Delimber (A)
- Tower Yarder (Medium)

Combination#: 2 Douglas - Fir 30.00%

Yarding Distance: Medium (800 ft) **Downhill Yarding** No

Logging System: Track Skidder **Process:** Feller Buncher

Tree Size: Small / Thinning 12in (130 Bft/tree), 12-17 logs/MBF

Loads/Day: 8 **Bd. Ft./Load:** 3,500

Cost/MBF: \$125.67

Machines:

- Feller Buncher w/ Delimber
- Log Loader (B)
- Stroke Delimber (B)
- Track Skidder



"STEWARDSHIP IN FORESTRY"

Timber Sale Appraisal

Logging Costs

New Potato

Sale 341-02-69

Date: 4/8/02

Operating Seasons: 2.0

Profit & Risk: 15%

Project Costs: \$166,322

Other Costs (P/R): \$8,944

Slash Disposal: \$0

Other Costs: \$2,810

Miles of Road			
Dirt	Rock (Contractor)	Rock (State)	Paved
0.0	0.0	0.0	0.0

Road Maintenance: \$2.34

Hauling Costs

Species	\$/MBF	Trips/Day	MBF/Load
Douglas - Fir	\$0.00	3.0	3.5



"STEWARDSHIP IN FORESTRY"

Timber Sale Appraisal Logging Costs Breakdown New Potato Sale 341-02-69

Costs	Douglas - Fir
Logging	147.12
Road Maintenance	2.46
Fire Protection	1.21
Hauling	46.11
Other (P/R appl.)	2.00
Profit & Risk	29.83
Slash Disposal	0.00
Scaling	2.00
Other	0.63
Total	231.36

Amortization	0.00
Pond Value	502.01
Stumpage	270.65
Amortized	0.00



"STEWARDSHIP IN FORESTRY"

Timber Sale Appraisal Summary New Potato Sale 341-02-69

Amortized

	Douglas - Fir
MBF	0.00
Value	0.00
Total	0.00

Unamortized

	Douglas - Fir
MBF	4,472.00
Value	270.65
Total	1,210,346.80

Gross Timber Sale Value

Recovery \$1,210,346.80

Prepared by: Steve Langer

Date: 4/8/02

District: Tillamook

Phone: (503) 842-2545

PROJECT SUMMARY SHEET

Sale: NEW POTATO Date: Mar. 14 2002

Vacating -

Point	H - I	183+20	stations =	\$65,406.93
Point	C - D	34+00	stations =	\$8,607.50
Point	C - E	81+90	stations =	\$16,337.78
Point	C - F	17+00	stations =	\$309.00
Point			stations =	\$0.00
Point			stations =	\$0.00
Point			stations =	\$0.00
Point			stations =	\$0.00
SUB TOTAL				<u>\$90,661.21</u>

Improvement -

Point	A - B	12+25	stations =	\$54,252.70
Point			stations =	\$0.00
SUB TOTAL				<u>\$54,252.70</u>

Special Projects -

<u>Culvert Removal @ Pt. G</u>	\$16,187.96
<u>DIETZ CREEK STREAM ENHANCEMENT PROJECT:</u>	\$5,220.08
SUB TOTAL	\$21,408.04

GRAND TOTAL \$166,321.95

SUMMARY OF CONSTRUCTION COST

Sale: NEW POTATO

Road: Points A - B Sam Downs Road

Improvement 12+25 stations
0.23 miles

EXCAVATION -

LOG FILL @ 5+45:			
Excavator	8 hr.s @	\$130.00 per hr. =	\$1,040.00
ARCH-PIPE @ 9+15:			
Excavator	72 hr.s @	\$130.00 per hr. =	\$9,360.00
D-7 Cat	68 hr.s @	\$96.00 per hr. =	\$6,528.00
Dump Truck	63 hr.s @	\$57.00 per hr. =	<u>\$3,591.00</u>
TOTAL EXCAVATION			\$20,519.00

CULVERT MATERIALS -

Culverts			
	30	LF of 18"	\$442.50
	46	LF of 24"	\$816.50
	96	LF of 142"x91"	<u>\$18,760.32</u>
			\$20,019.32
Half Rounds			
	10	LF of 21"	\$114.00
	10	LF of 30"	<u>\$145.00</u>
			\$259.00
Culvert Stakes			
4	1/2 round stakes @	\$8.00 per stake=	\$32.00
3	marker stakes @	\$6.00 per stake=	<u>\$18.00</u>
			\$50.00

3 Aluminized Bands & Gaskets			<u>\$1,311.00</u>	
TOTAL CULVERT MATERIALS				\$21,639.32

SURFACING-

Sta.s 6+00 to 12+25				
12" Depth	474	cy. of	Pit Run @	\$6.32 per c.y.= \$2,995.68
Sta. 5+45				
12" Depth	66	cy. of	Pit Run @	\$6.32 per c.y.= \$417.12
Sta. 0+15				
12" Depth	30	cy. of	Pit Run @	\$6.32 per c.y.= <u>\$189.60</u>
TOTAL SURFACING				\$3,602.40

MISCELLANEOUS-

For Arch-pipe:				
146	cy. of	Bedding Rock @	\$19.00 per c.y.=	\$2,774.00
40	cy. of	Riprap @	\$14.24 per c.y.=	<u>\$569.60</u>
TOTAL MISCELLANEOUS				\$3,343.60

SPECIAL PROJECTS

Grade Road, Stations 4+95 to 12+25		\$103.66
ARCH-PIPE INSTALLATION:		
3 Days Water Diversion Around Site w/ Water Pumps: 3 Pumps x \$75/day x 3 Days		\$675.00
Labor: 2 Persons, 40 Hours @ \$28/hr.		\$2,240.00
Hand Tamp Fill: Hand Tamper, 2 Days & \$45/day		\$90.00
Grass Seed, Fertilize & Mulch Fill Slopes, Waste Area & Disturbed Soil: .4 Acres @ \$1,180/ac.		<u>\$472.00</u>
TOTAL SPECIAL PROJECTS		\$3,580.66
MOVE-IN: Water Truck, 2 Rollers, Cat. Excavator, Dump Trucks		\$1,567.72
TOTAL MOVE-IN		\$1,567.72

GRAND TOTAL \$54,252.70

SUMMARY OF CONSTRUCTION COST

Sale: New Potato Road: Pt.s C - D, White Creek Ridge Road

Vacate Road - 34+00 stations
0.64 miles

CLEARING AND GRUBBING -

Side cast 1.40 acres @ \$540.00 per acre = \$756.00

EXCAVATION -

Excavator	9 hr.s @	\$130.00 per hr. =	\$1,170.00	
	0.00 sta. @	\$65.00 per sta. =	\$0.00	
	3783 cys. @	\$1.50 per c.y. =	\$5,674.50	
	0 cys. @	\$0.00 per c.y. =	\$0.00	
	0 cys. @	\$0.00 per c.y. =	\$0.00	
		TOTAL EXCAVATION		\$6,844.50

SPECIAL PROJECTS

Construct Road Barrier @ Pt. C	\$50.00
Remove Old Culverts	\$224.92
Waterbar Construction	\$275.00
Grass Seed, Fertilize Areas of Distrubed Soil	\$115.00
TOTAL SPECIAL PROJECTS	\$664.92

MOVE-IN: Excavator, Dump Truck	\$342.08
TOTAL SPECIAL PROJECTS	\$342.08

GRAND TOTAL **\$8,607.50**

SUMMARY OF CONSTRUCTION COST

Sale: NEW POTATO

Road: Little North Fork Wilson River Pt.s C - E

Vacate Road - 81+90 stations
1.55 miles

CLEARING AND GRUBBING -

Side cast 1.40 acres @ \$540.00 per acre = \$756.00

Excavator	9.5 hr.s @	\$130.00 per hr. =	\$1,235.00	
	0.00 sta. @	\$65.00 per sta. =	\$0.00	
	8378 cys. @	\$1.50 per c.y. =	\$12,567.00	
	0 cys. @	\$0.00 per c.y. =	\$0.00	
	0 cys. @	\$0.00 per c.y. =	\$0.00	
		TOTAL EXCAVATION		\$13,802.00

SPECIAL PROJECTS

<u>Waterbar Road</u>	\$1,025.00
<u>Grass Seed, Fertilize Areas of Disturbed Soil</u>	\$394.00
<u>Remove Culverts From State Land</u>	\$360.78
TOTAL SPECIAL PROJECTS	\$1,779.78

GRAND TOTAL **\$16,337.78**

SUMMARY OF CONSTRUCTION COST

Sale: NEW POTATO Road: Culvert Removal--Pt. G Clear Crk. Rd.

Culvert Removal 1+00 stations
0.02 miles

EXCAVATION -

	0 hr.s @	\$0.00 per hr. =	\$0.00	
	0.00 sta. @	\$65.00 per sta. =	\$0.00	
W/ End Haul	2632 cys. @	\$5.23 per c.y. =	\$13,765.36	
	0 cys. @	\$0.00 per c.y. =	\$0.00	
	0 cys. @	\$0.00 per c.y. =	\$0.00	
		TOTAL EXCAVATION		\$13,765.36

SPECIAL PROJECTS

<u>Grass Seed, Fertilize & Mulch Areas of Disturbed Soil & Waste Area: .3 Acres @ 1,180/</u>	\$354.00
<u>Remove Culvert From State Land</u>	\$270.00
<u>Construct 2 Four-Foot High Barriers w/ Trenches</u>	\$100.00
<u>Develop Waste Area</u>	\$500.00
TOTAL SPECIAL PROJECTS	\$1,224.00
<u>MOVE-IN: Excavator, Cat, Dump Trucks</u>	<u>\$698.60</u>
TOTAL SPECIAL PROJECTS	\$1,198.60

GRAND TOTAL **\$16,187.96**

SUMMARY OF CONSTRUCTION COST

Sale: NEW POTATO Road: Points H - I, Sam Downs Road

Vacating - 183+20 stations
3.47 miles

CLEARING AND GRUBBING -

Side cast 6.30 acres @ \$540.00 per acre = \$3,402.00
TOTAL CLEARING AND GRUBBING \$3,402.00

EXCAVATION -

ROAD VACATING:
Excavator 34.5 hr.s @ \$130.00 per hr. = \$4,485.00
D-7 Cat 8 hr.s @ \$96.00 per hr. = \$768.00
Pullback 31348 cys. @ \$1.44 per c.y. = \$45,141.12
0 cys. @ \$0.00 per c.y. = \$0.00
TOTAL EXCAVATION \$50,394.12

SPECIAL PROJECTS -

ROAD VACATING:
Construct 2 Tank Traps \$100.00
Waterbar Construction \$1,145.00
Grass Seed, Fertilize Areas & Mulch Areas of Disturbed Soil: 7.3 Acres @\$1,180/ac. \$8,614.00
Remove Old Culverts From State Lands \$1,551.81
TOTAL SPECIAL PROJECTS \$11,410.81

MOVE-IN: Cat, Excavator \$200.00
TOTAL MOVE-IN \$200.00

GRAND TOTAL **\$65,406.93**

SUMMARY OF CONSTRUCTION COST

Sale: New Potato Road: Deitz Creek Stream Enhancement Project
Sites 1, 2, 3, 4

Excavator 25 hr.s @ \$130.00 per hr. = \$3,250.00
 TOTAL \$3,250.00

SPECIAL PROJECTS

Log Truck & Driver: 4 Hours @ \$77/hr. \$308.00
Dump Truck to Move Pipe Creek Log: 4 Hours @ \$77/hr. \$228.00
Laborer: 12 hours @ \$28/hr. \$336.00
Seed, Fertilize & Mulch Access Trails & Disturbed Soil \$100.00
Move-In: Excavator, Log Truck \$998.08
 TOTAL SPECIAL PROJECTS \$1,970.08

GRAND TOTAL **\$5,220.08**

PIT RUN PIT DEVELOPMENT AND STRIPPING COST SUMMARY
SALE: NEW POTATO

Location: **NW1/4Sec21RT1NR8W**

Pit:	Sam Downs
Rock:	PIT RUN
Swell:	1.30
Shrinkage:	1.16
Drill Pct.:	25%

Road:	570 c.y.
Stockpile Size:	c.y.
Total Truck Loads:	570 c.y.
In Place Total:	438 c.y.

Pit Development:						\$500.00
Drill & Shoot:	\$1.90	/cu.yd.	x	110	cu.yds.	\$208.27
Strip Rock:	\$1.50	/cu.yd.	x	329	cu.yds.	\$493.27
Push Rock:	\$0.60	/cu.yd.	x	570	cu.yds.	\$342.00
Load Dump Truck:	\$0.70	/cu.yd.	x	570	cu.yds.	\$399.00
				Sub Total		\$1,942.54

Base Cost **\$3.41 Per Cu.Yd.**

Road Segment	Haul Cost /cu.yd.	Proc Cost /cu.yd.	Base Cst. /cu.yd.	Cost /cu.yd.	Number Cu. Yds	ROCK COST
A - B	\$2.01	\$0.90	\$3.41	\$6.32	570	\$3,601.24
	\$0.00	\$0.90	\$3.41	\$4.31	0	\$0.00
				Total C.Y.	570	Sub Total \$3,601.24

Stockpile	Haul Cost /cu.yd.	Proc Cost /cu.yd.	Base Cst. /cu.yd.	Cost /cu.yd.	Number Cu.Yds.	ROCK COST
	\$0.00	\$0.55	\$0.00	\$0.55	0	\$0.00
	\$0.00	\$0.55	\$0.00	\$0.55	0	\$0.00
				Total C.Y.	0	Sub Total \$0.00

TOTAL ROCKING COSTS = \$3,601.24

OREGON DEPARTMENT OF FORESTRY
CRUISE REPORT



New Potato

1. **Type of Sale:** Clearcut Harvest/ Recovery.
2. **Legal Description:** Portions of Sections 18 and 19, T1S, R7W, and Sections 13, 14 and 24, T1S, R8W, W.M., Tillamook County, Oregon.
3. **Sale Acreage:** The sale boundaries were plotted on a digital orthophotograph and the acreage was calculated with GIS.

ACRES			
Area	Sale	Total	Net
1	120	128	116
2	84	85	77
3	22	23	21
4	84	86	81
5	46	46	44
6	108	102	93
Total	464	470	432

Sale Acres: *Area within the Timber Sale Boundary signs.*

Total Acres: *For accomplishment reporting*

Clearcut: Sale acres; plus green tree retention acres outside the sale boundary; less roads and riparian areas classified as Special Stewardship in LMCS inside the sale boundary.

Net Acres: *Used for calculating the advertised volume.*

Clearcut: Sale acres; less green tree retention, roads, and riparian areas classified as Special Stewardship in LMCS inside the sale boundary.

4. **Cruising Procedures:**

A. **Cruise Method:** Plots were established on a grid of 250 X 500. A total of 139 full point plots were taken. Information from these plots was then used to compute basal area and average diameter of the trees to be removed. V-BAR (volume to basal area ratio) trees were measured in representative portions of the stand and entered into SuperAce Timberland Appraisal and Planning System from Atterbury Consultants Inc., version 95.02.21.

B. **Plot Size:** A basal area factor of 20 was used. The point observation for conifers and hardwoods was 4.5 feet.

C. **Grading System:** Grade breakdown was based on grades assigned when measuring V-BAR trees.

5. **Computation Procedures:** Basal area was calculated from plot data taken. V-BAR (Volume-Basal Area Ratio) was computed by entering V-BAR measurements into SuperAce. See attached Volume Computation Summary and Stand Tables.
6. **Defect and Breakage:** A 5% defect and breakage reduction was applied to the volume.
7. **Timber Description:** The sale area burned in the 1933 and 1939 fires. The sale area was planted from 1953 to 1956 and is currently 45 to 50 years old. Alder was sprayed in the 1970's. Douglas-fir was thinned and the majority of the alder removed with a timber sale in 1995. The sale area is severely infected with Swiss needle cast with one to two years of needle retention and growth has slowed.
8. **Cruiser Names/Dates:** Shaver/Keith/Langer, April, 2001.
9. **Revenue Distribution:**
100% FDF
Tax Code: 9-1(70%), 9-2(30%)
Deed Numbers: 161, 169
100% Rehabilitation Obligated
10. **Attachments:**
Volume Summary
Logging Plan

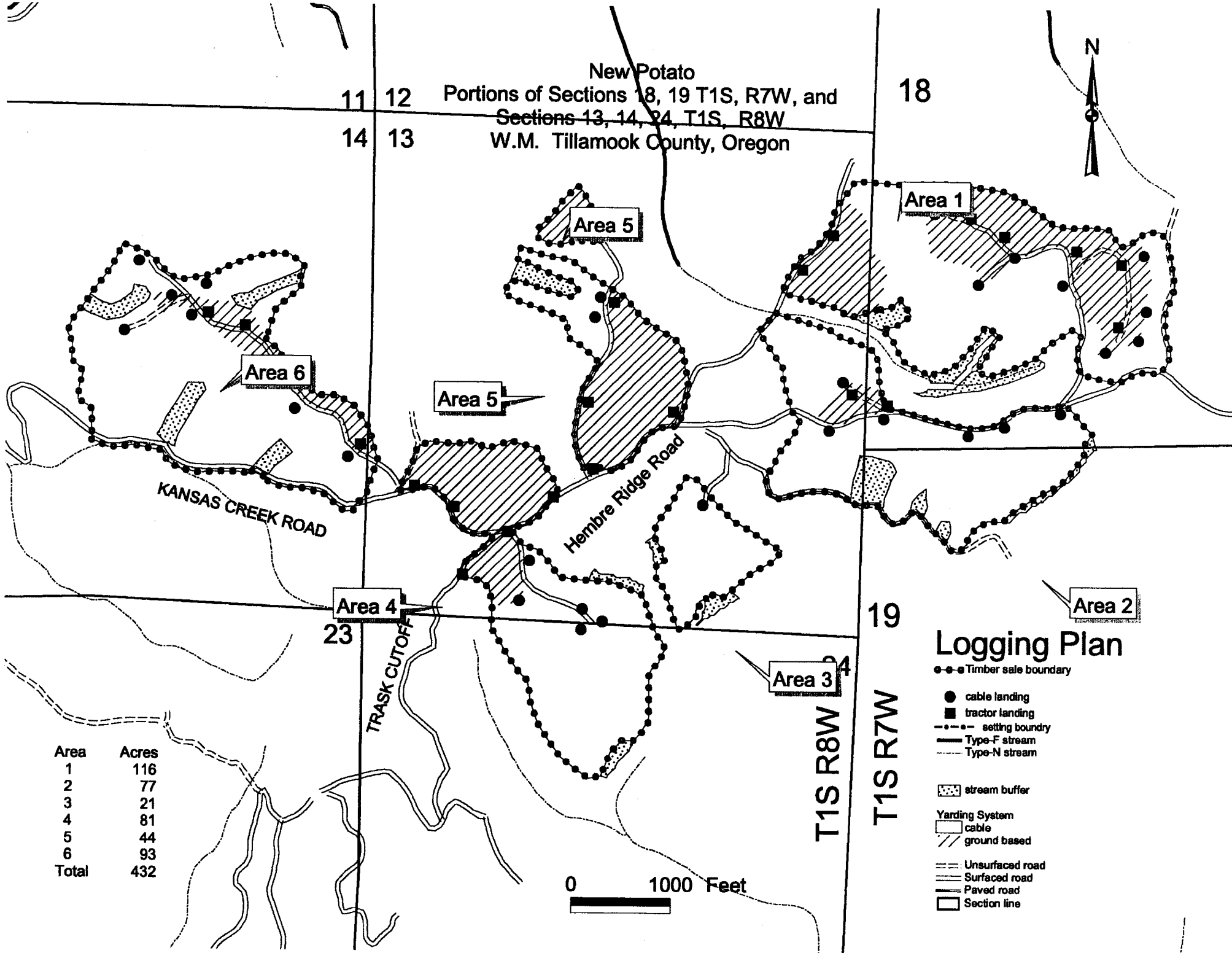

Area	Acres
1	116
2	77
3	21
4	81
5	44
6	93
Total	432



"STEWARDSHIP IN FORESTRY"

New Potato

Volume Summary

Area 1							
116 acres							
SPECIES	QMD	Basal Area	V-BAR	Vol/Acre MBF	Volume MBF	D & B	Net Vol MBF
Douglas-fir	16.3"	112	93	10.4	1206.4	5%	1146
TOTAL							1146

Area 2							
77 acres							
SPECIES	QMD	Basal Area	V-BAR	Vol/Acre MBF	Volume MBF	D & B	Net Vol MBF
Douglas-fir	16.1"	126	99	12.5	962.5	5%	914
TOTAL							914

Area 3							
21 acres							
SPECIES	QMD	Basal Area	V-BAR	Vol/Acre MBF	Volume MBF	D & B	Net Vol MBF
Douglas-fir	17.7"	66	123	8.1	170.1	5%	162
TOTAL							162

Area 4							
81 acres							
SPECIES	QMD	Basal Area	V-BAR	Vol/Acre MBF	Volume MBF	D & B	Net Vol MBF
Douglas-fir	17.7"	71	123	8.7	704.7	5%	669
TOTAL							669

New Potato

Volume Summary

Area 5							
44 acres							
SPECIES	QMD	Basal Area	V-BAR	Vol/Acre MBF	Volume MBF	D & B	Net Vol MBF
Douglas-fir	16.1"	79	99	7.8	343.2	5%	326
TOTAL							326

Area 6							
93 acres							
SPECIES	QMD	Basal Area	V-BAR	Vol/Acre MBF	Volume MBF	D & B	Net Vol MBF
Douglas-fir	15.5"	116	122	14.2	1320.6	5%	1255
TOTAL							1255

TOTAL SALE VOLUME 440 net harvest acres				
SPECIES	QMD	MBF	D&B	Net Vol (MBF)
Douglas-fir	16.3"	4708	5%	4472
TOTAL		4708		4472

OREGON DEPARTMENT OF FORESTRY

WRITTEN PLAN

NEW POTATO TIMBER SALE

Protected Waters: Dietz Creek, a type F stream of the Kilchis River Basin. An unnamed type F tributary of Sam Downs Creek in the Kilchis River Basin. Klahn Creek, and other unnamed tributaries of Berry Creek in the Wilson River Basin. The Little North Fork of the Wilson in the Wilson River Basin. Clear Creek, a type F stream in the Kilchis River Basin.

Location: Sec. 23, T1N, R9W, W.M. Sec. 10, T1S, R9W, W.M. Sec. 19, 20, 21, 29, T1N, R8W, W.M. Sec. 6, T1S, R8W, W.M.

Activities: Placing trees in the RMA of Dietz Creek for in-stream habitat improvement. Replacement of a log culvert on Sam Downs Road with an arch pipe to allow fish passage. Road vacating on part of Sam Downs Road and the Little North Fork of the Wilson Road, including sidecast retrieval and removal of existing culverts on tributaries of Berry Creek. Removal of a large culvert on Clear Creek Road to allow fish passage on Clear Creek.

Protection Measures: Work will not be allowed from October 16 through April 30. No activity within 100 feet of the protected waters or in-stream activity will be conducted before July 1 or after September 15 without prior approval from the Oregon Department of Fish and Wildlife.

A 91" x 142" by 96 foot arch pipe has been sized for a 100-year event using Peak Flow. Fill material will be placed in 8-inch lifts and compacted with a tamper. Fill slopes will be constructed at a 1½ to 1 fill width-to-height ratio.

Road closure activities will include excavating material from stream crossings to restore natural stream channel widths, with the stream banks shaped at a 1½ to 1 width-to-height ratio, and water barring the roads.

Fish habitat improvement work on Dietz Creek will be done only during dry weather periods and low water stream flows. Machine activity in the stream will be kept to a minimum. Disturbance of existing vegetation will be kept to a minimum. All practical erosion control measures will be taken to minimize sedimentation to waters of the State. Access trails will be blocked, water barred, seeded with grass and mulched upon completion. Alders that are cleared to gain access will be placed in the stream or used to block access trails.

All other areas of disturbed soil resulting from project work, including fill slopes, sidecast retrieval slopes, cut banks and waste areas will be grass seeded, fertilized and mulched upon completion of work.

Prepared By: Carl J. Walter
Road Specialist

Date: February 8, 2002