



"STEWARDSHIP IN FORESTRY"

Timber Sale Appraisal Cost Summary Kansas Cutoff Sale 341-02-27

District: Tillamook

Date: 4/8/02

	Conifer	Hardwood	Total
Gross Timber Sale Value	\$254,789.56	\$0.00	\$254,789.56
		Project Work	\$0.00
		Advertised Value	\$254,789.56



Timber Sale Appraisal Timber Description Kansas Cutoff Sale 341-02-27

"STEWARDSHIP IN FORESTRY"

District: Tillamook

Location: Portions of Sections 13, 14, 23, 24, T1S, R8W, W.M. Tillamook County, Oregon

Date: 4/8/02

Stand Stocking: 20%

Species	Avg. DBH	Amortized%	Recovery%
Douglas - Fir	21	0	95

Volume by Grade	Douglas - Fir	Total
2S	557	557
3S	186	186
Total	743	743

Comments: Pond Values Used: 1st Quarter 2002 & Local Pond Values.

Other (plus P & R): Brand and Paint: $\$2.00/\text{MBF} \times 743 \text{ MBF} = \1486

Road Maintenance: $\$2.55$

Grading: $\$500/\text{Mile} \times 1 \text{ grading} \times 3 \text{ miles} / 743 \text{ MBF} = \$2.02/\text{MBF}$

Surfacing: $\$3.30/\text{yard} \times .8\text{MBF} \times 50 \text{ yards/MMBF} \times 3 \text{ miles} / 743 \text{ MBF} = \$.53/\text{MBF}$

Hardwood local pond value of $\$420$ used. Obtained from Northwest Hardwoods, Jan. 2002



Timber Sale Appraisal

Logging Conditions

Kansas Cutoff

Sale 341-02-27

"STEWARDSHIP IN FORESTRY"

Combination#: 1	Douglas - Fir	85.00%
Yarding Distance:	Medium (800 ft)	Downhill Yarding: No
Logging System:	Cable: Medium Tower >40 - <70	Process: Manual Delimiting
Tree Size:	Mature Private Forest / Regen Cut (250 Bft/tree), 6-11 logs/MBF	
Loads/Day:	6	Bd. Ft./Load: 4,500
Cost/MBF:	\$122.84	
Machines:		
	Log Loader (A)	
	Tower Yarder (Medium)	
Combination#: 2	Douglas - Fir	15.00%
Yarding Distance:	Short (400 ft)	Downhill Yarding: No
Logging System:	Track Skidder	Process: Manual Falling/Delimiting
Tree Size:	Small / Thinning 12in (130 Bft/tree), 12-17 logs/MBF	
Loads/Day:	7	Bd. Ft./Load: 4,500
Cost/MBF:	\$103.66	
Machines:		
	Log Loader (B)	
	Track Skidder	



Timber Sale Appraisal

Logging Costs

Kansas Cutoff

Sale 341-02-27

"STEWARDSHIP IN FORESTRY"

Date: 4/8/02

Operating Seasons: 1.0

Profit & Risk: 15%

Project Costs: \$0

Other Costs (P/R): \$1,486

Slash Disposal: \$0

Other Costs: \$0

Miles of Road			
Dirt	Rock (Contractor)	Rock (State)	Paved
0.0	0.0	0.0	0.0

Road Maintenance: \$2.55

Hauling Costs

Species	\$/MBF	Trips/Day	MBF/Load
Douglas - Fir	\$0.00	3.0	4.5



"STEWARDSHIP IN FORESTRY"

Timber Sale Appraisal Logging Costs Breakdown Kansas Cutoff Sale 341-02-27

Costs	Douglas - Fir
Logging	119.96
Road Maintenance	2.68
Fire Protection	3.65
Hauling	35.89
Other (P/R appl.)	2.00
Profit & Risk	24.63
Slash Disposal	0.00
Scaling	2.00
Other	0.00
Total	190.81

Amortization	0.00
Pond Value	533.73
Stumpage	342.92
Amortized	0.00



"STEWARDSHIP IN FORESTRY"

Timber Sale Appraisal Summary Kansas Cutoff Sale 341-02-27

Amortized

	Douglas - Fir
MBF	0.00
Value	0.00
Total	0.00

Unamortized

	Douglas - Fir
MBF	743.00
Value	342.92
Total	254,789.56

Gross Timber Sale Value

Recovery \$254,789.56

Prepared by: Steve Langer

Date: 4/8/02

District: Tillamook

Phone: (503) 842-2545



OREGON DEPARTMENT OF FORESTRY
CRUISE REPORT

Kansas Cutoff

1. **Type of Sale:** Clearcut, Recovery
2. **Legal Description:** Sections 13, 14, 23, 24, T1S, R8W, W.M. Tillamook County, Oregon
3. **Sale Acreage:** The sale boundary was plotted on a digital orthophotograph and the acreage was calculated with GIS.

ACRES		
<u>Sale</u>	<u>Total</u>	<u>Net</u>
99	100	89

Sale Acres: *Area within the Timber Sale Boundary signs.*

Total Acres: *For accomplishment reporting*

Clearcut harvest: Sale acres; plus green tree retention acres outside the sale boundary; less roads and riparian areas classified as Special Stewardship in LMCS inside the sale boundary.

Net Acres: *Used for calculating the advertised volume.*

Clearcut: Sale acres; less green tree retention, roads, and riparian areas classified as Special Stewardship in LMCS inside the sale boundary.

4. **Cruising Procedures:**
 - A. **Cruise Method:** 59 variable radius measured plots were established 200 feet apart on cruise lines headed north and south and spaced 300 feet apart. Diameter was taken at 4.5 feet and was measured to the nearest inch. Heights were measured to a 6 inch top, or 25% of diameter, whichever was greater, and were measured to the nearest foot. The coefficient of variation for Douglas-fir was 65.6% and the standard error was 4.8% for board foot measure.
 - B. **Plot size:** A basal area factor of 20 was used, point of tree observation was 16 feet.
 - C. **Grading System:** Trees were graded during the cruise following the Columbia River Official Log Scaling and Grading Bureau rules.
5. **Computation Procedure:** The cruise was entered into SuperAce Timberland Appraisal and Planning System from Atterbury Consultants Inc., version 98.06.27. Information on the stand (noted under the timber description) was calculated using this program. Basal area was then reduced to account for individually marked leave trees left in the sale area, and the VBAR from the cruise was applied to the net basal area to calculate volume.

6. **Hidden Defect and Breakage:** A 5% breakage and defect reduction was applied to the volume.
7. **Timber Description:** The sale area burned in 1933 and 1939. The timber sale is comprised of 50 year old Douglas-fir with scattered hemlock and spruce. The area was thinned and the alder removed in 1998. The Douglas-fir on the sale area are severely affected by Swiss needle cast. Information calculated from the cruise is as follows:
Douglas-fir:
 - Basal area per acre: 78 ft²
 - Trees per acre: 33
 - Average DBH: 21 inches
8. **Cruiser Names/Dates:** Steve Langer, Bob Shaver, Ed Keith, January, 2001
9. **Revenue Distribution:**
 - 100% FDF
 - Tax Code: 9-1
 - Deed Numbers: 169, 211
 - 100% Rehabilitation Obligated
7. **Attachments:**
 - Volume Summary
 - Logging Plan



STEWARDSHIP IN FORESTRY

Kansas Cutoff

Volume Summary

Regeneration Harvest						
89 acres						
SPECIES	Basal Area Per Acre	V-BAR	Vol/Acre MBF	Volume MBF	D & B	Net Vol MBF
Douglas-fir	72	122	8.8	782	5%	743
TOTAL				782		743

Kansas Cutoff Logging Plan

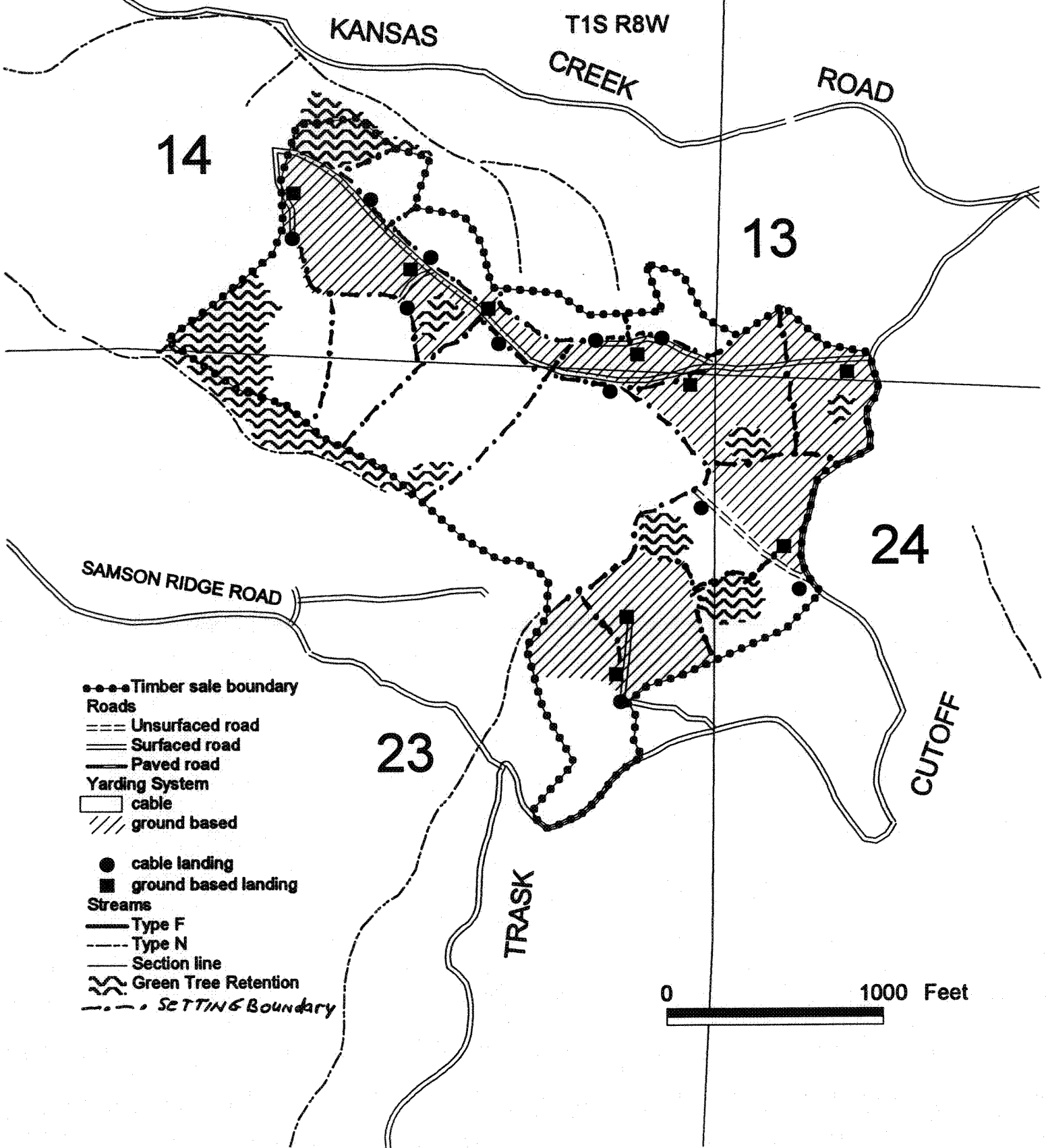

- Timber sale boundary
- Roads**
- Unsurfaced road
- Surfaced road
- Paved road
- Yarding System**
- cable
- /// ground based
- cable landing
- ground based landing
- Streams**
- Type F
- - - Type N
- Section line
- ~ Green Tree Retention
- · · · · SETTING Boundary

